

Instruction/Installation Sheet

DataComm Electronics 50-6623-WH-KIT Flat Panel TV Cable Organizer Kit w/ Duplex Power Solution



DataComm Electronics
6349 Peachtree St.
Norcross, GA 30071-1725
888.223.7977
www.datacommelectronics.com

Parts Included:

1. Pre-Assembled Top Plate w/ 15A / 125V duplex receptacle and pre-stripped electrical building wire
2. Bottom Plate with easy push-in connectors
3. 6 ft. extension cord w/ 360° rotating flat head

Tools Needed:

1. Drywall Saw
2. 6 ft. Tape Measure
3. Pencil
4. Phillips Head Screwdriver

Use the Flat Panel TV Cable Organizer Kit w/ Duplex Power Solution to install power and low voltage cables behind your flat panel TV, amplifier, or other audio and video devices to your equipment, your equipment room or other location.

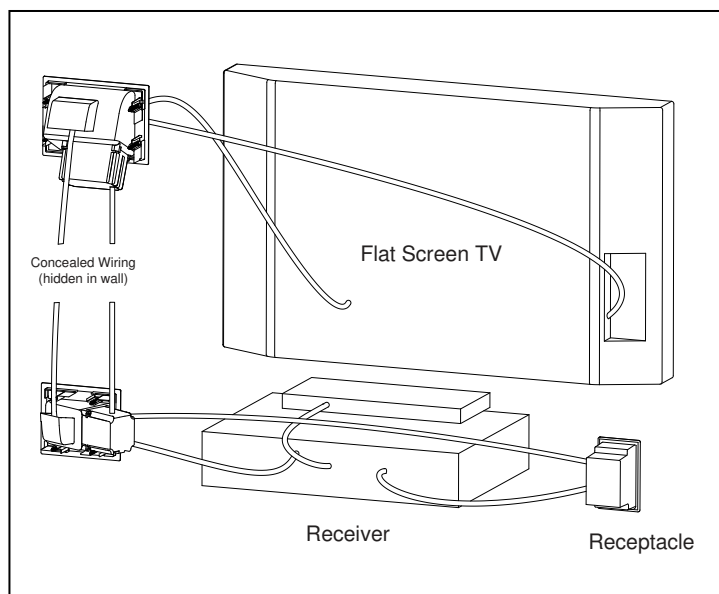
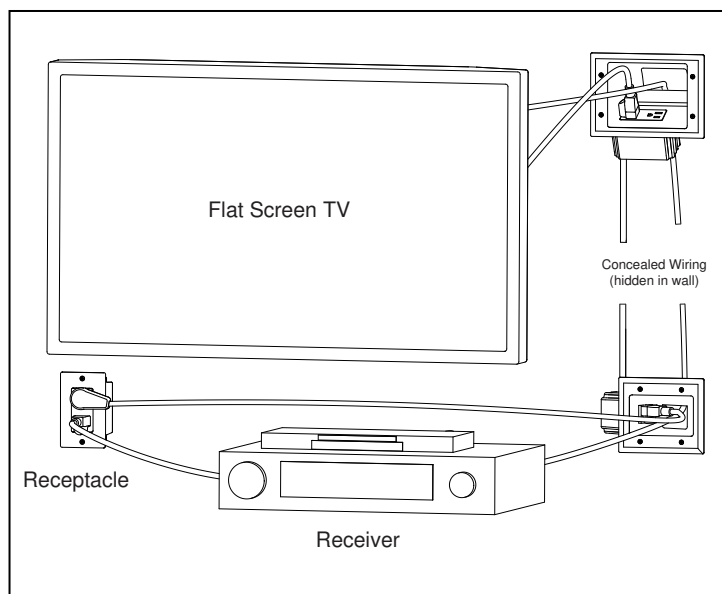

IMPORTANT INSTRUCTIONS:

- Always follow local electrical code when installing this product.
- The electrical parts in this kit are designed to be used only as a kit and none of these electrical parts are designed to be used individually.
- This product is not designed to be part of your home or a commercial building's electrical wiring system.
- This installation is only energized (electrically active) when the supplied 6 ft. cord is plugged into the recessed straight blade inlet (located on the recessed low voltage cable plate) and the straight blade end of the 6 ft. cord is plugged into either your surge protector or wall receptacle.

If you are not familiar with home wiring systems, please call a qualified electrician to install this product.

IMPORTANT INSTRUCTIONS:

This product is designed for retrofit work only because the electrical outlet box cannot be attached to a stud.

Installation Instructions for Retrofit Work Only:

Select the location of your flat panel TV mounting bracket. Next, select the location for both cable plates of the top and bottom plates.

Figure 1



Top view - shows needed space between the drywall and the studs. The power output plate should be centered between the studs.

Figure 2



Using the template supplied (see page 5 of instruction sheet), trace the opening for both the top and bottom plate. See Figure 1 before tracing your opening. Remember, the plates are designed to be mounted centered between the studs. Using a drywall saw, cut a hole in the drywall the size of each template.

Figure 3



Run your low voltage cables and the included 14/2 with ground UL approved electrical building wire from the top opening in the wall through the bottom opening in the wall. You will need to fish the cables from the top opening to the bottom opening.

Stop: Important: Before installing the top power plate into the top template opening, make sure to pull your low voltage cables through the low voltage cable opening at the back of the plate.

Figure 4



After inserting your low voltage cables and the electrical building wire through the opening for the top plate, insert the top plate into the wall by inserting the electrical work box into the wall first (see Figure 4).

Slowly slide the top power plate into the opening. Swing the top of the plate into position until the entire plate is flush against the wall.

Figure 5



Using a Phillips screwdriver, tighten the screws with wings. These wings fasten tightly against the back of the wall. **Note:** Do not overtighten screws.

Figure 6

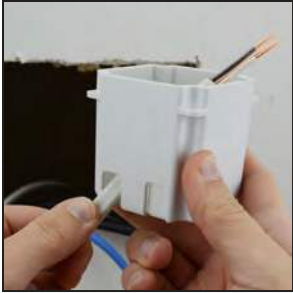

Now that you have pulled the top power outlet plate's electrical building wire through the bottom hole, bend the wire straight. Push the stripped end of the wire through the opening in the white old work box.

Figure 7



Insert the stripped end of the wires into the push-in connectors. First, insert the stripped black wire into the open side of the push-in connector with the black wire – be sure to push the stripped black wire completely into the connector. Now insert the stripped white wire into the open side of the push-in connector with the white wire. Next, insert the bare copper ground wire into the open side of the push-in connector with the green ground wire.

Figure 8

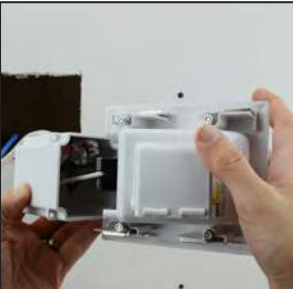

Shove all of the wires and the push-in connectors into the white old work box.

Figure 9



Now screw the white old work box to the back of the bottom plate.

Figure 10

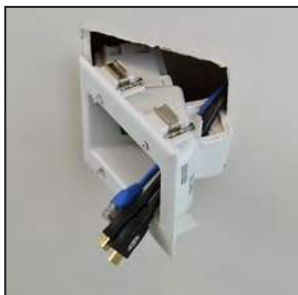

Now pull your low voltage cables through the cable opening in the bottom plate.

Stop: Important: Before installing the bottom recessed plate with inlet into the bottom template opening, make sure to pull your low voltage cables through the low voltage cable opening in the back of the plate.

After you have pulled your low voltage and audio/video cables through the bottom power input plate, insert the side of the plate with the electrical work box into the wall. (see Figure 10). Swing the right side of the plate into position until the entire plate is flush against the wall. Now tighten the screws with wings. These wings fasten tightly against the back of the wall. Note: Do not overtighten screws.

Figure 11



Now hang your flat panel TV on the mounting bracket (not included) and plug your TV into the top power output plate. Then plug your power cord set into the bottom power input plate. Complete installation by plugging the male end of the power cord set into the nearby wall receptacle.

WARNING:

- DataComm Electronics' products shall be installed and used only as indicated in DataComm Electronics' product instruction sheets.
- Instruction sheets are available online at www.datacommelectronics.com

CAUTION:

- For shock protection, this device must be properly grounded.
- Use copper wire only with this device.

IMPORTANT INSTRUCTIONS:

- Read and understand all instructions.
- Follow all warnings and instructions marked on the product.
- Do not use this product near water, for example; near a bathtub, wash bowl, kitchen sink, laundry tub, in a wet basement, or near a swimming pool.
- SAVE THESE INSTRUCTIONS



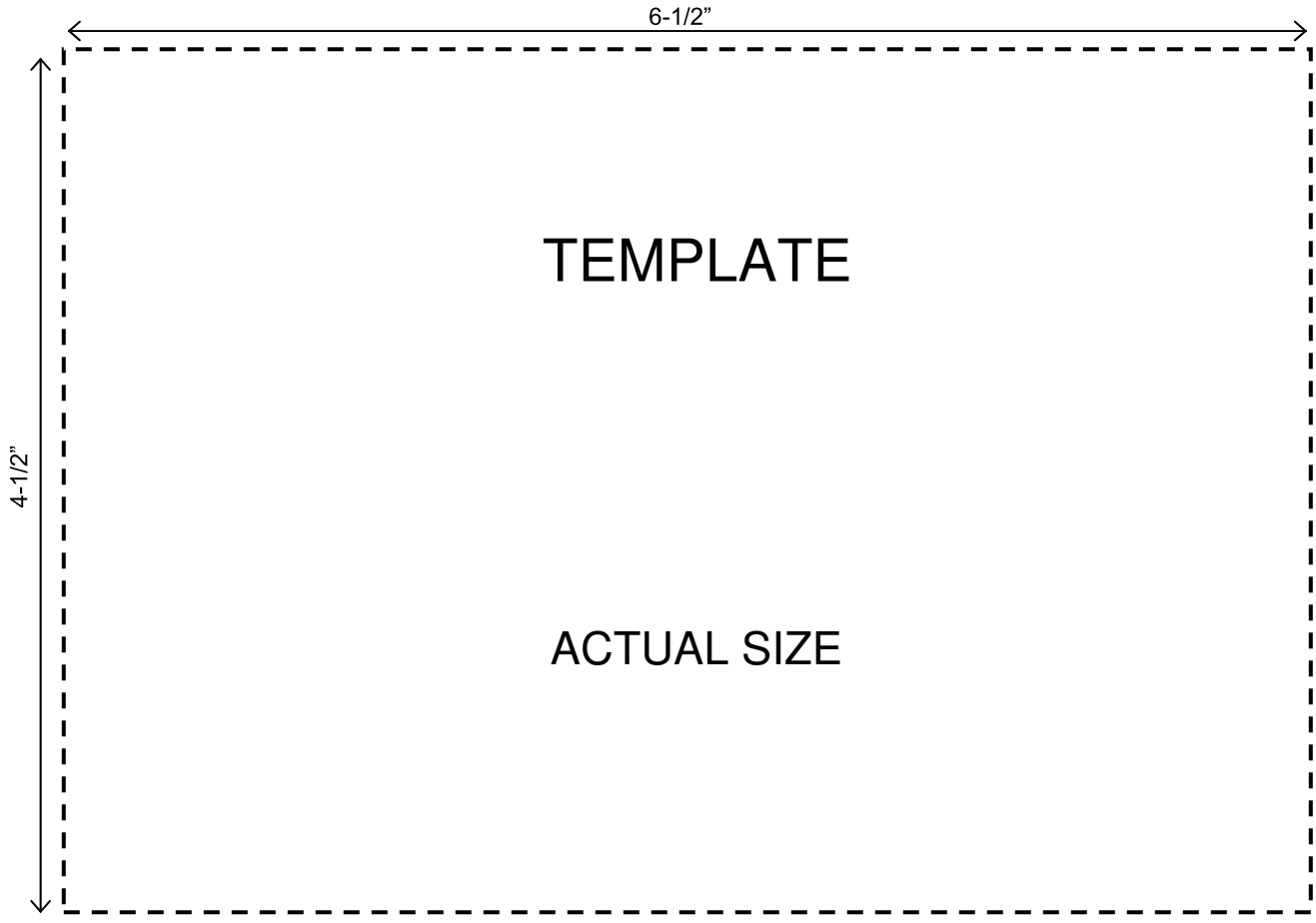

CUT ALONG DOTTED LINE ✂

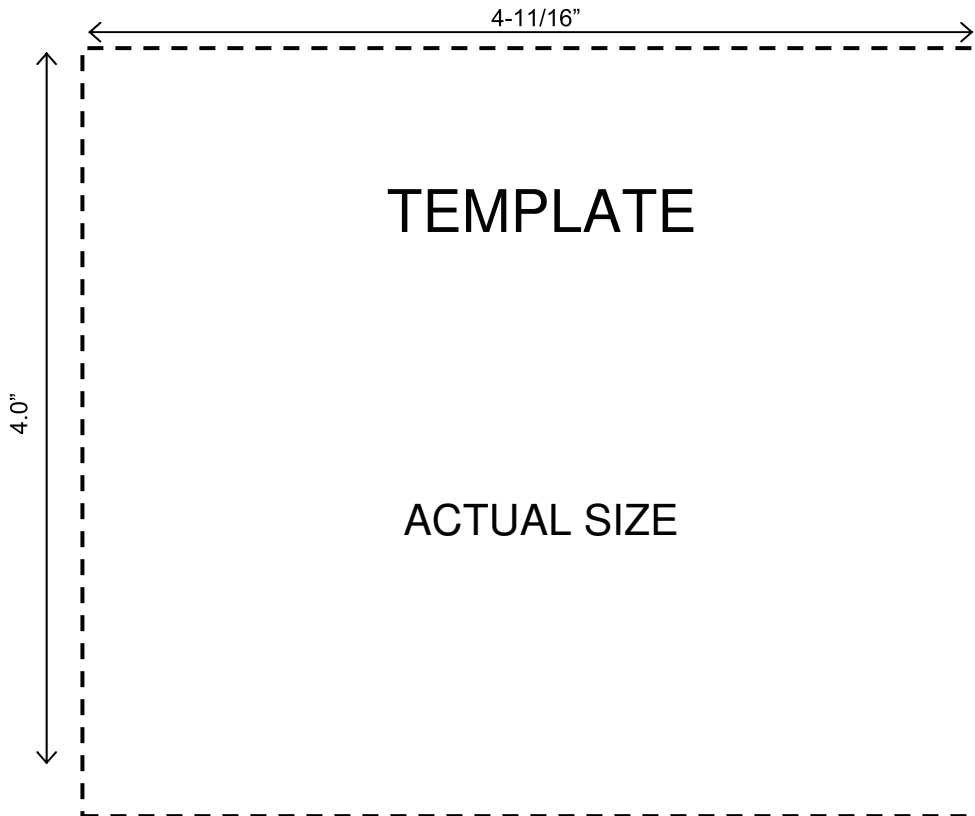

CUT ALONG DOTTED LINE ✂

