

NOTE : IN CASE OF E662XXXXXXXX6XXX, Ground is not connected, GN/YE wire is cutted off.

BILL OF MATERIALS

ITEM	QTY.	DESCRIPTION	MATERIAL	FINISH
12	0/2	WASHER	-	-
11	0/2	SCREW M3x27	STEEL	ZINC
10	0/2	INTEGRATED GASKET	NBR	-
9	0/2	FLAT GASKET	NBR/SILICONE	-
8	0/2	PROFILE GASKET	NBR/SILICONE	-
7	0/2	SCREW M3x25	STEEL	ZINC
6	2	LABEL WHITE	ABS	-
5	0/2	PCB	-	-
4	2	INSERT DIN	PA66+25%G V0	-
3	6	CONTACT DIN	BRASS	SILVER
2	-	MOULDING MATERIAL	PP	-
1	-	CABLE	PUR	BLACK
ITEM	QTY.	DESCRIPTION	MATERIAL	FINISH

NOTES :

- ELECTRICAL - CURRENT : MAX. 5.0A
- CONTACT RESISTANCE : ≤15 milliohms MAX.
- INSULATION RESISTANCE : 100 Megaohms MIN.
- PHYSICAL - OPERATING TEMPERATURE WITH : NITRILE RUBBER (NBR) GASKET : -40°C TO +90°C
- LIVE CONTACT DISTANCE : FORM B - 11.00mm
- ENVIRONMENTAL - IP65 SEALING PROTECTION(FIXING SCREW)

FUNCTIONAL SYMBOLS			THIS DRAWING CONTAINS INFORMATION THAT IS PROPRIETARY TO MOLEX ELECTRONIC TECHNOLOGIES, LLC AND SHOULD NOT BE USED WITHOUT WRITTEN PERMISSION		
▽A = 0	mm	SCALE 1:1	CURRENT REV DESC: TOL. TABLE UPDATED		
▽E = 0	GENERAL TOLERANCES (UNLESS SPECIFIED)		EC NO: 642619		
▽F = 0	ANGULAR TOL ± 1.0°		DRWN: SSM 2020/07/29		
DIVISIONAL SYMBOLS		4 PLACES ±	CHK'D: RSILLER 2020/09/04		
		3 PLACES ±	APPR: RSILLER 2020/09/04		
		2 PLACES ± 0.05	INITIAL REVISION:		
		1 PLACE ± 0.3	DRWN: SSM 2020/07/29		
		0 PLACES ± 0.5	APPR: RSILLER 2020/09/04		
DRAFT WHERE APPLICABLE MUST REMAIN WITHIN DIMENSIONS		THIRD ANGLE PROJECTION	DRAWING A3-SIZE	SERIES 121055	MATERIAL NUMBER SEE SHEET 2
			CUSTOMER GENERAL MARKET	DOC TYPE PSD	DOC PART 000
			SHEET NUMBER 1 OF 2		

ENGINEERING No. MATRIX

E 6 6 X X X X X X X 2 X X X X

E66 - Form Industrial
(11mm Contact Spacing)

Number of Wires
2 - 2 Poles
3 - 2 Poles + Ground

Cable type:
See Table

Head Colour:
G - Grey
N - Black
A - CSA-UL Black
B - CSA-UL Grey

Cable Length in Meters (L):
A=1
B=1.5
C=2
D=2.5
E=3
F=3.5
G=4
H=4.5
L=5
M=5.5
N=6
P=6.5
Q=7
R=7.5
S=8
T=8.5
U=9
K=10

Cable Length in cm Between 2 connectors (L1)
15=15 cm
30=30 cm
1K=100 cm
min length=13 cm

Earth PIN Location:
2=12/1 earth on 12H

Internal Circuit
see Wiring Configuration

Voltage and LED color

1= 12V
2= 24V
3= 48V
4= 115V
5= 230V
RED LED

A= 12V
B= 24V
C= 48V
D= 115V
E= 230V
GREEN LED

G= 12V
H= 24V
K= 48V
L= 115V
M= 230V
YELLOW LED

Type of Gasket and Screw:

- 1 = NBR Profile Gasket + Fixing Screw M3x25mm
- 2 = NBR Flat Gasket + Fixing Screw M3x25mm
- 3 = Silicone Profile Gasket + Fixing Screw M3x25mm
- 4 = Silicone Flat Gasket + Fixing Screw M3x25mm
- P = NBR Integrated Gasket + Fixing Screw with Washer M3x27mm Assembled on Connector
- R = NBR Integrated Gasket + Fixing Screw with Washer M3x27mm NOT Assembled on Connector
- T = NBR Profile Gasket + Fixing Screw with Washer M3x27mm

Type of Screws and Gaskets

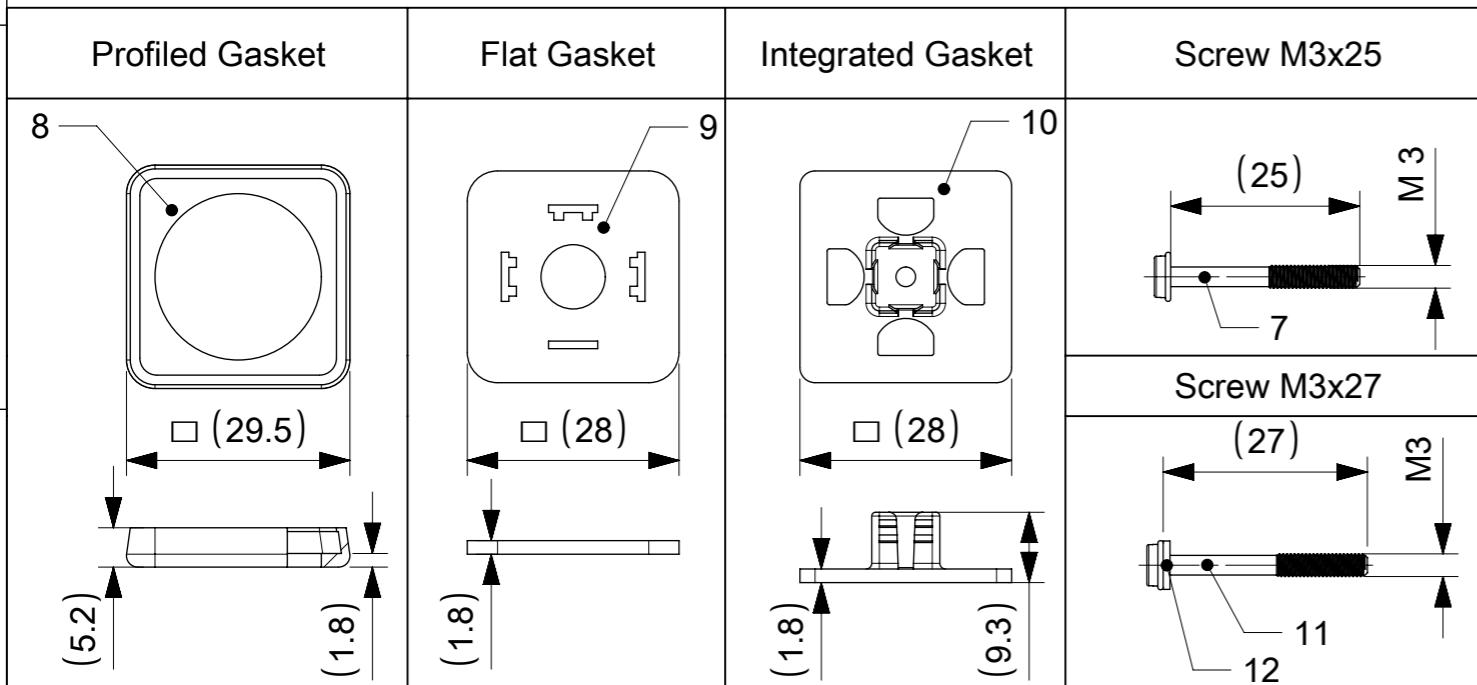

PART LIST

SL No.	MOLEX P/N	ENG No.
1	1210550262	E663P3NE2021S0B
2	1210550263	E663P3NC2021S0B
3	1210550270	E663P2NE202PC4H

Over	Up to and Including	Tolerance
0	500	-10/+20
500	1000	±20
1000	3000	±30
3000	5000	±40
5000	10000	±50
10000	15000	±100
15000	20000	±150
20000		±L/100

THIS DRAWING CONTAINS INFORMATION THAT IS PROPRIETARY TO MOLEX ELECTRONIC TECHNOLOGIES, LLC AND SHOULD NOT BE USED WITHOUT WRITTEN PERMISSION

FUNCTIONAL SYMBOLS: $\sqrt{A} = 0$, $\sqrt{E} = 0$, $\sqrt{F} = 0$

DIMENSION UNITS: mm | SCALE: 1:1

GENERAL TOLERANCES (UNLESS SPECIFIED): ANGULAR TOL ± 1.0°

EC NO: 642619 | DRWN: SSM | 2020/07/29 | APPR: RSILLER | 2020/09/04

INITIAL REVISION: DRWN: SSM | 2020/07/29 | APPR: RSILLER | 2020/09/04

DOCUMENT NUMBER: 1210550270 | DOC TYPE: PSD | DOC PART: 000 | REVISION: A

DRAFT WHERE APPLICABLE MUST REMAIN WITHIN DIMENSIONS | THIRD ANGLE PROJECTION | DRAWING: A3-SIZE | SERIES: 121055 | MATERIAL NUMBER: SEE PART LIST | CUSTOMER: GENERAL MARKET | SHEET NUMBER: 2 OF 2

Screw M3x25
and Profile Gasket
Qty 2

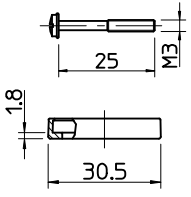

Screw M3x25
and Flat Gasket
Qty 2

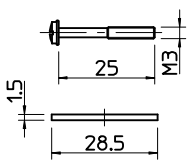

Screw M3x27
with Grommet
& Integrated Gasket
Qty 2

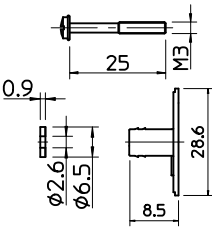

PART NUMBER MATRIX

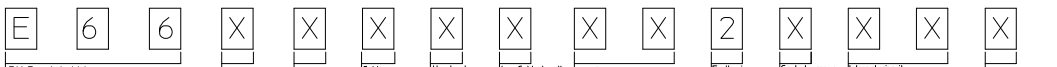

E66-Form Industrial (thin contact spacing)
Number of poles: 2-2 Poles-Earth 3-2 Poles-Earth
Cable type: N-PVC BLACK I-CEI GREY PA-PUR BLACK A-PVC CSA-UL BK B-PUR CSA-UL BK
Cable cross section area: 2-4.5 mm² (20AWG) 3-6.75 mm² (18AWG)
Head colour: N-Black A-CSA-UL Black
L - Cable length: A-1000mm B-1500mm C-2000mm D-2500mm E-3000mm F-3500mm G-4000mm H-4500mm L-5000mm M-5500mm N-6000mm
L1 - Distance between the two head in cm: ex. 13-130mm
P-6500mm Q-7000mm R-7500mm S-8000mm T-8500mm U-9000mm V-9500mm W-1000mm X-1000mm
Earth pin locators: 2-H1Z
Gasket-screws: H-NBR profile gasket+screw 2-NBR flat gasket+screw 3-Silicon profile gasket+screw 4-Silicon flat gasket+screw P-NBR integrated gasket+screw
Internal circuit
Supply voltage and LED colour: 1 - 5V-Red LED A - 5V-Green LED 6 - 5V-Amber LED
1A,G-12V 230V-24V 3,C,K-48V 4,D,L-15V 5,E,M-230V

EXAMPLE: E663P2NE202PC4H

Circuit Tempo Printout/White (Not for E66XXXXXX2X000)

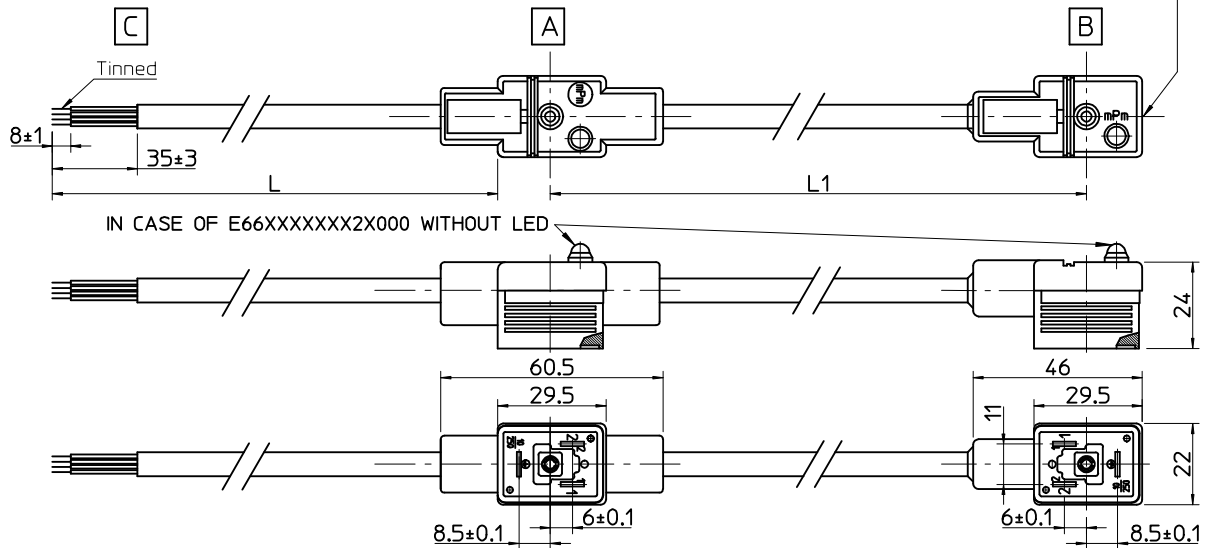

IN CASE OF E66XXXXXX2X000 WITHOUT LED

Table of length tolerances [mm]

Over	Up to and including	Tolerance
0	1000	±20
1000	3000	±30
3000	5000	±40
5000	10000	±50
10000	15000	±100
15000	20000	±150
20000		±L/100

ELECTRICAL DIAGRAM E66XXXXXX000

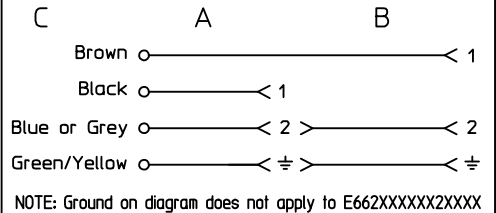

NOTE: Ground on diagram does not apply to E662XXXXX2XXXX

ELECTRICAL DIAGRAM E66XXXXXX3X

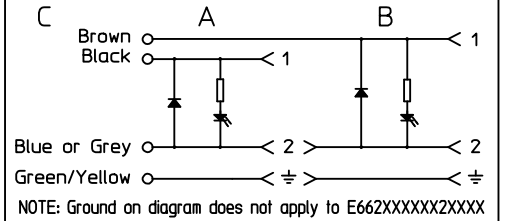

NOTE: Ground on diagram does not apply to E662XXXXX2XXXX

ELECTRICAL DIAGRAM E66XXXXXXA1X

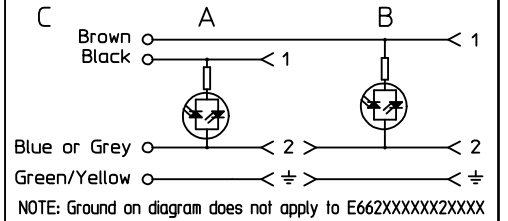

NOTE: Ground on diagram does not apply to E662XXXXX2XXXX

ELECTRICAL DIAGRAM E66XXXXXXC4X

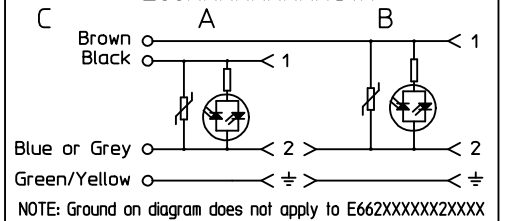

NOTE: Ground on diagram does not apply to E662XXXXX2XXXX

ELECTRICAL DIAGRAM E66XXXXXXS0X

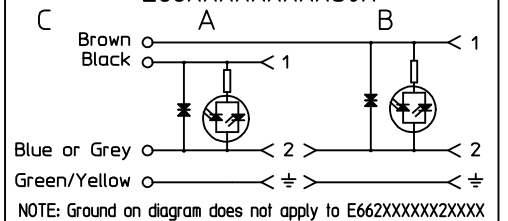

NOTE: Ground on diagram does not apply to E662XXXXX2XXXX

Table 1 - PNs list

Molex PN	Engineering No.	L [mm]	L1 [mm]
1210550270	E663P2NE202PC4H	3000	200

Notes:
1. Dimensions without tolerance are referential.

ORIGINAL RELEASE
EC NO: IPG2015-0619
DRWN: JMARSZALEK 2014/10/03
CHKD:WSTRASZKIEWI 2014/10/03
APPR:MIWASIECZKO 2014/10/20

QUALITY SYMBOLS
▽=0
◁=0

GENERAL TOLERANCES (UNLESS SPECIFIED)

	mm	INCH
4 PLACES	± ---	± ---
3 PLACES	± ---	± ---
2 PLACES	± ---	± ---
1 PLACE	± ---	± ---
0 PLACE	± ---	± ---

ANGULAR ±---°
DRAFT WHERE APPLICABLE
MUST REMAIN WITHIN DIMENSIONS

DIMENSION STYLE
MM ONLY

DRAWN BY: JMARSZALEK
DATE: 2014/10/03

CHECKED BY: WSTRASZKIEWI
DATE: 2014/10/03

APPROVED BY: MIWASIECZKO
DATE: 2014/10/20

MATERIAL NO.
MATRIX DRAWING

SIZE: A3

SCALE: -
DESIGN UNITS: METRIC
THIRD ANGLE PROJECTION

E66XXXXXX2XXXX
DUAL DIN FORM B-IND. H12

molex

DOCUMENT NO.: SD-121055-010
SHEET NO.: 1 OF 1

THIS DRAWING CONTAINS INFORMATION THAT IS PROPRIETARY TO MOLEX INCORPORATED AND SHOULD NOT BE USED WITHOUT WRITTEN PERMISSION

Screw M3x25
and Profile Gasket
Qty 2

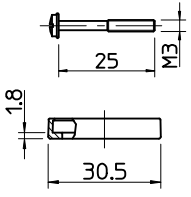

Screw M3x25
and Flat Gasket
Qty 2

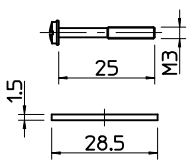

Screw M3x27
with Grommet
& Integrated Gasket
Qty 2

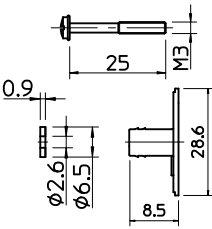

PART NUMBER MATRIX

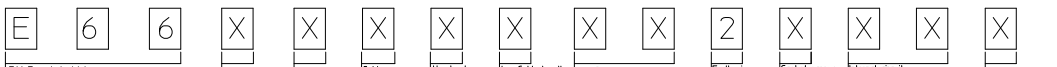

E66-Form Industrial (thin contact spacing)
Number of poles: 2-2 Poles-Earth 3-2 Poles-Earth
Cable type: N-PVC BLACK I-CEI GREY P-PLUR BLACK A-PVC CSA-UL BK B-PLUR CSA-UL BK
Cable cross section area: I-2.5 mm² (20AWG) A-1.5 mm² (18AWG) B-1.5 mm² (18AWG)
Head colour: N-Black A-CSA-UL Black
L - Cable length: A-1000mm B-1500mm C-2000mm D-2500mm E-3000mm F-3500mm G-4000mm H-4500mm L-5000mm M-5500mm N-6000mm
L1 - Distance between the two head in cm: ex. 13-130mm
P-6500mm Q-7000mm R-7500mm S-8000mm T-8500mm U-9000mm V-9500mm W-1000mm X-1000mm
Earth pin locators: I-4Hz
Gasket-screws: H-NBR profile gasket+screw I-NBR flat gasket+screw J-Silicon profile gasket+screw K-Silicon flat gasket+screw L-NBR integrated gasket+screw
Internal circuit
Supply voltage and LED colour: 1 - 5V-Red LED A - 5V-Green LED G - 5V-Amber LED 1A,G-12V 230V-24V 3,3K-48V 4,0L-15V 5,EM-230V

EXAMPLE: E663P2NE202PC4H

Circuit Tempo Printout/White
(Not for E66XXXXXX2X000)

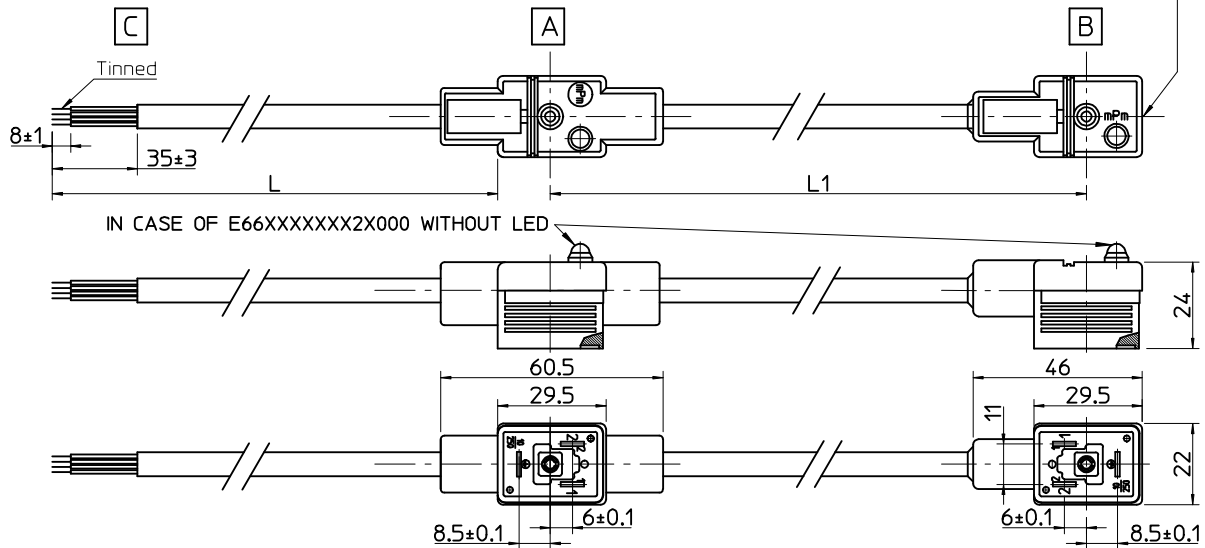

IN CASE OF E66XXXXXX2X000 WITHOUT LED

Table of length tolerances [mm]

Over	Up to and including	Tolerance
0	1000	±20
1000	3000	±30
3000	5000	±40
5000	10000	±50
10000	15000	±100
15000	20000	±150
20000		±L/100

ELECTRICAL DIAGRAM E66XXXXXX000

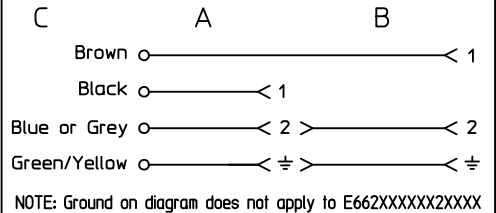

NOTE: Ground on diagram does not apply to E662XXXXX2XXXX

ELECTRICAL DIAGRAM E66XXXXXX3X

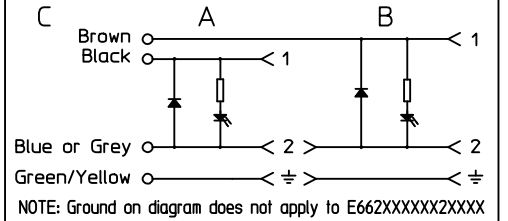

NOTE: Ground on diagram does not apply to E662XXXXX2XXXX

ELECTRICAL DIAGRAM E66XXXXXXA1X

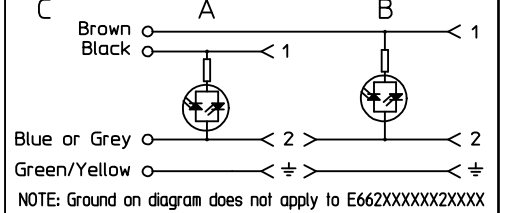

NOTE: Ground on diagram does not apply to E662XXXXX2XXXX

ELECTRICAL DIAGRAM E66XXXXXXC4X

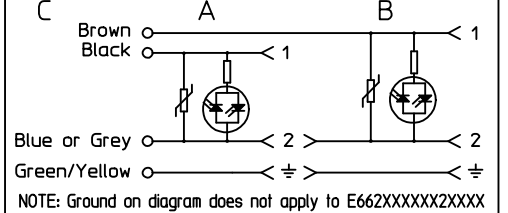

NOTE: Ground on diagram does not apply to E662XXXXX2XXXX

ELECTRICAL DIAGRAM E66XXXXXXS0X

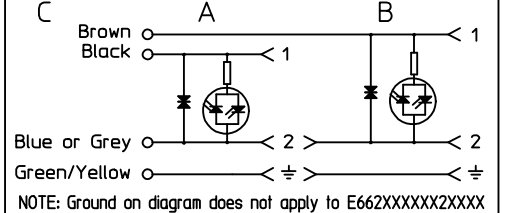

NOTE: Ground on diagram does not apply to E662XXXXX2XXXX

Table 1 - PNs list

Molex PN	Engineering No.	L [mm]	L1 [mm]
1210550270	E663P2NE202PC4H	3000	200

Notes:
1. Dimensions without tolerance are referential.

ORIGINAL RELEASE
EC NO: IPG2015-0619
DRWN: JMARSZALEK 2014/10/03
CHKD: WSTRASZKIEWI 2014/10/03
APPR: MIWASIECZKO 2014/10/20

QUALITY SYMBOLS
▽=0
◁=0

GENERAL TOLERANCES (UNLESS SPECIFIED)

	mm	INCH
4 PLACES	± ---	± ---
3 PLACES	± ---	± ---
2 PLACES	± ---	± ---
1 PLACE	± ---	± ---
0 PLACE	± ---	± ---

ANGULAR ±---°
DRAFT WHERE APPLICABLE
MUST REMAIN WITHIN DIMENSIONS

DIMENSION STYLE
MM ONLY

DRAWN BY: JMARSZALEK
DATE: 2014/10/03

CHECKED BY: WSTRASZKIEWI
DATE: 2014/10/03

APPROVED BY: MIWASIECZKO
DATE: 2014/10/20

MATERIAL NO.
MATRIX DRAWING

SIZE: A3

SCALE: -
DESIGN UNITS: METRIC
THIRD ANGLE PROJECTION

E66XXXXXX2XXXX
DUAL DIN FORM B-IND. H12

molex

DOCUMENT NO.: SD-121055-010
SHEET NO.: 1 OF 1

THIS DRAWING CONTAINS INFORMATION THAT IS PROPRIETARY TO MOLEX INCORPORATED AND SHOULD NOT BE USED WITHOUT WRITTEN PERMISSION