

MATERIAL NUMBER	ENG. NO.	MATERIAL NUMBER TAPE MOUNTED	ENG. NO.	STUD SIZE	"S" ±.005	"W" MAX	"C" MIN	"L" MAX
----- B1 -----	-----	-----	-----	04	.119 (3.02)	.322 (8.18)	.285 (7.24)	.885 (22.48)
190730083	BB-837-06	190730084	BB-837-06T	06	.146 (3.71)			
190730085	BB-837-08	190730086	BB-837-08T	08	.173 (4.39)			
190730087	BB-837-10	190730088	B1 BB-837-10T	10	.198 (5.03)	.352 (8.94)	.310 (7.87)	.936 (23.77)
----- B1 -----	-----	-----	B1 -----	06	.146 (3.71)			
190730094	BB-839-08	190730096	BB-839-08T	08	.173 (4.39)			
190730097	BB-839-10	190730099	BB-839-10T	10	.198 (5.03)			

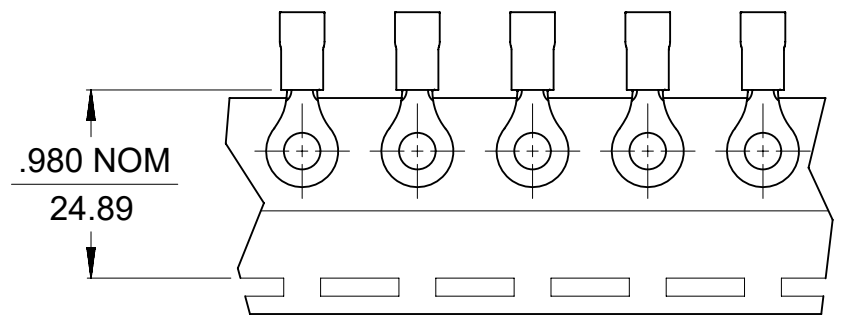
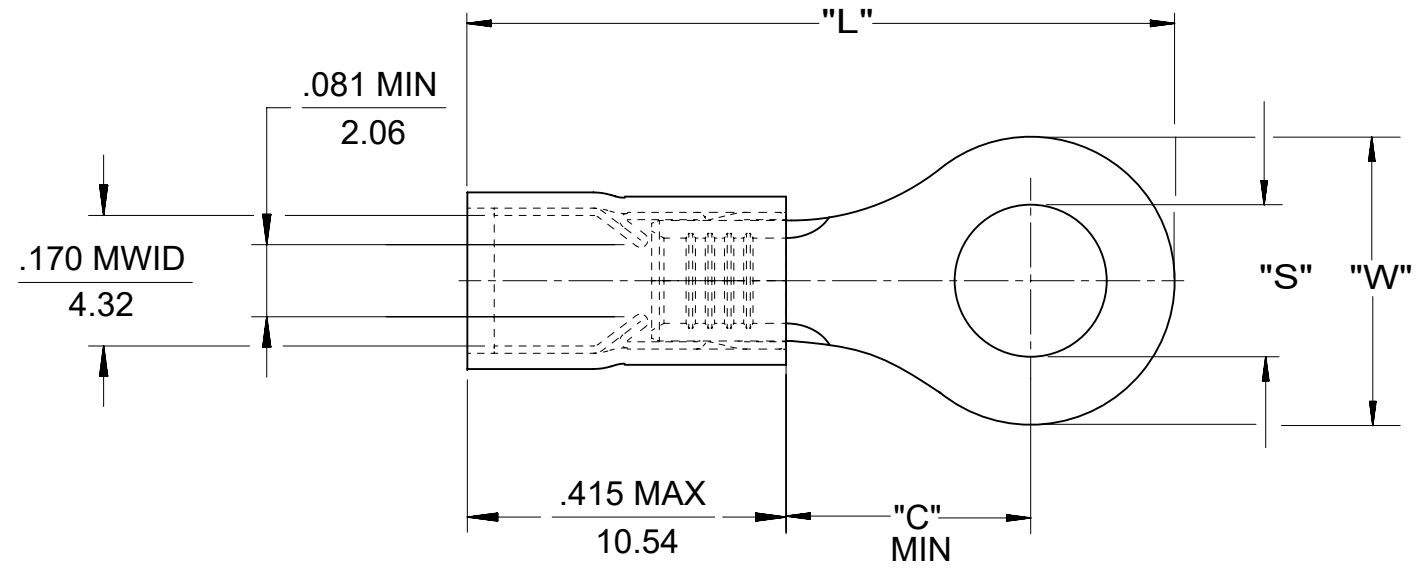

NOTE(S):

- MATERIAL THICKNESS: COPPER .031 (0.79) REF
PLATING: ELECTROPLATE TIN
- FERRULE: TIN-PLATED BRASS
- INSULATION: BLUE NYLON
- MWID = MAXIMUM WIRE INSULATION DIA.
- WIRE SIZE: 16-14 AWG
1.0-2.5 MM²

FUNCTIONAL SYMBOLS FA = 0 FE = 0 FP = 0	THIS DRAWING CONTAINS INFORMATION THAT IS PROPRIETARY TO MOLEX ELECTRONIC TECHNOLOGIES, LLC AND SHOULD NOT BE USED WITHOUT WRITTEN PERMISSION		CURRENT REV DESC: ENG PN ERROR: BB-837-10T WAS BB-823-10T. RMV OBSO PN'S: 190730081, -0302, -0093.				
	DIMENSION UNITS	SCALE	GENERAL TOLERANCES (UNLESS SPECIFIED)				
	INCH/MM	4:1	4 PLACES ±	±			
			MM	INCH			
DIVISIONAL SYMBOLS	3 PLACES ±	± 0.005	EC NO: 710863 DRWN: DMYRICK CHKD: JMACNEIL APPR: JMACNEIL		2022/06/16 2022/06/16 2022/06/16		
		2 PLACES ±	± 0.13	± 0.01	INITIAL REVISION:		
		1 PLACE ±	± 0.25	±	DRWN:		
		0 PLACES ±	±	±	APPR:		
		ANGULAR TOL	± 1.0 °	DRAFT WHERE APPLICABLE MUST REMAIN WITHIN DIMENSIONS			
		THIRD ANGLE PROJECTION	DRAWING	SERIES	MATERIAL NUMBER	CUSTOMER	SHEET NUMBER
			B-SIZE	19073	SEE CHART	GENERAL MARKET	1 OF 1