

NO SOLDER PASTE
AND WICKING ALLOWED.

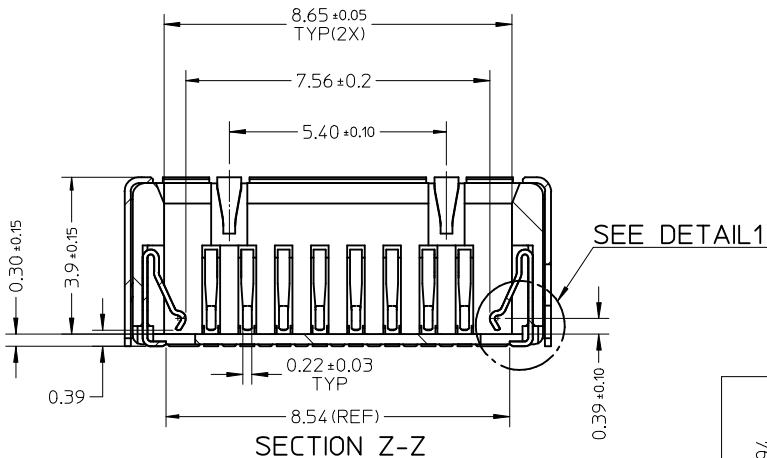
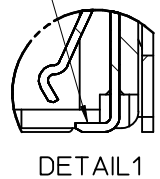

NOTES:

- MATERIALS
HOUSING: LCP, BLACK, UL94 V-0
TERMINAL: COPPER ALLOY.
SHELL: SEE CHART.
- FINISH
TERMINAL: 2-4 MICROMETER NICKEL UNDERPLATING OVERALL,
GOLD PLATING 0.3 MICROMETER ON CONTACT AREA,
GOLD FLASH PLATING ON SOLDER AREA.
SHELL:SEE CHART.
- PRODUCT SPECIFICATION: PS-105028-001
- PAKAGING: TAPE&REEL
- COPLANALITY TO BE 0.08MM MAX.
- APPLICABLE CAMERA MODULE SEE SHEET 3.

P/N	SHELL MATERIAL	SHELL FINISH
1050280010	NICKEL SILVER	NON PLATED
1050280001	COPPER ALLOY	GOLD FLASH ON SOLDERING AREA OVER 127 MICRON MIN. NICKEL UNDER PLATING

RELEASE
EC NO: SHZ009-0694
DRW:WFDENG
CHKD:WFDENG
APPR:
A

DATE: 2009/05/07
DATE: 2009/05/08

QUALITY SYMBOLS	DESCRIPTION
▽=0	
∇=0	

GENERAL TOLERANCES (UNLESS SPECIFIED)		DIMENSION STYLE	
mm	INCH	MM ONLY	
4 PLACES ± ---	± ---	DRAWN BY	DATE
3 PLACES ± ---	± ---	PATRICK CHU	2007/06/16
2 PLACES ± 0.10	± ---	CHECKED BY	DATE
1 PLACE ± 0.15	± ---	YLZHU	2007/06/16
ANGULAR ± 1°		APPROVED BY	DATE
		HWWANG	2007/06/16
DRAFT WHERE APPLICABLE MUST REMAIN WITHIN DIMENSIONS		MATERIAL NO.	
		1050280001	

SCALE	DESIGN UNITS	THIRD ANGLE PROJECTION	
8:1	METRIC		
TITLE			
8.5*8.5 CAMERA SOCKET SIDE CONTACT TYPE TOP MOUNT			
MOLEX INCORPORATED		DOCUMENT NO.	
		SD-105028-001	
			SHEET NO.
			1 OF 3

10 9 8 7 6 5 4 3 2 1

F

E

D

C

B

A

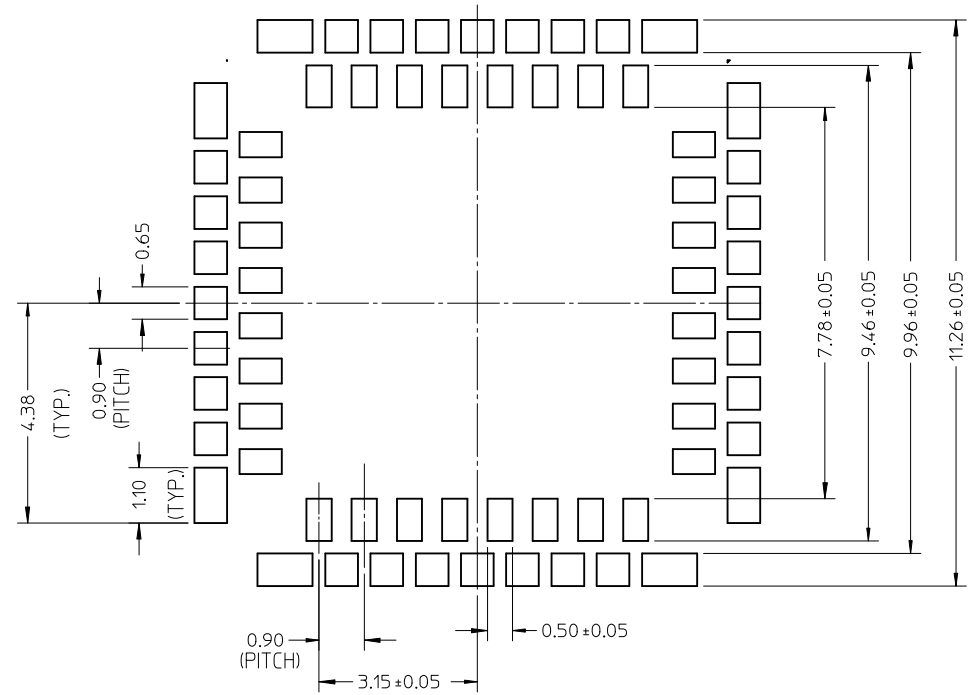

RECOMMENDED PCB LAYOUT
TOLERANCE ±0.05 MM

PROPOSAL EC NO: SH2009-0694 DRW: WFDENG 2009/05/07 CHK: WFDENG 2009/05/08 APPR:	QUALITY SYMBOLS ▽=0 ◻=0	GENERAL TOLERANCES (UNLESS SPECIFIED)		DIMENSION STYLE MM ONLY	SCALE 10:1	DESIGN UNITS METRIC	THIRD ANGLE PROJECTION	
	DESCRIPTION REV:	mm INCH	DRAWN BY PATRICK CHU	DATE 2007/06/16	TITLE 8.5*8.5 CAMERA SOCKET SIDE CONTACT TYPE TOP MOUNT			
		4 PLACES ± --- ± --- 3 PLACES ± --- ± --- 2 PLACES ± 0.10 ± --- 1 PLACE ± 0.15 ± ---	CHECKED BY YLZHU	DATE 2007/06/16	MOLEX INCORPORATED			
		ANGULAR ± 1°	APPROVED BY HWANG	DATE 2007/06/16	MATERIAL NO. 1050280001	DOCUMENT NO. SD-105028-001	SHEET NO. 2 OF 3	
DRAFT WHERE APPLICABLE MUST REMAIN WITHIN DIMENSIONS		SIZE A3	THIS DRAWING CONTAINS INFORMATION THAT IS PROPRIETARY TO MOLEX INCORPORATED AND SHOULD NOT BE USED WITHOUT WRITTEN PERMISSION					

9 8 7 6 5 4 3 2 1

APPLIED CAMERA MODULE

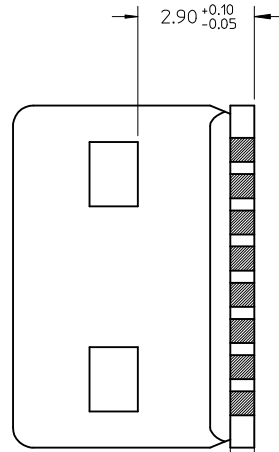
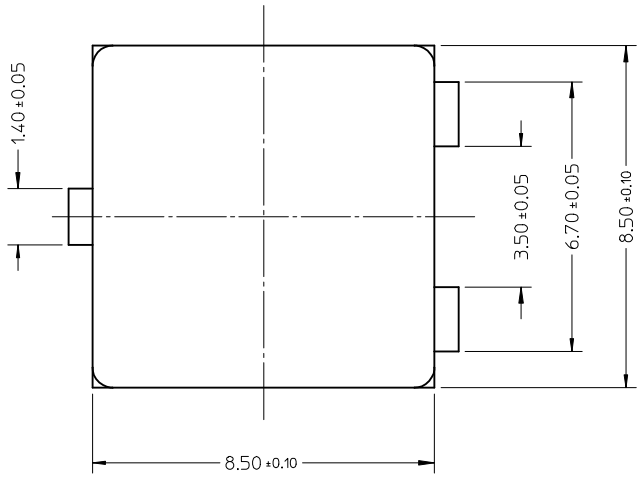

PTH THICKNESS
IN CONTACT AREA

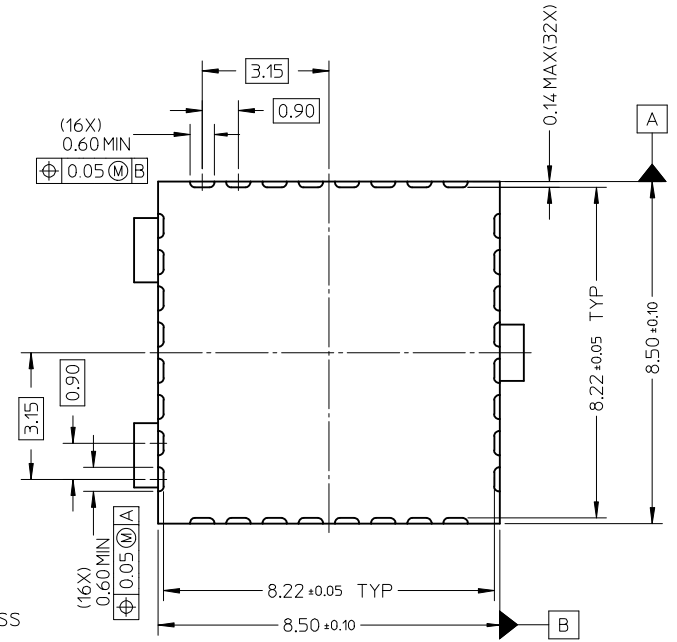

FOR PCB (PTH)

PROPOSAL EC NO: SHZ009-0694 DRW:WFDENG 2009/05/07 CHK:DWFENG 2009/05/08 APPR:HWANG 2009/05/11	DESCRIPTION REV	QUALITY SYMBOLS ▽=0 ◻=0	GENERAL TOLERANCES (UNLESS SPECIFIED)		DIMENSION STYLE MM ONLY		SCALE 8:1	DESIGN UNITS METRIC	THIRD ANGLE PROJECTION	
			4 PLACES ± --- ± --- 3 PLACES ± --- ± --- 2 PLACES ± 0.10 ± --- 1 PLACE ± 0.15 ± ---	mm INCH ± --- ± --- ± 0.10 ± --- ± 0.15 ± ---	DRAWN BY PATRICK CHU	DATE 2007/06/16	TITLE 8.5*8.5 CAMERA SOCKET SIDE CONTACT TYPE TOP MOUNT			
			ANGULAR ± 1°	DRAFT WHERE APPLICABLE MUST REMAIN WITHIN DIMENSIONS	CHECKED BY YLZHU	DATE 2007/06/16	APPROVED BY HWANG			
					MATERIAL NO. 1050280001	DATE 2007/06/16	MOLEX INCORPORATED		DOCUMENT NO. SD-105028-001	SHEET NO. 3 OF 3

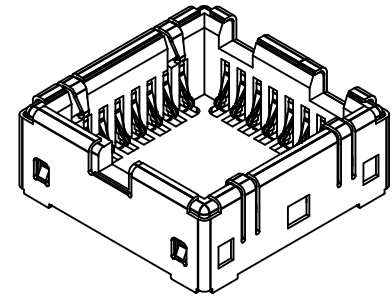
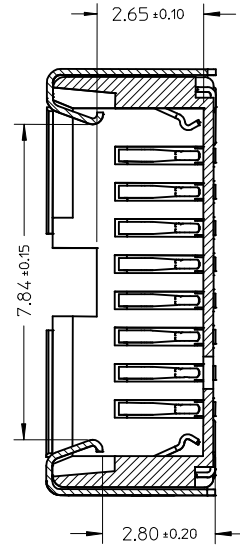
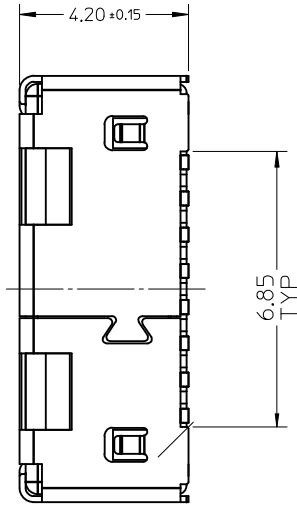
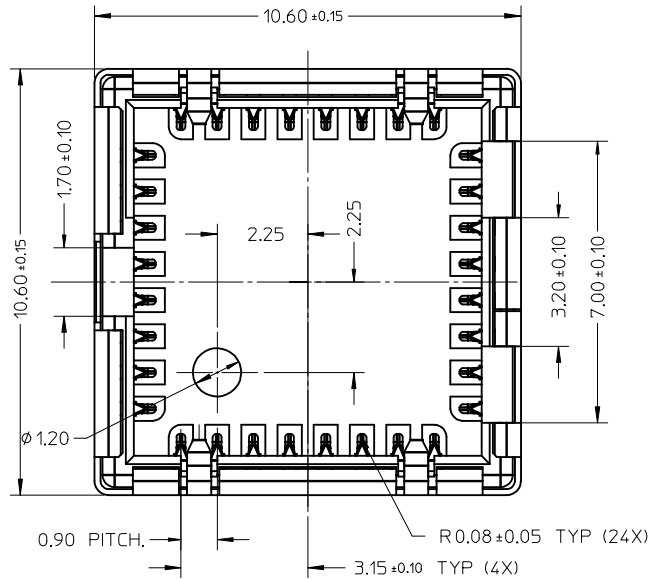

SECTION X-X

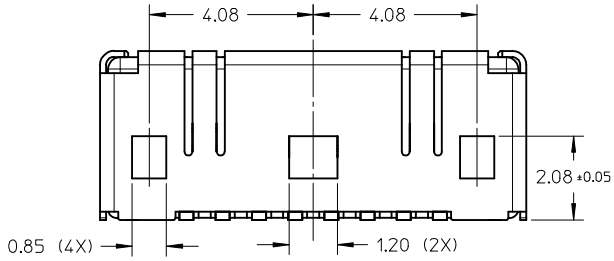

NO SOLDER PASTE
AND WICKING ALLOWED.

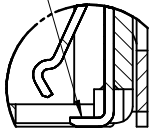

DETAIL 1

NOTES:

1. MATERIALS
HOUSING: LCP, BLACK, UL94 V-0
TERMINAL: COPPER ALLOY.
SHELL: COPPER ALLOY
2. FINISH
TERMINAL: 2-4 MICROMETER NICKEL UNDERPLATING OVERALL,
GOLD PLATING 0.3 MICROMETER ON CONTACT AREA,
GOLD FLASH PLATING ON SOLDER AREA.
SHELL: SEE THE TABLE OF PAGE 2
3. PAKAGING: TAPE&REEL
4. COPLANALITY TO BE 0.08MM MAX.
5. APPLICABLE CAMERA MODULE SEE SHEET 3.

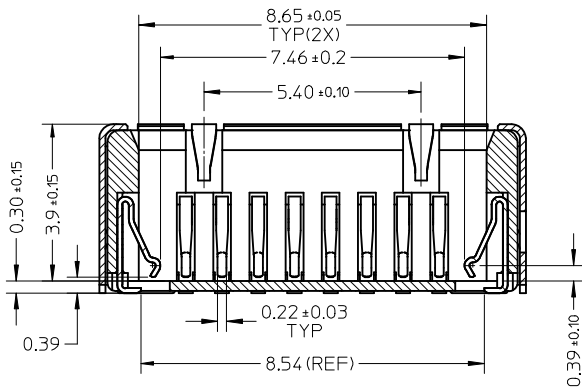

SECTION Z-Z

ADD PLATING TYPE EC NO: SH2015-0274 DRWN: JHU0 2015/01/14 CHKD: APPR: AYIN 2015/04/08 REV	QUALITY SYMBOLS	GENERAL TOLERANCES (UNLESS SPECIFIED)		DIMENSION STYLE MM ONLY		SCALE 8:1	DESIGN UNITS METRIC	THIRD ANGLE PROJECTION	
	$F_{\sigma} = 0$	mm	INCH	DRAWN BY	DATE	TITLE			
	$F_{\sigma} = 0$	4 PLACES ± --- ± ---	ERIC CHENG	2009/07/15	8.5*8.5 CAMERA SOCKET				
	$F_{\sigma} = 0$	3 PLACES ± --- ± ---	CHECKED BY	DATE	SIDE CONTACT TYPE				
	$F_{\sigma} = 0$	2 PLACES ± 0.10 ± ---	WFDENG	2009/07/15	TOP MOUNT				
	1 PLACE ± 0.15 ± ---	APPROVED BY	DATE	MATERIAL NO.		DOCUMENT NO.		SHEET NO.	
	0 PLACE ± --- ± ---	WFDENG	2009/07/15	SEE TABLE		SD-105028-301		1 OF 3	
DRAFT WHERE APPLICABLE MUST REMAIN WITHIN DIMENSIONS		ANGULAR ± 1 °		THIS DRAWING CONTAINS INFORMATION THAT IS PROPRIETARY TO MOLEX INCORPORATED AND SHOULD NOT BE USED WITHOUT WRITTEN PERMISSION					

10 9 8 7 6 5 4 3 2 1

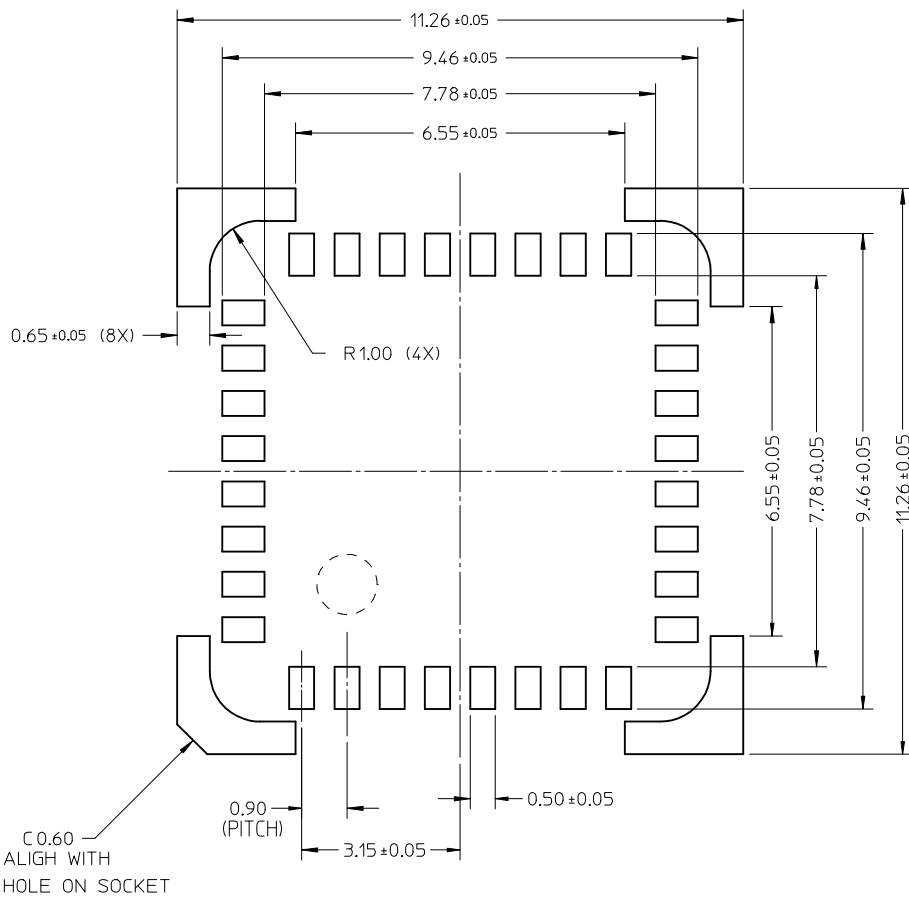

RECOMMENDED PCB LAYOUT
TOLERANCE ±0.05 MM

OPTION	PART NO.	PLATING SPECIFICATION
1	1050283001	1.27 MICRON MIN NICKEL UNDERPLATING OVERALL GOLD FLASH ON SOLDERING AREA
2	1050283011	1.27 MICRON MIN NICKEL UNDERPLATING OVERALL 1.5 MICRON MIN MATTE TIN ON SOLDERING AREA
3	1050283021	1.27 MICRON MIN SOLDERABILITY NICKEL OVERALL

SHELL PLATING TYPE

ADD PLATING TYPE EC NO: SH2015-0274 DRWN: JRU0 2015/01/14 CHKD: APPR: AYIN 2015/04/08	QUALITY SYMBOLS $F_{\Delta} = 0$ $F_{\square} = 0$ $F_{\square} = 0$	GENERAL TOLERANCES (UNLESS SPECIFIED) <table border="1"> <thead> <tr> <th></th> <th>mm</th> <th>INCH</th> </tr> </thead> <tbody> <tr> <td>4 PLACES</td> <td>± ---</td> <td>± ---</td> </tr> <tr> <td>3 PLACES</td> <td>± ---</td> <td>± ---</td> </tr> <tr> <td>2 PLACES</td> <td>± 0.10</td> <td>± ---</td> </tr> <tr> <td>1 PLACE</td> <td>± 0.15</td> <td>± ---</td> </tr> <tr> <td>0 PLACE</td> <td>± ---</td> <td>± ---</td> </tr> </tbody> </table>		mm	INCH	4 PLACES	± ---	± ---	3 PLACES	± ---	± ---	2 PLACES	± 0.10	± ---	1 PLACE	± 0.15	± ---	0 PLACE	± ---	± ---	DIMENSION STYLE MM ONLY	SCALE 10:1	DESIGN UNITS METRIC	THIRD ANGLE PROJECTION
		mm	INCH																					
	4 PLACES	± ---	± ---																					
	3 PLACES	± ---	± ---																					
2 PLACES	± 0.10	± ---																						
1 PLACE	± 0.15	± ---																						
0 PLACE	± ---	± ---																						
DESCRIPTION REV C	ANGULAR ± 1 ° DRAFT WHERE APPLICABLE MUST REMAIN WITHIN DIMENSIONS	DRAWN BY ERIC CHENG	DATE 2009/07/15	TITLE 8.5*8.5 CAMERA SOCKET SIDE CONTACT TYPE TOP MOUNT																				
		CHECKED BY WFDENG	DATE 2009/07/15	molex																				
		APPROVED BY WFDENG	DATE 2009/07/15	MATERIAL NO. SEE TABLE	DOCUMENT NO. SD-105028-301	SHEET NO. 2 OF 3																		

9 8 7 6 5 4 3 2 1

APPLIED CAMERA MODULE

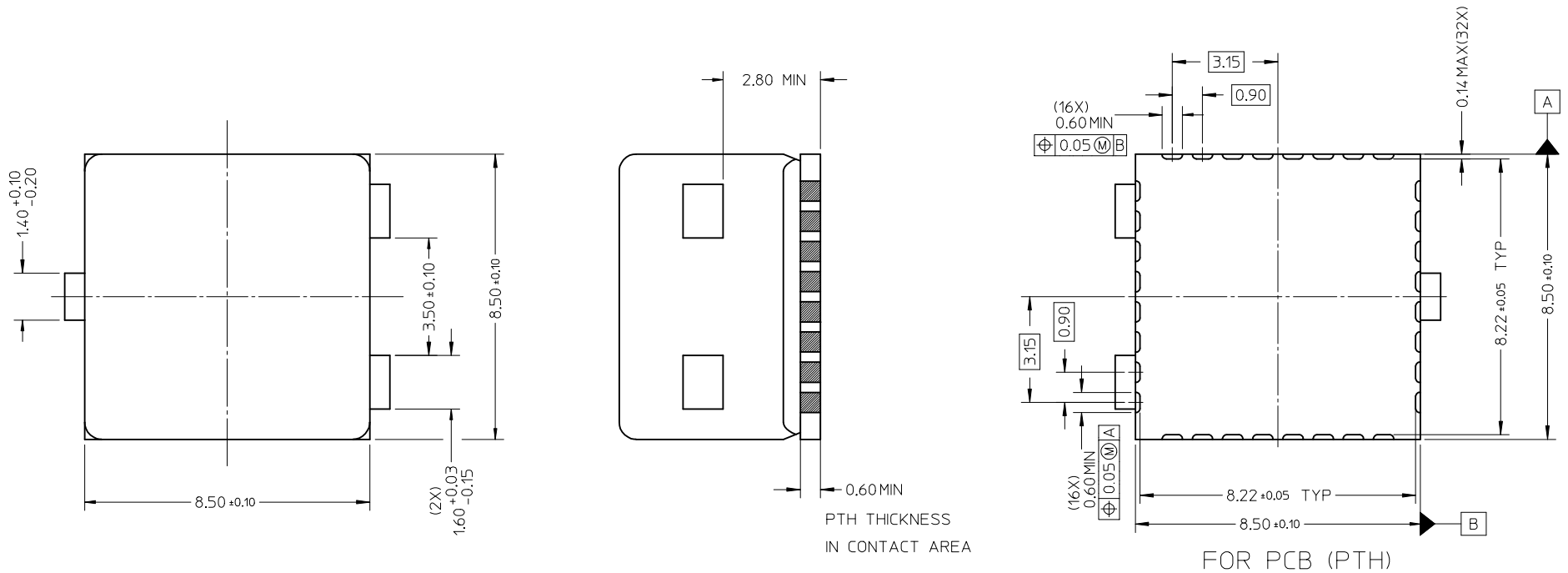

ADD PLATING TYPE EC NO: SH2015-0274 DRW:WJHUO 2015/01/14 CHKD: APPR:AYIN 2015/04/08	QUALITY SYMBOLS	GENERAL TOLERANCES (UNLESS SPECIFIED)		DIMENSION STYLE MM ONLY		SCALE 8:1	DESIGN UNITS METRIC	THIRD ANGLE PROJECTION
	$F_{\Delta} = 0$	mm	INCH	DRAWN BY	DATE	TITLE		
	$F_{\square} = 0$	4 PLACES ± ---	± ---	ERIC CHENG	2009/07/15	8.5*8.5 CAMERA SOCKET SIDE CONTACT TYPE TOP MOUNT		
	$F_{\nabla} = 0$	3 PLACES ± ---	± ---	CHECKED BY	DATE			
$F_{\circ} = 0$	2 PLACES ± 0.10	± ---	WFDENG	2009/07/15	molex			
	1 PLACE ± 0.15	± ---	APPROVED BY	DATE				
	0 PLACE ± ---	± ---	WFDENG	2009/07/15	MATERIAL NO.		DOCUMENT NO.	SHEET NO.
		ANGULAR ± 1 °		SEE TABLE		SD-105028-301		3 OF 3
		DRAFT WHERE APPLICABLE MUST REMAIN WITHIN DIMENSIONS		SIZE A3		THIS DRAWING CONTAINS INFORMATION THAT IS PROPRIETARY TO MOLEX INCORPORATED AND SHOULD NOT BE USED WITHOUT WRITTEN PERMISSION		