

PART NUMBER 10125705-001LF

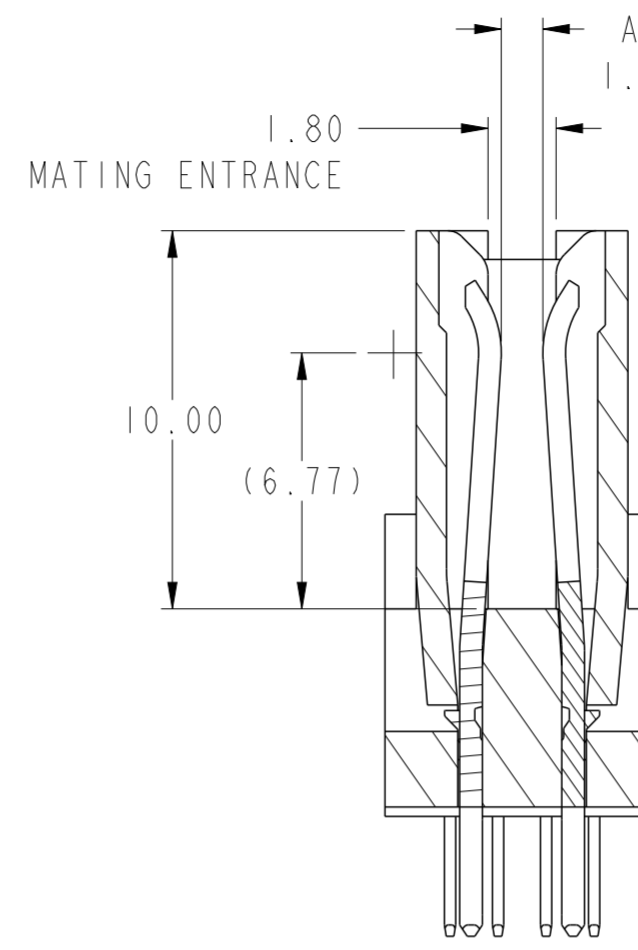

SECTION C-C

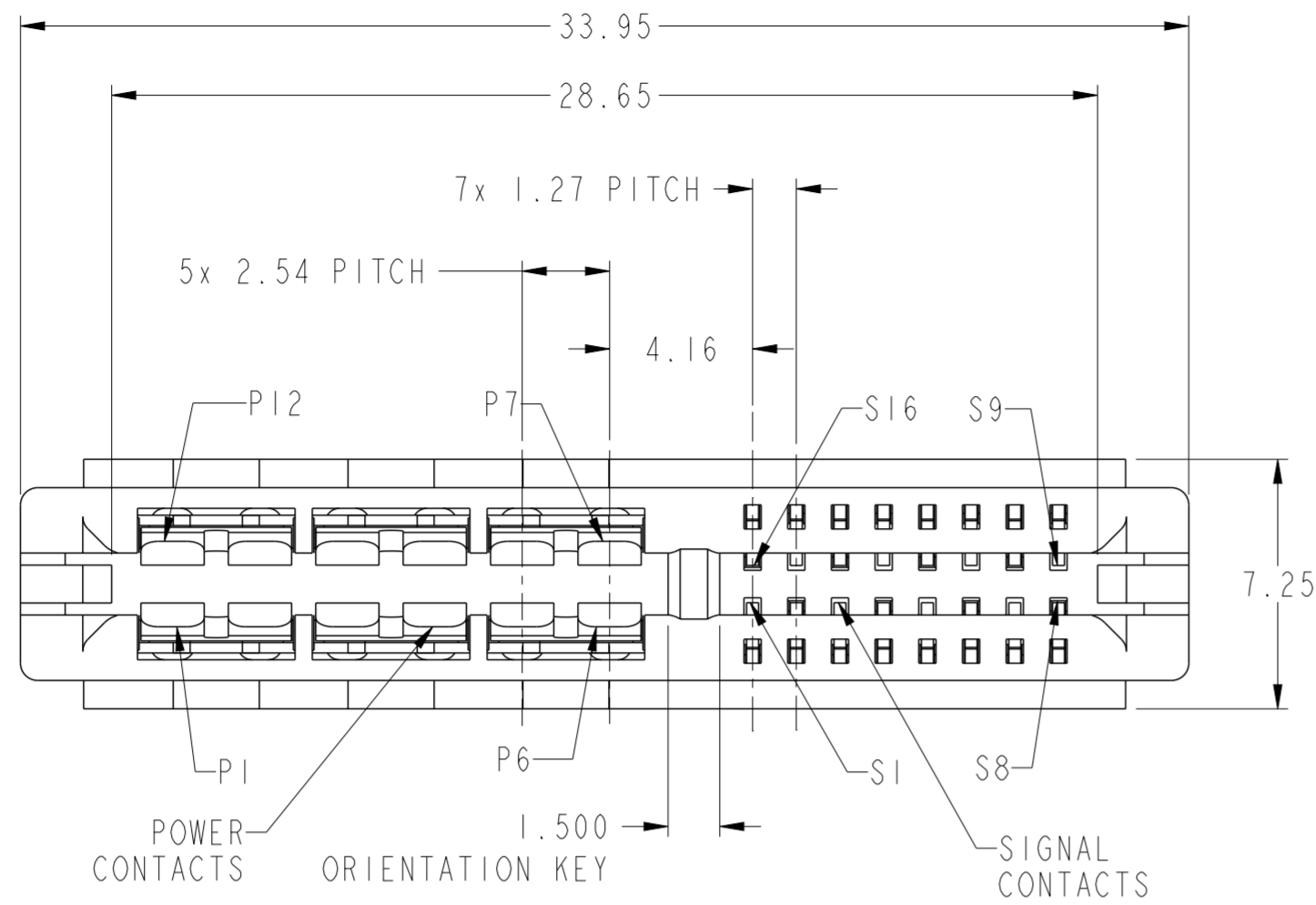
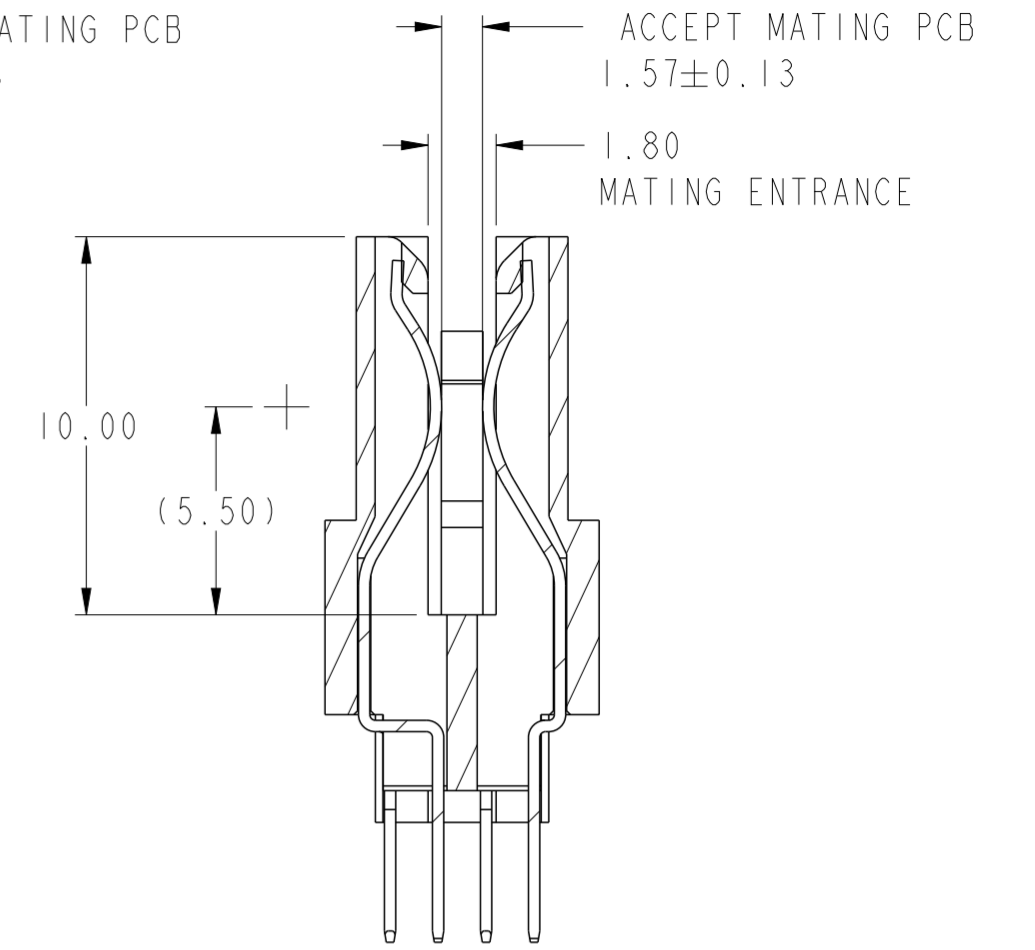

SECTION D-D

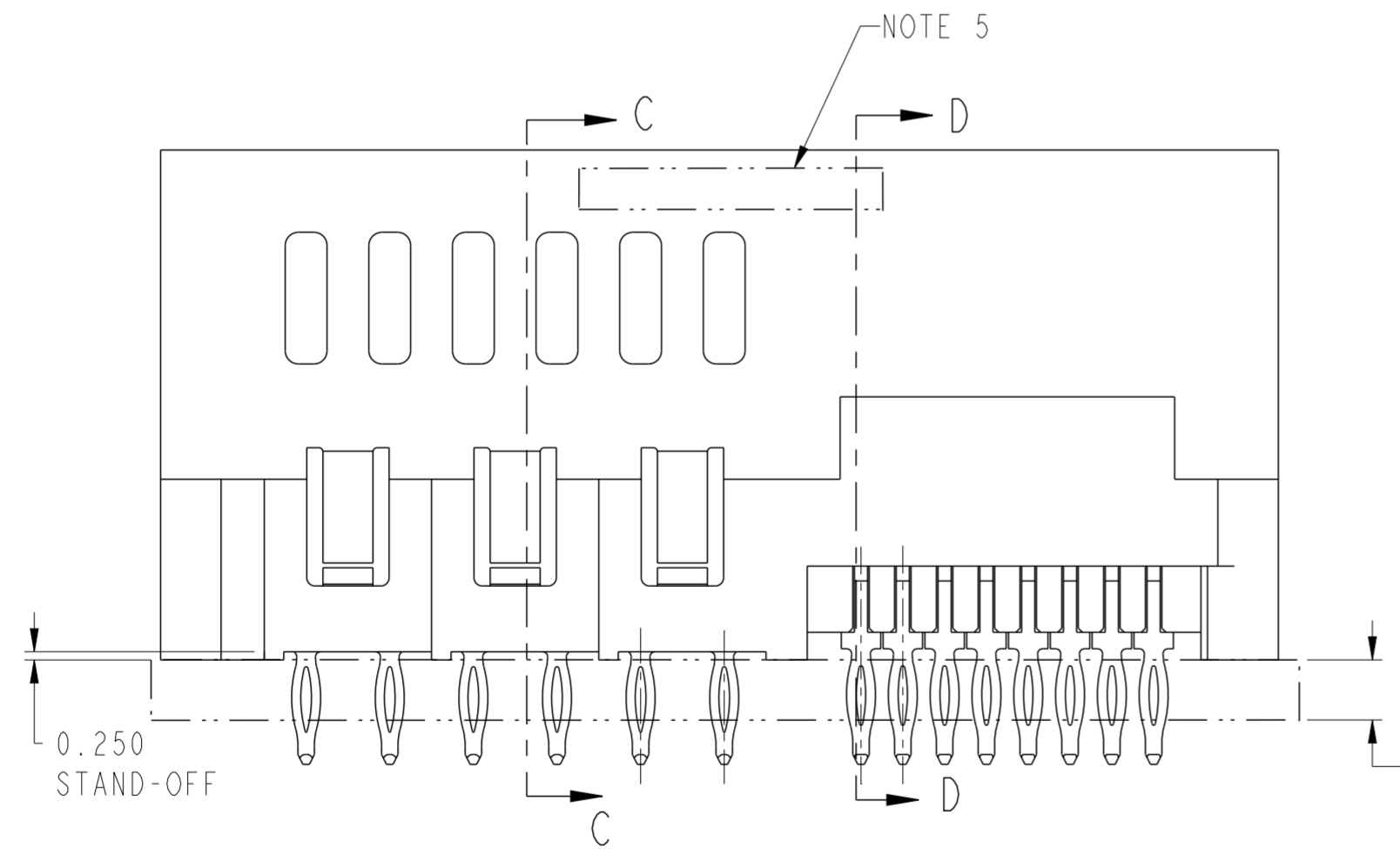

RECOMMENDED BOARD THICKNESS  
1.57 MIN (PRESS-FIT)

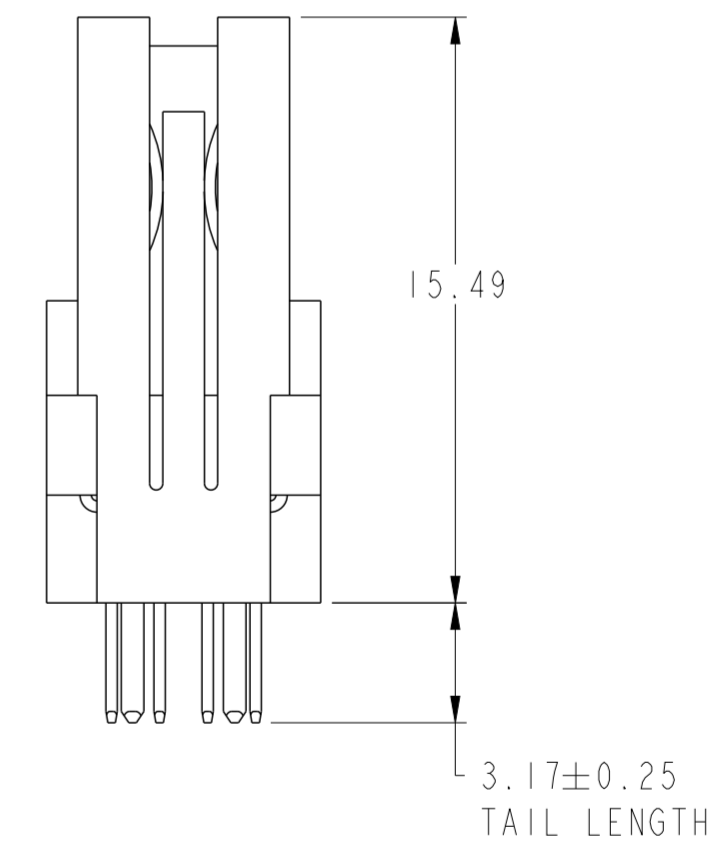

spec ref	-	dr	Jackie Huang	2014/10/31	projection	mm	size	A2	scale	5:1
tolerance std	ISO 406 ISO 1101	eng	Sunny2 Liu	2016/04/12		mm	ecn no	ELX-DG-22934-1	rel level	Released
TOLERANCES UNLESS OTHERWISE SPECIFIED		chr	Terris Liu	2016/05/20						
surface	ASME Y14.5	appr	Pai-Ming Zheng	2016/05/24	VERT RECP (12P 16S) MEZZANINE HPCE		cat. no.	10125705	rev	B
linear	0.X ±0.5 0.XX ±0.25 0.XXX ±0.10	Amphenol FCI		Product - Customer Drw		sheet 1 of 3				
angular	0° ±2°	PDS: Rev :B		STATUS:Released		Printed: May 24, 2016				

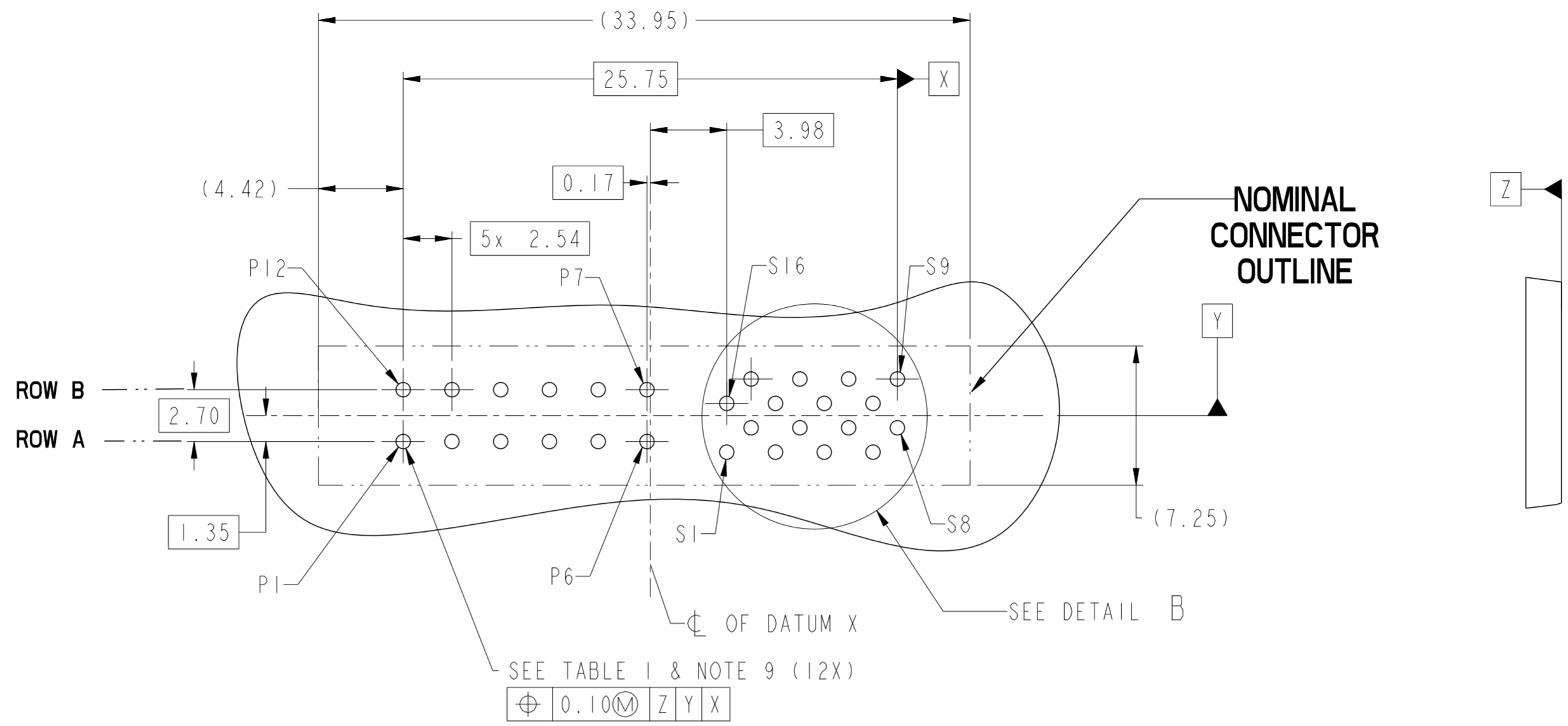

**RECOMMENDED PCB LAYOUT  
VIEWED FROM CONNECTOR SIDE**

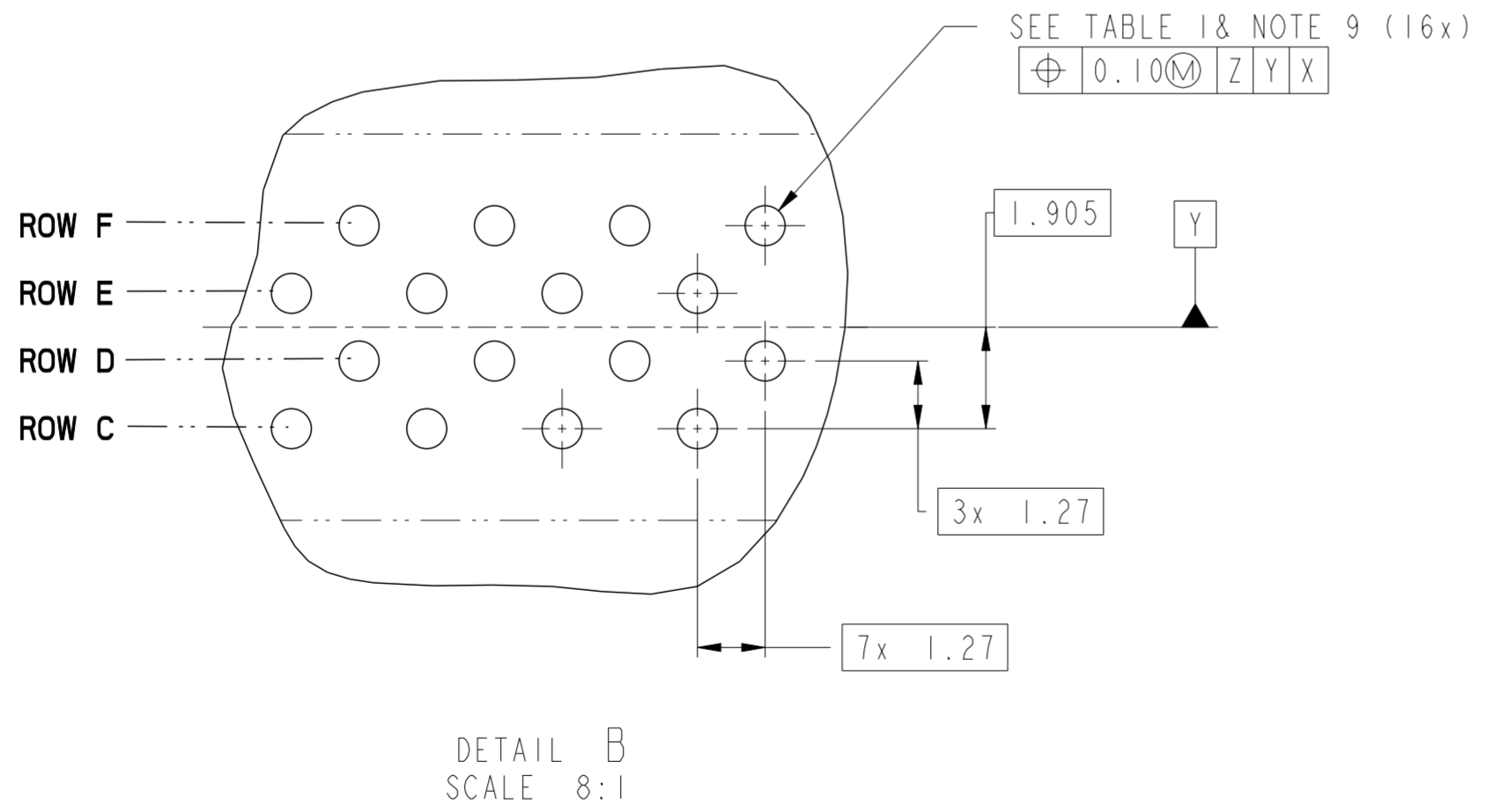
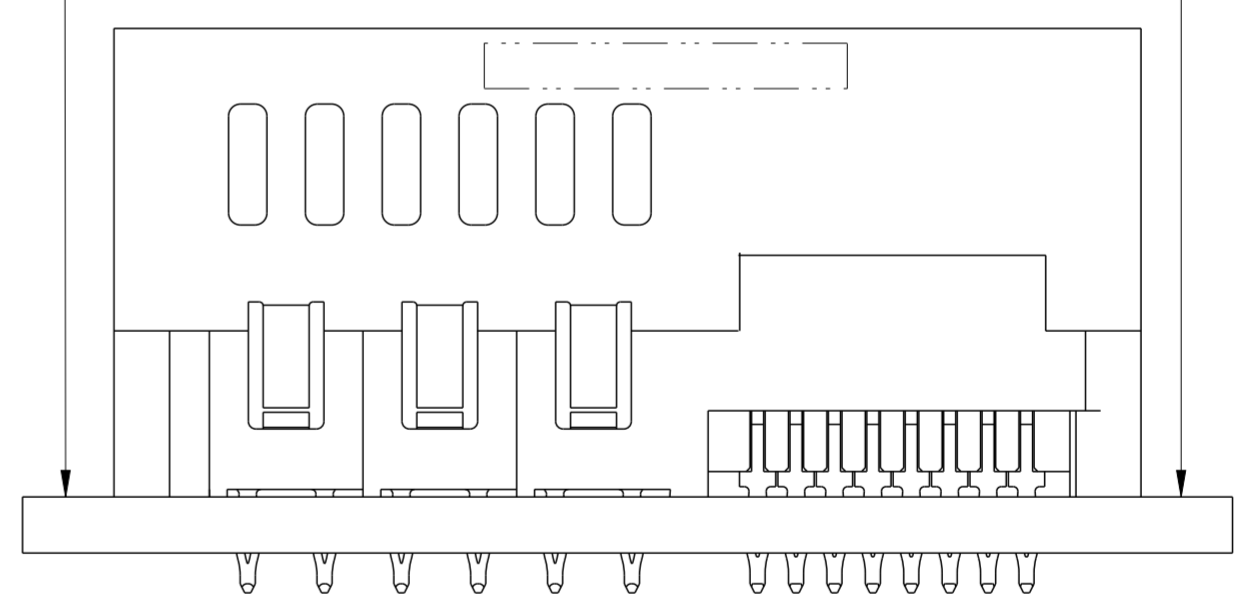

spec ref	-	dr	Jackie Huang	2014/10/31	projection	mm	size	A2	scale	2:1
tolerance std	ISO 406 ISO 1101	eng	Sunny2 Liu	2016/04/12			ecn no	ELX-DG-22934-1		
TOLERANCES UNLESS OTHERWISE SPECIFIED		chr	Terris Liu	2016/05/20			rel level	Released		
surface	ASME Y14.5	appr	Pei-Ming Zheng	2016/05/24	product family	-	rel level	Released		
linear	0.X ±0.5 0.XX ±0.25 0.XXX ±0.10	Amphenol FCI		title	VERT RECP (12P 16S) MEZZANINE HPCE		dwg no	10125705		
angular	0° ±2°	Amphenol FCI		cat. no.	-	Product - Customer Drw	sheet 2 of 3	rev B		

CONTACT TYPE	TOP LAYER DESCRIPTION	TABLE 1 (HPCE / PRESS-FIT TAILS) PLATED THROUGH-HOLE REQUIREMENTS				
		DRILLED HOLE DIAMETER	COPPER THICKNESS	TIN-LEAD THICKNESS	TIN THICKNESS	FINISHED HOLE DIAMETER
POWER & SIGNAL	TIN-LEAD	0.81-0.86 (0.85 DRILL)	0.025 - 0.050	0.005 - 0.015	--	0.65 - 0.80
	IMMERSION TIN	0.81-0.86 (0.85 DRILL)	0.025 - 0.050	--	0.9 - 1.5um	0.70 - 0.80
	COPPER (SEE NOTE 8)	0.81-0.86 (0.85 DRILL)	0.025 - 0.050	--	--	0.70 - 0.80

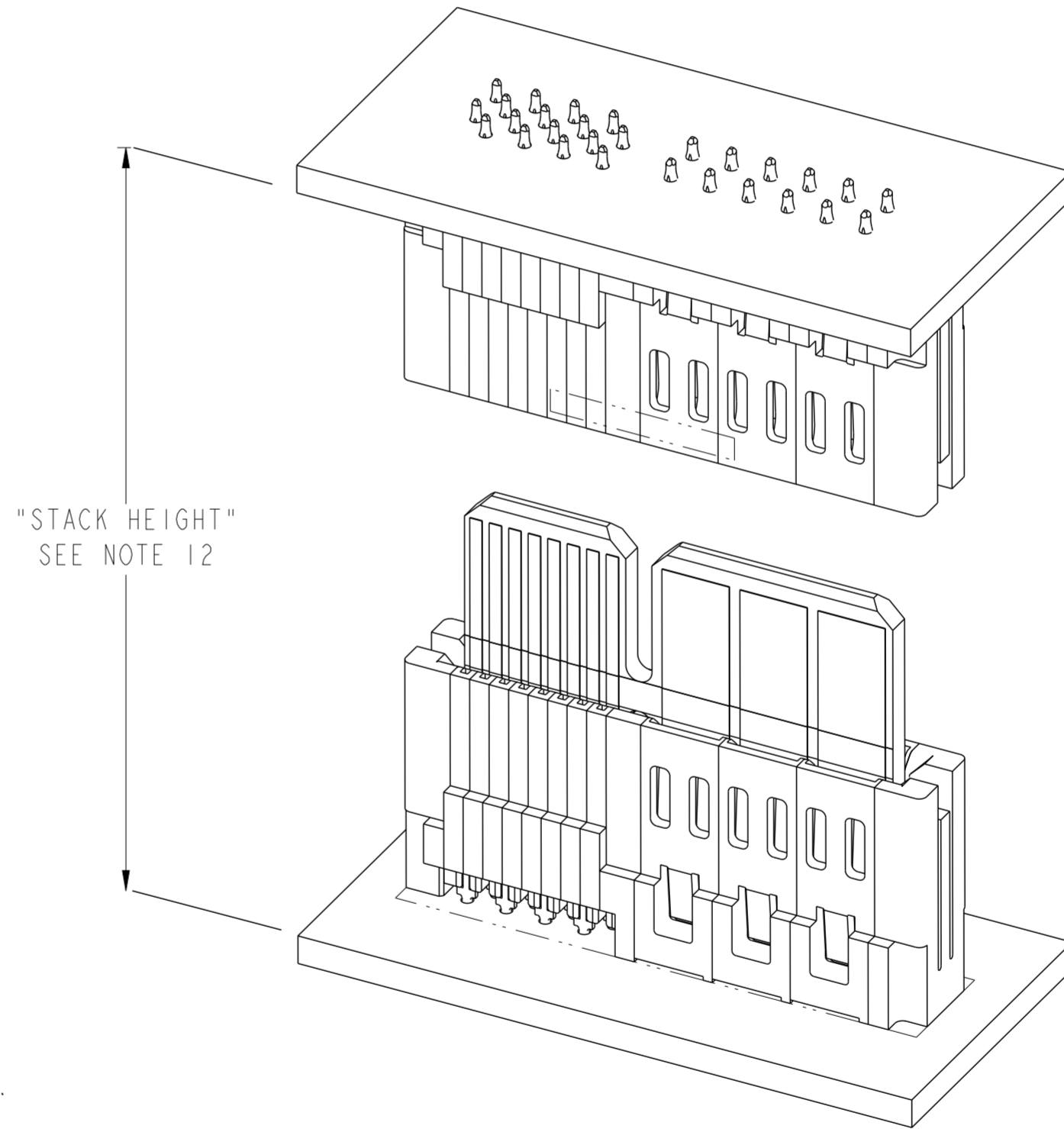

NOTES:

- CONNECTOR MATERIALS:  
 HOUSING: HIGH TEMPERATURE THERMAL PLASTIC, BLACK  
 UL 94V-0 COMPLIANT  
 CONTACTS: HIGH PERFORMANCE COPPER ALLOY.
- CONTACT FINISH REF. GS-12-604 SECTION 5.2.
- PRODUCT SPECIFICATION: GS-12-1261.
- APPLICATION SPECIFICATION: GS-20-128.
- PRODUCT MARKING ON HOUSING IN AREA SHOWN MEETS AFCI SPECIFICATION: GS-24-007.
- PACKAGING MEETS FCI SPECIFICATION GS-14-937.
- HOUSING COMPONENT WILL WITHSTAND EXPOSURE TO 260°C PEAK TEMPERATURE FOR 60 SECONDS IN A CONVECTION, INFRA-RED, OR VAPOR PHASE REFLOW OVEN.
- COPPER PLATING THICKNESS IN CENTER OF VIA-HOLE CAN BE NO MORE THAN 0.003 LESS THAN OTHER AREAS.
- ALL HOLE SIZES ARE FINISHED HOLE SIZES.
- INTENDED USE: TWO ASSEMBLIES (P/N 10122776) MEZZANINE STACKED USING PCB TO CONTROL STACK HEIGHT.  
 DIM "L" + 10.98mm = FINAL MEZZANINE STACK HEIGHT.  
 DIM "L" RANGES FROM 21.02-31.02 mm IN 1 mm INCREMENTS.
- SEE DRAWING 10125707 FOR MATING PCB DETAIL
- A SYMBOL  $\triangle$  WILL BE NEXT TO ANY DIMENSION, VIEW, OR NOTE WHICH HAS BEEN MODIFIED WITH THE CURRENT DRAWING REVISION.

spec ref	-	dr	Jackie Huang	2014/10/31	projection	mm	size	A2	scale	1:1
tolerance std	ISO 406 ISO 1101	eng	Sunny2 Liu	2016/04/12			ecn no	ELX-DG-22934-1		
TOLERANCES UNLESS OTHERWISE SPECIFIED		chr	Terris Liu	2016/05/20			rel level	Released		
surface	linear	0.X	±0.5	apppr	Pai-Ming Zheng	2016/05/24	product family	-		
		0.XX	±0.25	Amphenol FCI		title	VERT RECP (12P 16S)		dwg no	10125705
		0.XXX	±0.10	MEZZANINE HPCE		rev	B		-	
ASME Y14.5	angular	0°	±2°	cat. no.	-		Product - Customer Drw	sheet 3 of 3		

Amphenol FCI

© 2016 AFCI