

RECOMMENDED HOLE LAYOUT FOR  
1.78(.070) MAX. THICK P.C. BOARD  
VIEWED FROM COMPONENT SIDE

NOTES:

1. MATERIAL:  
HOUSING: UNFILLED NYLON, 94V-2, NATURAL  
TERMINAL: BRASS ALLOY
2. FINISH:  
TERMINAL: .00090/(.000035) MIN. REFLOWED MATTE TIN PLATE OVER COPPER (PREPLATE)  
(FINISH IS BRIGHT IN APPEARANCE, THICKNESS AS APPLIED PRIOR TO REFLOW)
3. PRODUCT SPECIFICATION: PS-5556-001
4. PACKAGING SPECIFICATION: PK-43946-001
5. PART MATES WITH MINI-FIT JR. RECEPTACLE #5557.
6. PART IS DESIGNED FOR USE WITH #4 OR M3 SELF TAPPING SCREWS.
7. CONNECTOR ASSEMBLIES ARE NOT TO BE MATED OR UNMATED WHILE CIRCUITS ARE LIVE.
8. PART CONFORMS TO CLASS "B" REQUIREMENTS OF COSMETIC SPECIFICATION PS-45499-002.
9. TEXT ON PART IS FOR REFERENCE ONLY. TEXT AND TEXT LOCATION MAY VARY DEPENDING ON PART NUMBER AND/OR TOOL.

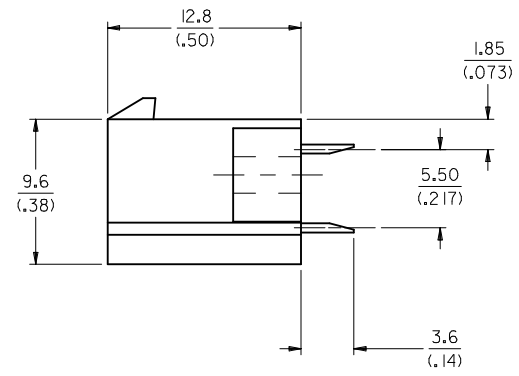

<b>UPDATE NOTE 2</b> EC NO: UCP2017-0446 DRAWN: SLAFTER 2016/08/26 CHKD: J.BELL 2016/08/25 APPR: FSMITH 2016/09/21	QUALITY SYMBOLS ▽=0 ▽=0 ▽=0	GENERAL TOLERANCES (UNLESS SPECIFIED)		DIMENSION STYLE <b>MM/IN</b>		SCALE <b>4:1</b>	DESIGN UNITS <b>METRIC</b>	THIRD ANGLE PROJECTION		
				DRAWN BY MBANDURA	DATE 1997/06/20	<b>MINI-FIT JR. 6 CIRCUIT VERTICAL HEADER ASSEMBLY WITH MOUNTING FLANGES</b>				
				CHECKED BY SMUELLER	DATE 1997/06/18					
				APPROVED BY FSMITH	DATE 2016/09/21	<b>molex</b>				
		ANGULAR ±1/2°		MATERIAL NO. <b>439460006</b>		DOCUMENT NO. <b>SD-43946-006</b>		SHEET NO. <b>1 OF 1</b>		
DRAFT WHERE APPLICABLE MUST REMAIN WITHIN DIMENSIONS				THIS DRAWING CONTAINS INFORMATION THAT IS PROPRIETARY TO MOLEX INCORPORATED AND SHOULD NOT BE USED WITHOUT WRITTEN PERMISSION						