

4

3

2

1

THIS DRAWING IS UNPUBLISHED.

RELEASED FOR PUBLICATION ,19 .

© COPYRIGHT 19

BY AMP INCORPORATED. ALL RIGHTS RESERVED.

LOC

DIST

REVISIONS

G

86

P

LTR

DESCRIPTION

DATE

DWN

APVD

D

REVISED & REDRAWN PER 0720-0856-96

21JUN96

DKS

WJV

STRAIGHT KNURL

5.61  
[.221]  
MAX DIA

21.46  
[.845]  
MAX

53853-2

AMP  
PART NUMBER

THIS DRAWING IS A CONTROLLED DOCUMENT FOR AMP INCORPORATED.  
IT IS SUBJECT TO CHANGE AND THE CONTROLLING ENGINEERING  
ORGANIZATION SHOULD BE CONTACTED FOR THE LATEST REVISION.

DWN DK SCHRUM 21JUN96

CHK WJ VOCKROTH 25JUN96

APVD JL MECKLEY 25JUN96

NAME

PRODUCT SPEC

APPLICATION SPEC

WEIGHT - lbs

CUSTOMER DRAWING

**AMP** AMP Incorporated  
Harrisburg, PA 17105-3608

PIN, QUICK-DISCONNECT,  
AMPOWER™

SIZE

CAGE CODE

DRAWING NO

A3

00779

C-53853

SCALE 5:1

SHEET 1 OF 1

REV D

DIMENSIONS:

mm [INCHES]

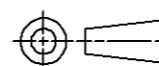

TOLERANCES UNLESS OTHERWISE SPECIFIED:

0 PLC ±-

1 PLC ±-

2 PLC ±0.20 [.008]

3 PLC ±-

4 PLC ±-

ANGLES ±-

MATERIAL  
BRASS  
PER QQ-B-626

FINISH SILVER PL  
0.00508 [.000200] MIN  
THK PER QQ-S-365