

Amphenol
FCi

© 2016 AFci

spec ref	-	dr	Wei-Long Zhang	2012/05/11	projection	MM	size	A2	scale	3:1	
tolerance std	ASME Y14.5	eng	Sunny2 Liu	2016/05/18		CARD EDGE	ecn no	ELX-DG-24036-1	rel level	Released	
TOLERANCES UNLESS OTHERWISE SPECIFIED		chr	Terris Liu	2016/05/20			rel level	Released			
surface	ASME Y14.5	appr	Pai-Ming Zheng	2016/05/24			cat. no.	-		Product - Customer Drw	sheet 1 of 4
linear	0.X ±0.3 0.XX ±0.1 0.XXX ±0.05	Amphenol FCi		TITLE		RECEPTACLE (16P-16S)		dwg no	10121046	rev	B
angular	0° ±2°										

PDS: Rev :B

STATUS:Released

Printed: May 24, 2016

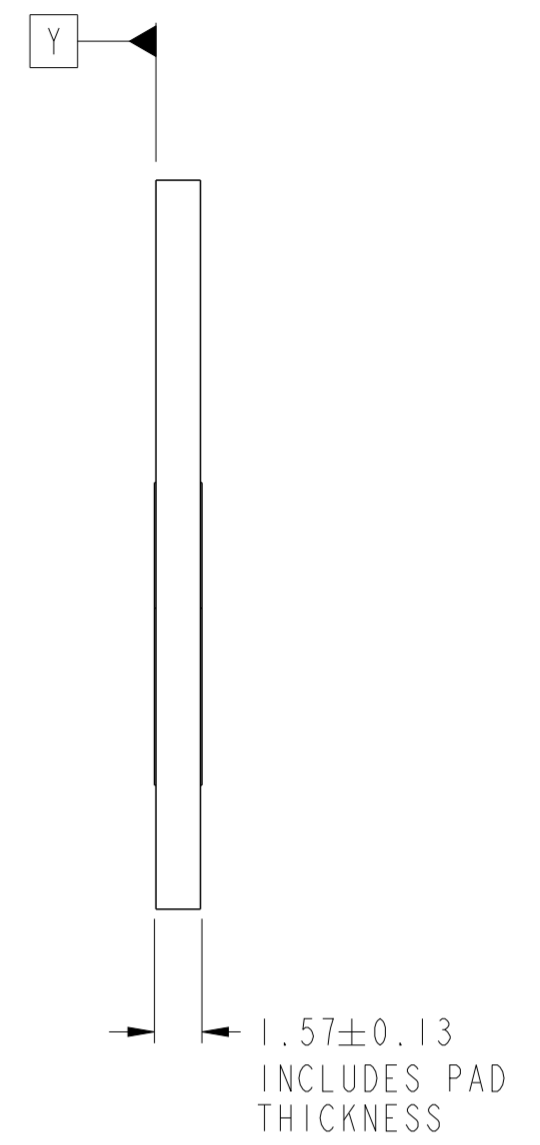
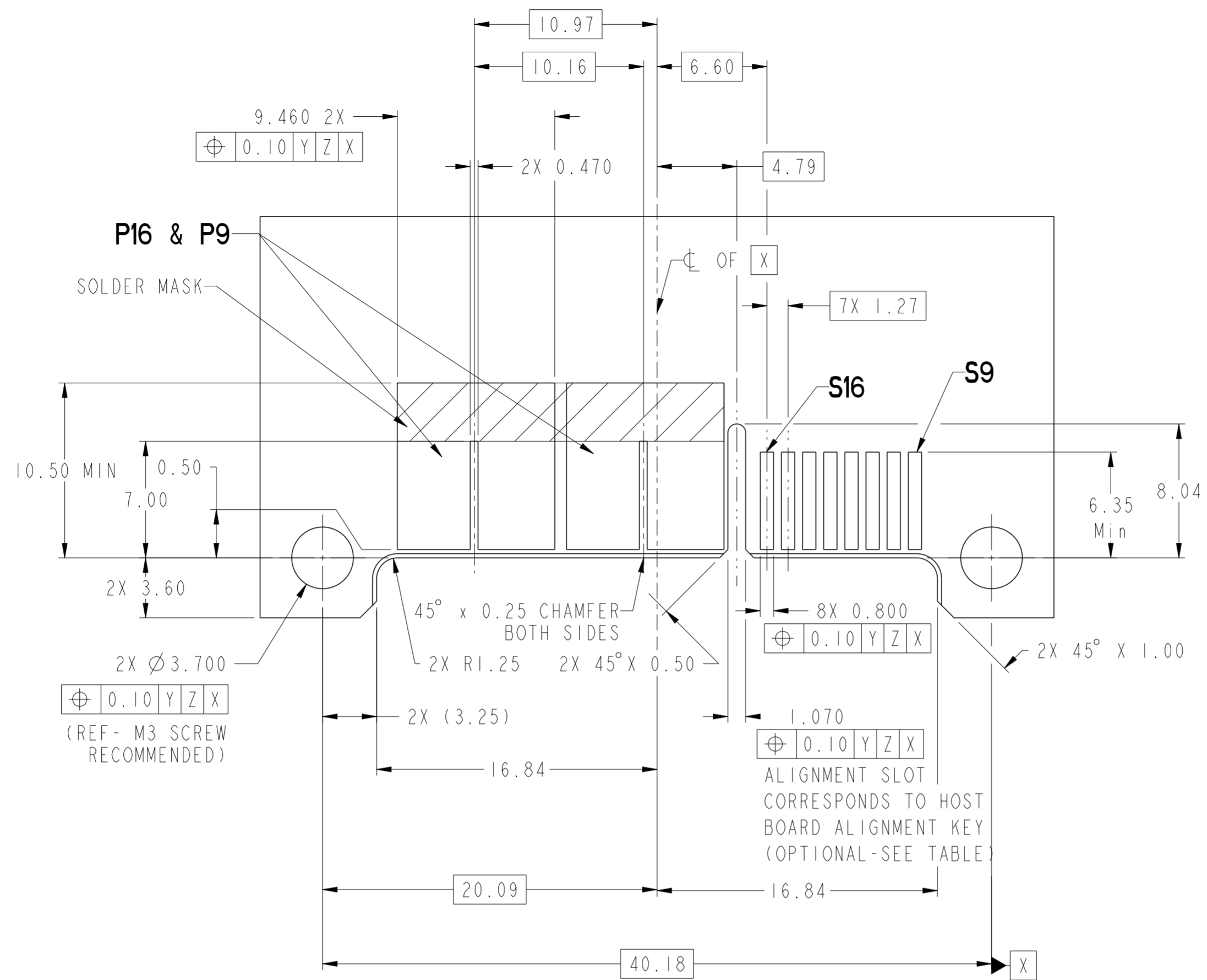

RECOMMENDED PCB LAYOUT AS VIEWED

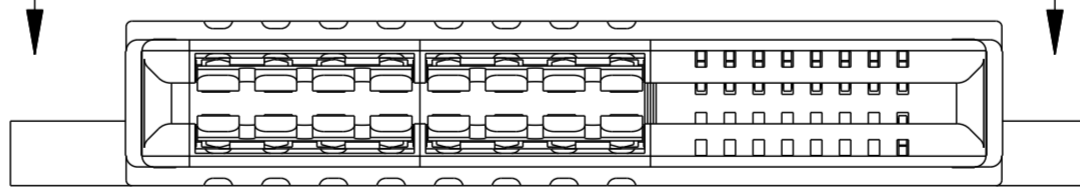

spec ref	-	dr	Wei-Long Zhang	2012/05/11	projection	MM	size	A2	scale	3:1				
tolerance std	ASME Y14.5	eng	Sunny2 Liu	2016/05/18			ecn no	ELX-DG-24036-1						
TOLERANCES UNLESS OTHERWISE SPECIFIED		chr	Terris Liu	2016/05/20			rel level	Released						
surface	linear	0.X	±0.3	0.XX			±0.1	0.XXX	±0.05	Amphenol FCI	title	RECEPTACLE (16P-16S)	cat. no.	-
ASME Y14.5	angular	0°	±2°	appr	Pai-Ming Zheng	2016/05/24	product family	CARD EDGE			rel level	Released		
										rev	B			
										dwg no	10121046			

PDS: Rev :B

STATUS:Released

Printed: May 24, 2016

Amphenol FCI

© 2016 AFCI

A

B

C

D

E

F

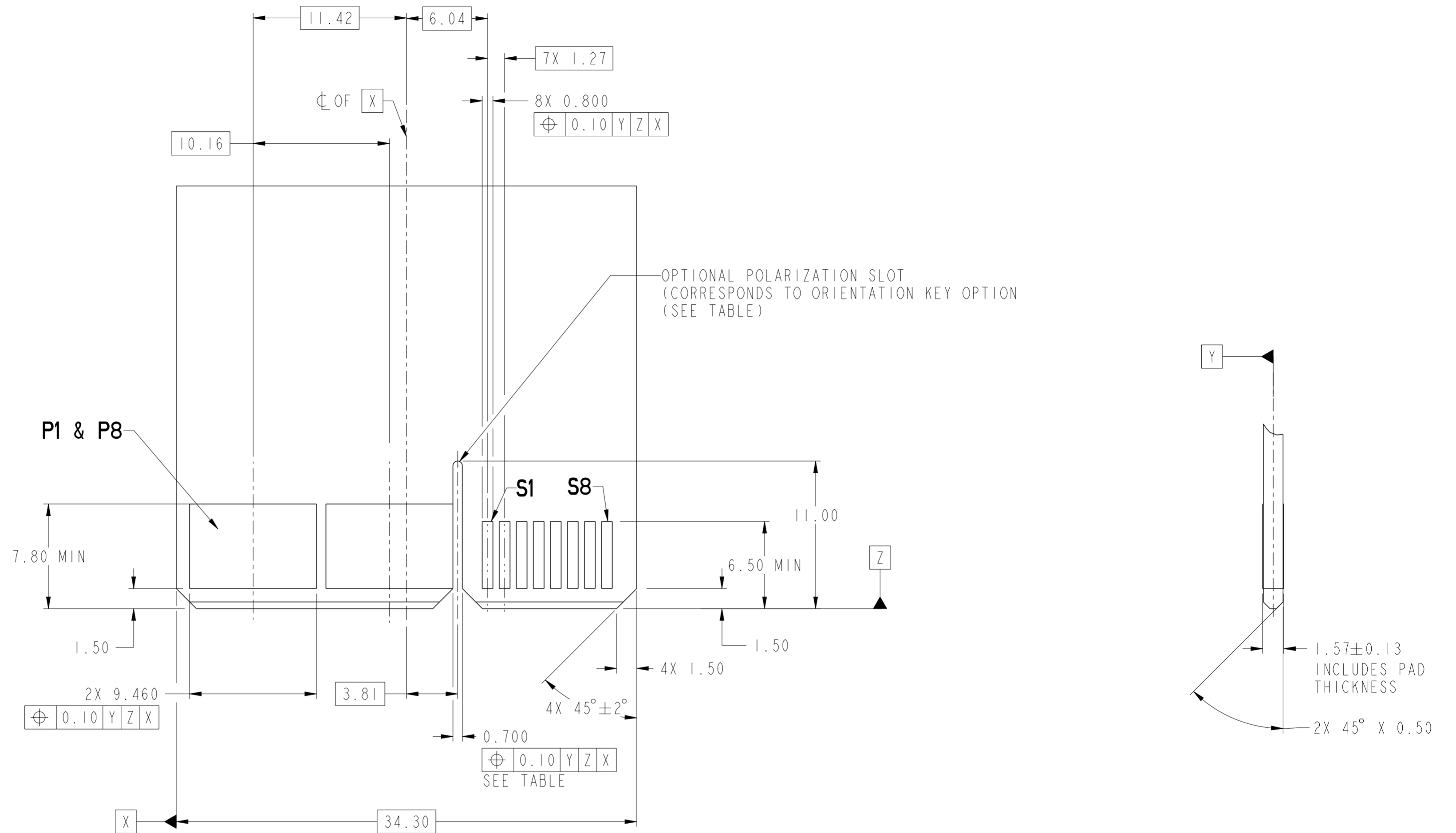

RECOMMENDED MATING BOARD FOOTPRINT

Amphenol FCI

© 2016 AFCl

spec ref	-	dr	Wei-Long Zhang	2012/05/11	projection	MM	size	A2	scale	1:1	
tolerance std	ASME Y14.5	eng	Sunny2 Liu	2016/05/18			ecn no	ELX-DG-24036-1	rel level	Released	
TOLERANCES UNLESS OTHERWISE SPECIFIED		chr	Terris Liu	2016/05/20							
		appr	Pai-Ming Zheng	2016/05/24							
surface	ASME Y14.5	linear	0.X	±0.3	0.XX	±0.1	0.XXX	±0.05	angular	0°	±2°
				RECEPTACLE (16P-16S) HPCE - (STRADDLE MOUNT)		cat. no.	-	Product - Customer Drw	sheet 3 of 4		
				title RECEPTACLE (16P-16S) HPCE - (STRADDLE MOUNT)		dwg no	10121046	rev	B		

PDS: Rev :B

STATUS:Released

Printed: May 24, 2016

PART NUMBER	FEATURE C HOST BOARD ALIGNMENT KEY (SEE NOTE 8)	FEATURE A MOUNTING EARS	FEATURE B FRONT POLARIZATION KEY
10121046-001LF	YES	YES	NO
10121046-002LF		YES	YES
10121046-003LF		NO	NO
10121046-004LF		NO	YES
10121046-005LF	NO	YES	NO
10121046-006LF		YES	YES
10121046-007LF		NO	NO
10121046-008LF		NO	YES

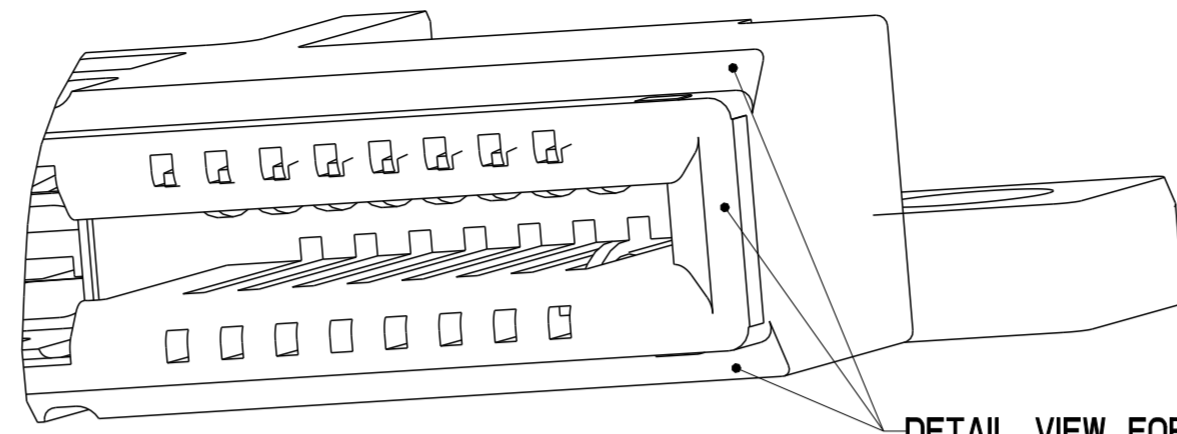

DETAIL VIEW FOR
AROUND ENHANCED WALL

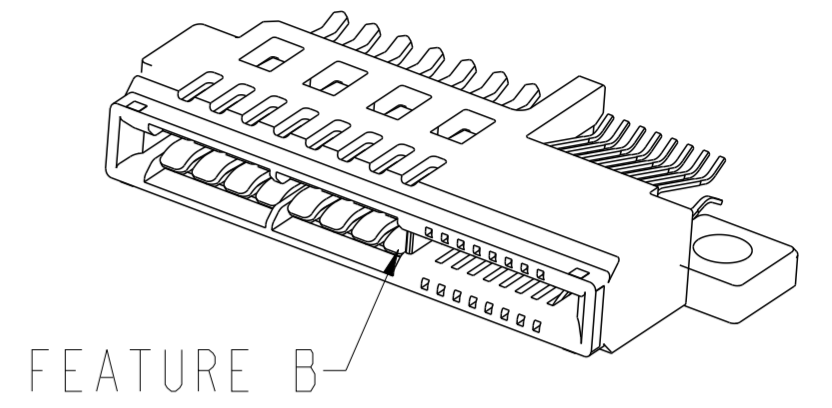

FEATURE B

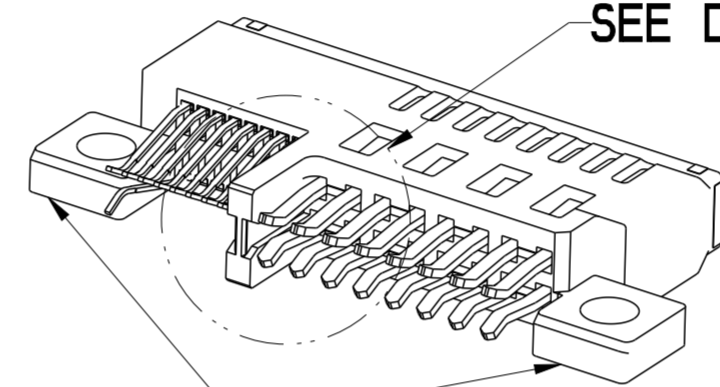

SEE DETAIL A

FEATURE A

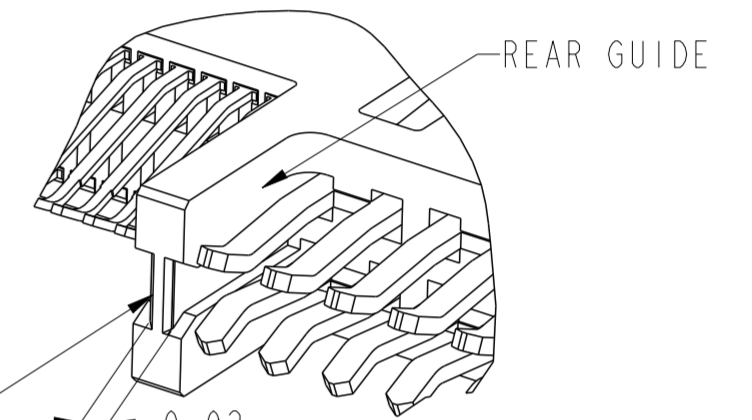

FEATURE C

0.92
ALIGNMENT KEY

DETAIL A
SCALE 4:1

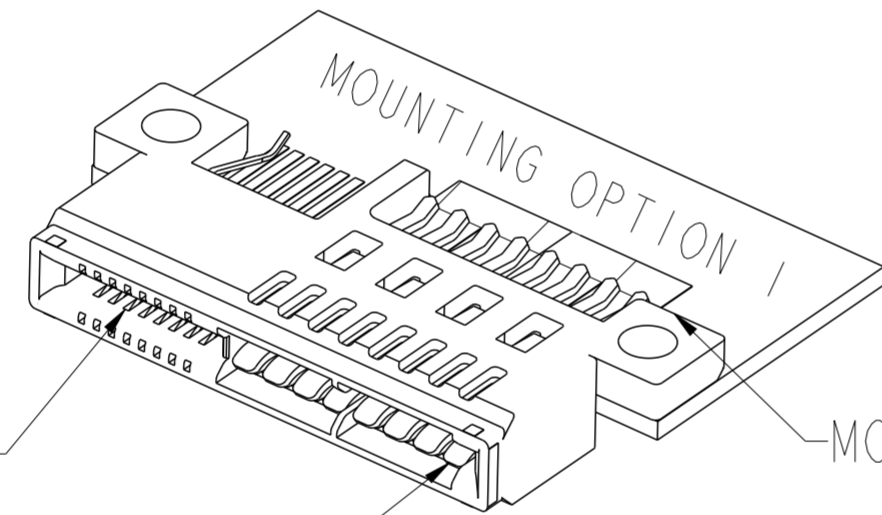

16 SIGNAL PINS

16 POWER PINS

MOUNTING EARS ARE UP

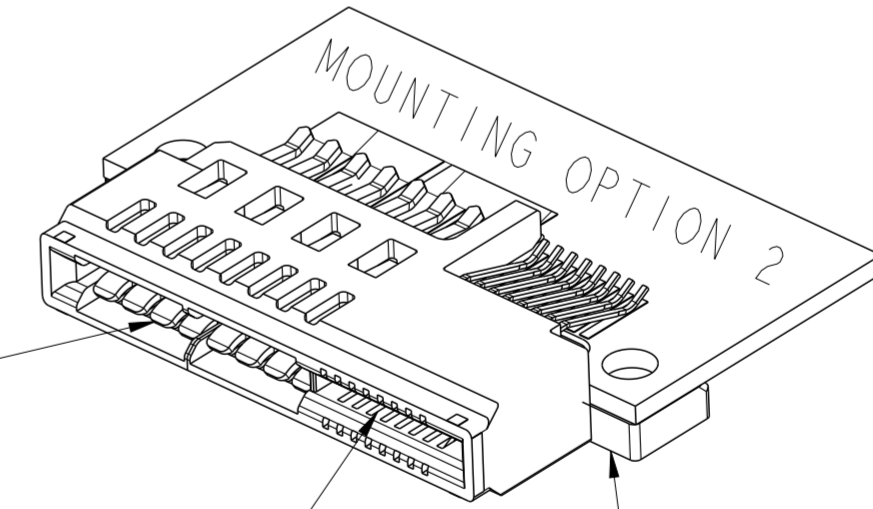

16 POWER PINS

16 SIGNAL PINS

MOUNTING EARS ARE DOWN

NOTES:

- CONNECTOR MATERIALS:
HOUSING: HIGH TEMPERATURE THERMAL PLASTIC, BLACK
UL 94V-0 COMPLIANT
CONTACTS: HIGH PERFORMANCE COPPER ALLOY.
- CONTACT FINISH REF. GS-12-604 SECTION 5.2.
- PRODUCT SPECIFICATION: GS-12-604.
- APPLICATION SPECIFICATION: GS-20-128.
- PRODUCT MARKING ON HOUSING IN AREA SHOWN MEETS AFCI SPECIFICATION: GS-24-007.
- PACKAGING MEETS FCI SPECIFICATION GS-14-937.
- HOUSING COMPONENT WILL WITHSTAND EXPOSURE TO 260°C PEAK TEMPERATURE FOR 60 SECONDS IN A CONVECTION, INFRA-RED, OR VAPOR PHASE REFLOW OVEN.
- HOST BOARD ALIGNMENT KEY IS RECOMMENDED TO ENSURE PROPER ALIGNMENT OF SOLDER TAILS WITH HOST BOARD PADS.
- A SYMBOL WILL BE NEXT TO ANY DIMENSION, VIEW, OR NOTE WHICH HAS BEEN MODIFIED WITH THE CURRENT DRAWING REVISION.

spec ref	-	dr	Wei-Long Zhang	2012/05/11	projection	MM	size	A2	scale	4:1
tolerance std	ASME Y14.5	eng	Sunny2 Liu	2016/05/18		MM	ecn no	ELX-DG-24036-1	rel level	Released
TOLERANCES UNLESS OTHERWISE SPECIFIED		chr	Terris Liu	2016/05/20						
surface	linear	0.X	±0.3	Amphenol FCI	product family	CARD EDGE	cat. no.	10121046	rev	B
		0.XX	±0.1		title	RECEPTACLE (16P-16S)				
		0.XXX	±0.05		HPCE - (STRADDLE MOUNT)					
	angular	0°	±2°				Product - Customer Drw	sheet 4 of 4		