

THIS DRAWING IS UNPUBLISHED. RELEASED FOR PUBLICATION
 © COPYRIGHT - By - ALL RIGHTS RESERVED.

| REVISIONS | | | | | |
|-----------|-----|---------------------------|-----------|-----|------|
| P | LTR | DESCRIPTION | DATE | DWN | APVD |
| J1 | | REVISED PER ECR-16-016655 | 02DEC2016 | BDA | DR |
| J2 | | REVISED PER ECO-17-007400 | 01DEC2017 | RS | DR |

| | | |
|--------------------------------|--------------------------------|--------------------------------|
| AMP WIRE RANGE | E13288 Listed | LR7189 Certified |
| 22-16 AWG SOLID OR STRANDED | 22-16 AWG SOLID OR STRANDED | 22-16 AWG SOLID OR STRANDED |

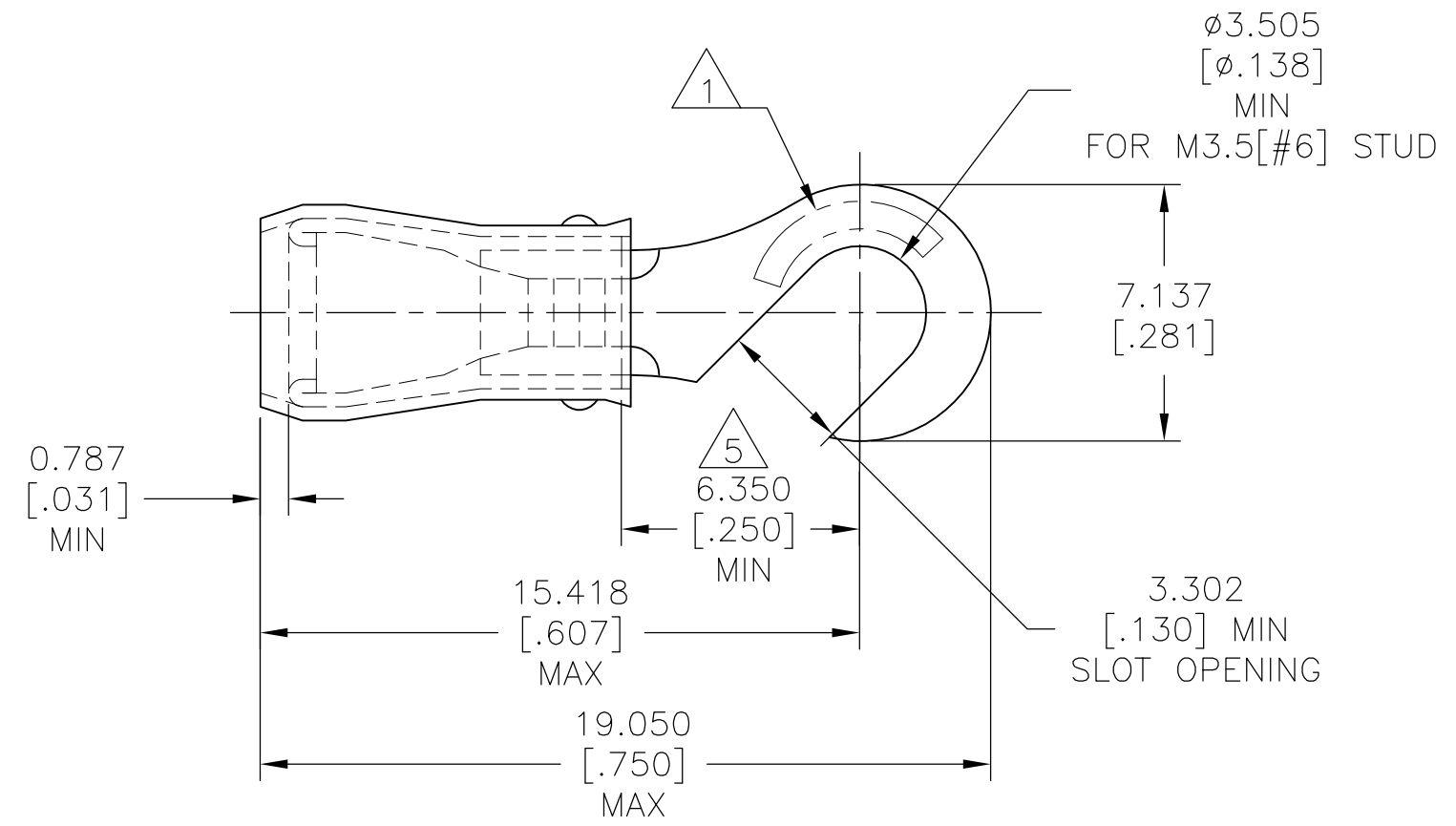

- 1 STAMP AMP 22-18* APPROX AS SHOWN
22-16 TERMINALS ARE STAMPED 22-18 IN
ACCORDANCE WITH MILITARY SPEC SAE AS 7928
COMMERCIAL WIRE RANGE IS 22-16.
- 2 WIRE INSULATION: Ø2.667-3.556[Ø.105-.140]
- 3 BODY MATERIAL THK: 0.787±0.051[.031±.002]
- 4 NOTE DELETED.
- 5 APPLIES FROM EDGE OF METAL WIRE BARREL TO
CENTER OF STUD HOLE.

| | | |
|------|--------------|----------|
| 1000 | LOOSE PIECE | 34313 |
| QTY. | PACKAGE TYPE | PART NO. |

AMP INCORPORATED
 CUSTOMER SERVICE SYSTEMS

THIS DRAWING IS A CONTROLLED DOCUMENT.

| | | |
|------------------|------------|---------|
| DWN | L OLMEDA | 3/21/94 |
| CHK | R HERSEY | 3/21/94 |
| APVD | M ELLIS | 3/21/94 |
| PRODUCT SPEC | UL 486 A-B | |
| APPLICATION SPEC | 114-2157 | |
| WEIGHT | - | |



NAME
 TERMINAL, HOOK, P.I.D.G., WIRE SIZE: 22-16 AWG

| | |
|---|--|
| FOR ADDITIONAL PRODUCT INFORMATION OR COPIES OF DRAWINGS AND TECHNICAL DOCUMENTS | PRODUCT INFORMATION CENTER 1-800-522-6752 |
| FOR APPLICATION TOOLING INFORMATION | TOOLING ASSISTANCE CENTER 1-800-722-1111 |
| FOR ORDER ENTRY | 1-800-526-5142 |

| |
|--|
| MAX RECOMMENDED OPERATING TEMPERATURE: 105°C [221°F] MAX |
| VOLTAGE RATING: 300 V MAX |
| WIRE CROSS SECTIONAL AREA RANGE, 0.26-1.65mm ² [509-3,260] CIR MILS SOLID OR STRANDED |

| | |
|---|---|
| DIMENSIONS: mm [INCHES] | TOLERANCES UNLESS OTHERWISE SPECIFIED: |
| | 0 PLC ± - 1 PLC ± - 2 PLC ± - 3 PLC ± 0.127[.005] 4 PLC ± - ANGLES ± - |
| MATERIAL COOPER PER ASTM B-152 NYLON, COLOR: RED | FINISH TIN PLATE PER ASTM B 545 |

CUSTOMER DRAWING SCALE 5:1 SHEET 1 OF 1 REV J2