

# CTSPMA4015F Series

From .47µH to 10µH

## SPECIFICATIONS

Parts are available in ±20% inductance tolerance only

Part Number	Inductance (µH)	L Test Condition	DCR Max. (mΩ)	Isat Max. (A)	Irms Max. (A)
CTSPMA4015F-R47M	0.47	100KHz, 1V	11.3	12.0	8.3
CTSPMA4015F-R68M	0.68	100KHz, 1V	13.8	8.6	7.7
CTSPMA4015F-1R0M	1.00	100KHz, 1V	22.5	8.4	5.4
CTSPMA4015F-1R5M	1.50	100KHz, 1V	30.0	6.1	4.8
CTSPMA4015F-2R2M	2.20	100KHz, 1V	48.0	5.8	3.7
CTSPMA4015F-3R3M	3.30	100KHz, 1V	82.5	4.1	2.8
CTSPMA4015F-4R7M	4.70	100KHz, 1V	100.0	3.5	2.5
CTSPMA4015F-6R8M	6.80	100KHz, 1V	125.5	2.8	2.2
CTSPMA4015F-100M	10	100KHz, 1V	230.0	1.8	1.6



## PHYSICAL DIMENSIONS

Size	A	B	C	D	E	F
mm	4.4±0.2	4.1±0.2	4.4	1.5	1.60	1.60
inches	0.17±0.008	0.16±0.008	0.17	0.059	0.063	0.063
Size	G	H	I	J	K	
mm	1.0	1.10±0.1	2.2	1.05±0.1	2.0	
inches	0.039	0.043±0.004	0.087	0.041±0.004	0.079	

## CHARACTERISTICS

**Description:** SMD (shielded) Power Inductors

**Applications:** Smart phones, Notebook PC's, Tablets, HDD's, Servers, VRM's, Compact power supply modules, etc.

**Saturation Rated Current (Isat):** The DC current when the when the inductance becomes 30% lower than its initial value. (Ta=25°C)

**Temperature Rise Current (Irms):** The actual current when temperature of coil becomes ΔT40°C. (Ta=25°C)

**Operating Temperature Range:** -55°C to 155°C

**Markings:** Inductance Code

**Miscellaneous:** RoHS compliant

**Samples available. See website for ordering information.**

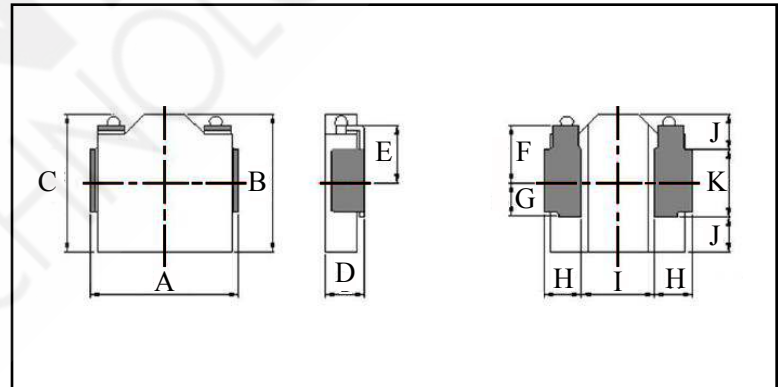

## PAD LAYOUT

