



00-9276-00X-021-X06

PREFIX _____

CODE	TYPE
00	WIRE TO BOARD CONNECTOR

SERIES _____

NO. OF WAYS _____

CODE	NO. OF WAYS	DETAILS
001	1	SHEET 2
002	2	SHEET 3
003	3	SHEET 4
004	4	SHEET 5
006	6	SHEET 6
008	8	SHEET 7

AVX CONFIDENTIAL PROPRIETARY
The document on this print and information therewith are PROPRIETARY to AVX and shall not be copied or disclosed in whole or in part without AVX's written consent.

STYLE _____

CODE	CONNECTOR STYLE
0	HORIZONTAL MOUNTING

WIRE SIZE _____

CODE	WIRE GAUGE	MAX CONDUCTOR	MAX INSULATION
21	SEE TABLE BELOW	1.05mm DIAMETER	2.10mm DIAMETER

INSULATOR COLOUR/APPROVAL _____

CODE	COLOUR	AVAILABILITY	WIRES ACCEPTED
0	BLACK	SPECIAL ORDER - NON-UL	18 AWG TO 26 AWG
1	WHITE	SPECIAL ORDER - NON-UL	18 AWG TO 26 AWG
8	BLACK	SPECIAL ORDER - UL APPROVED	18 AWG TO 26 AWG
9	WHITE	STANDARD - UL APPROVED	18 AWG TO 26 AWG

PLATING OPTION _____

CODE	CONTACT
06	TIN ALL OVER



SHEET 1 OF 8

FORM-106-01-056-6 ISS 8

Release No.
102631
25.10.2011
23.12.2011
102863
14.03.2012
102874
17.04.2012
102967
01.03.2013
103003
17.06.2013
103015
18.07.2013
103184
31.10.2014

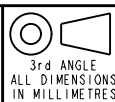

Drawn	Description	DATE
N.C.H.	18-26 AWG WIRE TO BOARD CONNECTOR	01-Oct-09
Size	Part Number	Issue
CV	00-9276-01_000S	7

I WAY WIRE TO BOARD CONNECTOR

AVX CONFIDENTIAL PROPRIETARY
 The document on this print and information therewith are
PROPRIETARY to AVX and shall not be copied or disclosed
 in whole or in part without AVX's written consent.

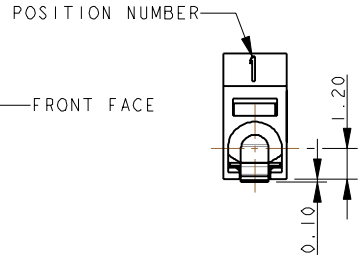
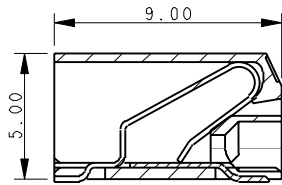
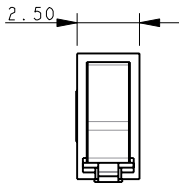

SECTION ON A-A

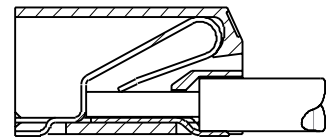
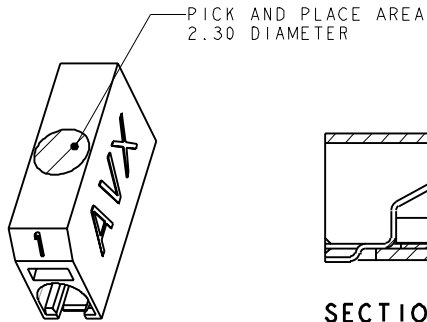
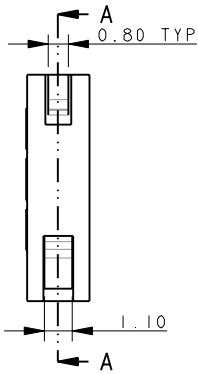

SECTION ON A-A WITH WIRE

NOTES :-

- 9276 ONE WAY CONNECTOR, REFER TO ELCO SPECIFICATION 201-01-125 , FOR UL APPROVED CONNECTORS REFER TO ELCO SPECIFICATION 201-01-125UL. FOR APPLICATION NOTES REFER TO 201-01-127.
- INSULATION MATERIAL :- NYLON 46, GLASS FILLED, UL94 V-0, COLOUR REFER TO SHEET 1.
- CONTACT MATERIAL :- COPPER ALLOY, 0.20mm THICK, TIN PLATED.
- OUTLINE OF CONNECTOR.
- WIRE ASSEMBLY/EXTRACTION, REFER TO SHEET 8.
- FRONT FACE OF CONNECTOR CAN BE IN LINE WITH EDGE OF PCB.
- PACKING IN TAPE AND REEL, QUANTITY 1000 PER REEL.
- FOR UL PRODUCT CODES UL REFERENCE E90723 (US AND CANADA).
- GENERAL TOLERANCE ± 0.20 UNLESS TOLERANCED.

PACKING DETAILS

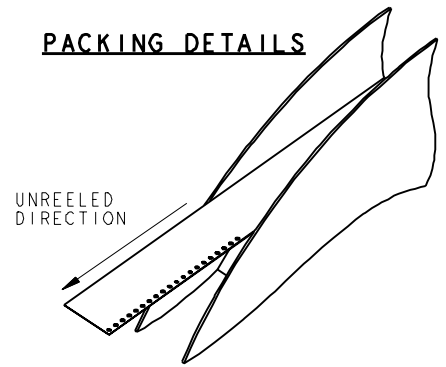

I WAY PCB BOARD LAYOUT

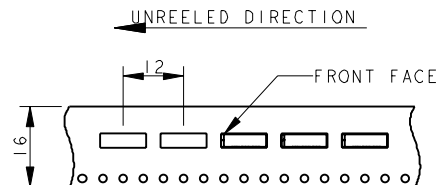
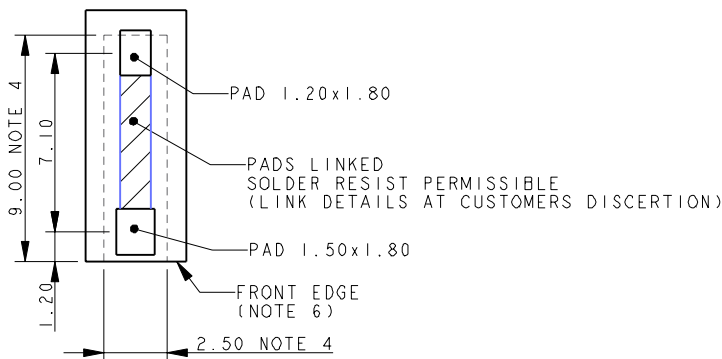

Release No.	History
102631	25.10.2011
102863	23.12.2011
102874	14.03.2012
102967	17.04.2012
103003	01.03.2013
103015	17.06.2013
103184	18.07.2013
103184	10.31.2014

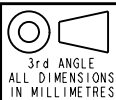

Drawn	N.C.H.
Size	CV

Description	18-26 AWG WIRE TO BOARD CONNECTOR
Part Number	00-9276-01_000S

DATE	13-Nov-09
Issue	7

A

B

2 WAY WIRE TO BOARD CONNECTOR

AVX CONFIDENTIAL PROPRIETARY
 The document on this print and information therewith are
PROPRIETARY to AVX and shall not be copied or disclosed
 in whole or in part without AVX's written consent.

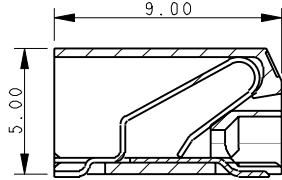
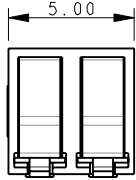

SECTION ON A-A

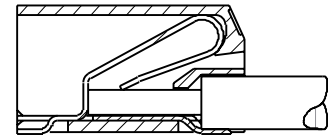
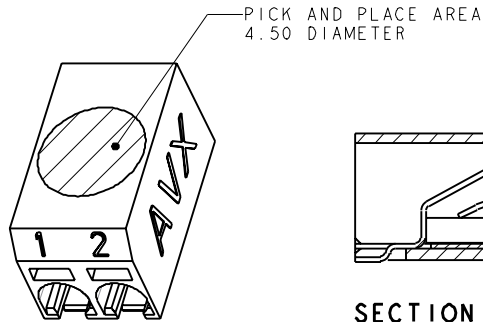
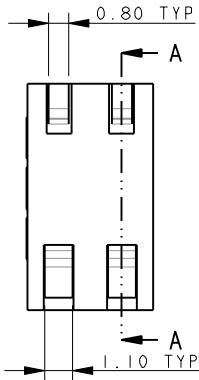
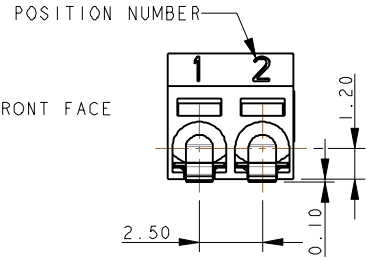

SECTION ON A-A WITH WIRE

NOTES :-

1. 9276 ONE WAY CONNECTOR, REFER TO ELCO SPECIFICATION 201-01-125 , FOR UL APPROVED CONNECTORS REFER TO ELCO SPECIFICATION 201-01-125UL.
FOR APPLICATION NOTES REFER TO 201-01-127.
2. INSULATION MATERIAL :- NYLON 46, GLASS FILLED, UL94 V-0, COLOUR REFER TO SHEET 1.
3. CONTACT MATERIAL :- COPPER ALLOY, 0.20mm THICK, TIN PLATED.
4. OUTLINE OF CONNECTOR.
5. WIRE ASSEMBLY/EXTRACTION, REFER TO SHEET 8.
6. FRONT FACE OF CONNECTOR CAN BE IN LINE WITH EDGE OF PCB.
7. PACKING IN TAPE AND REEL, QUANTITY 1000 PER REEL.
8. FOR UL PRODUCT CODES UL REFERENCE E90723 (US AND CANADA).
9. GENERAL TOLERANCE ± 0.20 UNLESS TOLERANCED.

2 WAY PCB BOARD LAYOUT

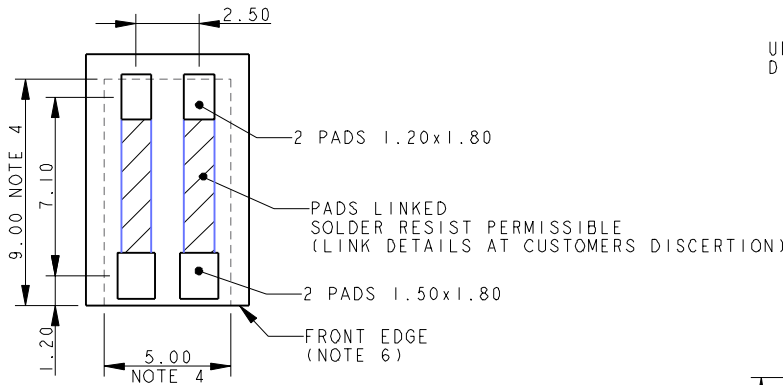

PACKING DETAILS

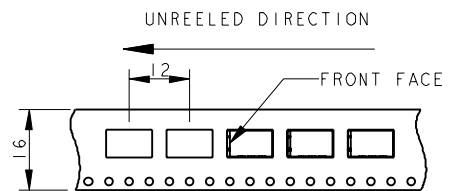
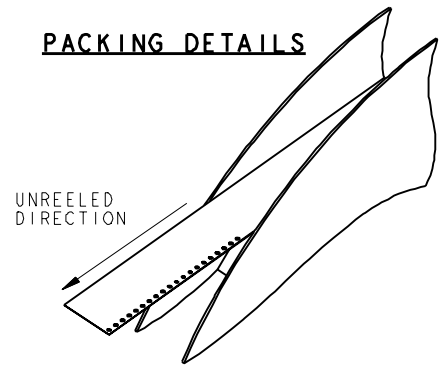

SHEET 3 OF 8

FORM-106-01-056-6 ISS 8

Release No.	102631
History	25.10.2011
	23.12.2011
	102863
	14.03.2012
	102874
	17.04.2012
	102967
	01.03.2013
	103003
	17.06.2013
	103015
	18.07.2013
	103184
	31.10.2014

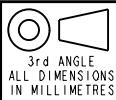

Drawn	N.C.H.
Size	CV

Description	18-26 AWG WIRE TO BOARD CONNECTOR
Part Number	00-9276-01_000S

DATE	13-Nov-09
Issue	7

A

B

A

B

3 WAY WIRE TO BOARD CONNECTOR

AVX CONFIDENTIAL PROPRIETARY
 The document on this print and information therewith are
 PROPRIETARY to AVX and shall not be copied or disclosed
 in whole or in part without AVX's written consent.

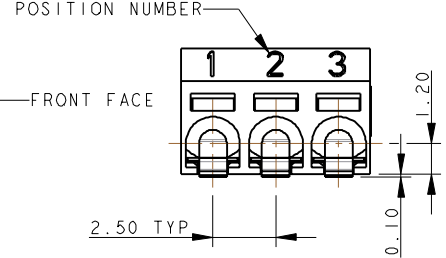
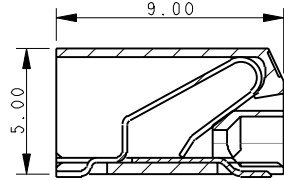
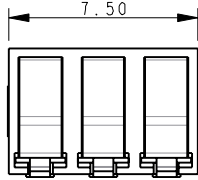

SECTION ON A-A

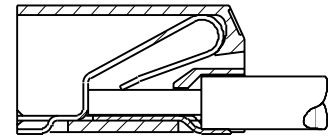
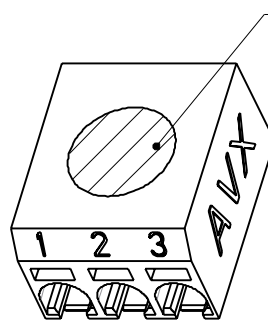
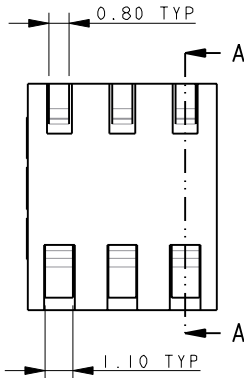

SECTION ON A-A WITH WIRE

NOTES :-

- 9276 ONE WAY CONNECTOR, REFER TO ELCO SPECIFICATION 201-01-125 , FOR UL APPROVED CONNECTORS REFER TO ELCO SPECIFICATION 201-01-125UL. FOR APPLICATION NOTES REFER TO 201-01-127.
- INSULATION MATERIAL :- NYLON 46, GLASS FILLED, UL94 V-0, COLOUR REFER TO SHEET 1.
- CONTACT MATERIAL :- COPPER ALLOY, 0.20mm THICK, TIN PLATED.
- OUTLINE OF CONNECTOR.
- WIRE ASSEMBLY/EXTRACTION, REFER TO SHEET 8.
- FRONT FACE OF CONNECTOR CAN BE IN LINE WITH EDGE OF PCB.
- PACKING IN TAPE AND REEL, QUANTITY 1000 PER REEL.
- FOR UL PRODUCT CODES UL REFERENCE E90723 (US AND CANADA).
- GENERAL TOLERANCE ± 0.20 UNLESS TOLERANCED.

PACKING DETAILS

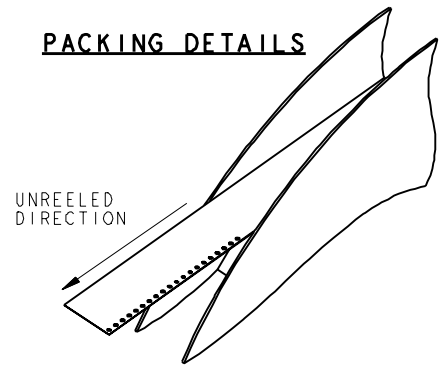

3 WAY PCB BOARD LAYOUT

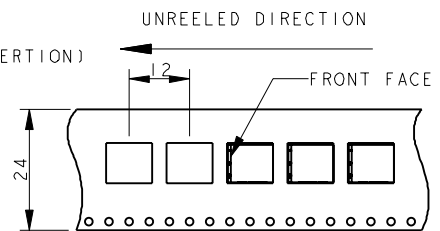
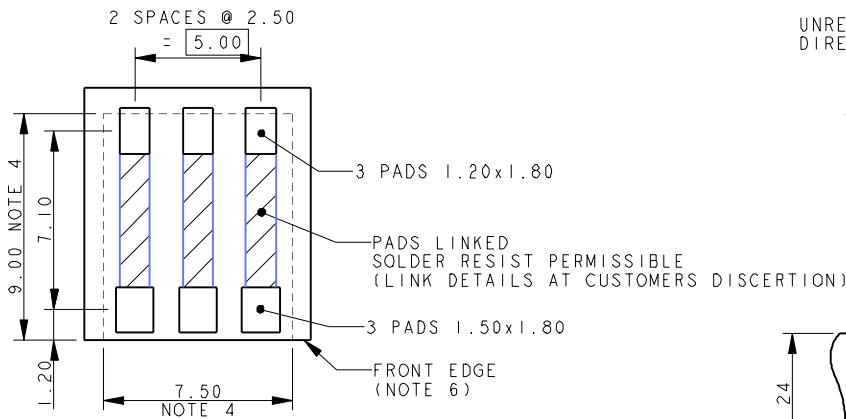

SHEET 4 OF 8

FORM-106-01-056-6 ISS 8

Release No.	
History	
102631	25.10.2011
102863	23.12.2011
102874	14.03.2012
102967	17.04.2012
103003	01.03.2013
103015	17.06.2013
103184	18.07.2013
103184	10.3.18.4
31.10.2014	

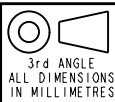

Drawn	N.C.H.
Size	CV

Description	18-26 AWG WIRE TO BOARD CONNECTOR
Part Number	00-9276-01_000S

DATE	13-Nov-09
Issue	7

A

B

A

B

4 WAY WIRE TO BOARD CONNECTOR

AVX CONFIDENTIAL PROPRIETARY
 The document on this print and information therewith are PROPRIETARY to AVX and shall not be copied or disclosed in whole or in part without AVX's written consent.

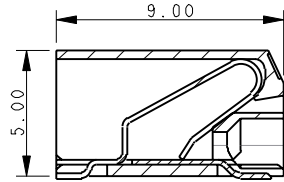
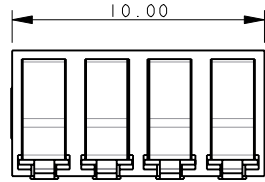

SECTION ON A-A

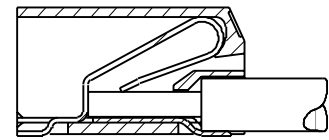
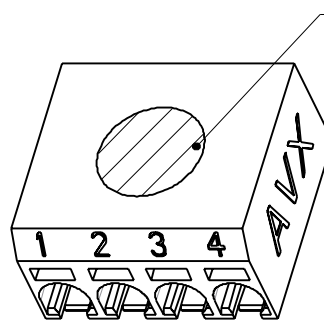
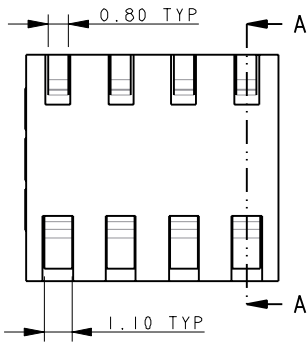
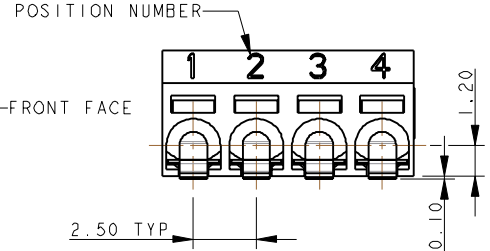

SECTION ON A-A WITH WIRE

NOTES :-

- 9276 ONE WAY CONNECTOR, REFER TO ELCO SPECIFICATION 201-01-125 , FOR UL APPROVED CONNECTORS REFER TO ELCO SPECIFICATION 201-01-125UL. FOR APPLICATION NOTES REFER TO 201-01-127.
- INSULATION MATERIAL :- NYLON 46, GLASS FILLED, UL94 V-0, COLOUR REFER TO SHEET 1.
- CONTACT MATERIAL :- COPPER ALLOY, 0.20mm THICK, TIN PLATED.
- OUTLINE OF CONNECTOR.
- WIRE ASSEMBLY/EXTRACTION, REFER TO SHEET 8.
- FRONT FACE OF CONNECTOR CAN BE IN LINE WITH EDGE OF PCB.
- PACKING IN TAPE AND REEL, QUANTITY 1000 PER REEL.
- FOR UL PRODUCT CODES UL REFERENCE E90723 (US AND CANADA).
- GENERAL TOLERANCE ± 0.20 UNLESS TOLERANCED.

PACKING DETAILS

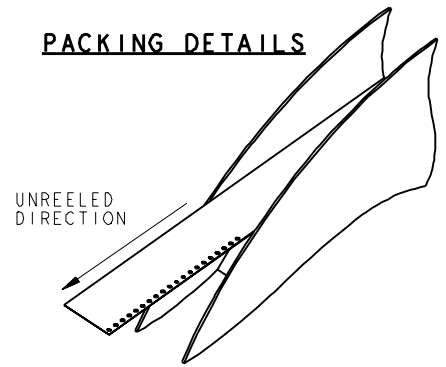

4 WAY PCB BOARD LAYOUT

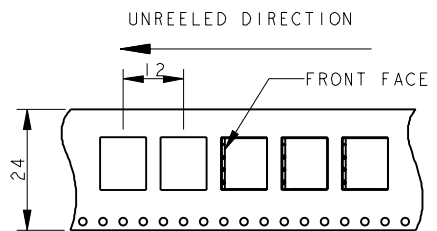
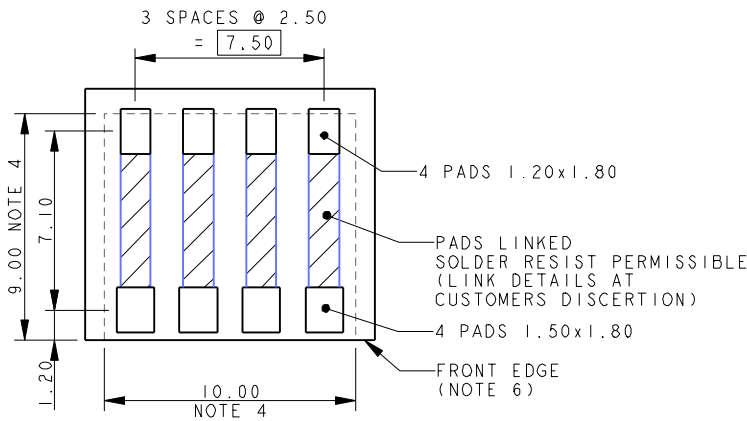

SHEET 5 OF 8

FORM-106-01-056-6 ISS 8

Release No.	
History	
102631	
25.10.2011	
23.12.2011	
102863	
14.03.2012	
102874	
17.04.2012	
102967	
01.03.2013	
103003	
17.06.2013	
103015	
18.07.2013	
103184	
31.10.2014	

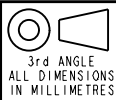

Drawn	N.C.H.
Size	CV

Description	18-26 AWG WIRE TO BOARD CONNECTOR
Part Number	00-9276-01_000S

DATE	13-Nov-09
Issue	7

A

B

A

B

6 WAY WIRE TO BOARD CONNECTOR

AVX CONFIDENTIAL PROPRIETARY
 The document on this print and information therewith are
 PROPRIETARY to AVX and shall not be copied or disclosed
 in whole or in part without AVX's written consent.

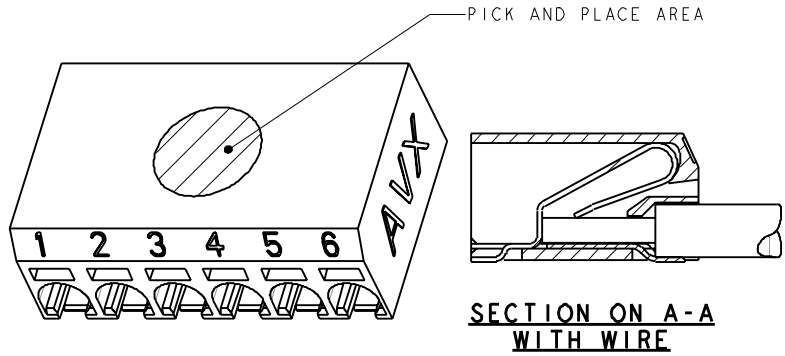
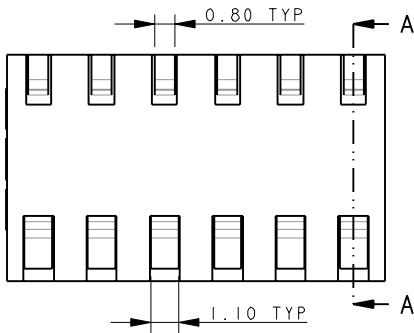
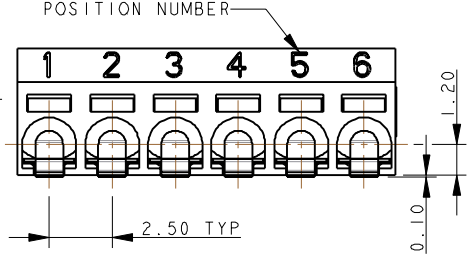
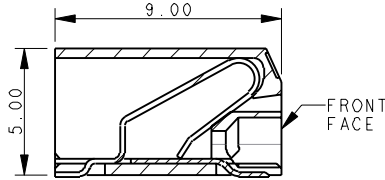
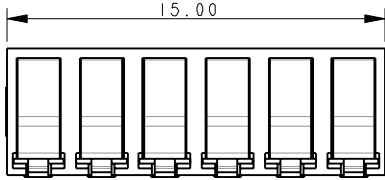

NOTES :-

- 9276 ONE WAY CONNECTOR, REFER TO ELCO SPECIFICATION 201-01-125 , FOR UL APPROVED CONNECTORS REFER TO ELCO SPECIFICATION 201-01-125UL. FOR APPLICATION NOTES REFER TO 201-01-127.
- INSULATION MATERIAL :- NYLON 46, GLASS FILLED, UL94 V-0, COLOUR REFER TO SHEET 1.
- CONTACT MATERIAL :- COPPER ALLOY, 0.20mm THICK, TIN PLATED.
- OUTLINE OF CONNECTOR.
- WIRE ASSEMBLY/EXTRACTION, REFER TO SHEET 8.
- FRONT FACE OF CONNECTOR CAN BE IN LINE WITH EDGE OF PCB.
- PACKING IN TAPE AND REEL, QUANTITY 1000 PER REEL.
- FOR UL PRODUCT CODES UL REFERENCE E90723 (US AND CANADA).
- GENERAL TOLERANCE ± 0.20 UNLESS TOLERANCED.

6 WAY PCB BOARD LAYOUT

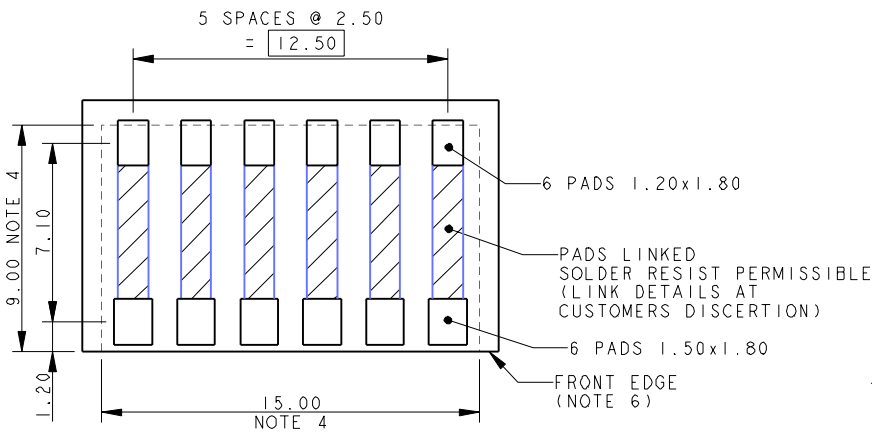

PACKING DETAILS

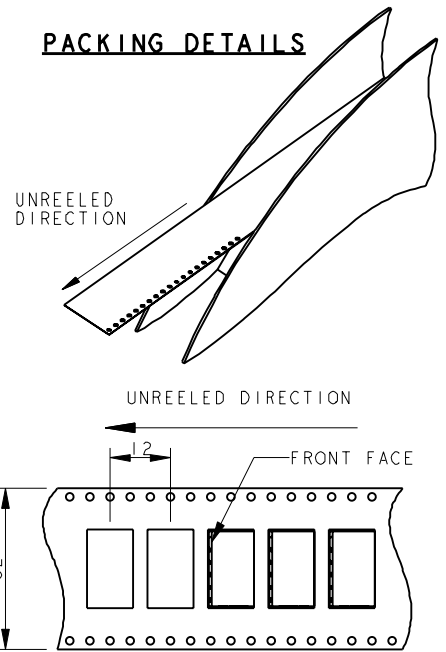

SHEET 6 OF 8

FORM-106-01-056-6 ISS 8

Release No.	
History	
102631	
25.10.2011	
102863	
23.12.2011	
102863	
14.03.2012	
102874	
17.04.2012	
102967	
01.03.2013	
103003	
17.06.2013	
103015	
18.07.2013	
103184	
31.10.2014	

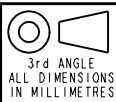

Drawn	N.C.H.
Size	CV

Description	18-26 AWG WIRE TO BOARD CONNECTOR
Part Number	00-9276-01_000S

DATE	13-Nov-09
Issue	7

A

B

8 WAY WIRE TO BOARD CONNECTOR

AVX CONFIDENTIAL PROPRIETARY
 The document on this print and information therewith are PROPRIETARY to AVX and shall not be copied or disclosed in whole or in part without AVX's written consent.

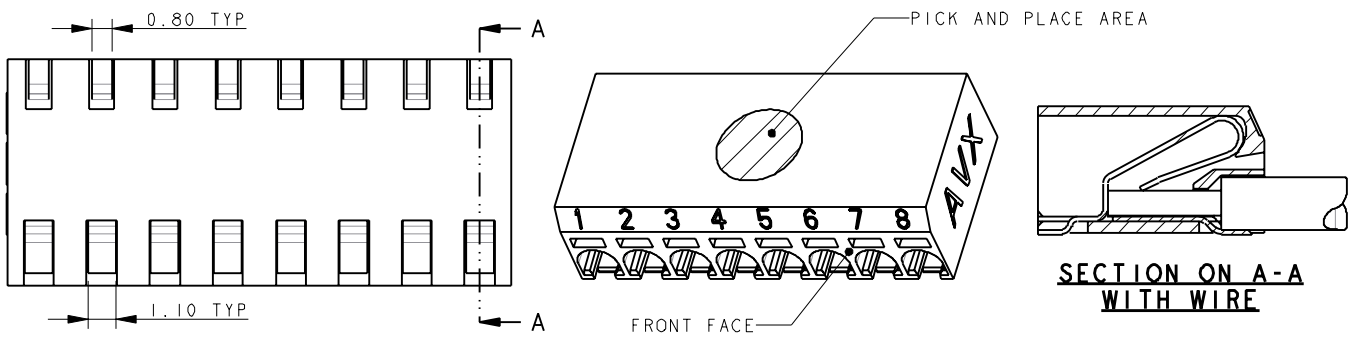
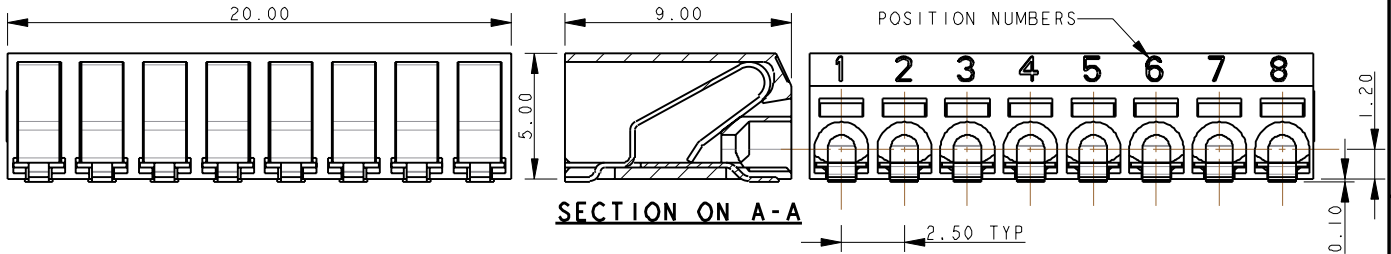

- NOTES :-
- 9276 ONE WAY CONNECTOR, REFER TO ELCO SPECIFICATION 201-01-125 , FOR UL APPROVED CONNECTORS REFER TO ELCO SPECIFICATION 201-01-125UL. FOR APPLICATION NOTES REFER TO 201-01-127.
 - INSULATION MATERIAL :- NYLON 46, GLASS FILLED, UL94 V-0, COLOUR REFER TO SHEET 1.
 - CONTACT MATERIAL :- COPPER ALLOY, 0.20mm THICK, TIN PLATED.
 - OUTLINE OF CONNECTOR.
 - WIRE ASSEMBLY/EXTRACTION, REFER TO SHEET 8.
 - FRONT FACE OF CONNECTOR CAN BE IN LINE WITH EDGE OF PCB.
 - PACKING IN TAPE AND REEL, QUANTITY 1000 PER REEL.
 - FOR UL PRODUCT CODES UL REFERENCE E90723 (US AND CANADA).
 - GENERAL TOLERANCE ±0.20 UNLESS TOLERANCED.

PACKING DETAILS

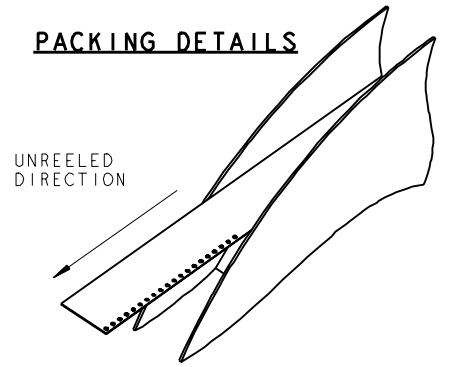

8 WAY PCB BOARD LAYOUT

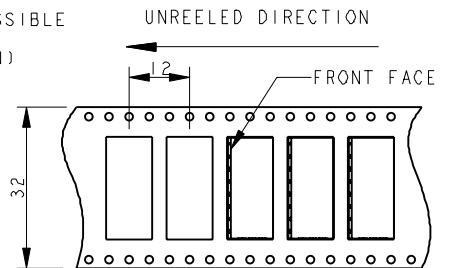
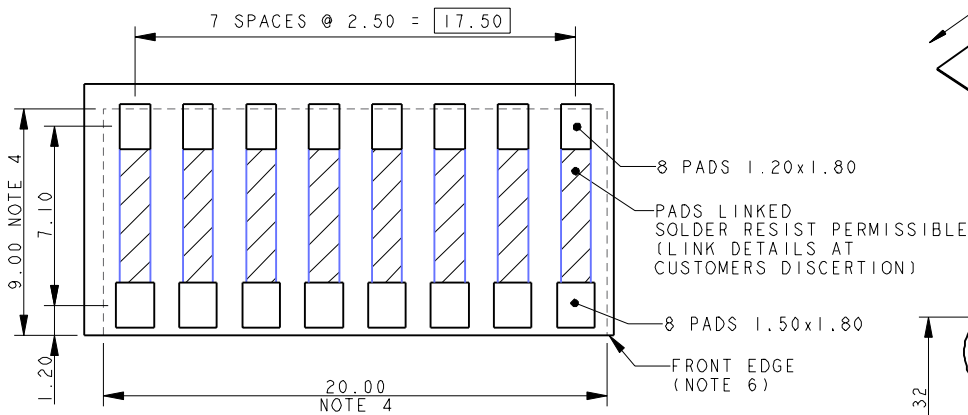

SHEET 7 OF 8

FORM-106-01-056-6 ISS 8

Release No.	History
102631	25.10.2011
102863	23.12.2011
102874	14.03.2012
102967	17.04.2012
103003	01.03.2013
103015	17.06.2013
103184	18.07.2013
103184	10.3.184
103184	31.10.2014

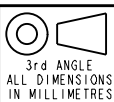

AVX
 © COPYRIGHT AVX
 NOT TO BE DISCLOSED OR COPIED
 WITHOUT WRITTEN PERMISSION

Drawn	Description	DATE
N.C.H.	18-26 AWG WIRE TO BOARD CONNECTOR	13-Nov-09
Size	Part Number	Issue
CV	00-9276-01_000S	7

WIRE ASSEMBLY
FOR FURTHER DETAILS REFER TO APPLICATION NOTES 201-01-127

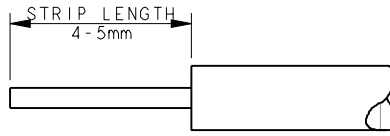

TRIM INSULATION.
DO NOT CRUSH CENTRE OF WIRE.
STRANDED WIRES TWISTED TOGETHER BEFORE INSETION.
CHECK ALL STRANDS OF WIRE ARE CORRECTLY ALIGNED
AFTER THE INSULATION IS REMOVED.

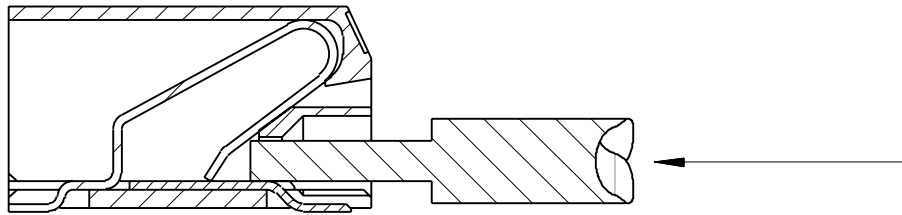

PUSH WIRE INTO HOLE IN FRONT OF CONNECTOR.
DO NOT BEND CONDUCTOR.

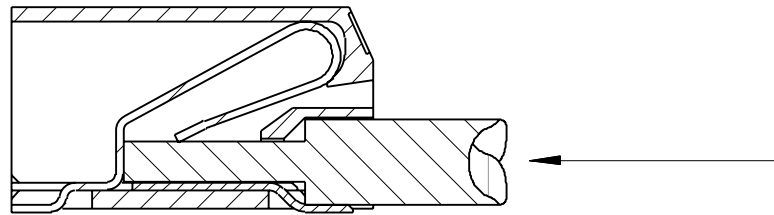

CONTINUE TO PUSH WIRE UNTIL STOP IS REACHED.

WIRE EXTRACTION

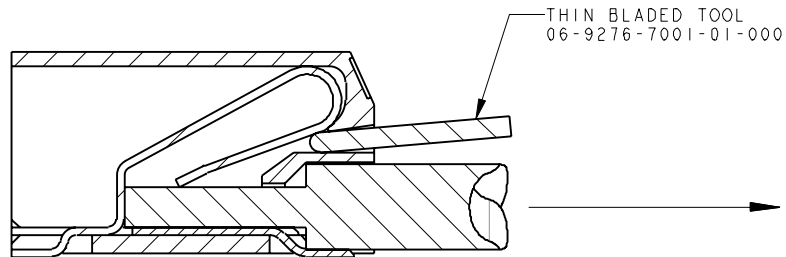

PUSH BLADE (NOT SHARP) INTO SLOT ABOVE WIRE.
WHEN WIRE IS FREE, PULL TO EXTRACT.

AVX CONFIDENTIAL PROPRIETARY
The document on this print and information therewith are
PROPRIETARY to AVX and shall not be copied or disclosed
in whole or in part without AVX's written consent.

FORM-106-01-056-6 ISS 8

Release No.
102631
25.10.2011
102863
23.12.2011
14.03.2012
102874
17.04.2012
102967
01.03.2011
103003
17.06.2013
103015
18.07.2013
103184
31.10.2014



Drawn N.C.H.
Size CV

Description 18-26 AWG WIRE TO BOARD CONNECTOR
Part Number 00-9276-01_000S

DATE 13-Nov-09
Issue 7

A

B