

Network cable - VS-M12FSEC-OE-93E-LI/2,0 - 1405837

Please be informed that the data shown in this PDF Document is generated from our Online Catalog. Please find the complete data in the user's documentation. Our General Terms of Use for Downloads are valid (<http://download.phoenixcontact.com>)



Assembled Ethernet cable, CAT5e, shielded, 2-pair, AWG 26 stranded (7-wire), RAL 5021 (water blue), M12 flush-type socket, front/screw mounting with M16 thread on free conductor end, line, length 2 m



Key commercial data

Packing unit	1 PCE
GTIN	4 046356 475969
Custom tariff number	85444290
Country of origin	GERMANY

Technical data

Mechanical characteristics

Number of positions	4
Shielded	Yes
Insertion/withdrawal cycles	≥ 100
Cable diameter	6.70 mm
Cable exit	Straight
Cable structure	2x2xAWG26/7; SF/UTP
Smallest bending radius, fixed installation	33.5 mm (cable, fixed installation)
Smallest bending radius, movable installation	33.5 mm (cable, flexible installation)
Length of cable	2 m
Ambient temperature (operation)	-25 °C ... 60 °C (cable, fixed installation)
	-5 °C ... 60 °C (cable, flexible installation)
	-25 °C ... 90 °C

Ambient conditions

Ambient temperature (operation)	-25 °C ... 60 °C (cable, fixed installation)
---------------------------------	--

Network cable - VS-M12FSEC-OE-93E-LI/2,0 - 1405837

Technical data

Ambient conditions

	-5 °C ... 60 °C (cable, flexible installation)
	-25 °C ... 90 °C
Degree of protection	IP65/67

Material data

Inflammability class according to UL 94	V0
Contact carrier material	PA 66
Contact material	CuZn
Contact surface material	Ni/Au
Outer sheath, material	PUR
External sheath, color	water blue RAL 5021

Electrical characteristics

Insulation resistance	$\geq 100 \text{ M}\Omega$
Transmission characteristics (category)	CAT5 (IEC 11801:2002), CAT5e (TIA 568B:2001)

Line characteristics

Cable type	PUR ETHERNET 2x2 FLEX
UL AWM style	20963 (80°C/30 V)
Cable structure	2x2xAWG26/7; SF/UTP
Conductor cross section	2x 2x 0.14 mm ²
AWG signal line	26
Conductor structure signal line	7x 0.16 mm
Core diameter including insulation	0.98 mm
External cable diameter	6.4 mm \pm 0.2 mm
Wire colors	white/orange-orange, white/green-green
External sheath, color	water blue RAL 5021
Transmission medium	Copper
Insulation resistance	$\geq 500 \text{ M}\Omega \cdot \text{km}$ (at 20 °C)
Conductor resistance	$\leq 290 \text{ }\Omega/\text{km}$ (at 20 °C)
Transmission characteristics (category)	CAT5 (IEC 11801:2002), CAT5e (TIA 568B:2001)
Working capacitance	45 nF (At 1 kHz)
Wave impedance	100 $\Omega \pm 5 \text{ }\Omega$ (At 100 MHz)
Signal runtime	5.3 ns/m
Nominal voltage, cable	$\leq 100 \text{ V}$
	300 V (Outer cable sheath)
Test voltage Core/Core	700 V (50 Hz, 1 min.)
Test voltage Core/Shield	700 V (50 Hz, 1 min.)
Twisted pairs	2 cores to the pair

Network cable - VS-M12FSEC-OE-93E-LI/2,0 - 1405837

Technical data

Line characteristics

Overall twist	Two pairs with two fillers to the core
Shielding	Aluminum-coated foil, tinned copper braided shield
Optical shield covering	70 %
Outer sheath, material	PUR
Material conductor insulation	Foamed PE
Conductor material	Bare Cu litz wires
Cable weight	42 kg/km
Minimum bending radius, fixed installation	4 x D
Minimum bending radius, flexible installation	8 x D
Tensile strength short-term/long-term	≤ 80N
Flame resistance	IEC 60332-1-2
Halogen-free	According to IEC 60754-1
Resistance to oil	in accordance with DIN EN 60811-2-1
Ambient temperature (operation)	-40 °C ... 80 °C (cable, fixed installation)
	-20 °C ... 80 °C (cable, flexible installation)

Classifications

ETIM

ETIM 3.0	EC001262
ETIM 4.0	EC001262
ETIM 5.0	EC000830

UNSPSC

UNSPSC 11	26121604
UNSPSC 12.01	31261501
UNSPSC 13.2	26121616
UNSPSC 6.01	26121616
UNSPSC 7.0901	26121616

eCl@ss

eCl@ss 4.0	272607xx
eCl@ss 4.1	27260701
eCl@ss 5.0	27260701
eCl@ss 5.1	27060307
eCl@ss 6.0	27061801
eCl@ss 7.0	27061801
eCl@ss 8.0	27061801

Network cable - VS-M12FSEC-OE-93E-LI/2,0 - 1405837

Drawings

Dimensioned drawing

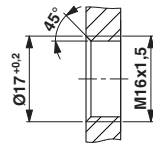

Housing cutout for M16 fastening thread, mounting panel with thread

Dimensioned drawing

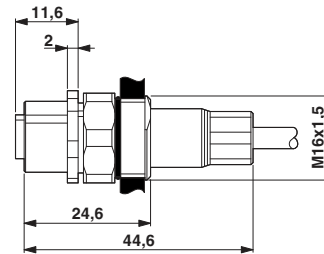

M12 flush-type connector