

P/N: 46437-1226

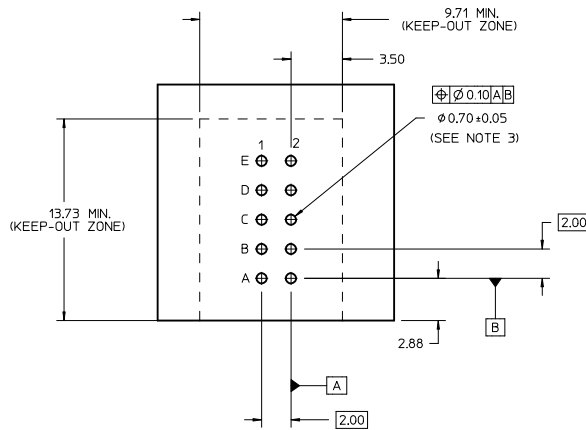
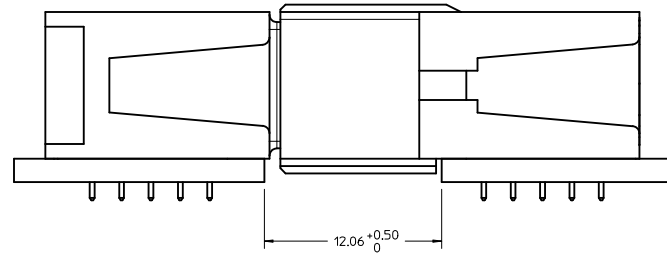
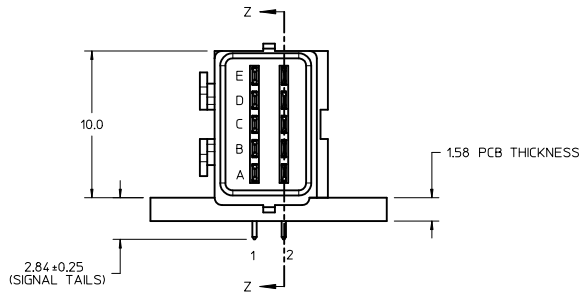

NOTES:

- MATERIAL:
 - HOUSINGS: LCP UL94 V-0, COLOR: BLACK.
 - TERMINALS: COPPER ALLOY.
 - PLATING: 0.00127mm NICKEL OVERALL WITH 0.00254mm SELECTIVE MATTE TIN ON TAILS. AND 0.000762mm SELECTIVE GOLD ON CONTACT AREA.
- ASSEMBLIES TO BE TRAY PACKED, STD. QUANTITY: TBD.
- PC BOARD REQUIRES PLATED THRU HOLES. REFER TO PS-46436-100 FOR DETAILS.
- PRODUCT SPEC: PS-46436-100.
- APPLICATION SPEC: AS-46436-100.
- SEE PRODUCT SPEC. FOR ROHS REQUIREMENTS.
- ASSEMBLY MATES WITH MOLEX RECEPTACLE ASSEMBLY, P/N 46436-1226.

| | | | | | | | | |
|---|--------------------------------------|---|---------|---|--|---------------------|-----------------------------------|--------------------------------------|
| INITIAL RELEASE IEC NO. UCF2012-1145 DRAWN BY BPSZCZOR 2012/05/14 CHECKED BY CHYD BPSZCZOR 2012/05/31 APPR: APATEL 2012/06/07 | QUALITY SYMBOLS ▽=0 ▽=0 ▽=0 | GENERAL TOLERANCES (UNLESS SPECIFIED) | | DIMENSION STYLE MM ONLY | | SCALE 6:1 | DESIGN UNITS METRIC | THIRD ANGLE PROJECTION |
| | | 4 PLACES ±--- ±--- 3 PLACES ±--- ±--- 2 PLACES ±0.13 ±--- 1 PLACE ±0.25 ±--- 0 PLACE ±--- ±--- | mm INCH | DRAWN BY DATE BPSZCZOR 2012/05/14 CHECKED BY DATE BPSZCZOR 2012/05/31 APPROVED BY DATE APATEL 2012/06/07 | TITLE R/A PLUG ASSY 10S NO GUIDES TEN60 POWER FAMILY | | MATERIAL NO. 46437-1226 | DOCUMENT NO. SD-46437-1226 |
| DRAFT WHERE APPLICABLE MUST REMAIN WITHIN DIMENSIONS | | THIS DRAWING CONTAINS INFORMATION THAT IS PROPRIETARY TO MOLEX INCORPORATED AND SHOULD NOT BE USED WITHOUT WRITTEN PERMISSION | | | | | | |

RECOMMENDED PCB LAYOUT AND KEEP-OUT ZONE