

Recommended PCB Layout
 Solder Area

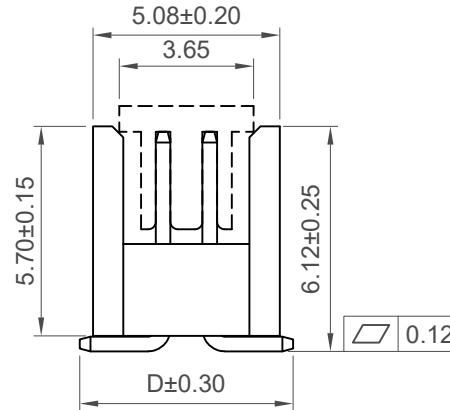
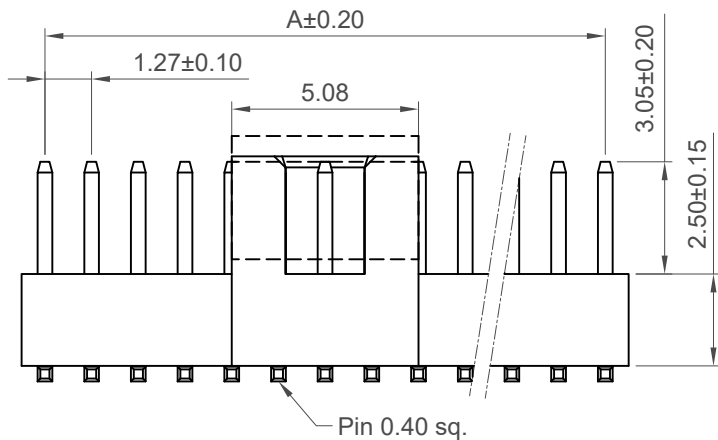
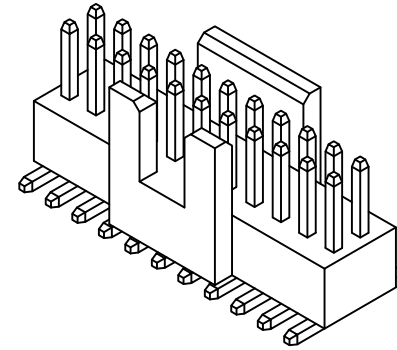

Specifications

Material

Insulator: LCP, UL 94V-0, Black
 Terminal: Brass

Plating

See Ordering Grid

Electrical

Current Rating: 1A per pin
 Contact Resistance: 20 mΩ max.
 Insulating Resistance: 1000 MΩ min.
 Dielectric Withstand Voltage: 500V AC

Soldering Process:

IR Reflow: 260°C for 10 sec.
 Manual Solder: 350°C for 3-5 sec

Mechanical & Environmental

Operating Temperature: -40°C to +105°C

Mates with (Subject to pin length)

BD050 BD055 BD060 BD064

| No. of Contacts | Dimensions | |
|-----------------|------------|-------|
| | A | B |
| 8 | 3.81 | 5.08 |
| * 10 | 5.08 | 6.35 |
| 12 | 6.35 | 7.62 |
| 14 | 7.62 | 8.89 |
| * 16 | 8.89 | 10.16 |
| 18 | 10.16 | 11.43 |
| * 20 | 11.43 | 12.70 |
| 22 | 12.70 | 13.97 |
| 24 | 13.97 | 15.24 |
| * 26 | 15.24 | 16.51 |
| 28 | 16.51 | 17.78 |
| * 30 | 17.78 | 19.05 |
| 32 | 19.05 | 20.32 |
| * 34 | 20.32 | 21.59 |
| 36 | 21.59 | 22.86 |
| 38 | 22.86 | 24.13 |
| * 40 | 24.13 | 25.40 |
| 42 | 25.40 | 26.67 |
| 44 | 26.67 | 27.94 |
| 46 | 27.94 | 29.21 |
| 48 | 29.21 | 30.48 |
| * 50 | 30.48 | 31.75 |

* = Tooled Parts
 Please contact GCT for non-tooled parts

Ordering Grid

BD125-XX-X-0305-XXXX-L-X

No. of Contacts: 08 to 50

Contact Plating: A = Gold Flash All Over (Standard), C = Tin All Over, G = 10µ" Gold Contact Area/Tin On Tail

Packing Options: B = Tape & Reel with Cap (Standard), D = Tube, E = Tube with Cap

Insulator Material: L = LCP

Request Samples and Quotation

Dimension D (1/100mm) (Width of Footprint)
0580 = 5.80mm (Standard)
 or specify Custom Footprint Width
 e.g. 5.50mm = 0550

| | | | |
|--------------|-----------------|--|-------------|
| Part Number | | Product Description | |
| BD125 | | 1.27mm Pitch Pin Header, Dual Row, Surface Mount, Vertical | |
| Drawing Date | | 18th November 2022 | |
| By | CC | Tolerances (Except as Noted) | Units: |
| Detail | Drawing Release | Length | Metric (mm) |
| Revision | A | Angle | |
| Date | 18/11/22 | X.X ± 0.30 | |
| | | X.XX ± 0.20 | |



This drawing is confidential and copyright of Global Connector Technology, Ltd (GCT). This drawing must not be copied or disclosed without written consent. E & OE



www.gct.co

| | | |
|--------------|-------------|---------------|
| Not to Scale | Drawn By CC | Sheet No. 1/1 |
|--------------|-------------|---------------|