

LEAD FREE PART NUMBER

SHELL	A±0.38	B±0.12	C±0.10	D±0.25	E±0.07	PART NUMBER
09	30.81	24.99	16.96	16.79	10.96	D09P24B.GL00LF
15	39.14	33.32	25.18	25.12	19.18	D15P24B.GL00LF
25	53.03	47.04	39.12	38.84	33.12	D25P24B.GL00LF
37	69.32	63.50	55.68	55.30	49.68	D37P24B.GL00LF

Performance class: 4 --> 200 mating/un-mating
6 --> 500 mating/un-mating

GENERAL CHARACTERISTICS AND ROHS INFORMATIONS:
SEE DRAWING C01-8646-0000

PC card drilling dimensions(after plating)
(thickness 2.40±0.20mm)

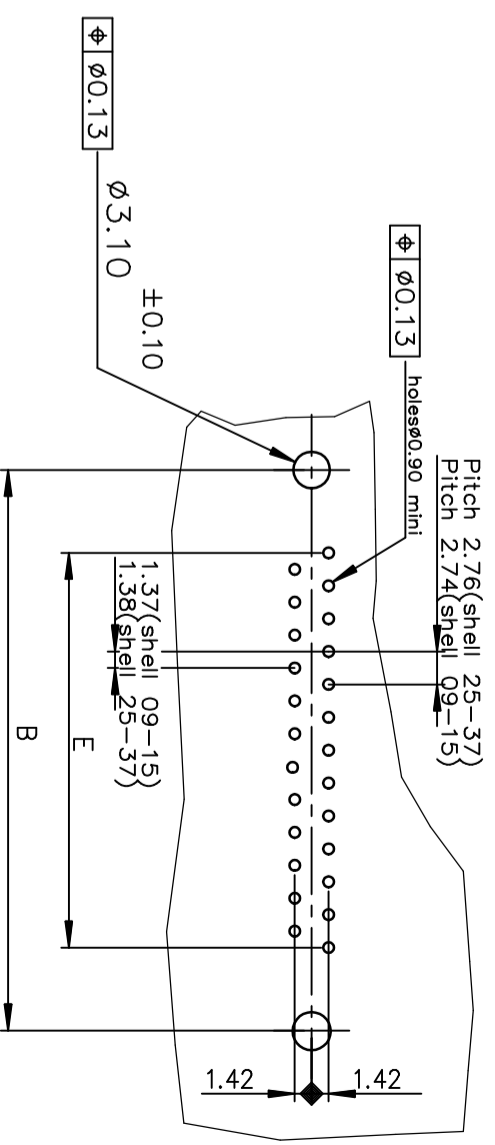

mat'l. code		surface		tolerance		projection		product family	
ltr	ecn no	dr	date	ISO 1302	ISO 406	ISO 1101	MM	D-SUB	D-SUB
F	EX-121654	AB	2015-10-26	tolerances unless otherwise specified	.0±0.1	.00±0.05	MM	MALE DELTA-D	
G	EX-1-42817	ACJ	2021-10-18	angles	.000±0.005	scale 2:1		STRAIGHT, SOLDER TYPE	
sheet index		revision	date	engr	chr	appd	Amphenol FCI	type	Product Customer Drawing
1		G	1	LELEON	GREGAR MATHEW	SANOJ KURIAKOSF		dwg no	sheet 1 of 1
				2021-10-18	2021-10-18	2021-10-18		C01-8646-0106	A3
								size	