

SECTION B-B  
SCALE 4:1

REV	ECN NO.	DR	DATE
A	---	ERIC	2013-09-03

spec ref	-	dr	Eric Jiang	20130903	projection	MM	size	A2	scale	4:1	
tolerance std	ASME Y14.5	eng	Eric Jiang	20130905	chr		ecn no		rel level	Released	
TOLERANCES UNLESS OTHERWISE SPECIFIED		appr	Pai-Ming Zhang	20130905	product family						
surface	linear	0.X	±0.50	FCI	VERT RECT (ALL SIGNAL PINS)		eng no	10123730	rev	A	
		0.XX	±0.25		HIGH POWER CARD EDGE						
		0.XXX	±0.10		www.fci.com	cat. no.					
ASME Y14.5	angular	0°	±2°							Product - Customer Drw	sheet 1 of 4

Copyright FCI.

CONTACT TYPE	TOP LAYER DESCRIPTION	TABLE 1 (HPCE / SOLDER TAILS) PLATED THROUGH-HOLE REQUIREMENTS				
		DRILLED HOLE DIAMETER	COPPER THICKNESS	TIN-LEAD THICKNESS	TIN THICKNESS	FINISHED HOLE DIAMETER
POWER & SIGNAL	TIN-LEAD	1.10-1.16 (1.15 DRILL)	0.025 - 0.050	0.005 - 0.015	--	0.94 - 1.10
	IMMERSION TIN	1.10-1.16 (1.15 DRILL)	0.025 - 0.050	--	0.9 - 1.5um	0.94 - 1.10
	COPPER (SEE NOTE 8)	1.10-1.16 (1.15 DRILL)	0.025 - 0.050	--	--	0.94 - 1.10

CONTACT TYPE	TOP LAYER DESCRIPTION	TABLE 2 (HPCE / PRESS-FIT TAILS) PLATED THROUGH-HOLE REQUIREMENTS				
		DRILLED HOLE DIAMETER	COPPER THICKNESS	TIN-LEAD THICKNESS	TIN THICKNESS	FINISHED HOLE DIAMETER
POWER & SIGNAL	TIN-LEAD	0.81-0.86 (0.85 DRILL)	0.025 - 0.050	0.005 - 0.015	--	0.65 - 0.80
	IMMERSION TIN	0.81-0.86 (0.85 DRILL)	0.025 - 0.050	--	0.9 - 1.5um	0.70 - 0.80
	COPPER (SEE NOTE 8)	0.81-0.86 (0.85 DRILL)	0.025 - 0.050	--	--	0.70 - 0.80

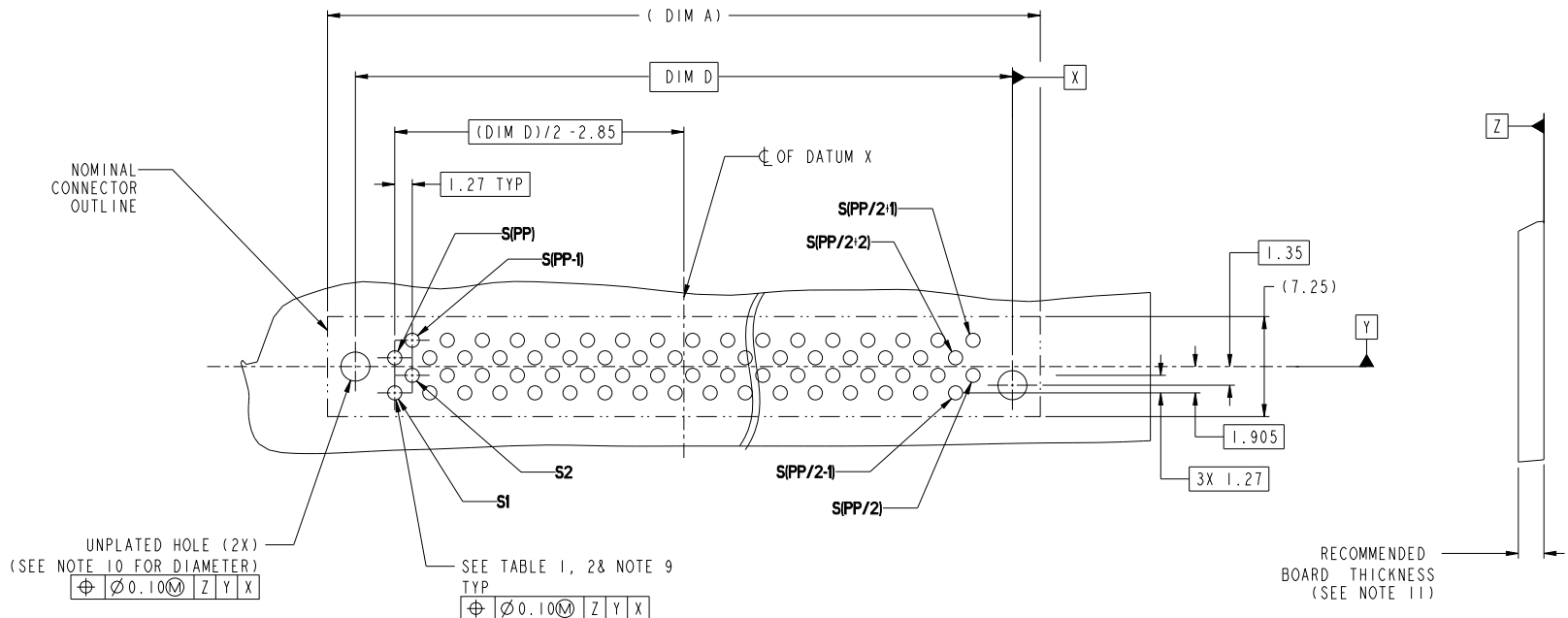

Copyright FCI.

spec ref	-	dr	Eric Jiang	20130209	projection	MM	size	A2	scale	4:1
tolerance std	ASME Y14.5	eng	Eric Jiang	20130905	chr		ecn no			
TOLERANCES UNLESS OTHERWISE SPECIFIED		appr	Pai-Ming Zhang	20130905	product family		rel level		Released	
surface	linear	0.X	±0.50	FCI	VERT RECT (ALL SIGNAL PINS)		eng no	10123730	rev	A
		0.XX	±0.25		HIGH POWER CARD EDGE					
	angular	0°	±2°		www.fci.com	cat. no.	Product - Customer Drw	sheet 2 of 4		

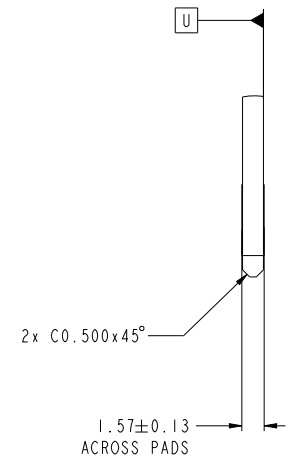
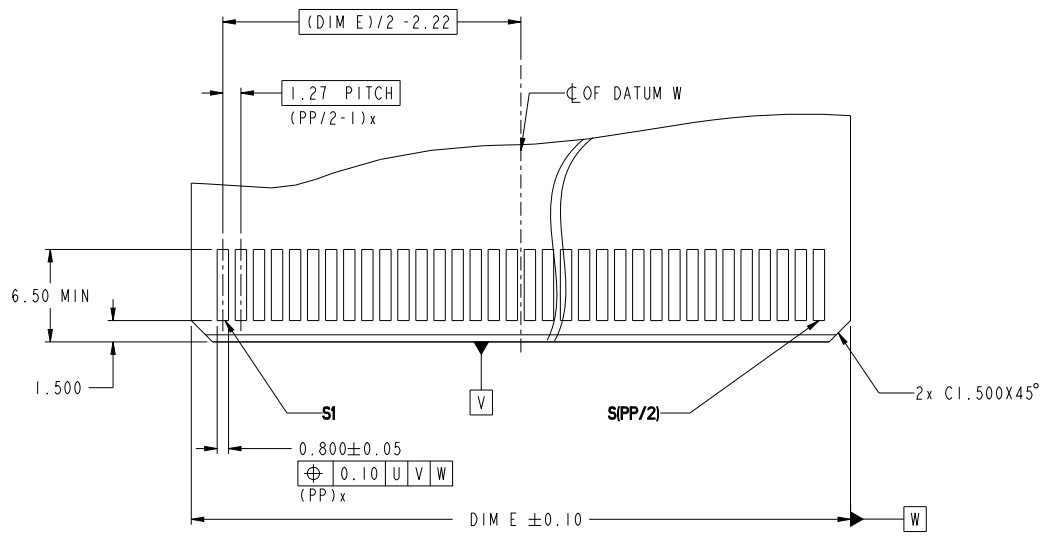

Copyright FCI.

spec ref	-			dr	Eric Jiang	20130209	projection	MM	size	A2	scale	4:1
tolerance std	ASME Y14.5			eng	Eric Jiang	20130905			ecm no	-		
TOLERANCES UNLESS OTHERWISE SPECIFIED				chr		20130905			rel level	Released		
surface	linear	0.X	±0.50	appr	Pai-Ming Zhang	20130905	product family					
		0.XX	±0.25			<b>TITLE</b> VERT RECT (ALL SIGNAL PINS) HIGH POWER CARD EDGE		eng no	10123730			
ASME Y14.5	angular	0.XXX	±0.10					www.fci.com	cat. no.	Product - Customer Drw	sheet 3 of 4	

PDS: Rev :A

STATUS: Released

Printed: Sep 10, 2013

10123730-0000 PP

LF

SIGNAL CONTACT QTY

LEAD FREE

TAIL TYPE NOTE 11	A	B
	STB	PF

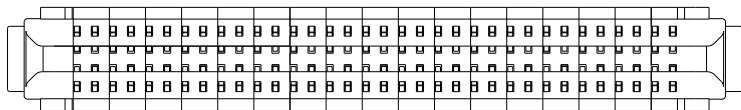

EXAMPLE: THE CONFIGURATION ABOVE IS 10123730-000068ALF  
STB VERT REC 68S

TABLE 3: PART NUMBER CODE, HPCE STD VERT REC S CONFIG

NOTES:

1. CONNECTOR MATERIALS:
  - HOUSING: HIGH TEMPERATURE THERMAL PLASTIC, BLACK  
UL 94V-0 COMPLIANT
  - CONTACTS: HIGH PERFORMANCE COPPER ALLOY.
2. CONTACT FINISH REF. GS-12-604 SECTION 5.2.
3. PRODUCT SPECIFICATION: GS-12-604.
4. APPLICATION SPECIFICATION: GS-20-128.
5. PRODUCT MARKING (FCI - PART NUMBER & DATE CODE) ON HOUSING IN AREA SHOWN.
6. PACKAGING MEETS FCI SPECIFICATION GS-14-937.
7. HOUSING COMPONENT WILL WITHSTAND EXPOSURE TO 260°C PEAK TEMPERATURE FOR 60 SECONDS IN A CONVECTION, INFRA-RED, OR VAPOR PHASE REFLOW OVEN.
8. COPPER PLATING THICKNESS IN CENTER OF VIA-HOLE CAN BE NO MORE THAN 0.003 LESS THAN OTHER AREAS.
9. ALL HOLE SIZES ARE FINISHED HOLE SIZES.
10. MOUNTING HOLES ARE UNPLATED
  - ∅ 2.40 +/- 0.1 FOR PRESS-FIT TAILS
  - ∅ 2.18 +/- 0.03 FOR SOLDER TAILS
11. STB=SOLDER TO BOARD, 1.57-2.38mm PCB THICKNESS.  
PF=PRESS FIT, 1.57mm MINIMUM PCB THICKNESS.

DIM	TABLE 2 LENGTH FORMULAS
DIM A	(PP/2)X1.27+8.47
DIM B	DIM A -5.00
DIM C	DIM A -2.34
DIM D	DIM A -4.04
DIM E	DIM A -5.30

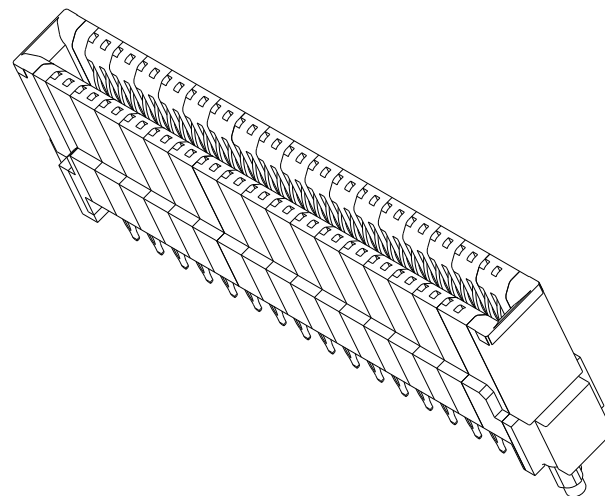

spec ref	-	dr	Eric Jiang	20130209	projection	MM	size	A2	scale	4:1
tolerance std	ASME Y14.5	eng	Eric Jiang	20130905	chr		ecm no			
TOLERANCES UNLESS OTHERWISE SPECIFIED		appr	Pui-Ming Zhang	20130905	product family		rel level		Released	
surface	linear	0.X	±0.50	FCI	VERT RECT (ALL SIGNAL PINS) HIGH POWER CARD EDGE	eng no	10123730	rev	A	www.fci.com
		0.XX	±0.25							
		0.XXX	±0.10							
ASME Y14.5	angular	0°	±2°	cat. no.	Product - Customer Drw	sheet 4 of 4				

PDS: Rev :A

STATUS: Released

Printed: Sep 10, 2013