

THIS COPY IS PROVIDED ON A RESTRICTED BASIS AND IS NOT TO BE USED IN ANY WAY DETRIMENTAL TO THE INTERESTS OF PANDUIT CORP.

NOTES:

1. VISIT OUR ON-LINE CATALOG AT WWW.PANDUIT.COM FOR A LIST OF CURRENT PARTS APPLICABLE FOR USE WITH THIS PRODUCT.
2. PRIMARY DIMENSIONS ARE IN MILLIMETERS (mm).
3. PARTS SUPPLIED:  
 (2) - PDU BRACKETS  
 (8) - TORX SCREWS  
 (1) - INSTRUCTION SHEET (NOT SHOWN)

PANDUIT P/N	WEIGHT
NVPDUBE	0.93 Kg/EACH 2.04 LBS/EACH

PDU MOUNTING BRACKET CAN BE ADJUSTED VERTICALLY ALONG CABINET PER RACK SPACE

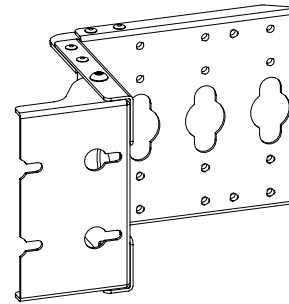

ISO VIEW

NET ACCESS N-TYPE PDU BRACKET (NVPDUBE)

CUSTOMER DRAWING

ITEM REVISION NAME

11V223AN/01

DATASET FILE NAME

11V223AN\_DC/01A

UNLESS OTHERWISE SPECIFIED, DIMENSIONAL TOLERANCES ARE:  
 INCHES    +/- 0.03    METRIC - MILLIMETER    ANGLE  
 X.X       +/- 0.018    X.X       +/- 0.8                    +/- 1°  
 X.XX      +/- 0.018    X.X       +/- 0.46  
 X.XXX    +/- 0.007    X.XX      +/- 0.18

MATERIAL:

N/A

DRAWING NUMBER:

11V223AN-DC

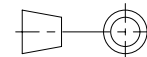

THIRD ANGLE PROJECTION

REV	DATE	BY	CHK	APR	DESCRIPTION	ECN	DRAWN BY	DATE	CHK	SCALE	SHT 1 OF 2	SIZE
01A	6/13/17	MEX-JAGC	SSP	ELE	RELEASED TO PRODUCTION	V09001HH/02	MEX-JAGC	6/13/17	SSP	NONE	SHT 1 OF 2	A

D10100DA/20

THIS COPY IS PROVIDED ON A RESTRICTED BASIS AND IS NOT TO BE USED IN ANY WAY DETRIMENTAL TO THE INTERESTS OF PANDUIT CORP.

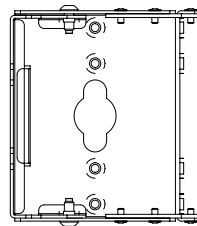
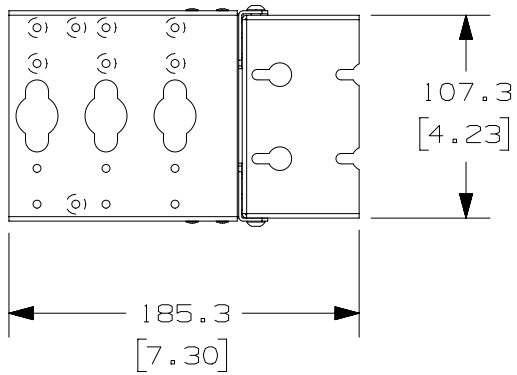
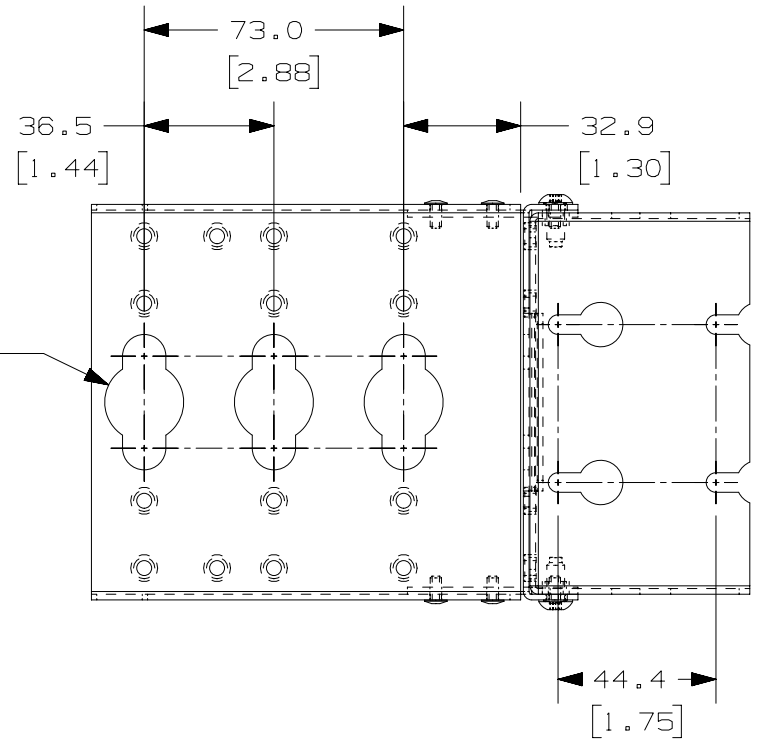
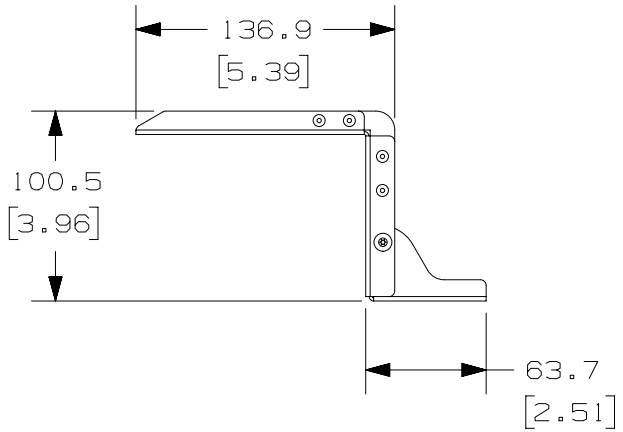

01A	6/13/17	MEX-JAGC	SSP	ELE	SEE SHEET 1 FOR REVISIONS				V09001HH/02
REV	DATE	BY	CHK	APR	DESCRIPTION	ECN			

TITLE				<b>NET ACCESS N-TYPE PDU BRACKET (NVPDUBE)</b>			
				CUSTOMER DRAWING			
ITEM REVISION NAME				11V223AN/01			
DATASET FILE NAME				11V223AN_DC/01A			
UNLESS OTHERWISE SPECIFIED, DIMENSIONAL TOLERANCES ARE:				MATERIAL:			
INCHES		METRIC - MILLIMETER		ANGLE		N/A	
X.X	+/- 0.03	X.	+/- 0.8				
X.XX	+/- 0.018	X.X	+/- 0.46		+/- 1°		
X.XXX	+/- 0.007	X.XX	+/- 0.18				
DRAWING NUMBER:				11V223AN-DC			
DRAWN BY		DATE		CHK		SCALE	
MEX-JAGC		6/13/17		SSP		NONE	
SHT 2 OF 2				A			

DL10100DA/20

2

1

2

1