

LOOSE PIECE		TAPE MOUNTED		SPECIFICATIONS							
MATERIAL NUMBER	ENGINEERING NUMBER	MATERIAL NUMBER	ENGINEERING NUMBER	STUD SIZE	"S" ±.005 [0.13]	"W" ±.010 [0.25]	"C" MIN.	"L" MAX.	"I.D." MIN.	"H"	STOCK THICKNESS
191930007	AA-320-04	191930008	AA-320-04T	4	.119 [3.02]	.225 [5.72]	.157 [3.99]	.484 [12.29]	.062 [1.57]	.980 [24.89]	.028 $\frac{+.001}{-.000}$ [0.71]
191930009	AA-320-06	191930011	AA-320-06T	6	.146 [3.71]						
191930012	AA-321-06	191930013	AA-321-06T	6	.146 [3.71]	.312 [7.93]	.270 [6.86]	.641 [16.28]	.062 [1.57]	.980 [24.89]	.028 $\frac{+.001}{-.000}$ [0.71]
191930014	AA-321-08	191930015	AA-321-08T	8	.173 [4.39]						
191930016	AA-321-10	191930017	AA-321-10T	10	.198 [5.03]						
191930021	AA-322-14	191930022	AA-322-14T	14	.265 [6.73]	.467 [11.86]	.386 [9.80]	.835 [21.21]	.062 [1.57]	.980 [24.89]	.028 $\frac{+.001}{-.000}$ [0.71]
191930023	AA-322-56	191930024	AA-322-56T	56	.328 [8.33]						
191930026	AA-326-14	---	---	14	.265 [6.73]	.534 [13.56]	.552 [14.02]	1.034 [26.26]	.054 [1.37]	---	.031±.001 [0.79]
191930034	AA-332-06	191930035	AA-332-06T	6	.146 [3.71]	.254 [6.45]	.240 [6.10]	.582 [14.78]	.062 [1.57]	.980 [24.89]	.028 $\frac{+.001}{-.000}$ [0.71]
191930036	AA-332-08	191930037	AA-332-08T	8	.173 [4.39]						

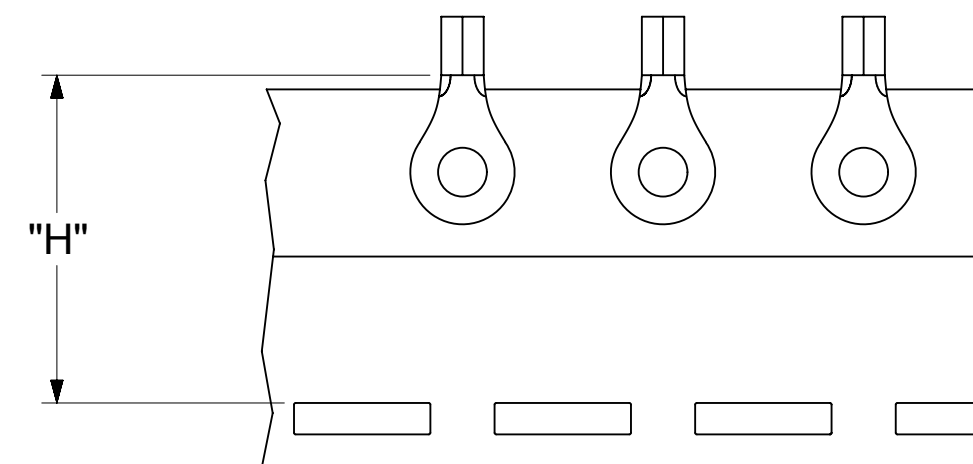
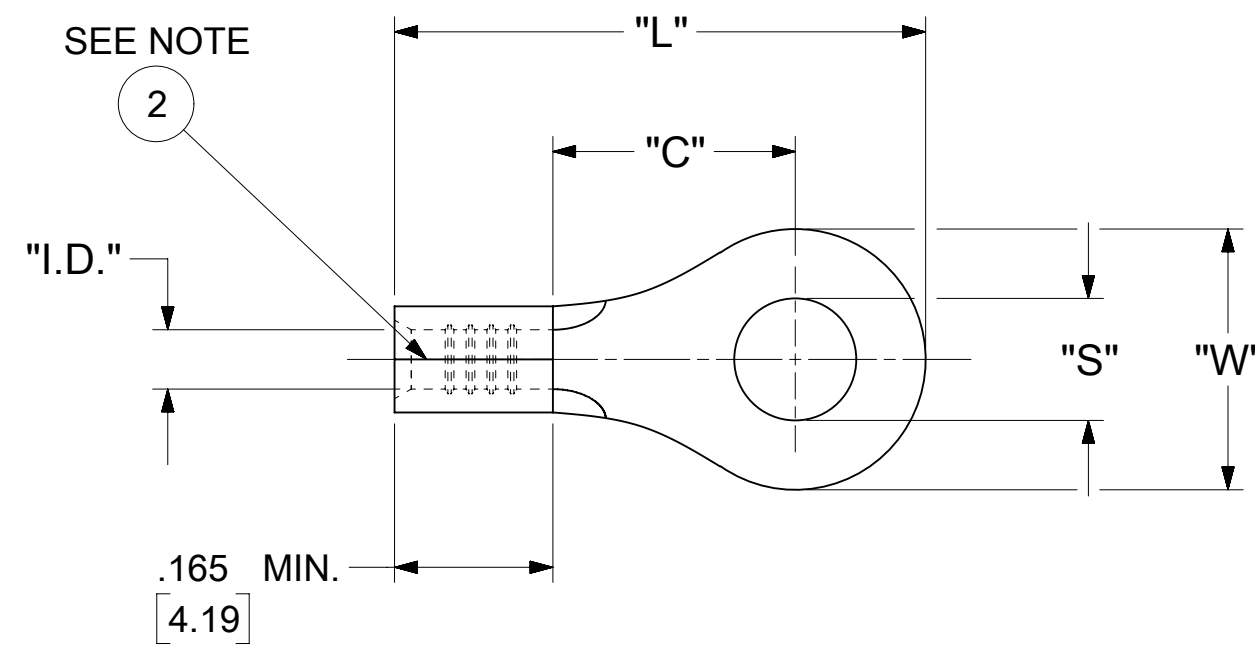

PARTS ON TAPE

NOTES:

- MATERIAL: COPPER
PLATING: ELECTRO-TIN (.0003 MIN).
- BRAZED SEAM
- WIRE SIZE: 22 - 18 AWG
0.25 - 1.5 MM²
- "UL" LISTING #E32244
"CSA" LISTING #18689
- ALL DIMENSIONS IN INCHES/[MM].
- PARTS ARE ROHS COMPLIANT.
- DIMS. SHOWN ARE FOR REFERENCE ONLY.

SYMBOLS	THIS DRAWING CONTAINS INFORMATION THAT IS PROPRIETARY TO MOLEX ELECTRONIC TECHNOLOGIES, LLC AND SHOULD NOT BE USED WITHOUT WRITTEN PERMISSION											
	DIMENSION UNITS	SCALE		CURRENT REV DESC: MIGRATION TO ECTR/NX								
▽ = 0	INCH/MM	NTS		molex RING TONGUE TERMINAL VERSAKRIMP 300-SERIES PRODUCT CUSTOMER DRAWING								
▽ = 0	GENERAL TOLERANCES (UNLESS SPECIFIED)											
▽ = 0		MM	INCH									
▽ = 0	4 PLACES	±	---	±	---	EC NO: 620820		DRWN: ABENJAMINLW 2019/07/08				
▽ = 0	3 PLACES	±	---	±	.005	DRWN: GROJAS01 2019/07/17		CHK'D: JMACNEIL 2019/08/06				
▽ = 0	2 PLACES	±	0.13	±	.01	APPR: JMACNEIL 2019/08/06		INITIAL REVISION:				
▽ = 0	1 PLACE	±	0.25	±	---	DRWN: JJ 1984/11/27		APPR: JMACNEIL 2019/08/06				
☒ = 0	0 PLACES	±	---	±	---	ANGULAR TOL ± 0.5 °		THIRD ANGLE PROJECTION				
■ = 0	DRAFT WHERE APPLICABLE MUST REMAIN WITHIN DIMENSIONS			DRAWING SERIES		C-SIZE 19193		DOCUMENT NUMBER				
▽ = 0								191930398				
DOCUMENT STATUS		P1	RELEASE DATE	2019/08/06	14:51:05	MATERIAL NUMBER		CUSTOMER		DOC TYPE	DOC PART	REVISION
12		11	10	9	8	7	6	5	4	3	2	1
SEE TABLE		GENERAL MARKET		1 OF 1								