

TOP VIEW

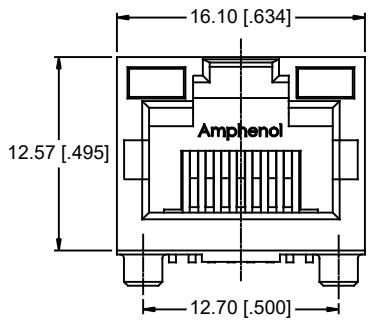

FRONT VIEW

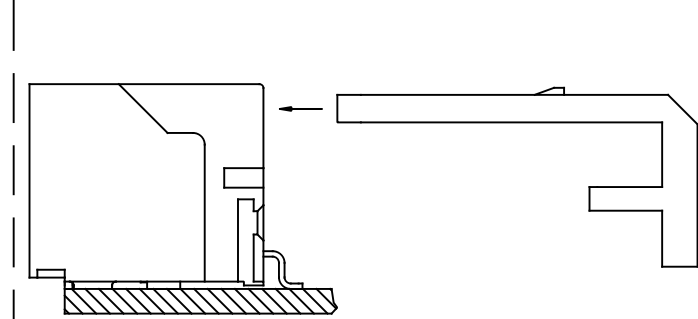

AFTER SOLDER REFLOW, LOAD LIGHT PIPE THROUGH THE CONNECTOR REAR ACCESS IN THE DIRECTION AS SHOWN

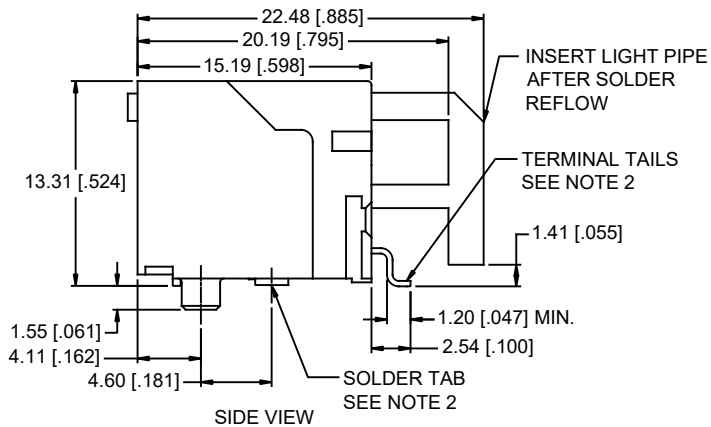

SIDE VIEW

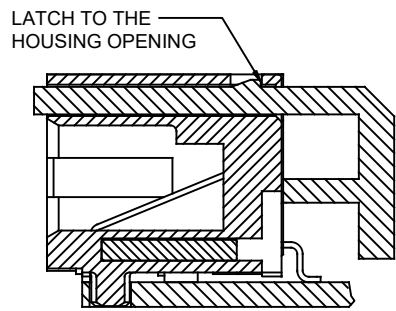

LATCH TO THE HOUSING OPENING

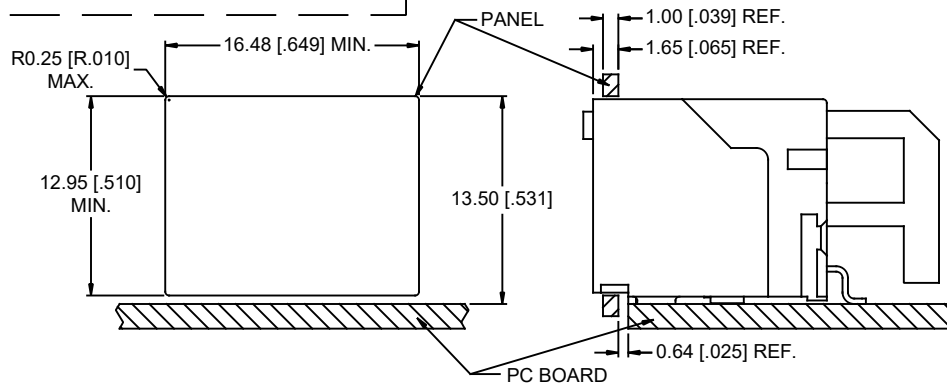

RECOMMENDED PANEL CUTOUT



REVISIONS				
REV	DESCRIPTION, ECN, EAR NO.	DATE	APP'D	
A	PROPOSAL	JUN20/08	L.CHAN	
B	CORRECT DIMENSION	JAN15/16	L.CHAN	
C	ADD PACKAGE INFORMATION	DEC08/21	L.CHAN	
D	ADD DIMENSIONS	FEB25/22	L.CHAN	

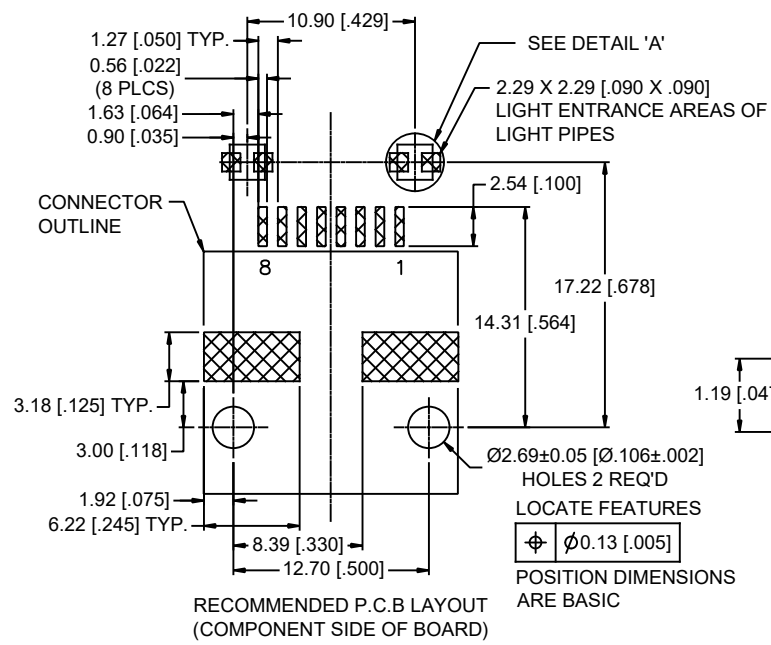

RECOMMENDED P.C.B LAYOUT (COMPONENT SIDE OF BOARD)

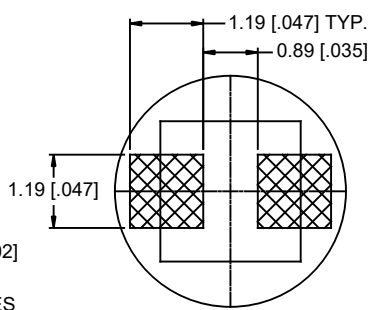

DETAIL 'A' (ENLARGED) SMT LED SOLDER PAD (SMT LED TO BE PROVIDED BY THE CUSTOMER)

NOTES:

- MATERIALS:
 PLASTIC HOUSING: ENGINEERING THERMOPLASTIC, FLAMMABILITY RATING UL 94V-0, COLOR: BLACK
 CONTACTS: PHOSPHOR BRONZE
 PLATING: 20u" [0.508 MICRONS] MINIMUM GOLD ON MATING SURFACE, 50u" [1.27 MICRONS] MINIMUM NICKEL UNDERPLATE, 100u" [2.54 MICRONS] MINIMUM MATTE-TIN ON SOLDER TAILS
 HOLD DOWN BRACKET: COPPER ALLOY
 PLATING: 100~300u" MATTE TIN OVERALL, 50u" MINIMUM NICKEL UNDERPLATE.
 LIGHT PIPE: CLEAR POLYCARBONATE RATED UL 94V-0
- COPLANARITY SPECIFICATION:
 WITH THE MODULAR JACK SITTING ON A LEVEL SURFACE AND ALL TERMINAL TAILS AND BOTH HOLD DOWN BRACKETS IS 0.10 [0.004].
- RECOMMENDED SOLDER PROCESS:
 REFLOW SOLDER PEAK TEMPERATURE 260°C FOR 10 SECONDS MAXIMUM.

AMPHENOL PART NUMBER: RJSSE-5081

UNLESS SPECIFIED OTHERWISE	DRAWN Huilan Wang	JUN20/08	Amphenol Canada Corp. Commercial Products
PRIMARY UNITS MILLIMETERS	CHECKED L.Chan	JUN20/08	
SECONDARY INCHES	M.E. APP'D		SURFACE MOUNT, RJ45 8 POSITION 8 CONTACTS, UNSHIELDED, WITH LIGHT PIPES, TRAY PACKAGING -RoHS COMPLIANT
REFERENCE IN PARENTHESES	Q.A. APP'D		
GENERAL TOLERANCES	DWG APP'D		DWG NO. P-RJSSE-5081
1 DECIMAL PLACE	ENG. REL. NO.		
2 DECIMAL PLACES ±0.38	REF.		REV D
3 DECIMAL PLACES	THIRD ANGLE PROJECTION	DO NOT SCALE DRAWING	CODE ID NO. 03554 DWG SIZE X SCALE XX:1 SHEET 1 OF 2
ANGULAR DEGREES ±1.5°			

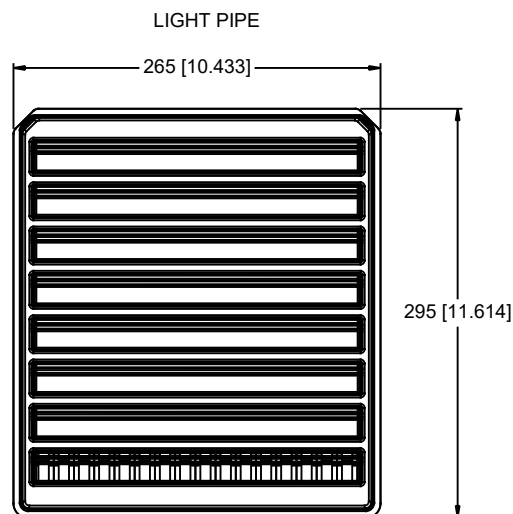
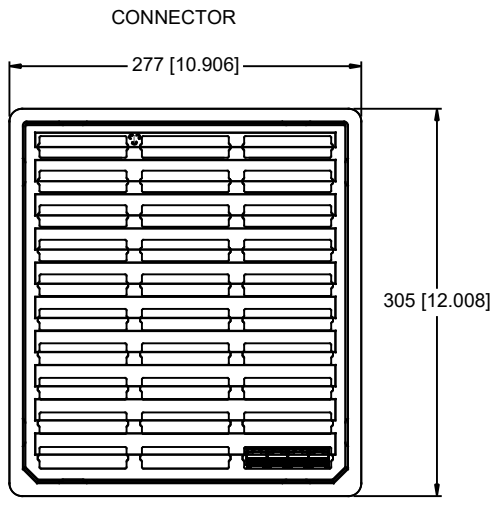

FIGURE 1

IMPORTANT NOTE:
FIGURE 1 SHOWS THE CONNECTOR
ORIENTATION (AFTER LOADING INTO THE TRAY)

PACKAGING NOTES:

1. A FULLY LOADED TRAY SHOULD CONTAIN 120 PCS CONNECTORS,
2. A FULLY LOADED TRAY SHOULD CONTAIN 128 PCS LIGHT PIPES,
3. A FULLY LOADED CARTON SHOULD CONTAIN 6 TRAYS(720 PCS) OF CONNECTORS AND 6 TRAYS(720 PCS) OF LIGHT PIPES.
4. THE PACKAGE MSL 1 COMPLIANT.

REVISIONS			
REV	DESCRIPTION, ECN, EAR NO.	DATE	APP'D
A	PROPOSAL	JUN20/08	L.CHAN
B	CORRECT DIMENSION	JAN15/16	L.CHAN
C	ADD PACKAGE INFORMATION	DEC08/21	L.CHAN
D	ADD DIMENSIONS	FEB25/22	L.CHAN

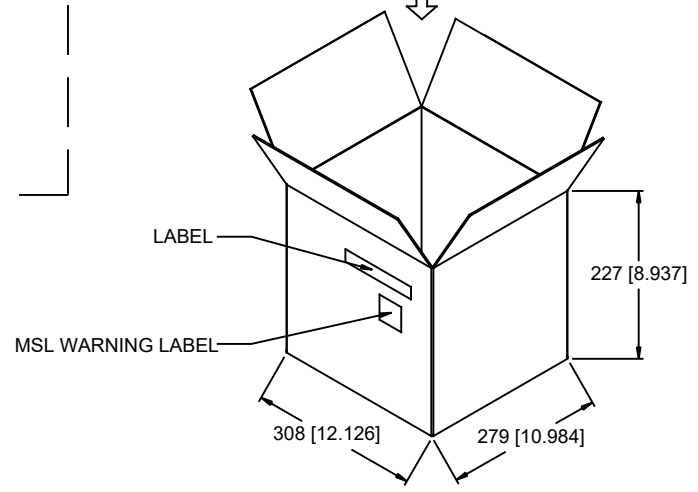
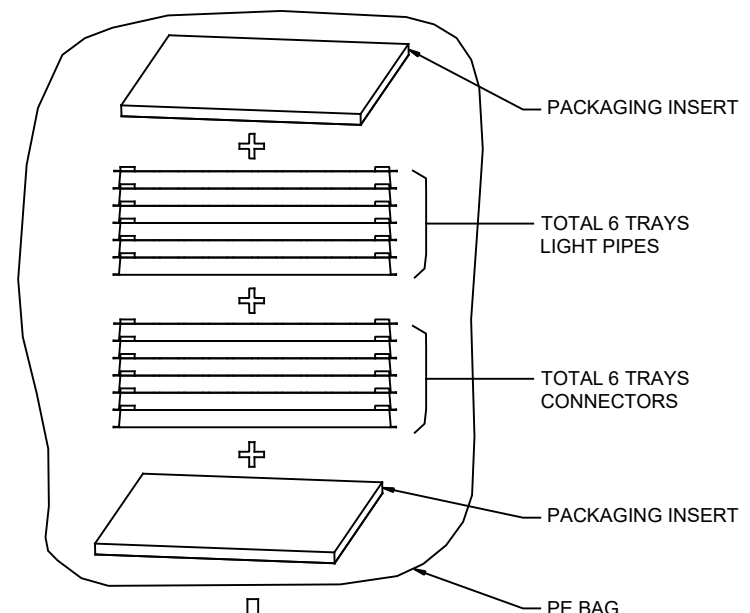

FIGURE 2
CARTON PACKAGING REFERENCE
(DIMENSIONS SHOWN INSIDE OF BOX)



UNLESS SPECIFIED OTHERWISE PRIMARY UNITS MILLIMETERS	DRAWN Huilan Wang JUN20/08 CHECKED L.Chan JUN20/08	Amphenol Canada Corp. Commercial Products
SECONDARY INCHES REFERENCE IN PARENTHESES	M.E. APP'D Q.A. APP'D	SURFACE MOUNT, RJ45 8 POSITION 8 CONTACTS, UNSHIELDED, WITH LIGHT PIPES, TRAY PACKAGING -RoHS COMPLIANT
GENERAL TOLERANCES	DWG APP'D	
1 DECIMAL PLACE	ENG. REL. NO.	DWG NO.
2 DECIMAL PLACES ±0.38	REF.	P-RJSSE-5081
3 DECIMAL PLACES	THIRD ANGLE PROJECTION	REV D
ANGULAR DEGREES ±1.5°	DO NOT SCALE DRAWING	CODE ID NO. 03554 DWG SIZE X SCALE XX:1 SHEET 2 OF 2