

REVISIONS				
REV	ECO	DESCRIPTION	DATE	BY APPR
A1	-	FIRST RELEASE	21-Nov-14	Tod TOMMY

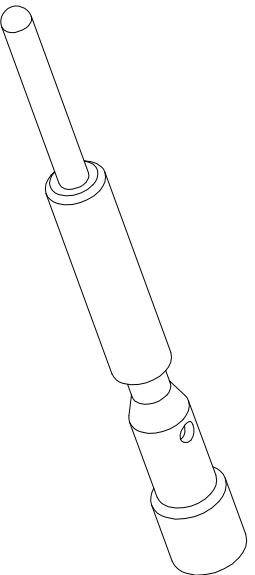
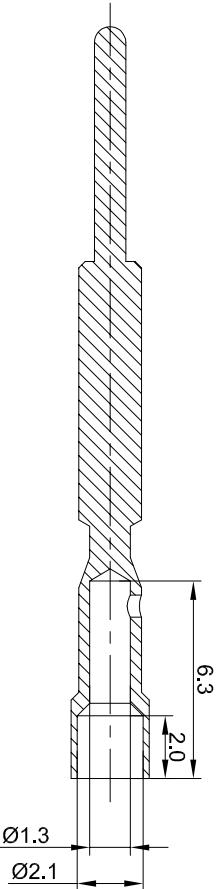
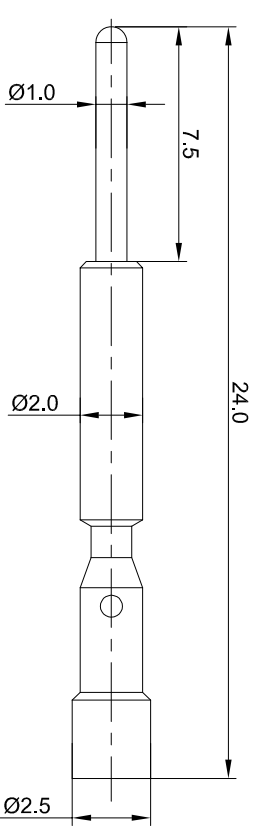

- NOTES: UNLESS OTHERWISE SPECIFIED
- MATERIAL: COPPER ALLOY, GOLD PLATED
 - SPECIFICATIONS:
 - RATED CURRENT: 7 AMPS
 - CONTACT RESISTANCE: <5 milliohm
 - AVAILABLE WIRE RANGE: 18-22AWG
 - ROHS COMPLIANT
 - ALL DIMENSIONS ARE FOR REFERENCE USE ONLY.

QUANTITY	SEE PART NUMBER CHART	PART NUMBER	DESCRIPTION	ITEM
MATERIALS LIST				
UNLESS OTHERWISE SPECIFIED				
1) All dimensions are in millimeters.				
2) Tolerances are as follows:				
1 Pt. DEC 20.30 Fractions .1754				
3 Pt. DEC 20.08 Angles .1°				
3) Note reference = A				
MATERIAL SPECIFICATIONS:		CUSTOMER:		
PROCESS SPECIFICATIONS:		THIS DRAWING IS SUPERSEDED BY ANY LATER DATED DRAWINGS. SPECIFICATIONS AND PERFORMANCE DATA ARE THE PROPERTY OF AMPHENOL CORPORATION. NO PORTS OF REPRODUCTION ARE PERMITTED. ALL MANUFACTURING VARIATIONS NORMAL.		
NEXT ASSY:		SCALE: 8 : 1		
		SHEET 1 OF 1		
		REVISION A1		

Amphenol

She Systems - www.amphenol-she.com
44724 Morley Drive
Clinton Township, MI 48036