

used for: D-SUB FILTER HD

NOTES:

1. METALSHELLS: STEEL; min. 320µ" TIN
2. INSULATORS: PBT GF UL 94 V-0, BLACK
3. CONTACTS: COPPER ALLOY
PLATING: 8µ" HARD GOLD OVER min. 50µ" NICKEL
4. METAL BRACKET: STEEL; min. 320µ" TIN over 80µ" NICKEL
5. THREADED INSERT: COPPER ALLOY; min. 200µ" TIN over 80µ" NICKEL
6. FIXING-PLATE: PBT GF UL 94 V-0, BLACK
7. CAPACITANCE: SEE TABLE
8. DIELECTRIC WITHSTANDING VOLTAGE: 300 VDC
9. MAXIMUM TORQUE VALUE FOR THREAD: 6" LBS
10. CONNECTOR IS PART MARKED: PART-NÖ. CONEC ABC

CAPACITANCE	CAPACITANCE	CAPACITANCE
180pF ±20%	370pF ±20%	830pF ±20%
242A26610X	242A25650X	242A25690X

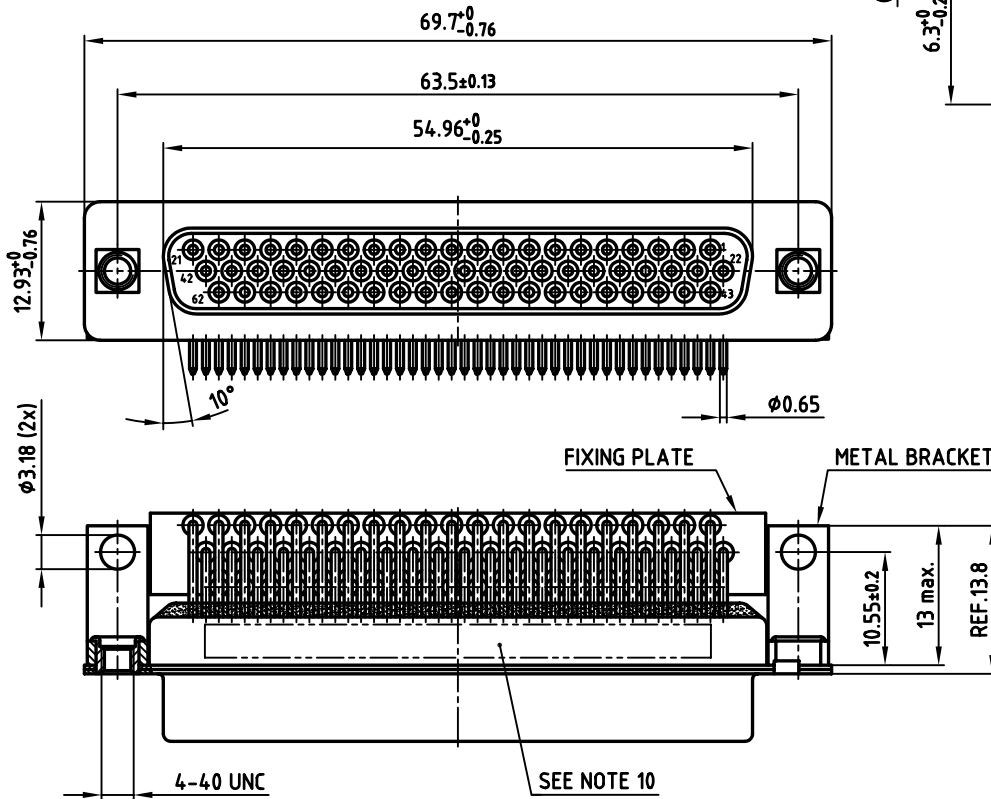
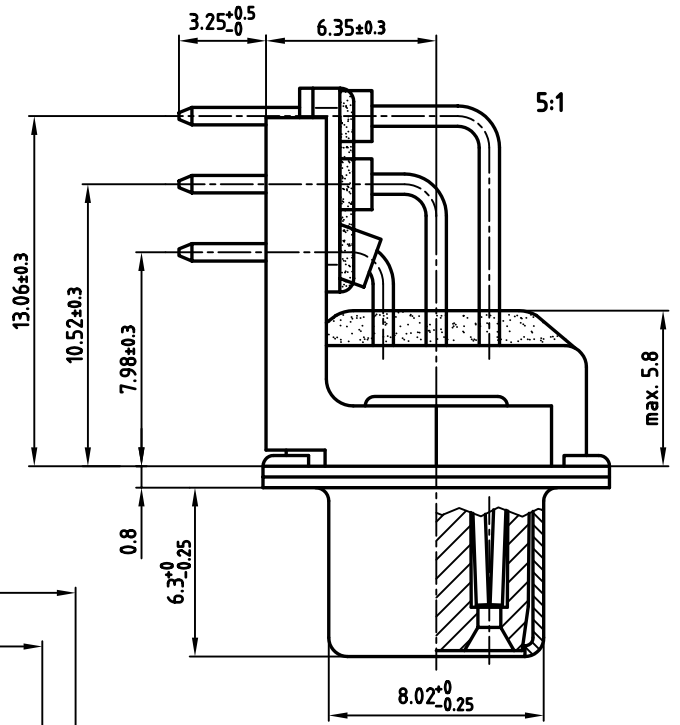

P.C.B. HOLE PATTERN

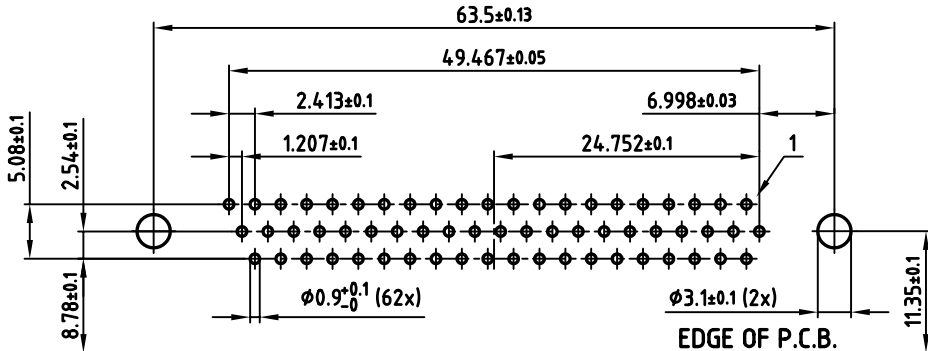

APPROVAL # FREIGABE # DEBLOCAGE # AUTOR/ZACION # APPROVAL		tolerance		dim. in mm	scale: 2:1 (5:1)
CUSTOMER APPROVAL DATE:		2005 date			material: SEE NOTES
NAME:	TITLE:	drawn	09.02.	Lehmenkühler	title: D-SUB HD FILTER FEMALE 90° 62pos. 0.350inch with metal bracket and threaded insert
COMPANY NAME:		appd.	09.02.	Mickenbecker	
APPROVAL # FREIGABE # DEBLOCAGE # AUTOR/ZACION # APPROVAL		norm		d-old	dwg no: AutoCAD 2004 DIN-A
THIS DRAWING MAY NOT BE COPIED OR REPRODUCED IN ANY WAY, AND MAY NOT BE PASSED ON TO A THIRD PARTY WITHOUT WRITTEN PERMISSION. OWNERSHIP AND COPYRIGHT OF CONEC GmbH DO NOT ALTER CAD DRAWING BY HAND					part no: SEE TABLE
rev.	description	date	name		3 sh: 1/1