

This drawing involves proprietary design rights of Tyco Electronics Corporation, and all design, manufacture, reproduction, use and sale rights regarding the same are expressly reserved. It is submitted for a specific purpose and the recipient by accepting this drawing, assumes custody and control and agrees to take reasonable precautions: (a) that this drawing will not be copied and reproduced, in whole or in part, or its contents revealed in any manner, or to any person except to meet the purpose for which it was delivered and (b) that any special features peculiar to this design will not be incorporated in other projects without the expressed written permission of Tyco Electronics Corporation.

| REVISIONS | | | |
|-----------|-----|-------------|----------|
| EC | REV | DESCRIPTION | DATE |
| CPR | A | NEW RELEASE | 02/16/06 |

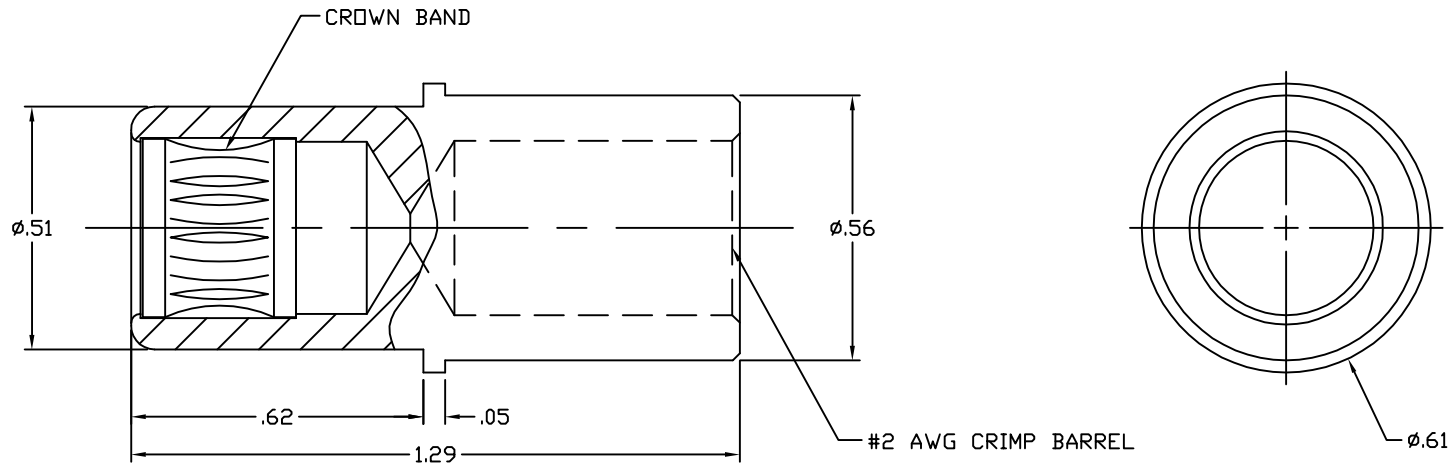

4. FOR TERMINATION, USE FOLLOWING EQUIPMENT:

INDENTOR DIE SET: 84C-E011
 CRIMP TOOL: 84C-E031
 LOCATOR: PIC0# 4066

3. FINISHES:

SOCKET BODY: SILVER PLATED, .000200 MIN THICK
 OVER NICKEL PLATED, .000040 MIN THICK
 CROWN BAND: GOLD PLATED, .000030 MIN THICK
 OVER NICKEL PLATED, .000040 MIN THICK

2. MATERIAL:

SOCKET BODY: TELLURIUM COPPER ALLOY,
 CROWN BAND: BERYLLIUM COPPER ALLOY.

1. PART NUMBER CHANGES AND OR DESIGN CHANGES AFFECTING ITEM INTERCHANGEABILITY REQUIRE PRIOR ELCON APPROVAL AND AUTHORIZATION BY REVISION TO THIS DRAWING.

NOTES: UNLESS OTHERWISE SPECIFIED

| | | | | | | |
|--|---------------|----------|--|-------------|----------|-------------------------|
| INCH OR INCH (MM) THIRD ANGLE PROJECTION UNLESS OTHERWISE SPECIFIED DIMENSIONS ARE IN INCHES (METRIC) TOLERANCES ANGLES ± .5° DECIMALS .XXX ± .010 (.25) .XX ± .02 (.3) | DRAWN | DATE | 6648407-1 | | AS SHOWN | |
| | HA NGUYEN | 02/16/06 | PART NUMBER | DESCRIPTION | | |
| | CHECKED | | Tyco Electronics Corporation Menlo Park, Ca 94025 | | | |
| | APPROVED | | TITLE | | | |
| | APPROVED | | CONTACT, SOCKET, SIZE #0 WITH #2 AWG CRIMP BARREL SINGLE CROWN | | | |
| | S. FLICKINGER | 02/16/06 | SIZE | DWG NUMBER | REV. | |
| | DCA APPROVED | | B | C = 6648407 | A | |
| | HA NGUYEN | 02/16/06 | ACAD FILE NUMBER C6648407A.DWG | | | DWG SCALE 4=1 SH 1 OF 1 |