

THIS DRAWING IS UNPUBLISHED. RELEASED FOR PUBLICATION  
 © COPYRIGHT - By - ALL RIGHTS RESERVED.

LOC		DIST		REVISIONS			
P	LTR	DESCRIPTION		DATE	DWN	APVD	
AD	00	A2	REVISED PER ECO-11-004820		11MAR11	RK	HMR

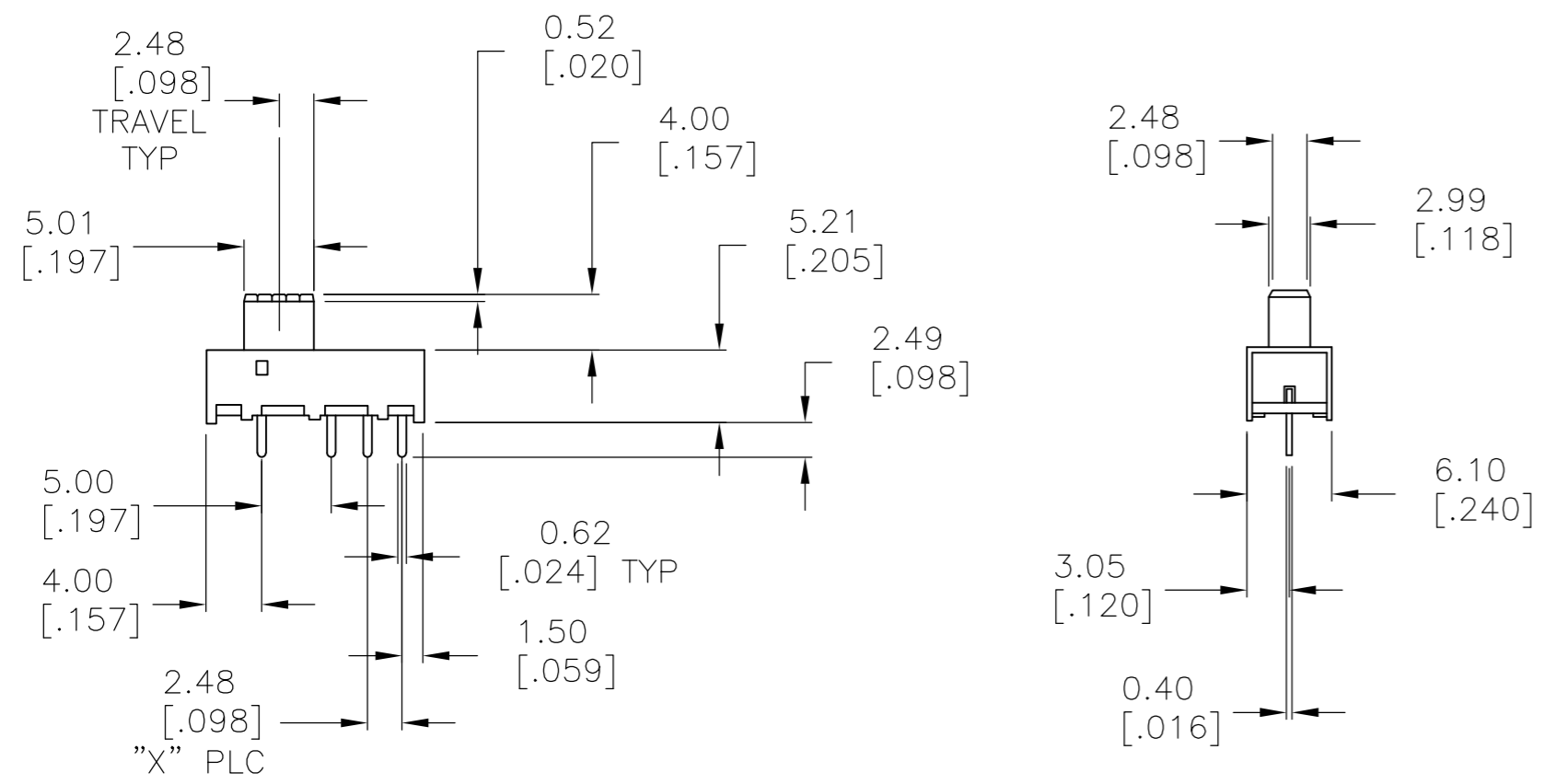

1825161-1 AS SHOWN

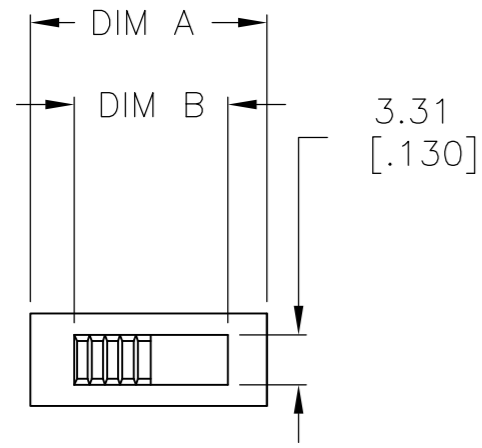
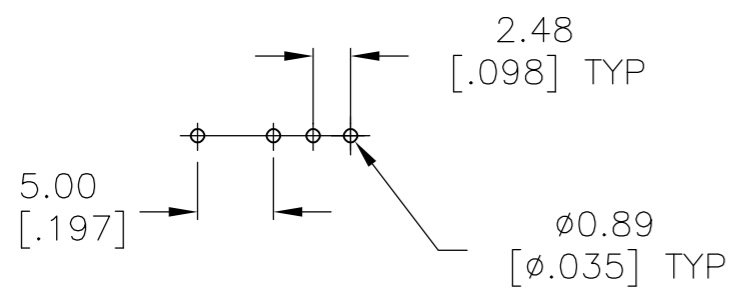
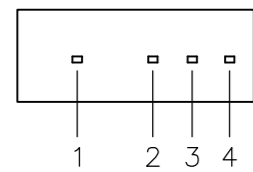

P.C. HOLE LAYOUT (1825161-1)

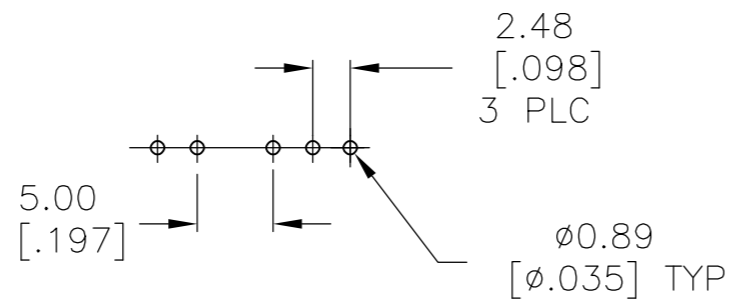

P.C. HOLE LAYOUT (1825161-2)

SPECIFICATIONS:  
 MAKE-BEFORE-BREAK

MATERIALS:  
 FRAME: STEEL, ZINC PLATE  
 ACTUATOR: POM UL94HB, BLACK  
 FIXED CONTACT/TERMINAL: COPPER ALLOY, SILVER OVER NICKEL PLATE  
 MOVING CONTACT: COPPER ALLOY, SILVER CLAD  
 COIL SPRING: TEMPERED STEEL WIRE  
 BALL- TEMPERED CARBON STEEL  
 TERMINAL BOARD: PHENOLIC, UL94HB  
 TERMINAL SEAL: EPOXY

ELECTRICAL:  
 CONTACT RATING: 250 MILLIAMPS@125V AC  
 CONTACT RESISTANCE: 30 MILLIOHMS MAX (INITIAL), 60 MILLIOHMS AFTER TEST  
 INSULATION RESISTANCE: 500 MEGOHMS MIN AT 500V DC  
 DIELECTRIC STRENGTH: 500 VAC RMS AT SEA LEVEL  
 LIFE EXPECTANCY: 10,000 CYCLES MIN. NO LOAD

MECHANICAL:  
 ACTUATION FORCE: 250 +150/-100 GRAMS  
 TRAVEL: 2.49 (.098)

ENVIRONMENTAL:  
 OPERATING TEMPERATURE: -10° TO +60°C  
 STORAGE TEMPERATURE: -10° TO +60°C  
 RESISTANCE TO SOLDER HEAT: 260°C FOR 10 SEC PER 109-202, COND. B  
 SOLDERABILITY: PER EIA-364-56A, PROCEDURE 3, COND. B

- NOTES:
- ALL MATERIALS AND FINISHES SHALL COMPLY WITH EU DIRECTIVE 2002/95/EC OF 27JAN2003 (ROHS)
  - ALL PERFORMANCE SPECIFICATIONS WERE TESTED IN ACCORDANCE WITH JIS-C-5441 UNLESS OTHERWISE STATED.

1-3	2-3	3-4	3-5	-	-	-		3	12.50[.492]	18.01[.709]	SP4T	STS1400PC04	1825161-2
-	-	-	-	1-2	2-3	2-4		2	10.01[.394]	15.50[.610]	SP3T	STS1300PC04	1825161-1
							BOTTOM VIEW	X PLC	DIM B	DIM A	FUNCTION	T&B P/N	P/N
FUNCTION DIAGRAM													

THIS DRAWING IS A CONTROLLED DOCUMENT.

DIMENSIONS: mm [INCHES]	TOLERANCES UNLESS OTHERWISE SPECIFIED: 0 PLC ± - 1 PLC ± - 2 PLC ± 0.20[.008] 3 PLC ± - 4 PLC ± - ANGLES ± -	DWN B.S.VISWESWARA CHK M S SARVER APVD -	01APR05	TE Connectivity	
MATERIAL	FINISH	PRODUCT SPEC	APPLICATION SPEC	SLIDE SWITCH, STS1300PC & STS1400PC SERIES	
		WEIGHT	SCALE	SHEET	REV
			A2	00779	A2
CUSTOMER DRAWING			SCALE 2:1	SHEET 1 of 1	REV A2