

1 2 3 4 5 6 7

A
B
C
D
E
F
G
H

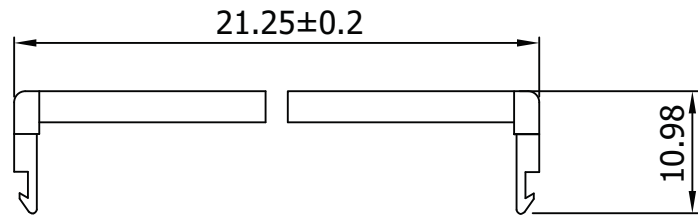
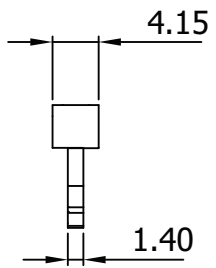

SR

I.D.C SOCKET DUAL-ROW

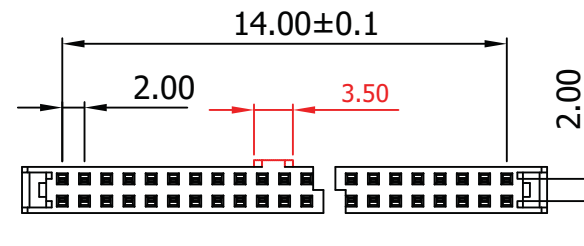
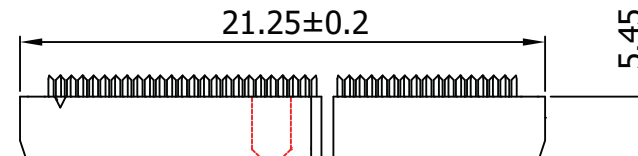
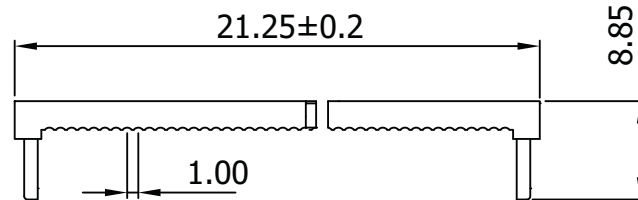
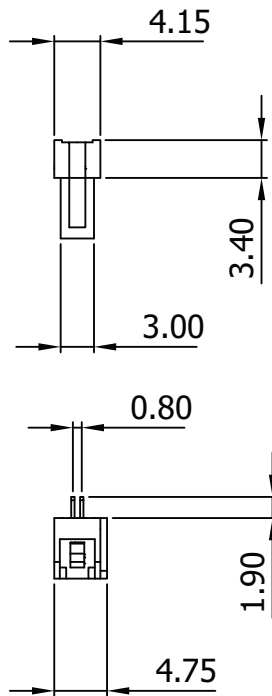
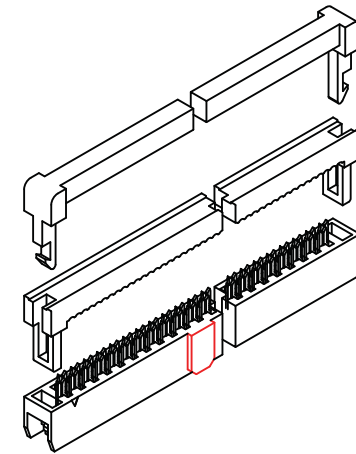

Material:

- Insulator: P.B.T. 30% Glass Fiber, UL 94V-0
- Contact Material: Phosphor Bronze, Gold flash over Nickel

Electrical:

- Current Rating: 1Amp DC
- Insulation Resistance: 1,000MΩ Min.
- Dielectric Withstanding: 500V AC
- Operating Temperature: -55°C ~ +105°C

Unit: MM±0.30MM

Scale	1:1					Name
TOLERANCE					Drawn	10.19.11
X.X	±0.40				Approved	Chappell
X.XX	±0.25					
X.XXX	±0.15					
Angle	±3°					
				Modification		



Item No.
AWP2-16-7241-T-R

Title IDC-Socket - 2.00MM Pitch,
Gold Flash, Central Lug w/Strain Relief,
16 Contacts

Drawing No. _____

Replace _____

rev00

Sheet _____

1 2 3 4 5 6 7

A
B
C
D
E
F
G
H

