

THIS DRAWING IS UNPUBLISHED. RELEASED FOR PUBLICATION  
 © COPYRIGHT BY TYCO ELECTRONICS CORPORATION. ALL RIGHTS RESERVED.

LOC	DIST	REVISIONS					
FT	0	P	LTR	DESCRIPTION	DATE	DWN	APVD
		E		REVISED PER ECO-10-004812	04MAY10	HMR	CR

MATERIALS:  
 HOUSING: THERMOPLASTIC, UL94V-0, BLACK.  
 TERMINAL: BRIGHT TIN OVER COPPER ALLOY.  
 SCREWS: 8-32, ZINC PLATED STEEL.

ELECTRICAL:  
 CURRENT RATING: 30A  
 VOLTAGE RATING: 600V  
 WIRE RANGE: 10-18 AWG (UL)  
 10-22 AWG (CSA)

MECHANICAL:  
 RECOMMENDED TORQUE: 20 IN-LB.  
 OPERATING TEMP.: -40°C TO +120°C MAX.

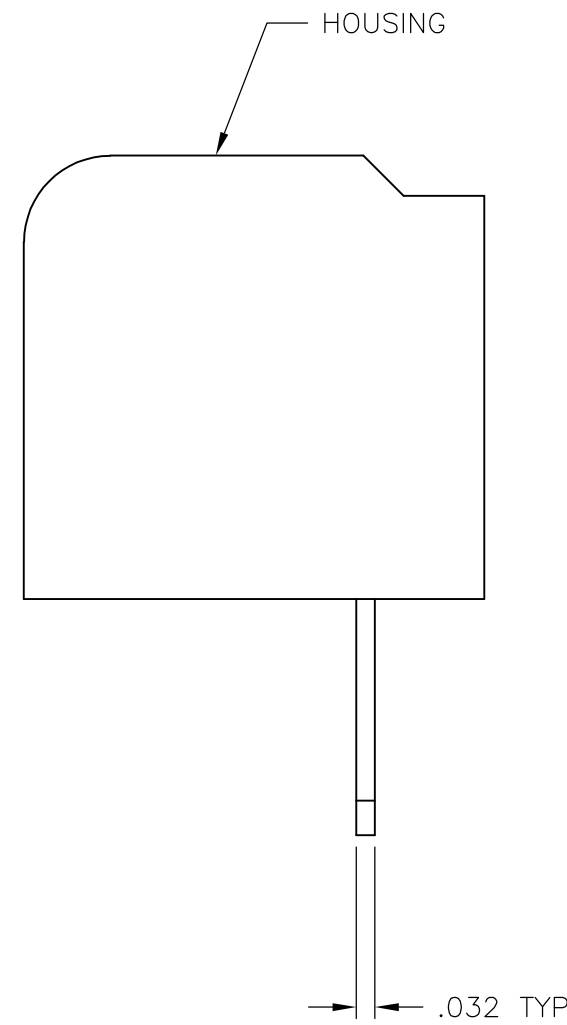
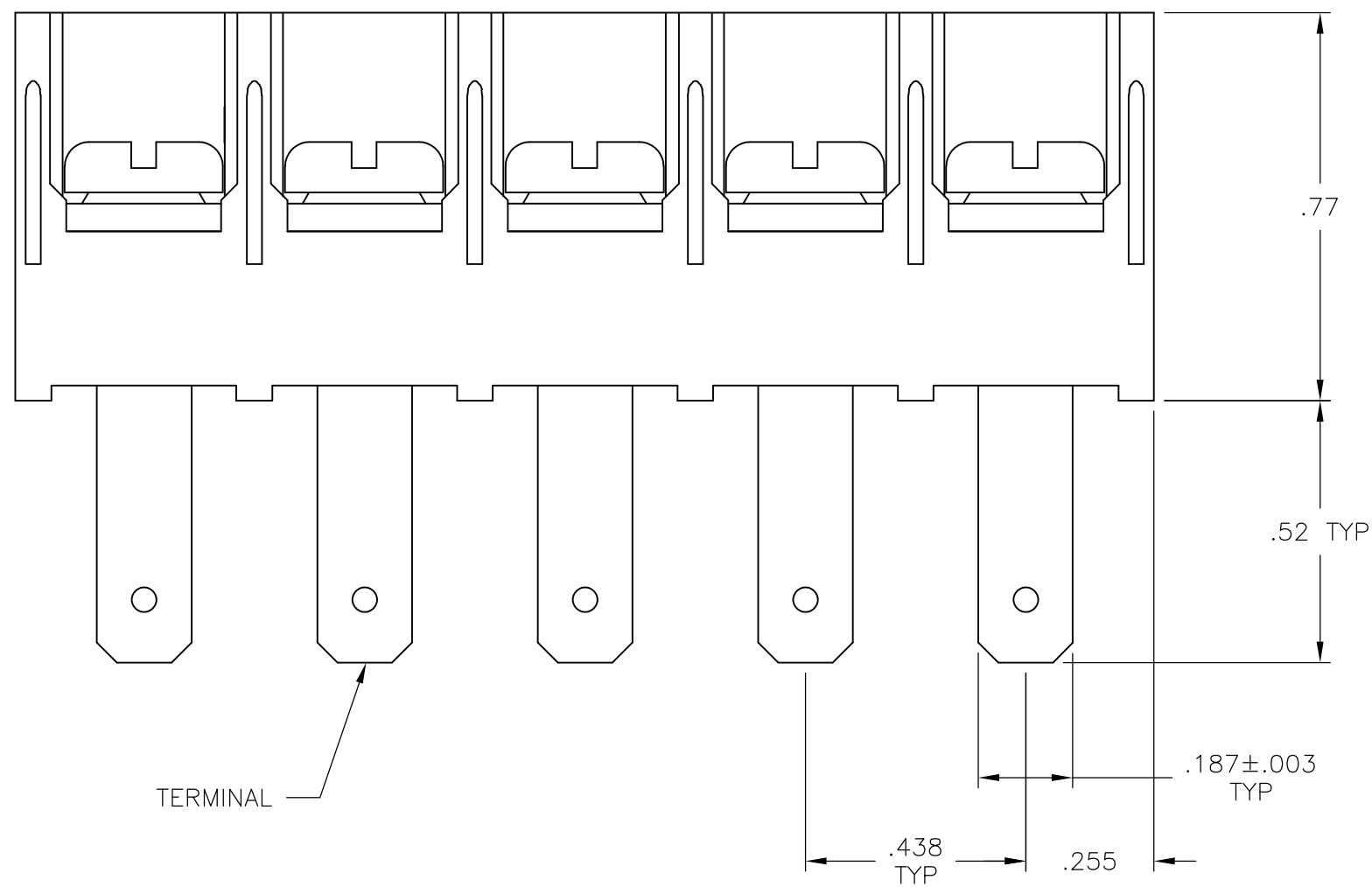
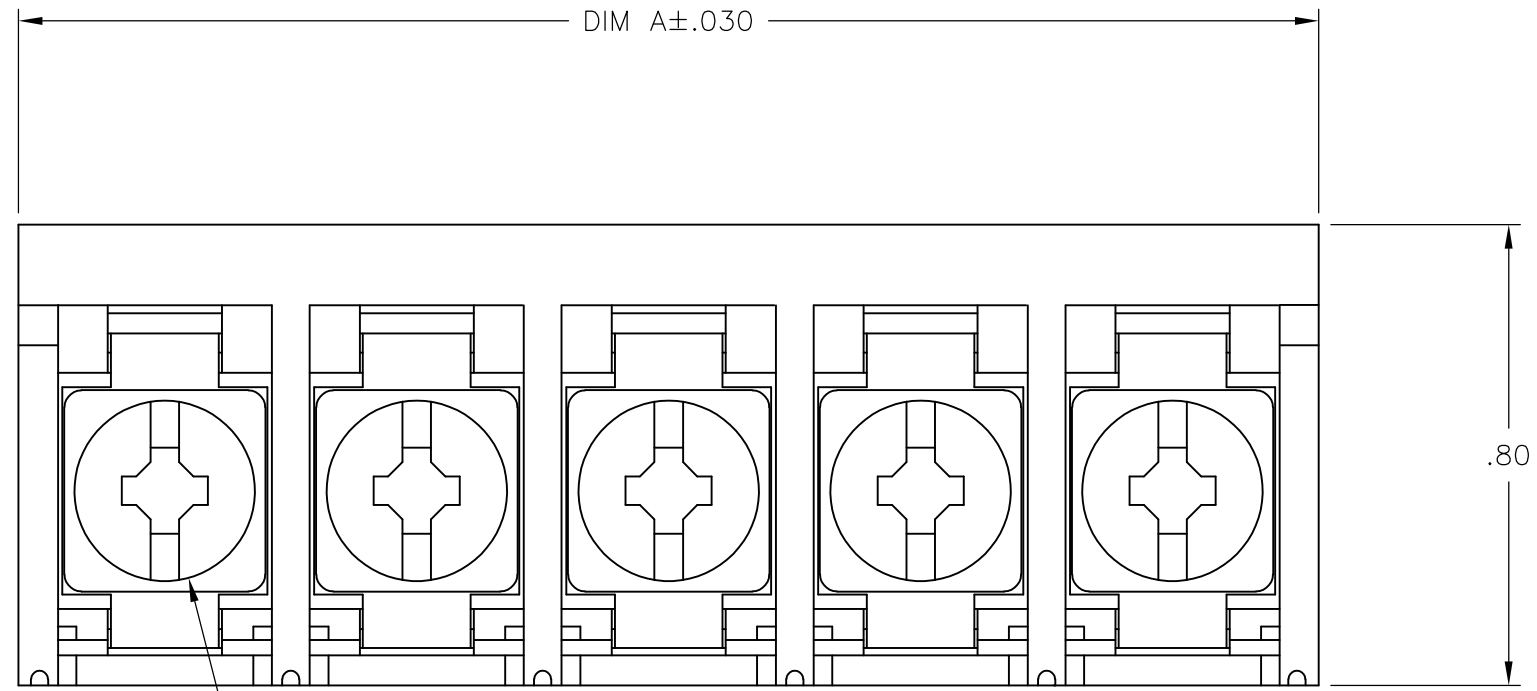

OBSOLETE	8QCV-26-008	10.937	26	2-1546296-6
OBSOLETE	8QCV-25-008	10.500	25	2-1546296-5
OBSOLETE	8QCV-24-008	10.062	24	2-1546296-4
OBSOLETE	8QCV-23-008	9.625	23	2-1546296-3
OBSOLETE	8QCV-22-008	9.187	22	2-1546296-2
OBSOLETE	8QCV-21-008	8.750	21	2-1546296-1
	8QCV-20-008	8.823	20	2-1546296-0
	8QCV-19-008	8.385	19	1-1546296-9
	8QCV-18-008	7.948	18	1-1546296-8
	8QCV-17-008	7.510	17	1-1546296-7
	8QCV-16-008	7.073	16	1-1546296-6
	8QCV-15-008	6.635	15	1-1546296-5
	8QCV-14-008	6.198	14	1-1546296-4
	8QCV-13-008	5.760	13	1-1546296-3
	8QCV-12-008	5.323	12	1-1546296-2
	8QCV-11-008	4.885	11	1-1546296-1
	8QCV-10-008	4.448	10	1-1546296-0
	8QCV-09-008	4.010	9	1546296-9
	8QCV-08-008	3.573	8	1546296-8
	8QCV-07-008	3.135	7	1546296-7
	8QCV-06-008	2.698	6	1546296-6
	8QCV-05-008	2.260	5	1546296-5
	8QCV-04-008	1.823	4	1546296-4
	8QCV-03-008	1.385	3	1546296-3
	8QCV-02-008	.948	2	1-1437659-2
CATALOG NUMBER	DIM A	NO OF POSN	PART NUMBER	

THIS DRAWING IS A CONTROLLED DOCUMENT.		DWN	S SCHLEGEL	19SEP2005	Tyco Electronics Corporation Harrisburg, PA 17105-3608		
DIMENSIONS: INCHES		CHK	S YODER	9/19/05			
TOLERANCES UNLESS OTHERWISE SPECIFIED:		APVD	S YODER	9/19/05			
0 PLC ± - 1 PLC ± - 2 PLC ± .02 3 PLC ± .010 4 PLC ± - ANGLES ± - FINISH -		PRODUCT SPEC	NAME			ASSEMBLY, DUAL BARRIER 8QCV-XX-008	
MATERIAL		APPLICATION SPEC	SIZE		CAGE CODE	DRAWING NO	RESTRICTED TO
-		WEIGHT	A2		00779	C=1-1437659-2	-
CUSTOMER DRAWING		SCALE	1:1		SHEET	1 of 1	
		REV					E