

P.C.B. HOLE DRILLINGS  
(P.C.B. TOP SIDE)

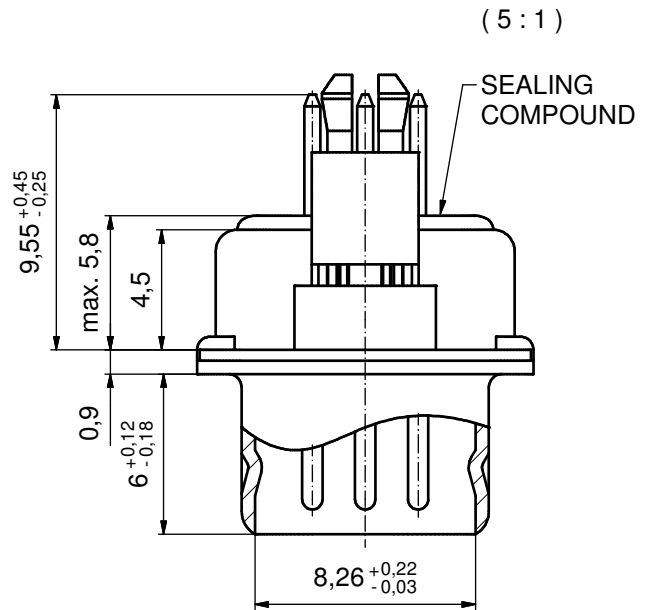
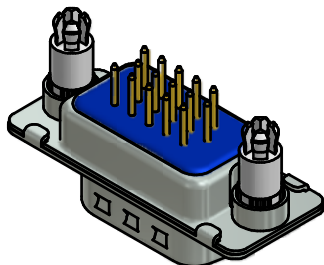
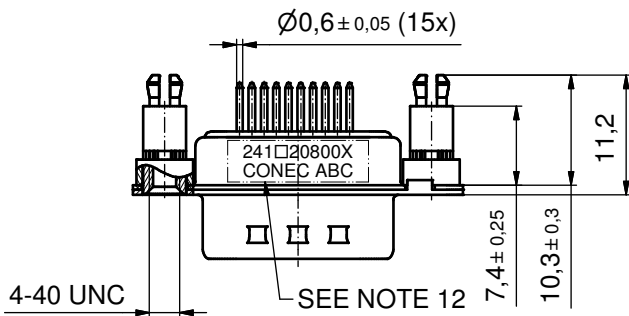
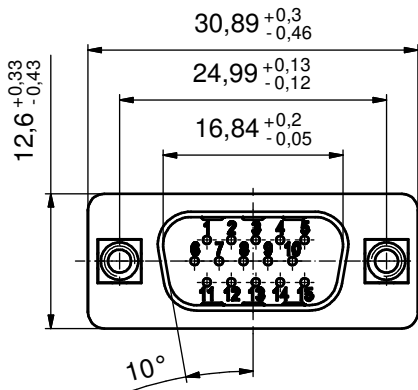

NOTES:

- RoHS COMPLIANT
- FOR WAVESOLDERING (SOLDER BATH TEMPERATURE 260 °C FOR 5 SEC. AND SOLDER PREHEAT 100 °C FOR 30 SEC.)
- METALSHELLS: STEEL; min. 315µm TIN over 40-80µm NICKEL
- INSULATORS: HIGH TEMPERATURE PLASTIC UL 94 V-0, BLACK
- CONTACTS: COPPER ALLOY; PLATING (SEE PART NO.):  
 PLEASE ADD A for GOLD FLASH over NICKEL (PREFERRED TYPE)  
 PLEASE ADD B for 20µm HARD GOLD over min. 50µm NICKEL  
 PLEASE ADD C for 30µm HARD GOLD over min. 50µm NICKEL  
 CONTACTS TAILS PRETINNED
- THREADED SPACER CLIPS: COPPER ALLOY; min. 200µm TIN over 80µm NICKEL  
 PCB-HOLE: Ø3,1 ± 0,1; PCB THICKNESS 1,6mm
- COLLARS: COPPER ALLOY; min 200µm TIN over 80µm NICKEL
- SEALING COMPOUND: PUR; BLUE
- DIELECTRIC WITHSTANDING VOLTAGE: 300 VDC
- CAPACITANCE: 830pF ± 20%
- MAXIMUM TORQUE VALUE FOR THREAD: 6 in. LB
- CONNECTOR IS PART MARKED: 241□20800X CONEC ABC (see note 5)

Directive 2002/95/EC RoHS compliant

THIS DRAWING MAY NOT BE COPIED OR REPRODUCED IN ANY WAY, AND MAY NOT BE PASSED ON TO A THIRD PARTY WITHOUT WRITTEN PERMISSION. OWNERSHIP AND COPYRIGHT OF CONEC GmbH DO NOT ALTER CAD DRAWING BY HAND	tolerance		dim. in mm	scale: 2:1 (5:1)			
				material: SEE NOTES			
	date	name		title: <b>D-SUB HD FILTER MALE</b> 15pos. SOLDER PIN STRAIGHT with threaded spacer clip			
	drawn	17.07.13	Henneboel				
	appd.	17.07.13	Fischer				
norm	d-old		dwg no:		DIN-A3		
a	Original			24K1A1455			
rev.	description	date	name	part no: 241□20800X (see note 5)		sh: 1	