



Copyright FCI.

A

B

C

D

A

B

C

D

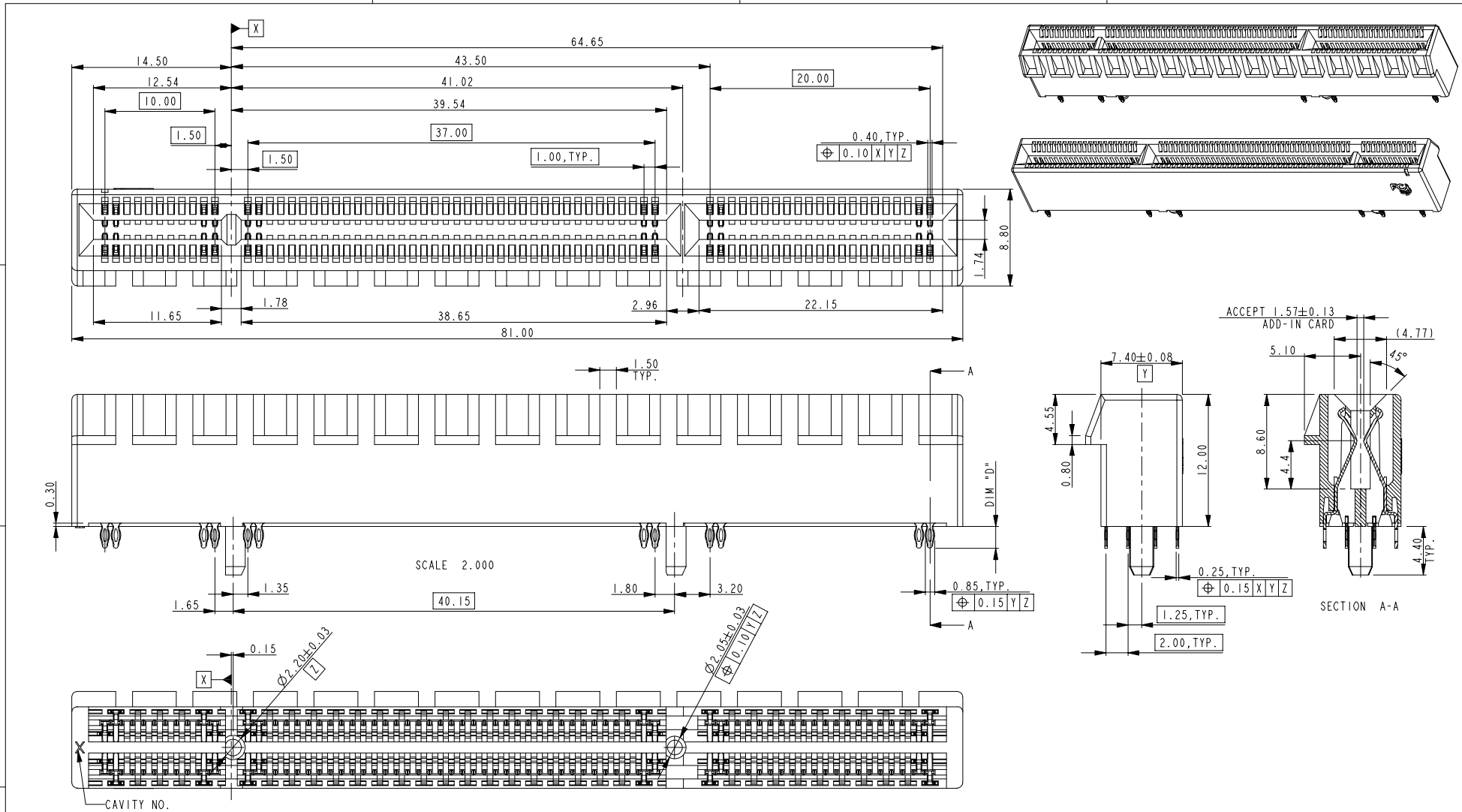

spec ref	x	dr	Stone LI	2015-05-24	projection	MM	size	scale			
tolerance std	TOLERANCES UNLESS OTHERWISE SPECIFIED	eng	Stone LI	2015-05-24			A4	1.000			
ISO 406		chr	/	/			ecn no	ELX-DG-21161-1			
ISO 1101		appr	PM ZHENG	2015-05-24		product family	rel level	-			
surface		linear	0.X	±0.30							
ISO 1302		0.XX	±0.20								
		0.XXX	±0.10								
angular	0°	±2°									
				PRESS FIT TYPE 140 POS. ASSEMBLY PCI EXPRESS GEN 3 PRESS-FIT TYPE		dwg no 10116975	rev B				
		www.fci.com		cat. no.		Product - Customer Drw		sheet 1 of 4			

PrdE File - REV C - 2009-04-09



Copyright FCI.

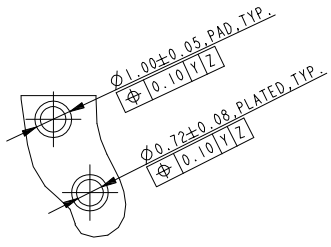
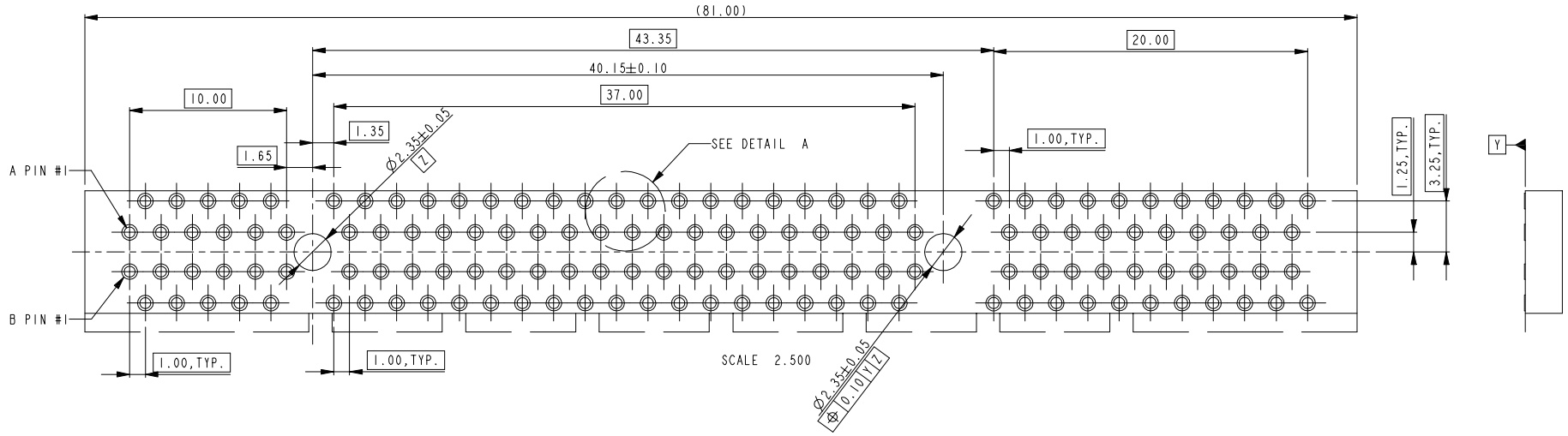

DETAIL A
SCALE 5.000

spec ref	X	dr	Stone LI	2015-05-24	projection	MM ←→	size	A4	scale	1.000		
tolerance std	TOLERANCES UNLESS OTHERWISE SPECIFIED	eng	Stone LI	2015-05-24			ecn no	ELX-DG-21161-1				
X		chr	/	/		rel level		-				
X		appr	PM ZHENG	2015-05-24				product family				
surface	linear		RECOMMENDED PCB LAYOUT FOR 140P (MOUNT SIDE) PCI EXPRESS GEN 3 PRESS-FIT TYPE			dwg no	10116975			rev	B	
X												0.X
	0.XX											±0.20
	0.XXX	±0.10										
	angular	0°	±2°	www.fci.com	cat. no.	Product - Customer Drw			sheet 2 of 4			

Profile File - REV C - 2009-04-09

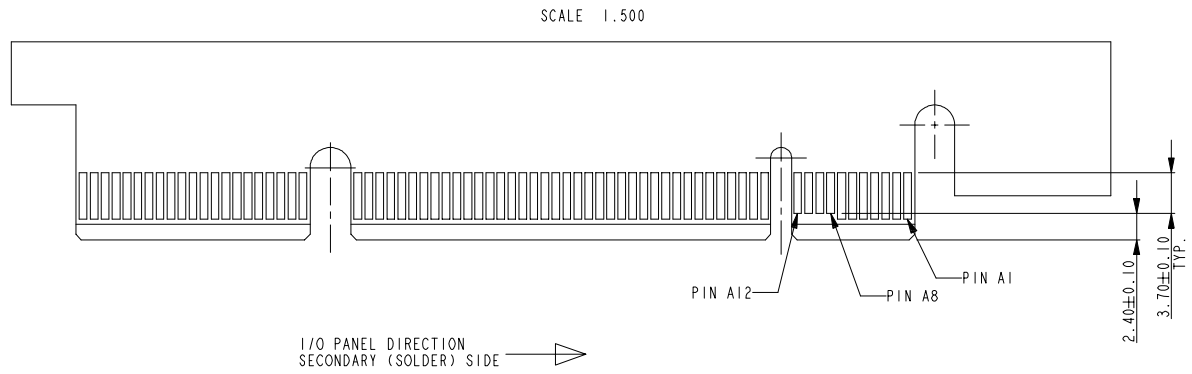
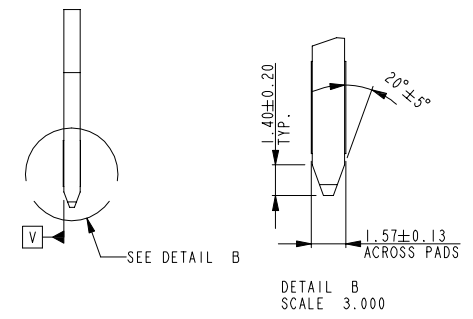
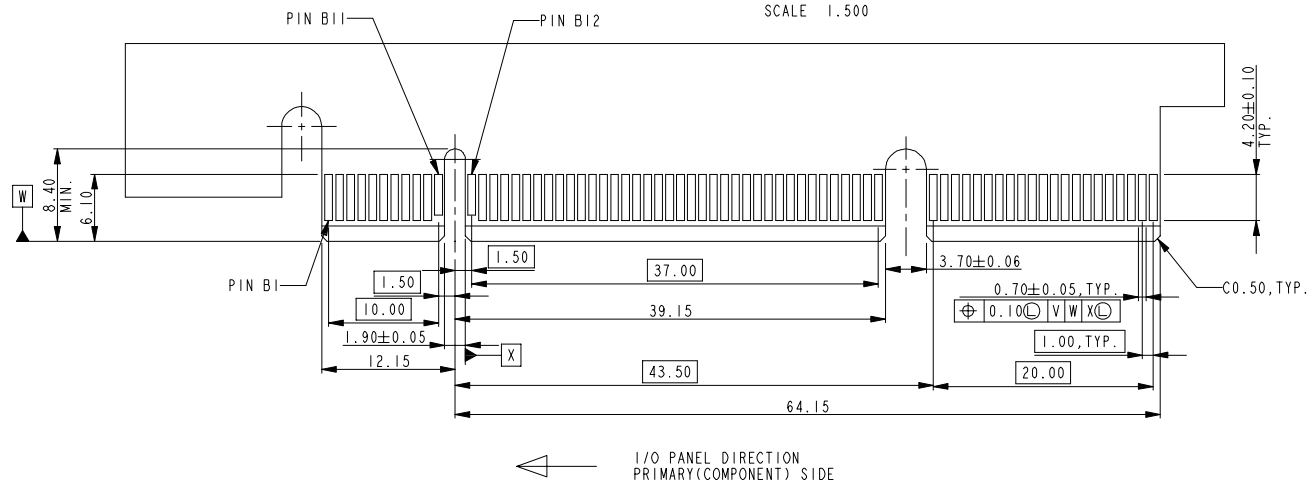

CONNECTOR LINK SIDE	#POS REF.	"F" NOTE 4
X8E	140	A8, A9, A10, A11, B11, B12

spec ref	X	dr	Stone LI	2015-05-24	projection	MM	size	A4	scale	1.000
tolerance std	TOLERANCES UNLESS OTHERWISE SPECIFIED	eng	Stone LI	2015-05-24		←→	ech no	ELX-DG-21161-1	rel level	-
X		chr	/	/						
X		appr	PM ZHENG	2015-05-24						
surface	✓	linear	0.X	±0.30	 RECOMMENDED PCB LAYOUT FOR 140P (PLUG SIDE) PCI EXPRESS GEN 3 PRESS-FIT TYPE	dwg no	10116975	rev	B	
X		angular	0°	±2°						
		www.fci.com		cat. no.	Product - Customer Drw			sheet 3 of 4		



Copyright FCI.

Profile File - REV C - 2009-04-09

NOTES:

1. MATERIAL:
HOUSING: HIGH PERFORMANCE RESIN, GLASS FILLED UL94V-0 RATED
TERMINAL: COPPER ALLOY
PLATING: 50\1.27um NICKEL UNDERPLATE ALL OVER.
CONTACT AREA PLATING - SEE PRODUCT NUMBER CODE.
SOLDER TAIL: TIN 2.54um MIN. OVER 1.27um NICKEL.
2. P/N SEE TABLE AND PRODUCT NUMBER CODE : DESH-XXXXTLF FOR TRAY PACKAGING.
3. PACKAGING SPECIFICATION.: GS-14-974.
4. PRODUCT SPECIFICATION : GS-12-584.
5. APPLICATION SPECIFICATION : GS-20-117.
6. THE HORIZONTAL AXIS FOR THE HOLE PATTERN IS ESTABLISHED BY A LINE THROUGH THE CENTER OF THE TWO Ø2.35 HOLES. THE VERTICAL AXIS IS 90° TO THE HORIZONTAL AXIS, THROUGH THE CENTER OF DATUM Z.
7. NO TIE BAR PERMITTED FROM CARD EDGE TO LEADING EDGE OF PAD FOR PINS A1 AND PIN NUMBERS "F".
8. CHAMFER EDGES MUST BE FREE OF CUTTING BURRS.
9. ALL PTH SHOULD BE 0.76-0.83 mm DIA DRILLED AND 0.025-0.050 mm MIN. ELECTRO-DEPOSITED COPPER THK ON THROUGH HOLE WALL.
10. RoHS COMPATIBLE PRODUCT SPECIFICATIONS:
- "LF" MEANS THE PRODUCT IS LEAD-FREE, 2.54um MINIMUM MATTE TIN OVER 1.27um MINIMUM NICKEL UNDERPLATE.
11. THE PRODUCT IS NOT INTENDED TO BE EXPOSED TO A MANUFACTURING SOLDER PROCESS.

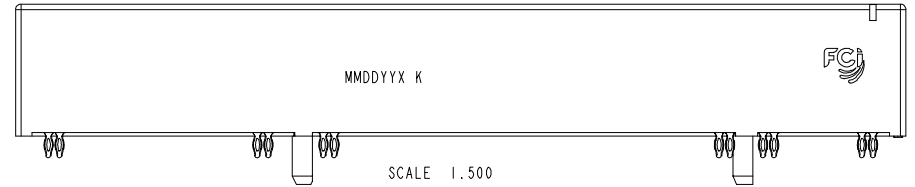

DATE CODE: COLOR IN WHITE
MDDYY: MONTH/DAY/YEAR
X: "K" - GEN.2 MARK NOTE 7

100116975 - X X X 0 X XX

HOUSING COLOR OPTION:
1: BLACK

1: RIDGE TYPE

TERMINAL PLATING OPTIONS

- 0-50µ" Ni UNDERPLATE
30µ" Au CONTACT AREA
100µ" TIN TAIL AREA
- 1-50µ" Ni UNDERPLATE
15µ" Au CONTACT AREA
100µ" TIN TAIL AREA
- 2-50µ" Ni UNDERPLATE
GOLD FLASH CONTACT AREA
100µ" TIN TAIL AREA

LEAD FREE OPTION
"LF": LEAD-FREE (FOR TERMINAL PLATING OPTION 0,1,2)

PACKAGING OPTIONS
T-TRAY PACKAGING

TAIL LENGTH OPTIONS

	DIM "D"	PCB THICKNESS
0	2.00±0.20	2.36
1	3.25±0.20	4.19



Copyright FCI.

dr	Stone LI	2015-05-24	projection 	MM 	size	A4	scale	1.000	
eng	Stone LI	2015-05-24			ecn no	ELX-DG-21161-1			
chr	/	/			rel level	-			
appr	PM ZHENG	2015-05-24	product family	3G10					
		PRESS FIT TYPE 140 POS. ASSEMBLY			dwg no		10116975	rev	B
		PCI EXPRESS GEN 3 PRESS-FIT TYPE							
www.fci.com		cat. no.		Product - Customer Drw			sheet 4 of 4		