

PRODUCT SPECIFICATION DRAWING

P2RSA-3753

FINISH:
BODIES &
HARDWARE: PASSIVATED PER QQ-P-35C, TYPE II

CONTACTS: GOLD OVER NICKEL

PERFORMANCE:
IMPEDANCE: 50 OHMS
VP: 70%
FREQ. RANGE: DC TO 18 GHZ
DELAY: 128ps 17.9 GHZ SPAN
VSWR: 1.25:1 (MAX) FOR DC-18 GHZ
INSERTION LOSS: -.2db @ 18 GHZ
OPERATING
TEMP RANGE: -65°C TO +155°C

MECHANICAL (TYP)
CONNECTOR: MATES WITH MIL-STD-348

MATERIAL:
BODY &
SHELL: STAINLESS STEEL PER AMS-5640, TYPE 303,
COND.A

CONTACTS: BERYLLIUM COPPER PER ASTM B196,
ALLOY UNS C17300

GASKET
& O-RING: SILICONE RUBBER, ZZ-R-765 DUROMETER 70

INSULATOR: PTFE PER ASTM-D1710

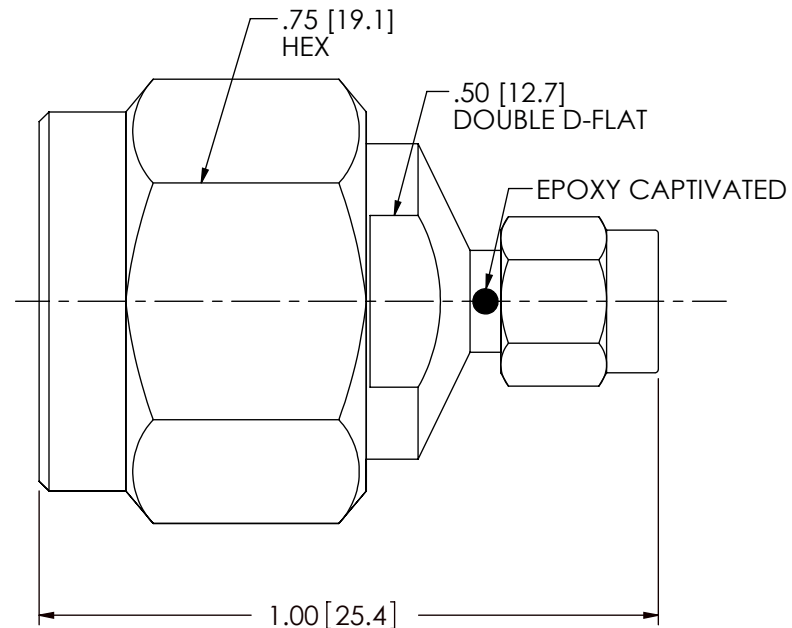

REVISION HISTORY				<div style="display: flex; justify-content: center; align-items: center;"> <div style="text-align: center; margin-right: 10px;"> </div> <div style="text-align: center;"> <p style="font-size: 1.2em; font-weight: bold;">PROPRIETARY</p> <p style="font-size: 0.8em;">THE INFORMATION HEREIN IS CONFIDENTIAL AND PROPRIETARY. NO DISCLOSURE, REPRODUCTION, OR FURTHER DISSEMINATION MAY BE MADE WITHOUT THE EXPRESSED WRITTEN CONSENT OF RF INDUSTRIES.</p> </div> </div>	DIMENSIONS ARE IN INCHES TOLERANCES: FRACTIONAL: ±1/64 ANGULAR: X° ±1'0" X*X' ±15' DECIMAL: .X ±.030 .XX ±.015 .XXX ±.005 INTERPRET DIMENSIONS AND TOLERANCES PER ASME Y14.5M - 1994		UNLESS OTHERWISE SPECIFIED 1) ALL DIMENSIONS ARE AFTER PLATING & HEAT TREATING. 2) BREAK CORNERS & EDGES .005 RADIUS MAX. 3) CHAMFER FIRST & LAST THREADS. 4) SURFACE ROUGHNESS 63 V.I.A.W. MIL-STD-10. 5) DIAMETERS ON COMMON CENTERS TO BE CONCENTRIC WITHIN T.I.R. 6) REMOVE ALL BURRS		<div style="display: flex; justify-content: space-between;"> <div style="font-size: 1.5em; font-weight: bold;">RFP²</div> <div style="font-size: 0.8em;">RF PRECISION PRODUCTS A DIVISION OF RF INDUSTRIES</div> </div> <p style="font-size: 0.7em;">7610 MIRAMAR ROAD, SAN DIEGO, CA 92126-4202 (858) 549-6340 - FAX (858) 549-6345 - RFP2@RFINDUSTRIES.COM</p>	
REV	DESCRIPTION	DATE	APPROVED		DRAWN BY: C. ZUNIGA 05/05/10 ENG APPROVAL: D. McREYNOLDS MFG APPROVAL: -- QA APPROVAL: --		TITLE: N PLUG TO SMA PLUG ADAPTER SIZE: A CODE: 000000 DWG. NO.: P2RSA-3753 SHEET 1 OF 1			
-	ENGINEERING RELEASE	05/05/10	JDMc							