

REVISIONS				
REV	ECO	DESCRIPTION	DATE	BY APPR
A1	-	RELEASED DRAWING	Jun.05.2018	White TOMMY

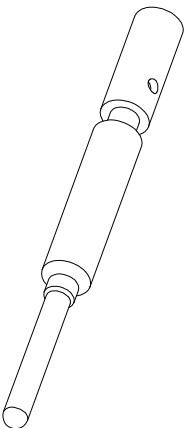
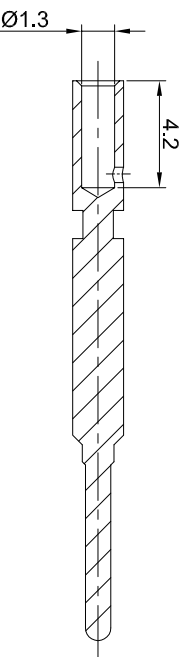
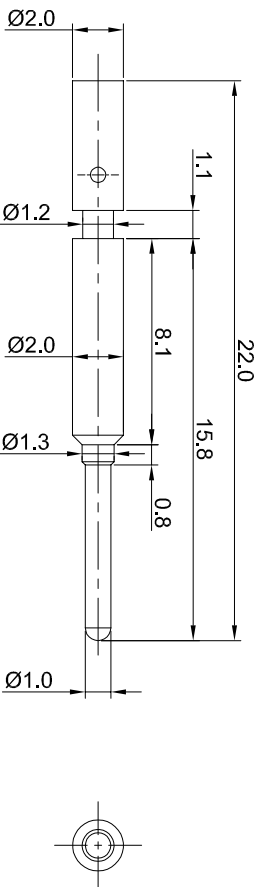

- NOTES: UNLESS OTHERWISE SPECIFIED
1. MATERIAL: COPPER ALLOY, GOLD PLATED
  2. SPECIFICATIONS:
    - 2.1 RATED CURRENT: 10 AMPS
    - 2.2 CONTACT RESISTANCE: <5 milliohm
    - 2.3 AVAILABLE WIRE RANGE: 18AWG~22AWG
    - 2.4 ROHS COMPLIANT
  3. ALL DIMENSIONS ARE FOR REFERENCE USE ONLY.

QUANTITY	SEE PART NUMBER CHART	PART NUMBER	DESCRIPTION	ITEM
<b>MATERIALS LIST</b>				
UNLESS OTHERWISE SPECIFIED		SIGNATURES		
1) All dimensions are in millimeters.		DRAWN: White	DATE: Jun.05.2018	
2) Tolerances are as follows:		CHECKED: Tod	DATE: Jun.05.2018	
3) Note reference =		APPROVAL: Tommy	DATE: Jun.05.2018	
MATERIAL SPECIFICATIONS:		CUSTOMER:		
PROCESS SPECIFICATIONS:		THIS DRAWING IS SUPPLIED FOR INFORMATION ONLY. DESIGN FEATURES, SPECIFICATIONS AND PERFORMANCE DATA ARE THE PROPERTY OF AMPHENOL CORPORATION. NO RIGHTS OR PERMISSIONS ARE GRANTED FOR REPRODUCTION OR TRANSMISSION IN ANY FORM OR BY ANY MEANS, ELECTRONIC OR MECHANICAL, INCLUDING PHOTOCOPYING, RECORDING, OR BY ANY INFORMATION STORAGE AND RETRIEVAL SYSTEMS. DIMENSIONS ARE SHOWN UNLESS OTHERWISE SPECIFIED. UNLESS OTHERWISE SPECIFIED, DIMENSIONS ARE SHOWN UNLESS OTHERWISE SPECIFIED.		
NEXT ASSTY:		SCALE: NONE		

REV: A1	SH: 1	DWG NO: SC000465	TITLE: Pin contact, 1.0mm, Chimp 18-22AWG
OF: 1			

SIZE: B	TYPE: C-	DWG NO: SC000465	REVISION: A1
Pin contact, 1.0mm, Chimp 18-22AWG			

Amphenol  
 Site Systems - www.amphenol-site.com  
 44724 Morley Drive  
 Clinton Township, MI 48036