



# 2185 MHz Ceramic Bandpass Filter

## Part Number: AM2185B1593



**ANATECH ELECTRONICS INC**  
RF & Microwave Filters & Products

### Electrical specifications

- Center Frequency:** 2185 MHz
- Bandwidth(BW):** 30 MHz
- Insertion loss(Fo):** 2.5 dB max
- Ripple in Bw:** 1.0 dB max
- VSWR:** 1.5:1 Min
- Attenuation 1:** 50 dB min @1616~1646 MHz
- Attenuation 2:** 55 dB min @1980~2010 MHz
- Attenuation 3:** 50 dB min @1980.4~2010.4 MHz
- Attenuation 4:** 50 dB min @1790.8~1820.8 MHz
- Attenuation 5:** 50 dB min @2344.8~2374.8 MHz
- Group delay variation:** 10 nsec max
- In/Out Impedance:** 50 Ohm
- Input power:** 3 Watt max

### Mechanical

- Mounting Method:** SMT
- Dimensions:** 13 X 14 X 4.5 mm

### Environmental

- Operating Temperature:** -45 to +85° C
- Storage Temperature:** -55 to +95° C
- Shock:** 20 G. 11ms
- Vibration:** 20 G. 5 to 200 MHz

This product is RoHs compliant.

### Outline Drawing:

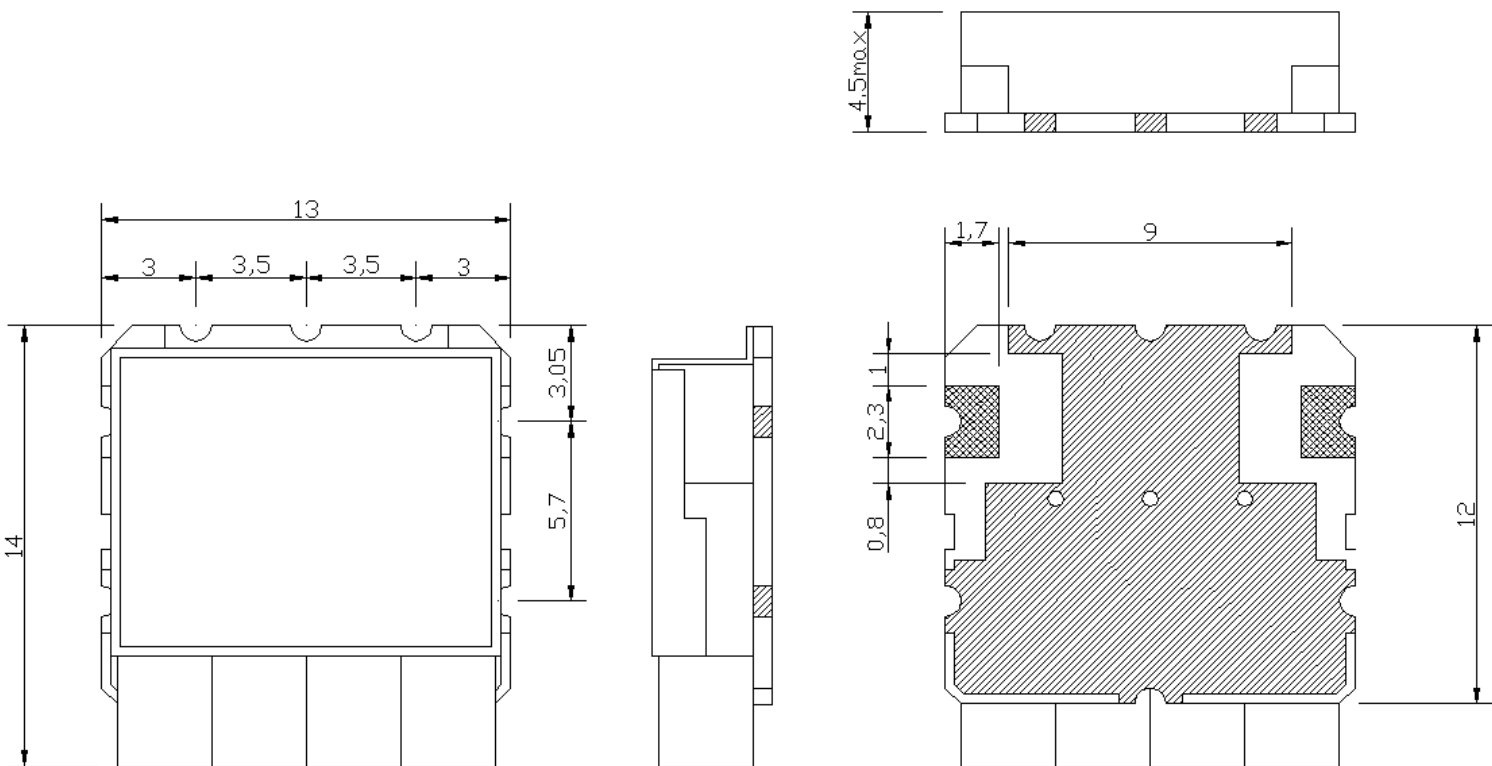

Unit:mm  
Tolerance:±0.3