

- NOTES:
1. ALL PARTS TO BE BULK PACKED.
  2. CONTACTS SHIPPED ASSEMBLED INTO CONNECTOR WITH SOLDER CUPS FACING THE KEY
  3. DIMENSIONS ARE REFERENCE EXCEPT THOSE WITH A TOLERANCE

ASS'Y P/N	CABLE O.D.
W8882-XSG-P-513	130-.150 [3.3-3.8]
W8882-XSG-P-516	.160-.180 [4.1-4.6]
W8882-XSG-P-519	.190-.210 [4.8-5.3]
W8882-XSG-P-522	.220-.250 [5.6-6.3]
W8882-XSG-P-526	.250-.270 [6.3-6.9]
W8882-XSG-P-528	.265-.285 [6.7-7.2]

ASSEMBLY P/N	CONTACT QTY
W8882-8SG-P-5XX	8
W8882-9SG-P-5XX	9
W8882-10SG-P-5XX	10
W8882-XSG-P-5XX	

GROMMET SIZE

NUMBER OF CONTACTS

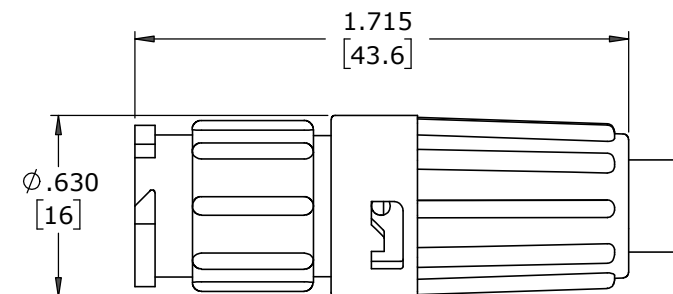

**SHOW ASSEMBLED**  
FOR CUSTOMER REFERENCE ONLY

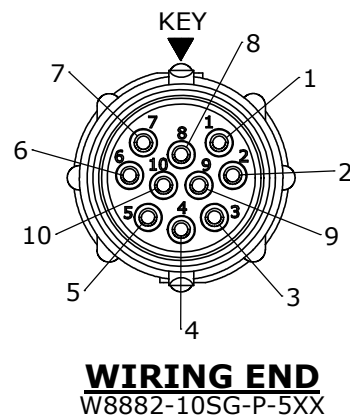
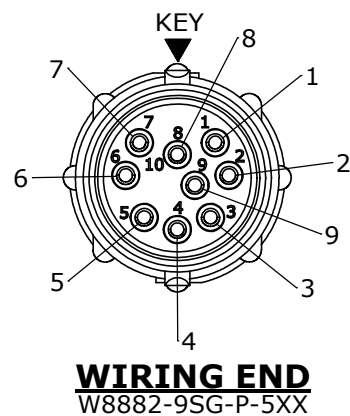
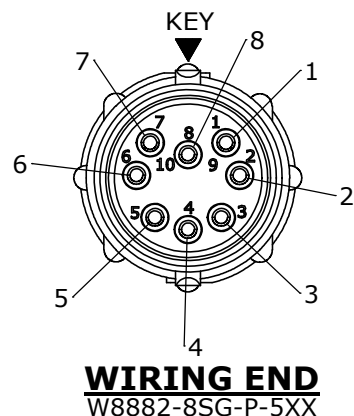
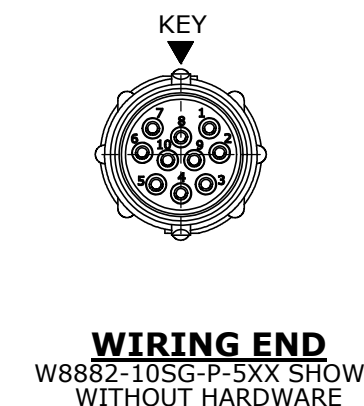
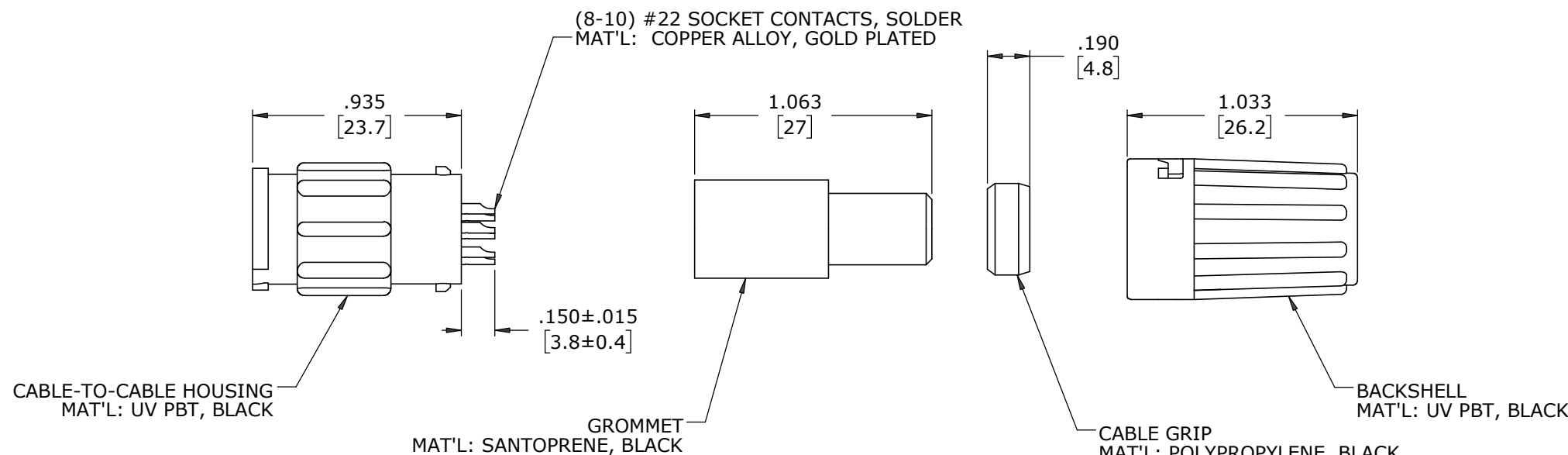
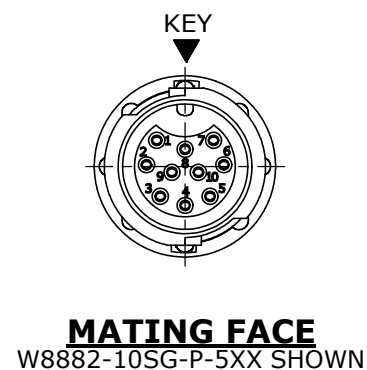

**CUSTOMER APPROVAL**

THIS DOCUMENT CONTAINS CONFIDENTIAL INFORMATION PROPRIETARY TO CONXALL CORPORATION. ANY REPRODUCTION, DISCLOSURE, OR USE OF THIS DOCUMENT /INFORMATION IS EXPRESSLY PROHIBITED UNLESS AUTHORIZED IN WRITING BY CONXALL CORPORATION.

APPROVED BY: \_\_\_\_\_

DATE: \_\_\_\_\_

**RoHS COMPLIANT**

MA	07-15-20	RELEASED PER PDR 16014-10
PNK	03-20-18	PDR 16014
REV. INIT.	DATE	DESCRIPTION
PNK	03-20-18	ORIG. DRAWN BY: DATE: 03-20-18
ALL INFORMATION ILLUSTRATED IS THE PROPERTY OF CONXALL CORPORATION. UNAUTHORIZED DUPLICATION OR DISTRIBUTION OF THIS DOCUMENT IS PROHIBITED.		<p>601 E. WILDWOOD VILLA PARK, IL 60181</p>
ALL UNITS ARE IN FEET, INCHES, FRACTION OF INCHES AND DECIMALS. UNLESS OTHERWISE SPECIFIED TOLERANCES: 3 PLACE DECIMALS ±.010 ANGLES ±1° FRACTIONS ±1/16		
APPROVED BY:	SCALE	TITLE
	NTS	CABLE-TO-CABLE ASSEMBLY (8-10) #22 SOCKET CONTACTS, SOLDER INSTA-CLICK™ MINI-CON-X
	SIZE	CUSTOMER: STANDARD PRODUCT
	B	
	SHEET	
	1 OF 1	
FILE: W8882-XSG-P-5XX	DIRECTORY: SLW	PART NUMBER: W8882-XSG-P-5XX
		REV A