

**2-by-1
zQSFP+
Extraction Tool**

molex®

**Application Tooling
Specification Sheet**

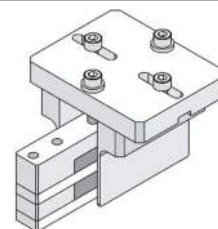

Order No. 62202-5210

FEATURES

- Used for removal of a zQSFP+ assembly from a PCB
- Removes connector from the PCB without damage to the board
- Use tool 62202-5250 to insert 170879-10** series assemblies
- Use tool 62202-5320 to insert 170879-30** series assemblies

SCOPE

Products: zQuad Small Form-Factor Pluggable Plus (zQSFP+) Cage Assembly, with Elastomeric Gasket or Metal EMI Gasket, 2-by-1 Enhanced EMI Cage Construction.

Connector Series No.	Connector Order No.						
170879	170879-1001	170879-1002	170879-1003	170879-1010	170879-3001	170879-3002	170879-3003
173604	173604-0001						

Notes:

1. See the following pages for tooling operation instructions.
2. These tools require a "Keep Out Zone" around the connector free of components. The right and left sides should be .138" (3.5mm). See Figure 1.

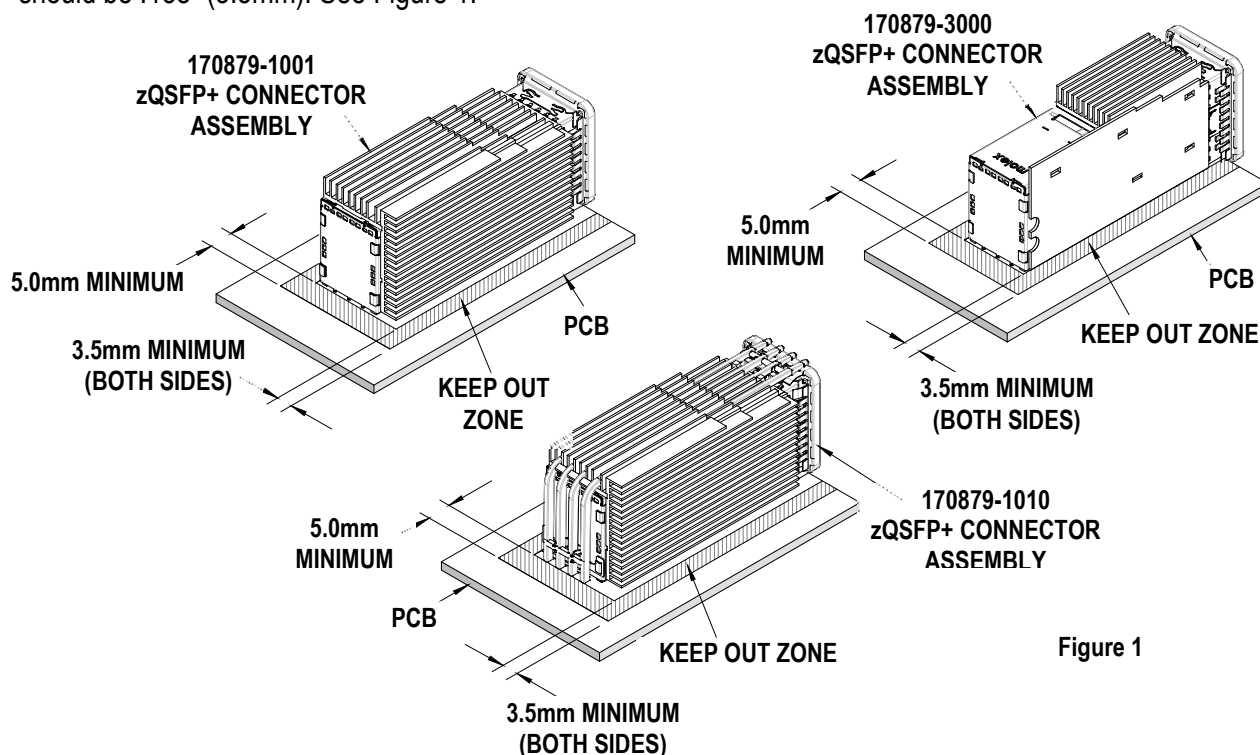

Figure 1

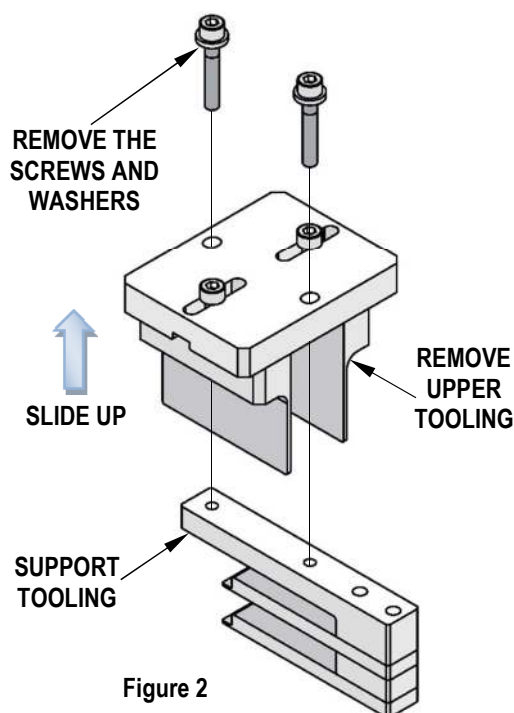

Figure 2

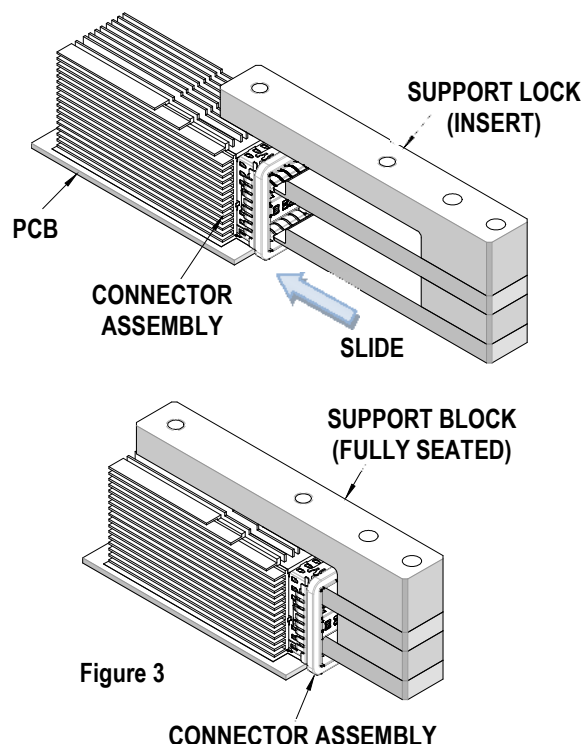

Figure 3

Description

The following Instructions are used for removing a 2-by-1 connector from a PCB.

Operation

1. Disassemble the (2) halves by unscrewing the screws on the top of the upper tooling. See Figure 2.
2. Remove the upper tooling from the support tooling.
3. Insert the support tooling into the cage ports until it is fully seated. See Figure 3.
4. Place the top removal assembly over the support tooling and the cage assembly, aligning the screw holes of the top removal assembly with the threaded holes in the support blocks. See Figure 4.
5. If the top removal assembly does not fit over the cage, the side supports of the top assembly can be adjusted farther from the cage sides.
6. Place the washers and M5 screws into the holes in the top removal assembly; turn the screws clockwise until they are started in the support blocks.

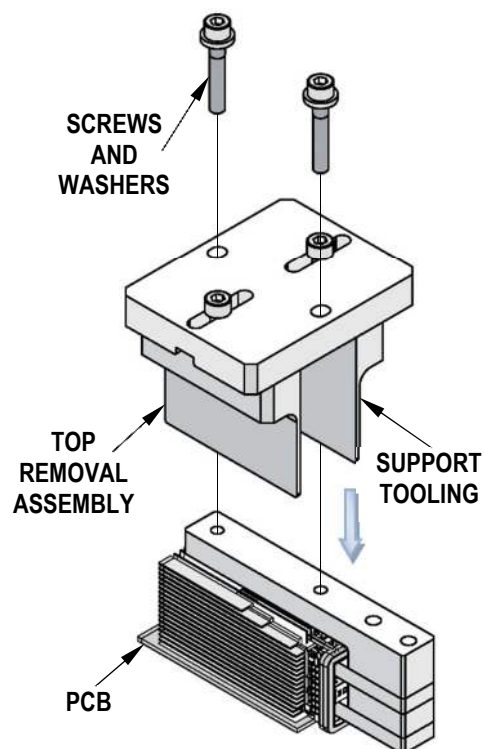

Figure 4

7. Using a 4mm hex wrench, tighten each screw, one turn in an alternating pattern until the cage assembly is removed from the PCB. See Figure 5.

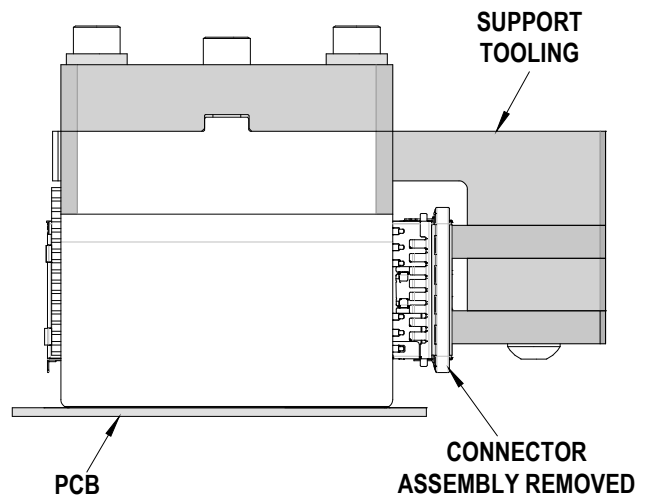
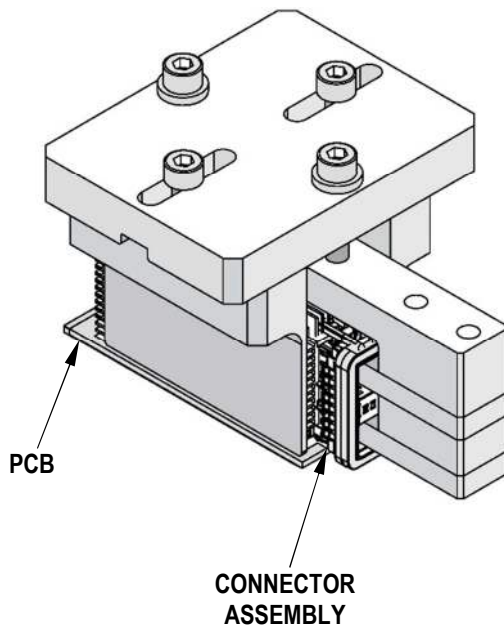

Figure 5

CAUTION: Molex application tooling specifications are valid only when used with Molex connectors and tooling.

Application Tooling Support

Phone: +1-402-458-TOOL (8665)
E-Mail: applicationtooling@molex.com
Website: www.molex.com/applicationtooling

Molex is a registered trademark of Molex, LLC in the United States of America and may be registered in other countries; all other trademarks listed herein belong to their respective owners.