

| REVISIONS | | | | | |
|-----------|-----|-----------------------|-----------|-----|------|
| P | LTR | DESCRIPTION | DATE | DMN | APVD |
| R | | REV PER ECO-16-009924 | 11JUL2016 | DS | SY |

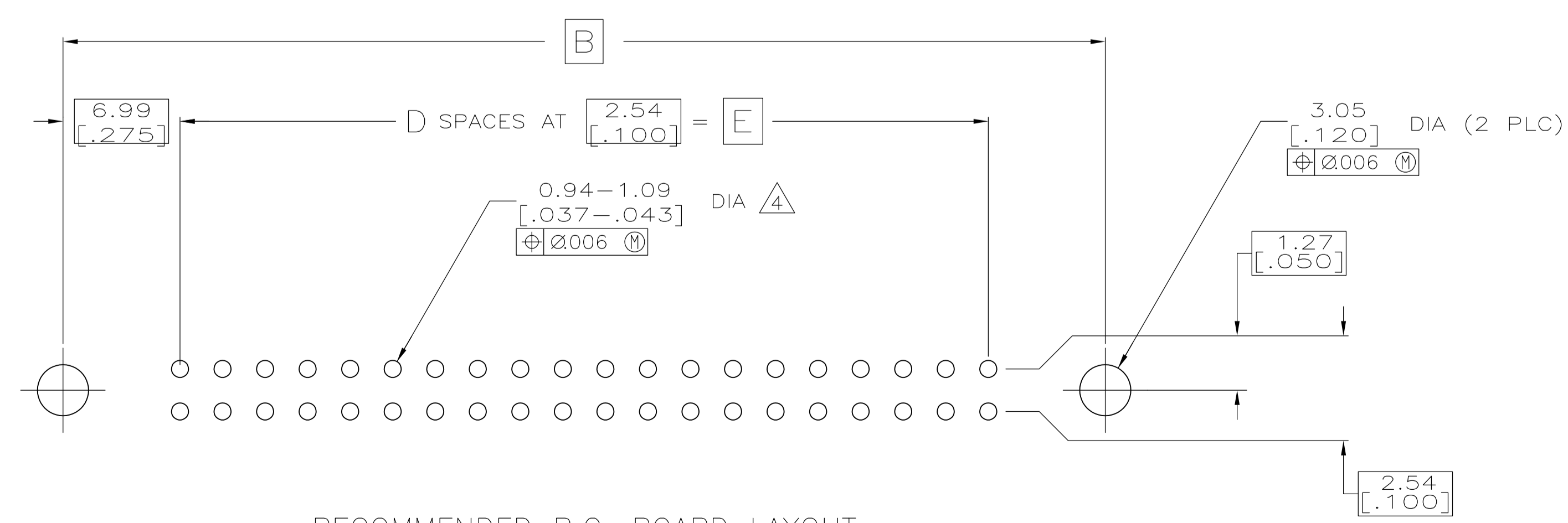
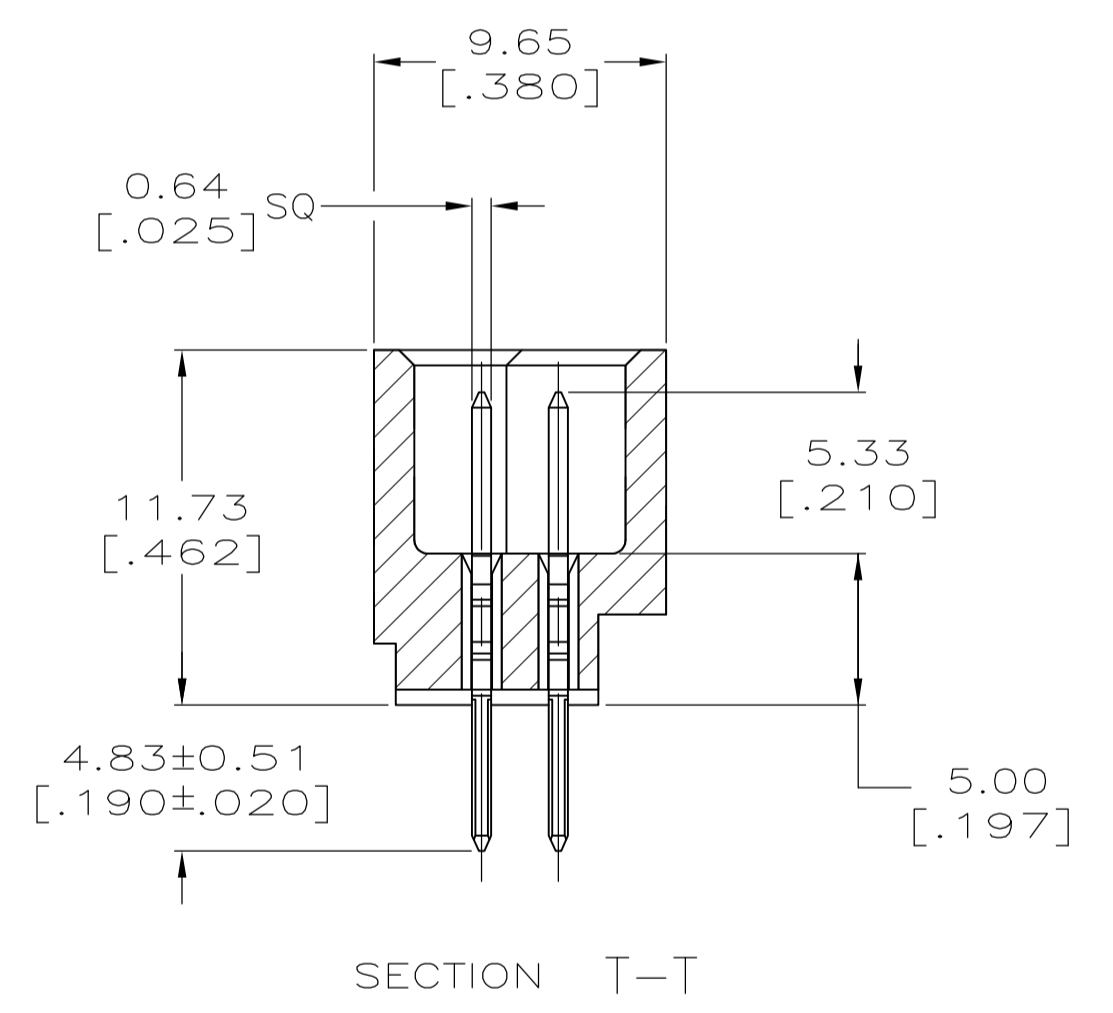
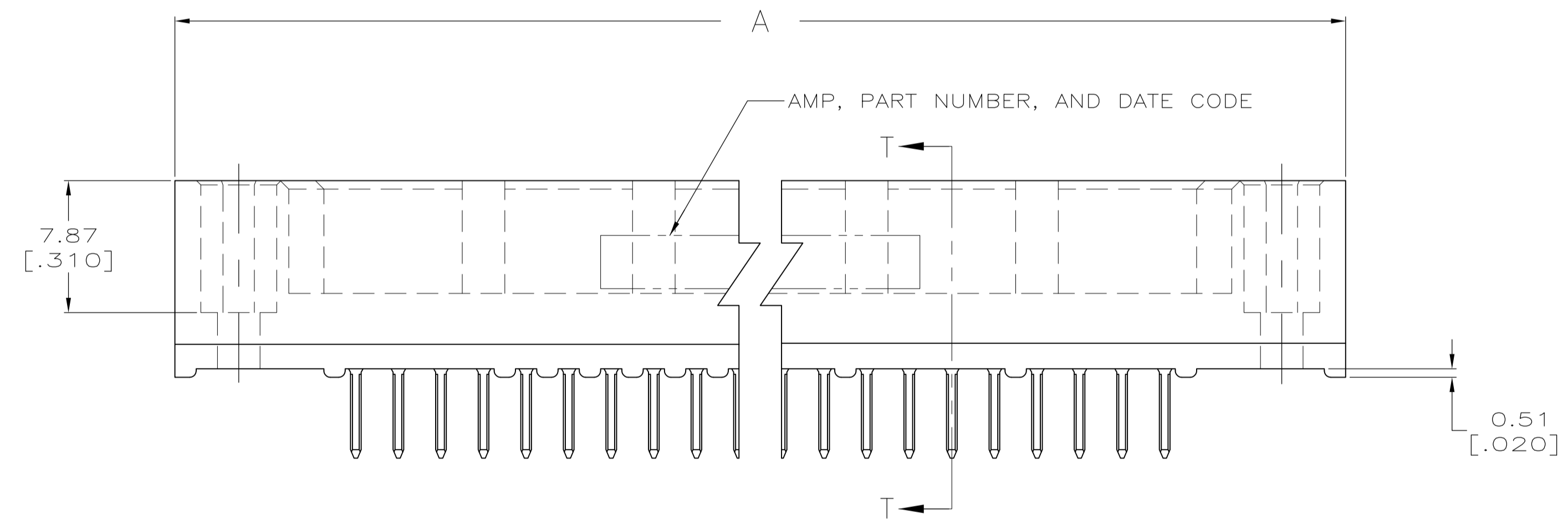
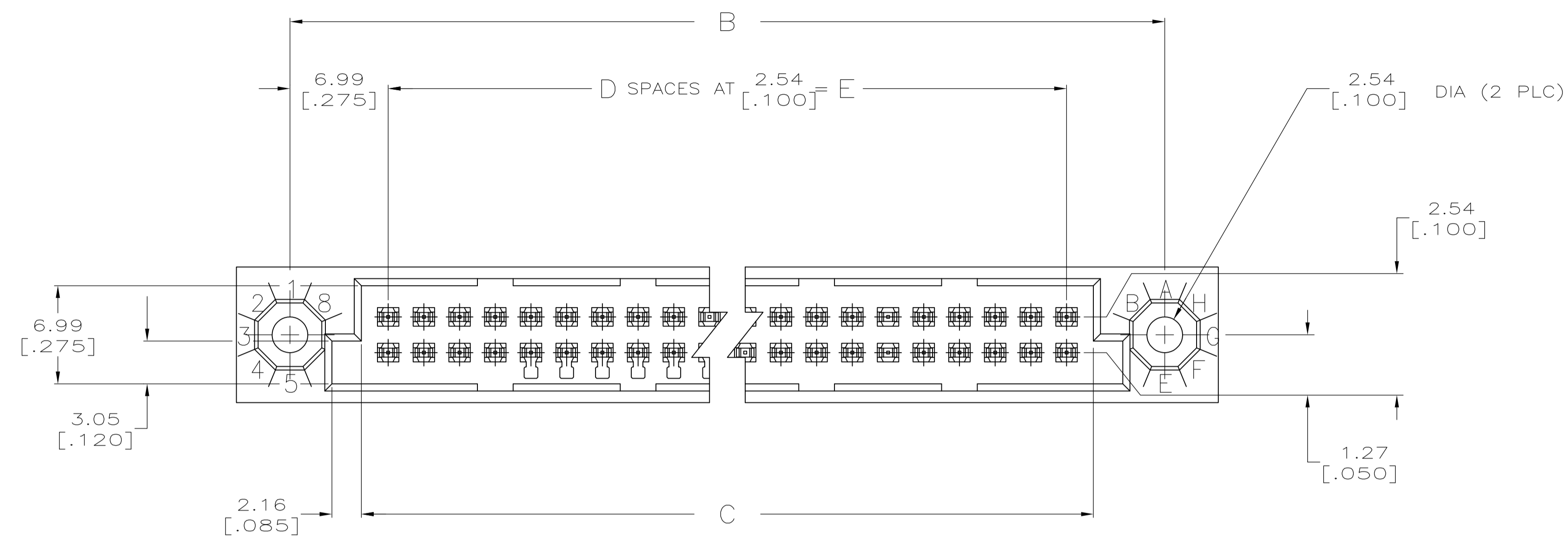

RECOMMENDED P.C. BOARD LAYOUT

| | | | | |
|--|--|-------------------------------|-----------------|---|
| THIS DRAWING IS A CONTROLLED DOCUMENT. | | DIN R.K. SEIFRIED 04/09/90 | TE Connectivity | |
| DIMENSIONS: mm [INCHES] | | CHK F. KIBLER 8-17-92 | | |
| TOLERANCES UNLESS OTHERWISE SPECIFIED: | | APVD | NAME | |
| 0 PLC ± - | | PRODUCT SPEC | | HDI, 2 ROW, PIN ASSEMBLY, 4.83 [.190] LONG SOLDER PINS |
| 1 PLC ± - | | APPLICATION SPEC | | |
| 2 PLC ± - | | MATERIAL | | |
| 3 PLC ± 0.13 [.005] | | FINISH | | |
| 4 PLC ± - | | WEIGHT | | RESTRICTED TO |
| ANGLES ± - | | CUSTOMER DRAWING | | SCALE 4:1 SHEET 1 OF 2 REV R |
| MATERIAL | | DRAWING NO. A1 00779 C=532430 | | |

| REVISIONS | | | | |
|-----------|-----|-------------|------|------|
| P | LTR | DESCRIPTION | DATE | APPV |
| - | - | SEE SHEET 1 | - | - |

- ① HOUSING MATERIAL: THERMOPLASTIC, COLOR-NATURAL.
- ② CONTACT MATERIAL: PHOSPHOR BRONZE.
- ③ FINISH:
MATING AREA: MEETS THE PERFORMANCE REQUIREMENTS OF PRODUCT SPECIFICATION 108-9063; BASED ON TELCORDIA DR-1217-CORE APPLICATIONS IN UNCONTROLLED ENVIRONMENTS.
TIN-LEAD PLATED POSTS.
- ④ SOLDER PIN POST RECOMMENDED P.C. BOARD HOLE SIZES ARE 0.94-1.09 [.037-.043]; RECOMMENDED PAD DIA IS 1.52 [.060].
- 5. DIMENSIONS IN BRACKETS ARE IN INCHES.
- ⑥ PART NUMBER IS OBSOLETE.
- ⑦ OBSOLETE PARTS: OBSOLETE CIS STREAMLINING PER D.RENAUD/D.SINISI
- ⑧ FINISH:
CONTACT FINISH: .00127-.00254 [.000050-.000100] NICKEL UNDERPLATE ALL OVER; .000762 [.000030] GOLD PLATE IN CONTACT AREA, TIN-LEAD PLATED POSTS.

| | | | | | | | |
|---|-------------------|---------------|--------------------|--------------------|--------------------|----------------|-------------|
| ⑧ | 124.46 [4.900] | 49 | 128.27 [5.050] | 138.43 [5.450] | 146.05 [5.750] | 100 | 3-532430-9 |
| ⑧ | 73.66 [2.900] | 29 | 77.47 [3.050] | 87.63 [3.450] | 95.25 [3.750] | 60 | 3-532430-5 |
| ⑥ | 251.46 [9.900] | 99 | 255.27 [10.050] | 265.43 [10.450] | 273.05 [10.750] | 200 | 1-532430-9 |
| ⑥ | 238.76 [9.400] | 94 | 242.57 [9.550] | 252.73 [9.950] | 260.35 [10.250] | 190 | 1-532430-8 |
| ⑥ | 226.06 [8.900] | 89 | 229.87 [9.050] | 240.03 [9.450] | 247.65 [9.750] | 180 | 1-532430-7 |
| ⑥ | 213.36 [8.400] | 84 | 217.17 [8.550] | 227.33 [8.950] | 234.95 [9.250] | 170 | 1-532430-6 |
| ⑥ | 200.66 [7.900] | 79 | 204.47 [8.050] | 214.63 [8.450] | 222.25 [8.750] | 160 | 1-532430-5 |
| | 187.96 [7.400] | 74 | 191.77 [7.550] | 201.93 [7.950] | 209.55 [8.250] | 150 | 1-532430-4 |
| ⑥ | 175.26 [6.900] | 69 | 179.07 [7.050] | 189.23 [7.450] | 196.85 [7.750] | 140 | 1-532430-3 |
| ⑥ | 162.56 [6.400] | 64 | 166.37 [6.550] | 176.53 [6.950] | 184.15 [7.250] | 130 | 1-532430-2 |
| ⑥ | 149.86 [5.900] | 59 | 153.67 [6.050] | 163.83 [6.450] | 171.45 [6.750] | 120 | 1-532430-1 |
| | 137.16 [5.400] | 54 | 140.97 [5.550] | 151.13 [5.950] | 158.75 [6.250] | 110 | 1-532430-0 |
| | 124.46 [4.900] | 49 | 128.27 [5.050] | 138.43 [5.450] | 146.05 [5.750] | 100 | 532430-9 |
| ⑥ | 111.76 [4.400] | 44 | 115.57 [4.550] | 125.73 [4.950] | 133.35 [5.250] | 90 | 532430-8 |
| ⑥ | 99.06 [3.900] | 39 | 102.87 [4.050] | 113.03 [4.450] | 120.65 [4.750] | 80 | 532430-7 |
| ⑥ | 86.36 [3.400] | 34 | 90.17 [3.550] | 100.33 [3.950] | 107.95 [4.250] | 70 | 532430-6 |
| | 73.66 [2.900] | 29 | 77.47 [3.050] | 87.63 [3.450] | 95.25 [3.750] | 60 | 532430-5 |
| ⑥ | 60.96 [2.400] | 24 | 64.77 [2.550] | 74.93 [2.950] | 82.55 [3.250] | 50 | 532430-4 |
| | 48.26 [1.900] | 19 | 52.07 [2.050] | 62.23 [2.450] | 69.85 [2.750] | 40 | 532430-3 |
| | 35.56 [1.400] | 14 | 39.37 [1.550] | 49.53 [1.950] | 57.15 [2.250] | 30 | 532430-2 |
| ⑥ | 22.86 [.900] | 9 | 26.67 [1.050] | 36.83 [1.450] | 44.45 [1.750] | 20 | 532430-1 |
| | E | D | C | B | A | POSN | PART NUMBER |

OBSOLETE

| | | | | | |
|--|--|--|--|------------------------------|--|
| THIS DRAWING IS A CONTROLLED DOCUMENT. | | DIN R.K. SEIFRIED 04/09/90 | | TE Connectivity | |
| DIMENSIONS: mm [INCHES] | | TOLERANCES UNLESS OTHERWISE SPECIFIED: | | NAME | |
| 0 PLC ± - | | 1 PLC ± - | | HDI, 2 ROW, PIN ASSEMBLY, | |
| 2 PLC ± - | | 3 PLC ± 0.13 [.005] | | 4.83 [.190] LONG SOLDER PINS | |
| 4 PLC ± - | | ANGLES ± - | | - | |
| MATERIAL | | FINISH | | SIZE | |
| | | | | A1 | |
| | | | | CAGE CODE | |
| | | | | 00779 | |
| | | | | DRAWING NO | |
| | | | | 532430 | |
| | | | | RESTRICTED TO | |
| | | | | - | |
| | | | | WEIGHT | |
| | | | | 0 | |
| | | | | CUSTOMER DRAWING | |
| | | | | SCALE | |
| | | | | 4:1 | |
| | | | | SHEET | |
| | | | | 2 OF 2 | |
| | | | | REV | |
| | | | | R | |