

**Type FSG**  
**Automotive Glass Fuse**  
**13/32" x 1-1/2" (10.3 x 38.1mm)**



www.optifuse.com (619) 593-5050

**Fuse Size:** 13/32" x 1 1/2" (10.3 x 38.1mm)

**Ampere Rating:** 1A ~ 80A  
**Voltage Rating:** 32V AC/DC

<b>Time Characteristics:</b>			
Rated Current	100%	135%	200%
	Min.	Max.	Max.
1A – 30A	4h	1h	120s
35A-80A	4h	1h	

**Interrupt Rating:** 1000A, 32 VDC

**Terminals:** Nickel plated

**Specifications** according to UL 248-1, 14

**Mechanical Dimensions:** Inches[mm]

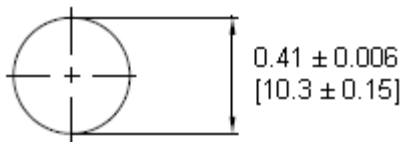
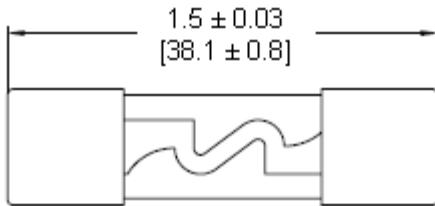

<b>Part Number</b>	<b>Ampere Rating</b>	<b>Voltage Rating</b>
<b>FSG-1A</b>	1A	32V AC/DC
<b>FSG-2A</b>	2A	
<b>FSG-3A</b>	3A	
<b>FSG-4A</b>	4A	
<b>FSG-5A</b>	5A	
<b>FSG-8A</b>	8A	
<b>FSG-10A</b>	10A	
<b>FSG-15A</b>	15A	
<b>FSG-20A</b>	20A	
<b>FSG-25A</b>	25A	
<b>FSG-30A</b>	30A	
<b>FSG-35A</b>	35A	
<b>FSG-40A</b>	40A	
<b>FSG-50A</b>	50A	
<b>FSG-60A</b>	60A	
<b>FSG-70A</b>	70A	
<b>FSG-80A</b>	80A	

	-Operation beyond the specified maximum ratings or improper use may result in damage and possible electrical arcing and/or flame.
	-Avoid contact of Fuse device with chemical solvent. Prolonged contact may damage the device performance.