

USED ON 966615

SUITABLE CONTACTS: IDC-AWG30-26 PN 215 192
 PASSENDE KONTAKTE: IDC-AWG26-22 PN 215 141
 CRIMP-AWG32-28 PN 167 041
 CRIMP-AWG26-20 PN 166 500

DWG-NO 964 779
 VERWENDET FÜR THIS DRAWING IS A CONTROLLED DOCUMENT

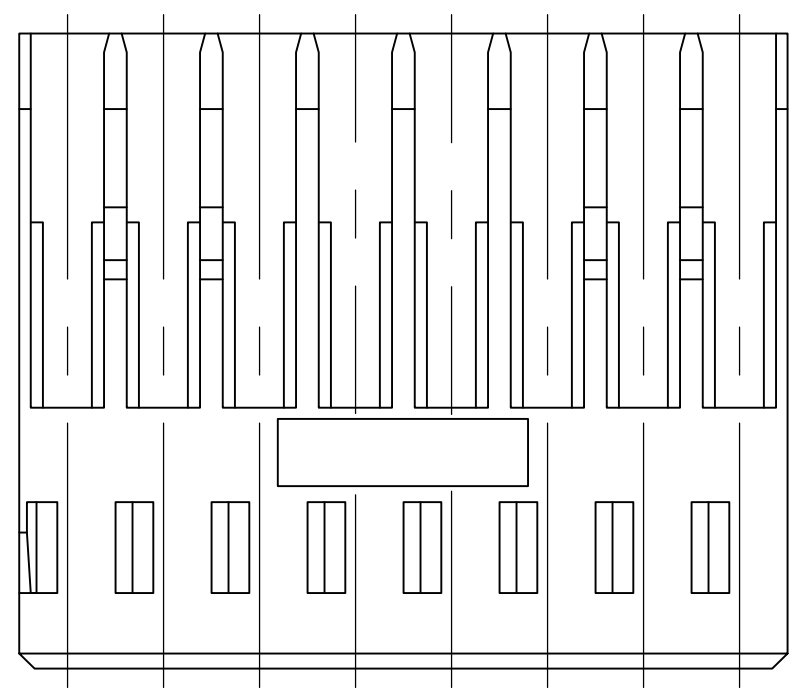
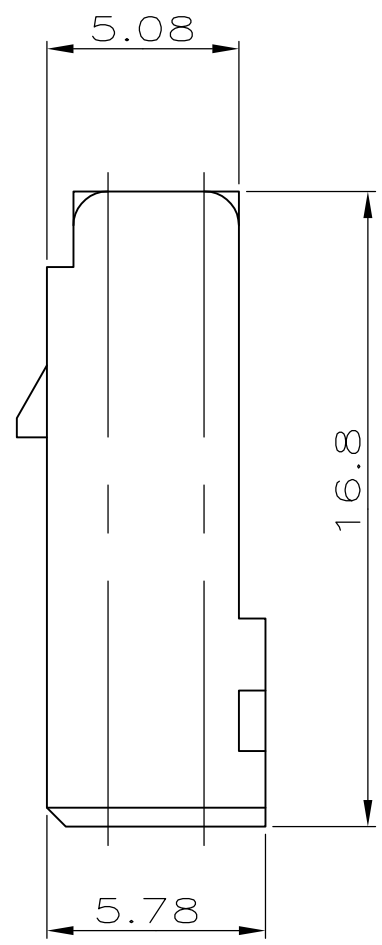
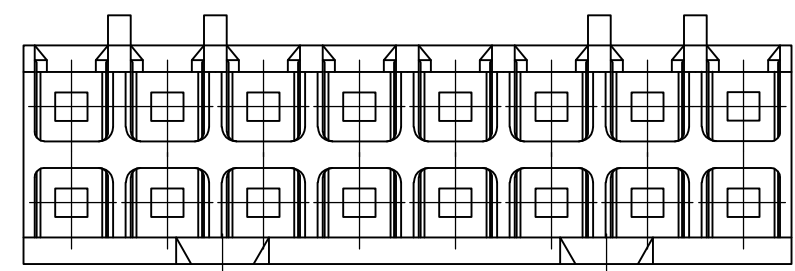
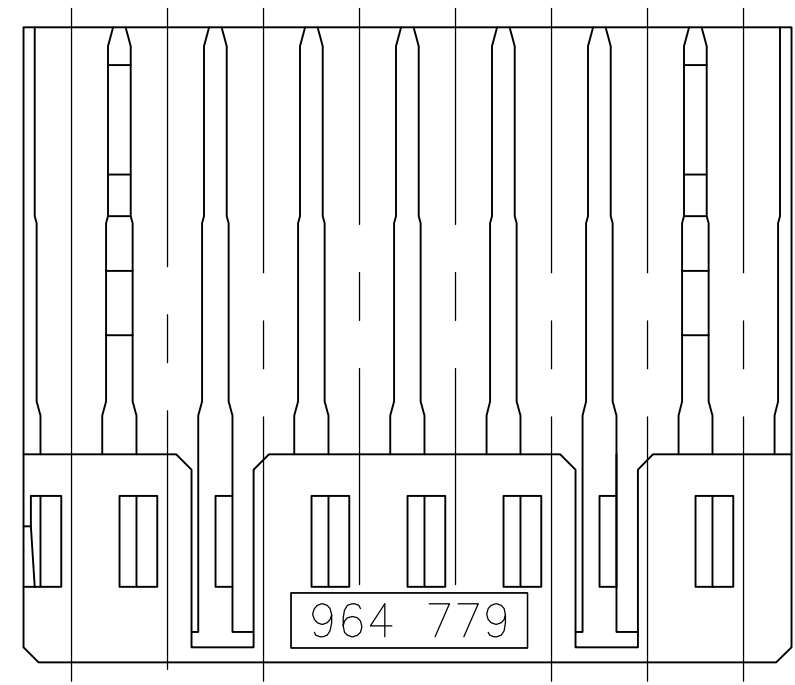
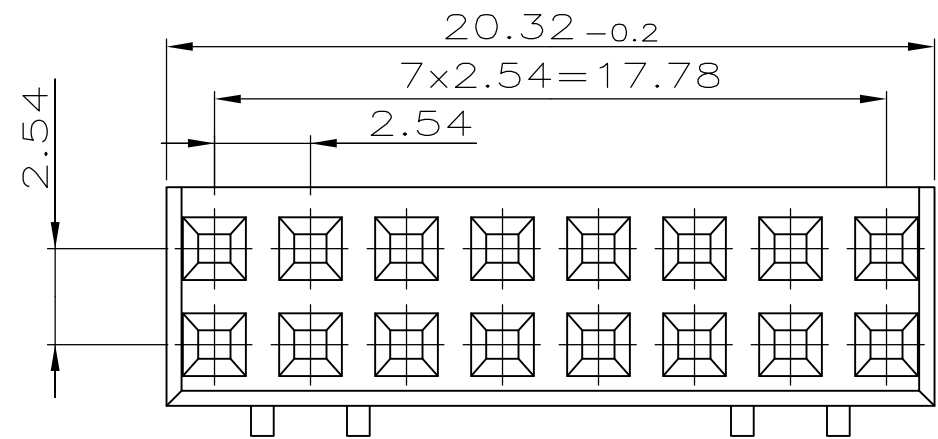

OBSOLETE

964 779-2	HOUSING	PBT GF	BLACK
964 779 1	HOUSING	PBT GF	BLACK
PART NUMBER	DESCRIPTION	MATERIAL	COLOR
DWN	28.11.94	MATERIAL	HEAT TREAT
M.Bleicher		PBTP GF	-
CHK	28.11.94		-
Krämer			
APVD	28.11.94		
Krämer		RV100-3 2x8 POS. MT HOUSING RV100-3 2x8 POL. MT BUCHSENGEH	
NAME			
SCALE	SIZE	DRAWING NO	SHEET OF REV
5:1	A3	964779	1 OF 1 C1

DIMENSIONS:		TOLERANCES UNLESS OTHERWISE SPECIFIED:	
mm		0 PLC	± -
		1 PLC	± -
		2 PLC	± 0.2
		3 PLC	± -
ANGLES ± 2°		4 PLC	± -
SURFACE TEXTURE			

P	LTR	REVISION RECORD	DATE	DWN	APVD
	C	REVOSED PER ECR-11-014637	18JUL2011	KS	MQ.W

THIS INFORMATION IS CONFIDENTIAL AND PROPRIETARY TO TYCO ELECTRON CORPORATION AND ITS WORLDWIDE SUBSIDIARIES AND AFFILIATES (TE). IT MAY NOT BE DISCLOSED TO ANYONE OTHER THAN TE PERSONNEL WITHOUT AUTHORIZATION FROM TE.
 PASSSEND ZU
 LOC AI
 DIST -