

4

3

2

1

NOTE(S):

- 1. FREQUENCY: 10MHz - 18GHz
- 2. VSWR: MAX. 1.35:1
- 3. ATTENUATION: MAX. 1.0 dB
- 4. VOLTAGE: MAX. 50 Volts
- 5. IMPEDANCE: 50 Ohm

REVISION			
REV.	DESCRIPTION	DATE	BY
-	INITIAL RELEASE	05/31/2019	TDR

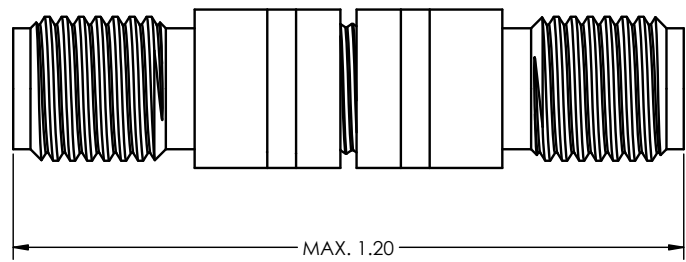

APPLICABLE CARLISLE IT DOCUMENTS		
WORK STANDARD	PROD INSTRUC	ASSY INSTRUC
NA	NA	NA
-	-	-

TOLERANCES AND NOTES
 EXCEPT AS NOTED
 DIMENSIONS ARE IN INCHES.
 LINEAR $XX \pm .015$ ANGULAR $\pm 1/2^\circ$
 FRACTION $\pm 1/32$

- MACHINE FINISH: $\sqrt{\text{RMS}}$
- BREAK ALL SHARP EDGES .003 MAX.
- MACHINED FILLETS .005 MAX.
- MACHINED SURFACES SQUARE TO RESPECTIVE AXIS WITHIN .005 INCHES PER INCH.
- MACHINED DIAMETERS CONCENTRIC WITHIN .002 TLR.
- DIMENSIONS TO BE MET BEFORE PLATING.
- CHAMFER ALL THREADS 45°.
- THREADS PER H-28
- REMOVE FRAYED EDGES ON TEFLON.
- REMOVE ALL BURRS.

NOTICE
 THIS DRAWING EMBODIES A CONFIDENTIAL PROPRIETARY DESIGN ORIGINATED BY CARLISLE INTERCONNECT TECHNOLOGIES & ALL DESIGN, MANUFACTURING, REPRODUCTION, USE & SALE RIGHTS REGARDING THE SAME ARE EXPRESSLY RESERVED. IT IS SUBMITTED UNDER A CONFIDENTIAL RELATIONSHIP FOR A SPECIFIED PURPOSE & THE RECIPIENT AGREES BY ACCEPTING THIS DRAWING NOT TO SUPPLY OR DISCLOSE ANY INFORMATION REGARDING IT TO ANY UNAUTHORIZED PERSON TO INCORPORATE IN OTHER PROJECTS ANY SPECIAL FEATURES PECULIAR TO THIS DESIGN. ALL PATENT RIGHTS HERETO ARE EXPRESSLY RESERVED BY CARLISLE INTERCONNECT TECHNOLOGIES, KENT, WA 98032.

MATERIAL		SIZE	SPECIFICATION	PROCUREMENT
APPROVAL INITIALS	DATE	CARLISLE Interconnect Technologies Kent, WA 98032 TITLE INNER DC BLOCK 3.5mm FEMALE - 3.5mm FEMALE SCALE 8:1 SIZE C 7M924 DRAWING NO. TM40-0176-00 SHEET 1 OF 1 REV. -		
DRAWN BY	TDR 05.31.19			
CHECKED BY	- -			
TEST ENGR	- -			
QUALITY	- -			
DESIGN ENGR	TDR 05.31.19	SUB-DIRECTORY\FILE NAME		XXXX\
MFG ENGR	- -	CAGE CODE		7M924

4

3

2

1