

DO NOT SCALE  
DIMENSIONS IN mm

METRIC

THIRD ANGLE  
PROJECTION

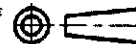

NOTES:

- 1 FOR USE ON MINIATURE APPLICATORS ( LEFT-RIGHT FEED )
- 2 HANDTOOL 180320 TO BE USED.
- 3 APPLICATION SPEC. 114-19025.
- 4 PRODUCT SPEC. 108-19084.



REVERSE REELED FOR MINI APPLICATOR.



OBSELETE PARTS:OBSELETE CIS STREAMLINING  
PER D.RENAUD/D.SINISI

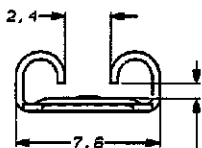
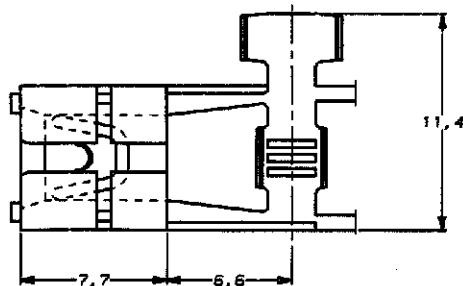

FOR 0,8 mm TAB  
THICKNESS

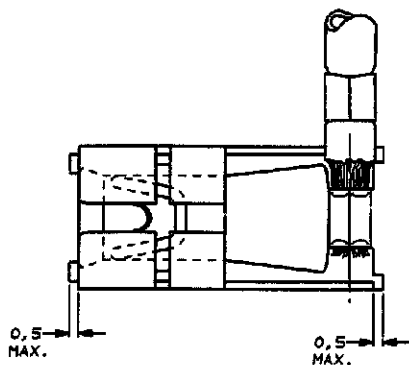

OBSELETE  
 6

OBSELETE  
 6

WIRE RANGE :  
0,5 - 1,5 mm<sup>2</sup>  
INSULATION RANGE :  
2,0 - 3,8 mm DIA.

LOOSE PIECE	FINISH	MATERIAL	PARTNUMBER
100688-4	TINPLATED	PH. BRONZE	100644-4
100688-3	UNPLATED	PH. BRONZE	100644-3
100688-2	TINPLATED	BRASS	100644-2
100688-1	UNPLATED	BRASS	100644-1
100688-4	TINPLATED	PH. BRONZE	100644-4
100688-3	UNPLATED	PH. BRONZE	100644-3
100688-2	TINPLATED	BRASS	100644-2
100688-1	UNPLATED	BRASS	100644-1

CUSTOMER DRAWING				FOR REFERENCE ONLY WILL NOT BE UPDATED	
© COPYRIGHT 19- BY AMP HOLLAND B.V.				ALL INTERNATIONAL RIGHTS RESERVED. AMP PRODUCTS MAY BE COVERED BY U.S. AND FOREIGN AND/OR PATENTS PENDING.	
THIS DRAWING IS UNPUBLISHED				RELEASED FOR PUBLICATION	
B1	ECO-09-026346	KK	AEG	NOV09	
B	EH-0935-93	P.B.	P.B.	09.12.93	
A	EH-0242-93	P.B.	P.B.	14.04.93	
Q	H-9565	P.B.	A.B.	20.02.92	
LTR.	REVISION RECORD		DR.	CHK.	DATE

**AMP** AMP HOLLAND B.V.  
's-Hertogenbosch,  
The Netherlands.

NAME  
LOW INSERTION FORCE FASTON RECEPTACLE  
FOR 0,8 mm TABTHICKNESS .250hrs (S,3)

DR.:	P.B.J.M.H.	CHK.:	A.B.M.H.	APP.:	A.V.BEST.	DWG. No.	REV. LTR.	SHEET
DATE:	20.02.92	DATE:	-	DATE:	08-2-93	C-100644	B1	1 of 1

DOC. CENTRE  
10 DEC. 1993