

LOC	DIST	REVISIONS					
		P	LTN	DESCRIPTION	DATE	DWN	APVD
CM	00	P1		REVISED PER ECR-12-011660	24JAN2013	KH	TM
		P2		REVISED PER ECR-21-118222	22JUL2022	AVN	VS

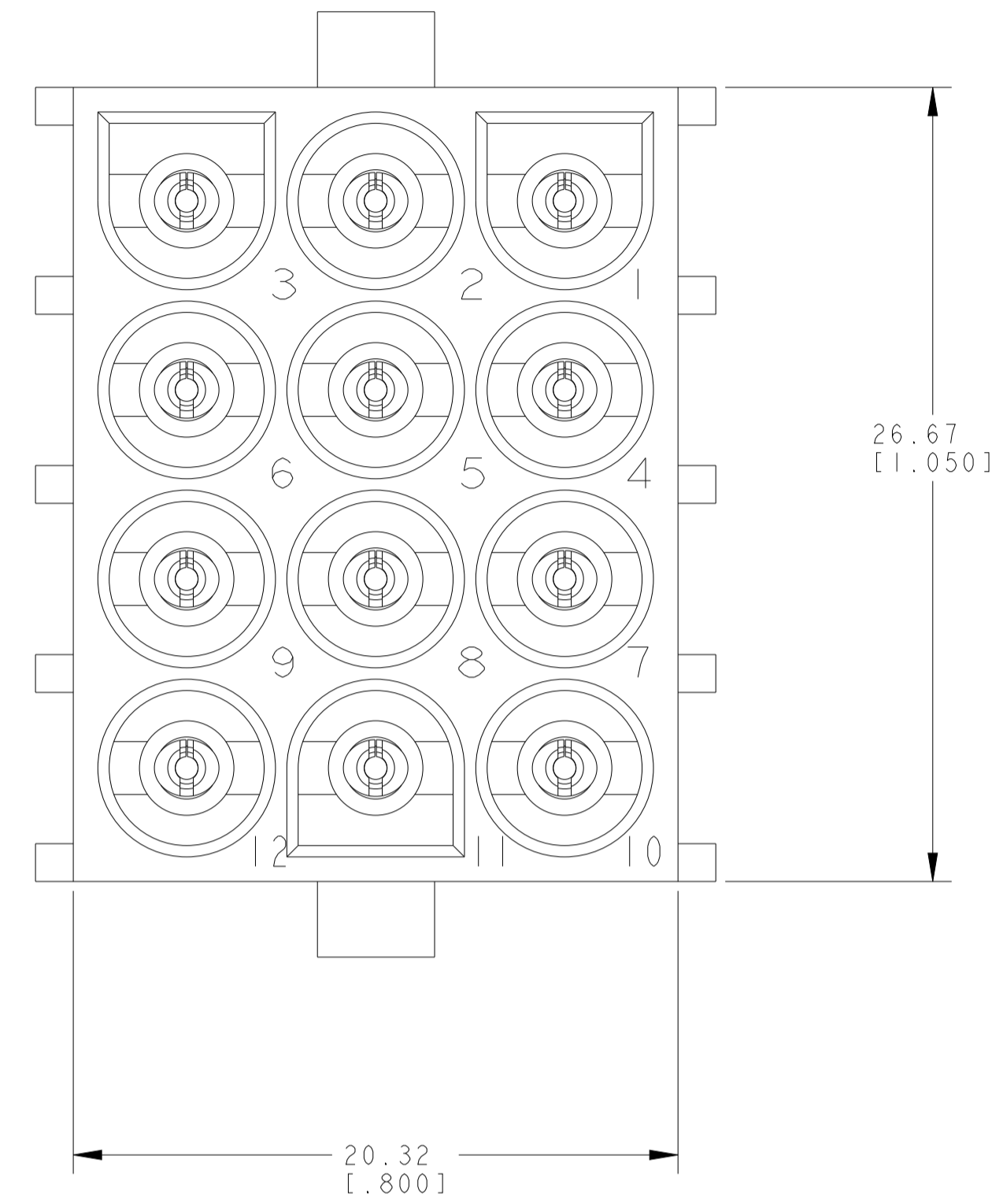

- PARTS MUST COMPLY WITH AMP SOLDERABILITY SPEC. 109-11-3.
- CONTACT IS PLATED OVERALL WITH 0.00127 [0.00050] NICKEL, THEN 0.00076 [0.00030] GOLD OVER CONTACT LENGTH INDICATED AND TIN LEAD ON SOLDER TAIL END.
- CIRCUIT IDENTIFICATION ON CHARACTERS ARE ADJACENT TO THE INDICATED CAVITIES, BUT LOCATION AND ORIENTATION MAY DIFFER FROM PRINT.
- CONTACT IS PLATED OVERALL WITH 0.00127 [0.00050] NICKEL, THEN 0.00076 [0.00030] GOLD OVER CONTACT LENGTH INDICATED AND MATTE TIN ON SOLDER TAIL END.
- SUPERSEDED BY 641974-3
- DIMENSIONS SHOWN REPRESENT PRODUCT IN DRY CONDITION. ADDITIONAL 2% GROWTH DUE TO END USE LOCATION MOISTURE ABSORPTION MAY OCCUR AND SHOULD BE ACCOUNTED FOR.

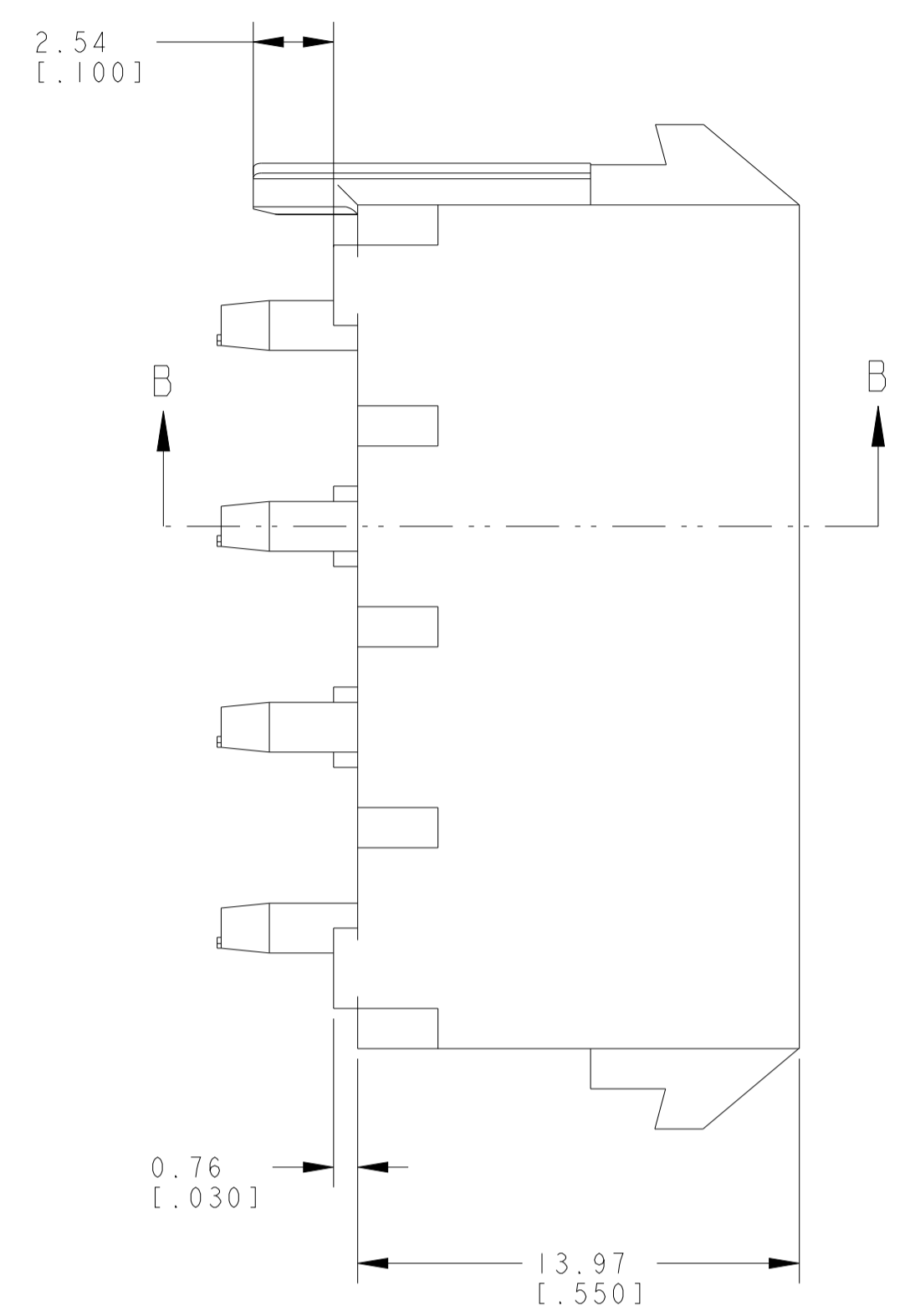
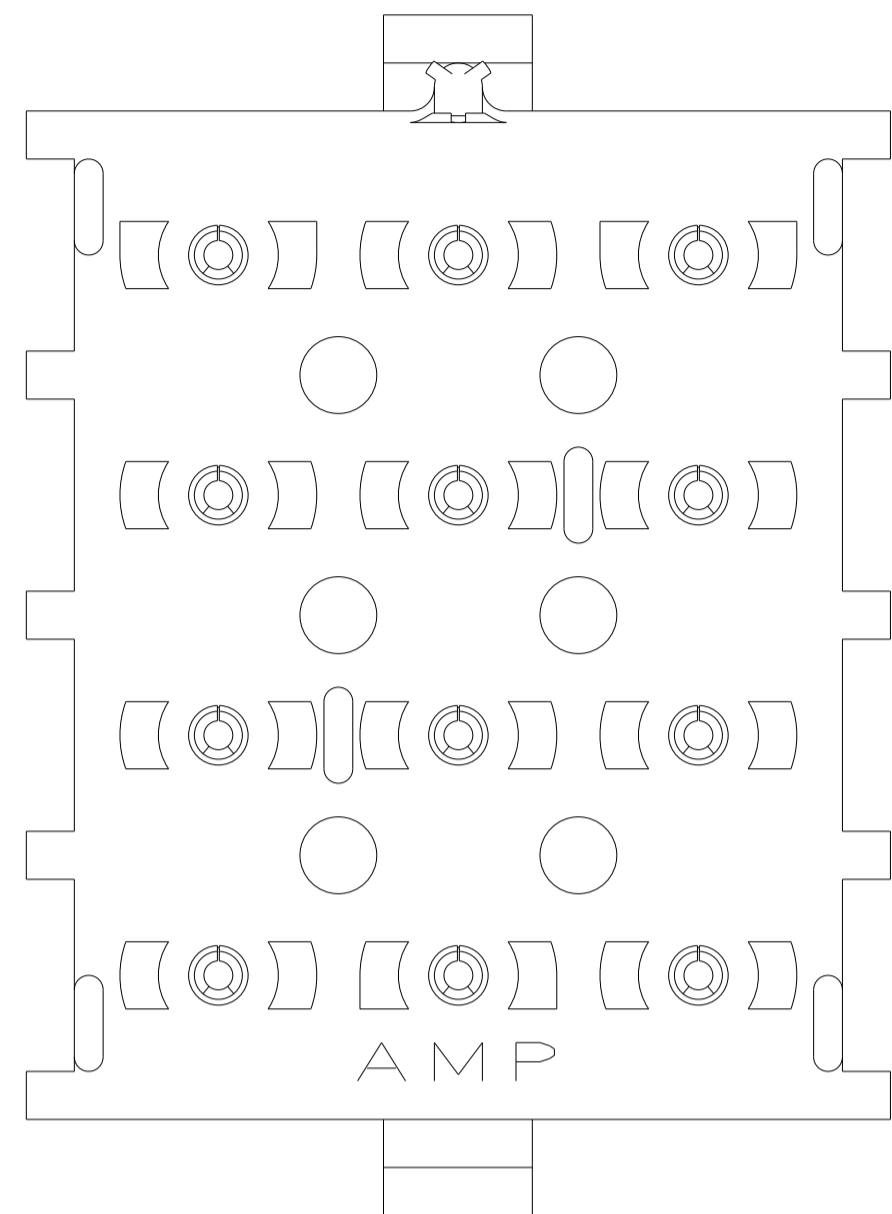
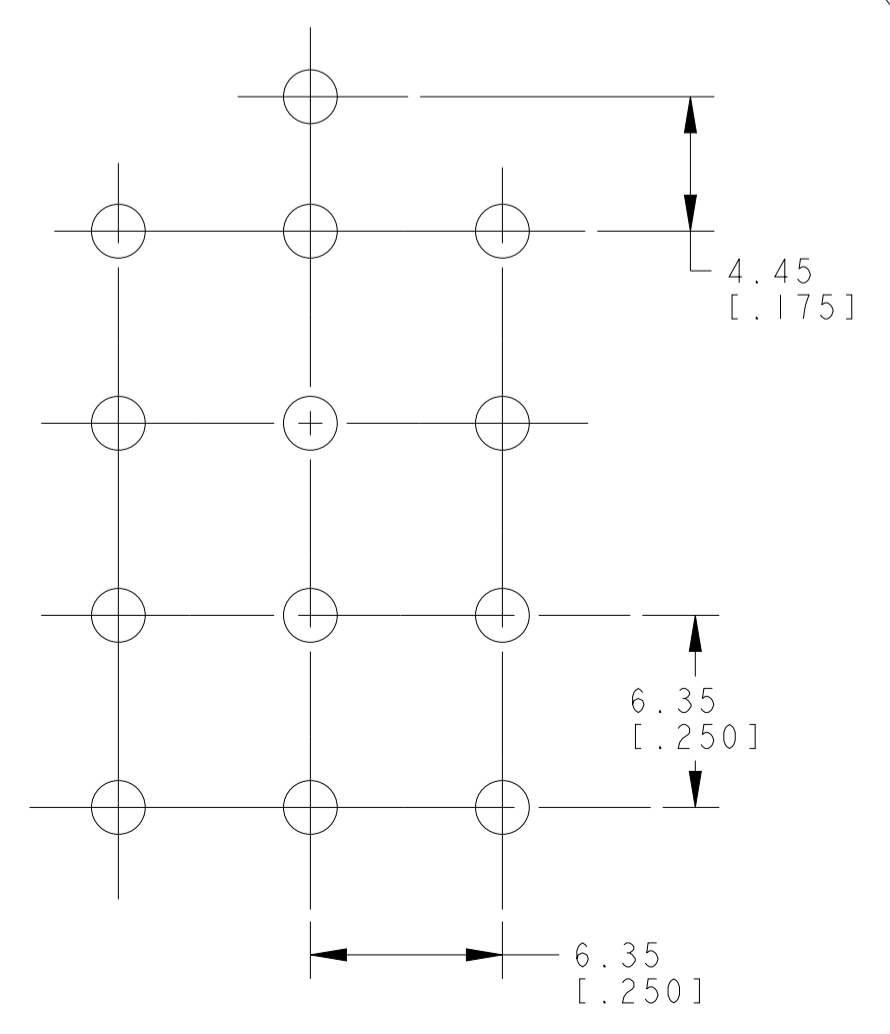
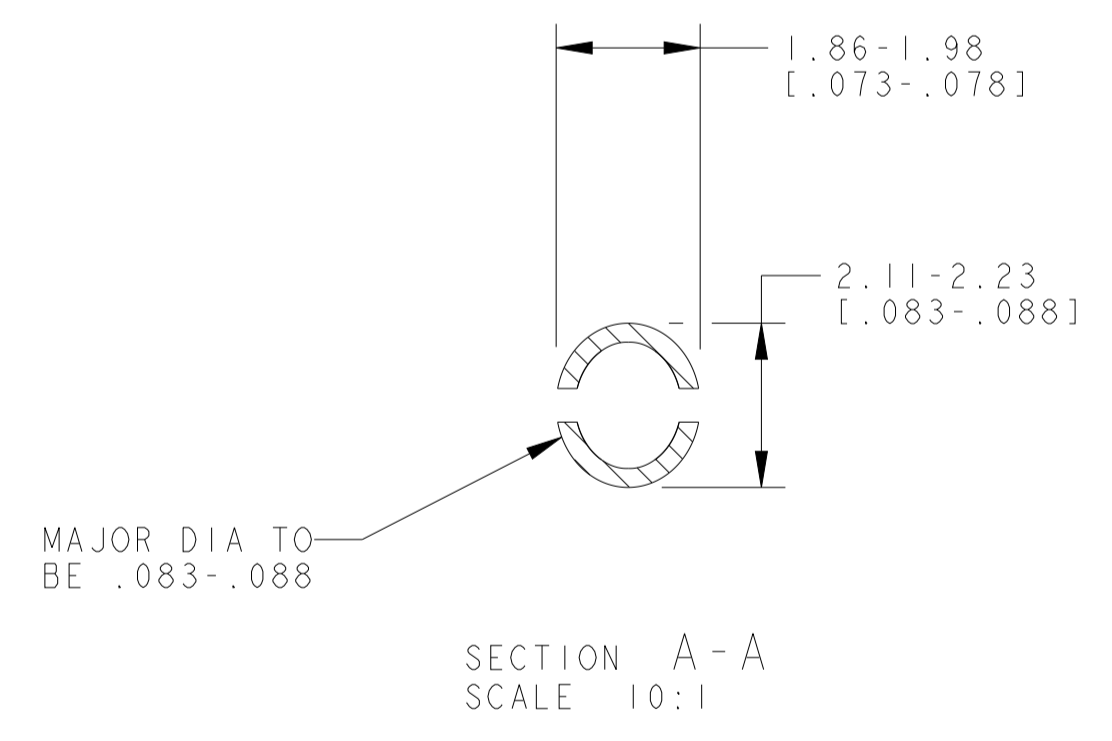
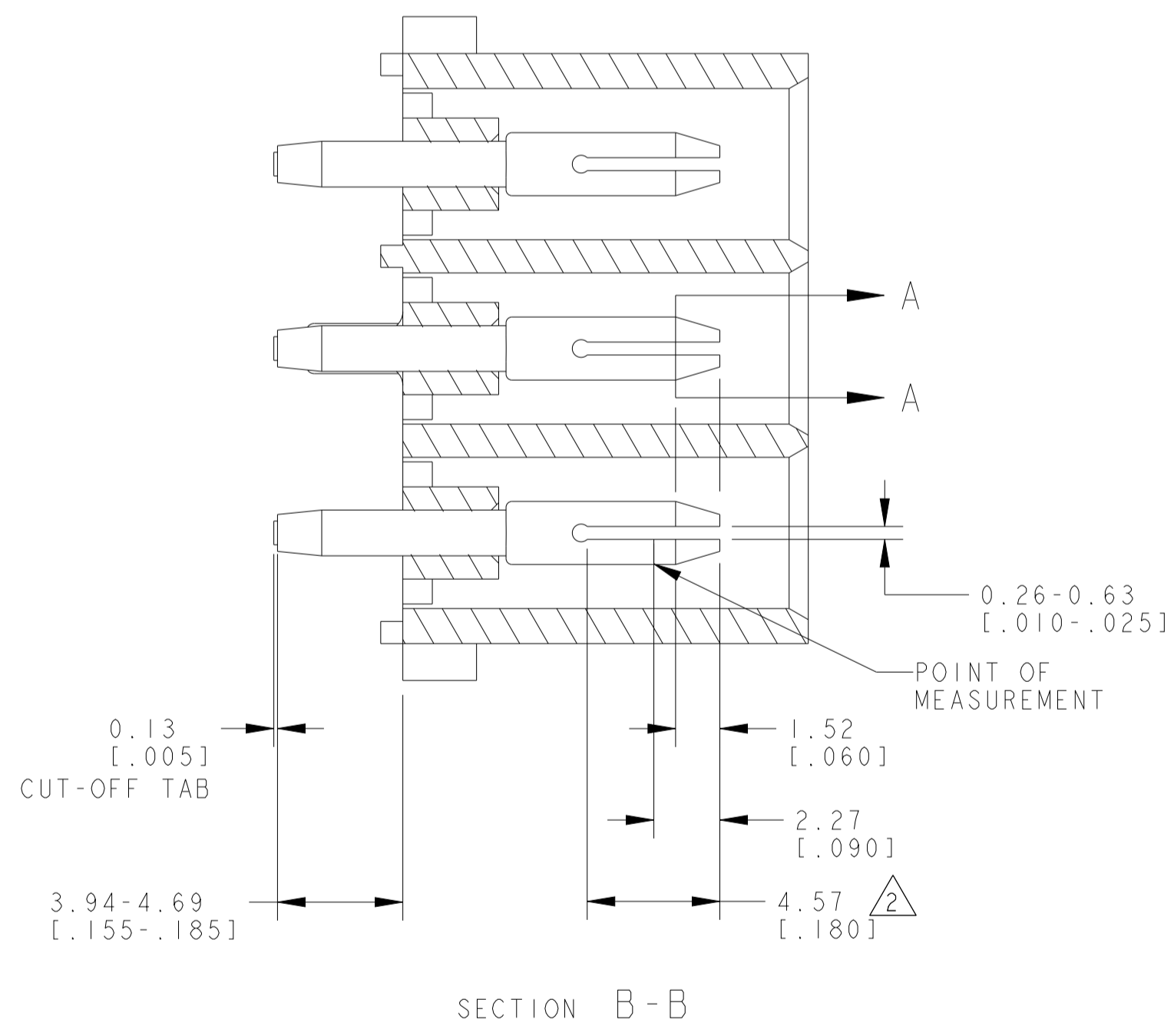

MATERIAL	FINISH	MATERIAL	COLOR	PART NO
PH BRZ	PRE-TIN	NYLON, 94V-0	BLACK	1-641974-1
PH BRZ	GOLD <sup>4</sup>	NYLON, 94V-0	WHITE	641974-3
PH BRZ	GOLD <sup>2</sup>	NYLON, 94V-0	WHITE	641974-2
PH BRZ	PRE-TIN	NYLON, 94V-0	WHITE	641974-1

METRIC

THIS DRAWING IS A CONTROLLED DOCUMENT.

OWN: R. WHITAKER 14OCT2005  
 CHK: S. RIDGILL 14OCT2005  
 APVD: S. RIDGILL 14OCT2005

TE Connectivity

NAME: HEADER ASSEMBLY, PIN UNIVERSAL MATE-N-LOK (TM), (STANDARD TAIL)

SIZE: A1 CAGE CODE: 100779 DRAWING NO: 641974

SCALE: 5:1 SHEET 1 OF 1 REV: P2