

REVISION RECORD		
REV	DESCRIPTION	DRFT

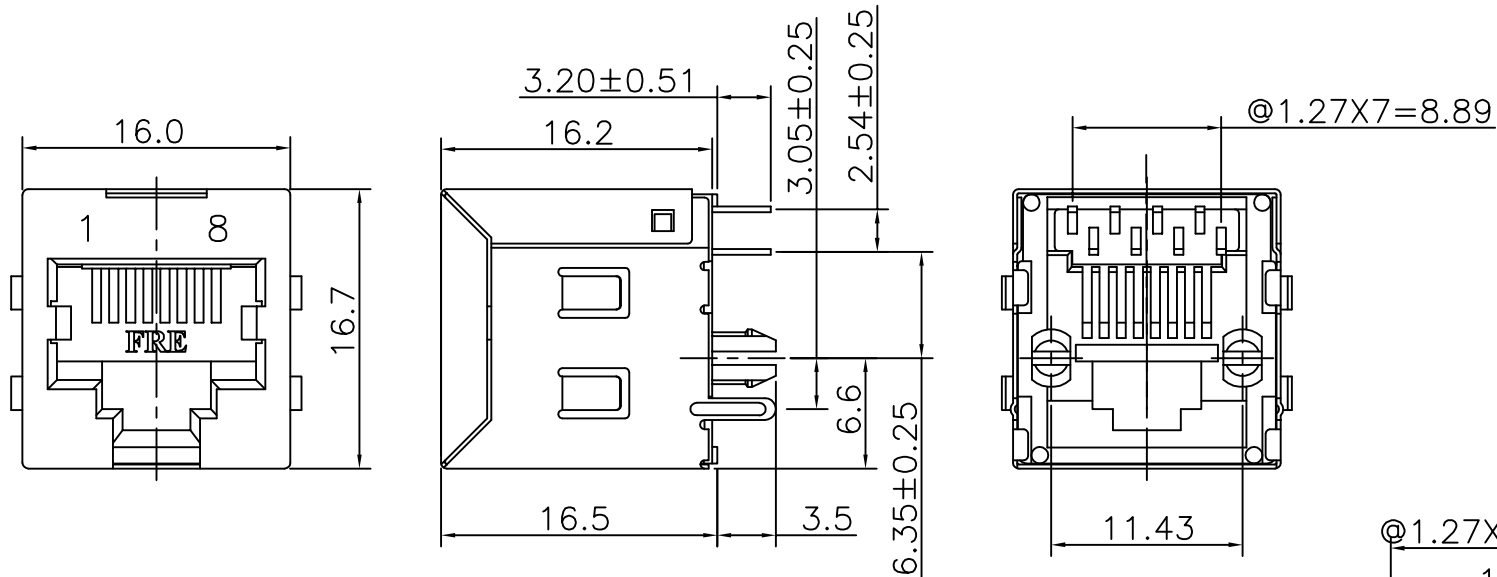

**NOTES:**

**ELECTRICAL:**

1. VOLTAGE RATING : 125 VAC RMS.
2. CURRENT RATING : 1.5 AMP.
3. CONTACT RESISTANCE : 40 MILLIOHMS MAX.
4. INSULATION RESISTANCE: 1000 MEGOHMS MIN @ 500 VDC.
5. DIELECTRIC STRENGTH : 1000 VDC RMS 60Hz, 1MIN.

**MECHANICAL:**

1. HOUSING MATERIAL : GLASS FIBER FILLED PBT UL94V-0. COLOR-BLACK
2. CONTACT MATERIAL : PHOSPHOR BRONZE t=0.35mm.
3. PLATING : GOLD PLATING OVER NICKEL.
4. OPERATING LIFE : 750 CYCLES MIN.
5. PCB RETENTION PRE-SOLDER : 1 LB MIN.
6. PCB RETENTION POST-SOLDER: 10 LBS MIN.

**ENVIRONMENTAL:**

1. STORAGE TEMPERATURE : -40°C TO +85°C.
2. OPERATION TEMPERATURE: -40°C TO +85°C.
3. WAVE SOLDER TEMPERATURE: 235~245°C(3~5 SECONDS).
4. RoHS COMPLIANT.

MATES WITH MODULAR PLUG CONFORMING TO  
FCC PART 68, SUBPART F.  
CUL FILE NO. E163191

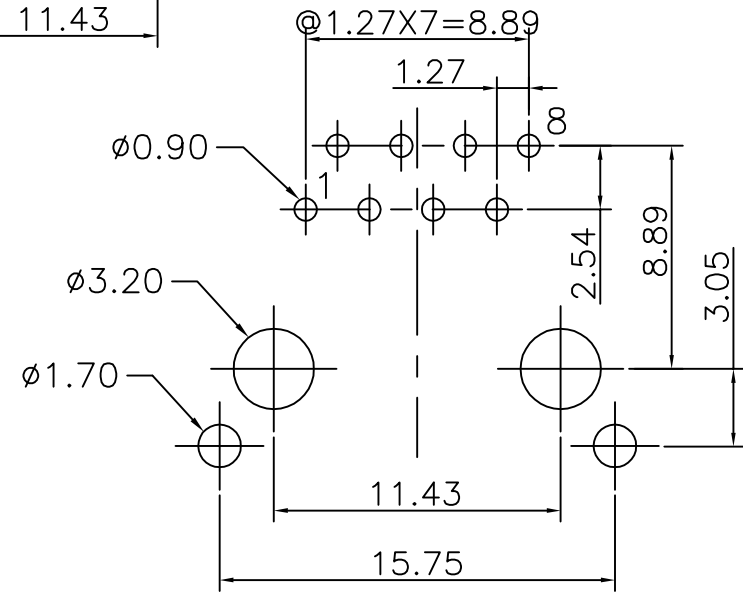

PC BOARD LAYOUT T=1.60mm  
COMPONENT SIDE SHOWN  
TOLERANCES±0.05mm

E5288-320044-L	30u"
PART NO.	Au PLATING

		<b>RoHS Compliant</b>			
DETACHED LISTS TOLERANCES EXCEPT AS NOTED MM .0 ± 0.25 ± .00 ± 0.20 ± .000 ± 0.10 ±		<b>TITLE</b> RJ45 TOP ENTRY PCB MODULAR JACK(DIP TYPE)			
ANGLES ± 1° 		DFTO : ELLA	DRAWING NO. CE5288-32004X-L	SIZE A3	REV 0
THIRD ANGLE PROJECTION		DATE : 08/13/2012	/PART NO. E5288-320044-L	DO NOT SCALE DRAWING	
SCALE : 3:1		SHEET 1 OF 1			