

PART NO.		RSA-3475	
REV	DESCRIPTION	DWN	DATE
—	ENGINEERING RELEASE	CZS	09/16/13
			APPROVED
			JDMc

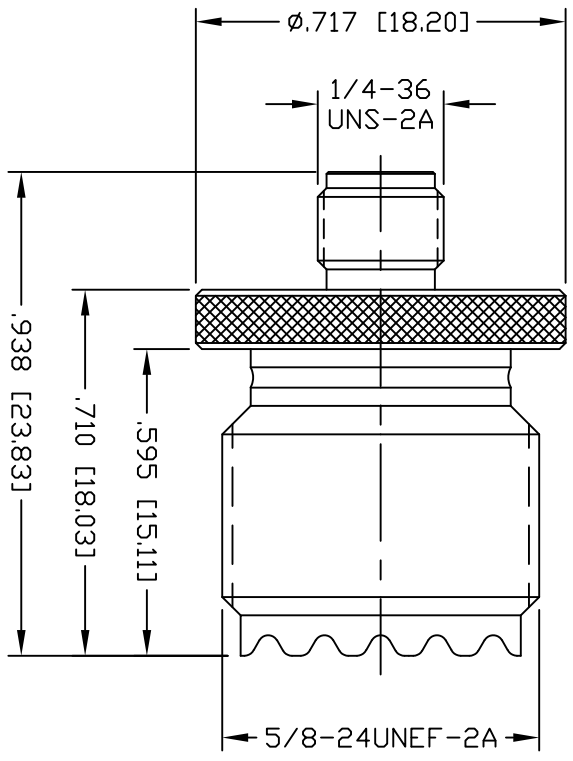

SPECIFICATIONS:

IMPEDANCE: NON CONSTANT
 FREQUENCY RANGE: 0-300 MHz
 WORKING VOLTAGE: 500 V rms max. @ sea level

#	DESCRIPTION	QTY	MATERIAL	FINISH
5	CONTACT	1	BRASS	GOLD
4	CONTACT	1	PHOS. BRONZE	GOLD
3	INSULATOR	1	PTFE	---
2	INSULATOR	1	PTFE	---
1	BODY	1	BRASS	NICKEL

CUSTOMER OUTLINE DRAWING ALL DIMENSIONS ARE REFERENCE ONLY UNLESS OTHERWISE SPECIFIED: DIMENSIONS ARE IN INCHES AND [MILLIMETERS]	
DRAWN C. ZUNIGA	09/16/13
CHECKED C. ZUNIGA	
ORG DRAWN C. ZUNIGA	09/16/13

ROHS COMPLIANT

PROPRIETARY AND CONFIDENTIAL
 THIS DRAWING CONTAINS
 INFORMATION PROPRIETARY TO
 RF INDUSTRIES, ANY
 UNAUTHORIZED USE OF THIS
 DRAWING IS EXPRESSLY
 PROHIBITED WITHOUT WRITTEN
 PERMISSION FROM RF
 INDUSTRIES. ANY VIOLATION IS
 PUNISHABLE UNDER U.S.
 COPYRIGHT LAWS.

RF Industries
 DIVISION OF RF INDUSTRIES, LTD. (858) 549-6345 FAX

RFINDUSTRIES.COM
 7610 MIRAMAR RD.
 SAN DIEGO, CA 92126
 (858) 549-6340

SMA JACK TO UHF JACK
 ADAPTOR

CABLE GROUP | DWG # **RSA-3475** | REVISION

FORMAT | SCALE | CONTROL # | SHEET 1 OF 1

A | N/A | NTS | 008974