

This document is the property of Amphenol Corporation and is delivered on the express condition that it is not to be disclosed, reproduced or used, in whole or in part, for manufacture or sale by anyone other than Amphenol Corporation without its prior consent, & that no right is granted to disclose or to use any information in this document.

Customer drawing

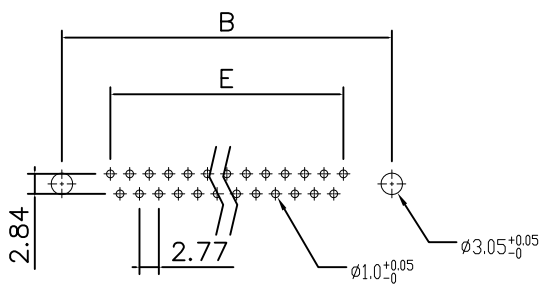

Recommended PCB layout
Tolerance: $\pm 0.05\text{mm}$

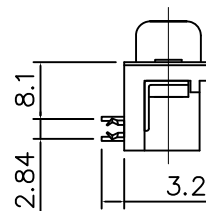
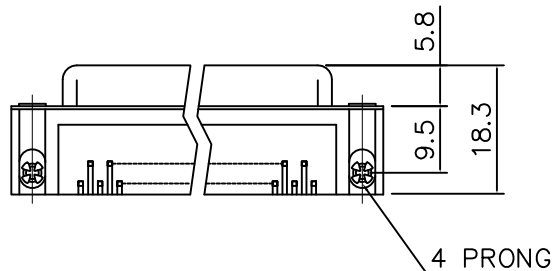
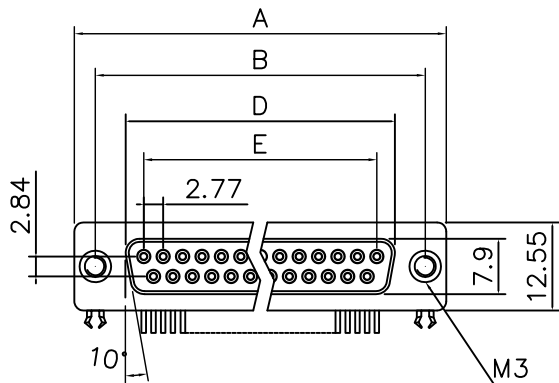

REVISIONS				
SYM	ECN	DESCRIPTION	DATE	APPROVED
1	HK--	First Release Drawing	04/11/19	IP

D-SUB TECHNICAL DATA

SHELL: SPCC, 100u" min Tin over 50u" min Nickel over 50u" min Copper

BODY: PA9T, UL 94V-0 Color: Black.

CONTACTS: Copper alloy
15u" Gold over 50u" min Nickel on mating area
100u" Tin over 50u" min Nickel on solder area

BOARDLOCK: Copper alloy, Tin plated

SCREWLOCK: Copper alloy, Nickel plated

REAR RIVET: Copper alloy, Nickel plated

ELECTRICAL: Current Rating: 3A
Voltage Rating: 250 VAC (RMS) Max.
Contact Resistance: 20 mohms Max.
Insulation Resistance: 1000 Mohms Min
Withstanding voltage: 1000V Rms

MARKING : Amphenol...(Series No.)
Commercial reference
Manufacturing date

PRODUCT CODE

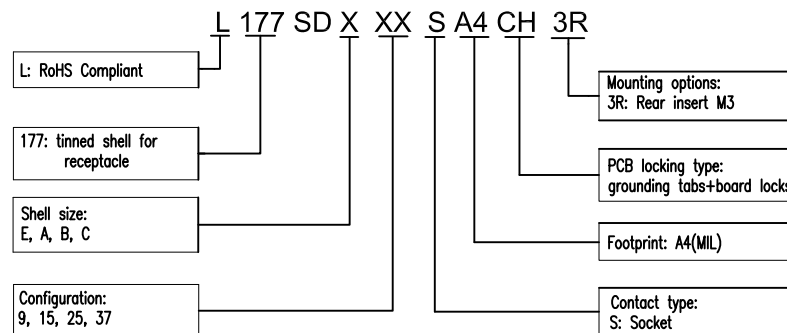

Dimensions

Shell Size	Positions	A	B	D	E
E	9	30.81	24.99	16.33	11.08
A	15	39.20	33.30	24.70	19.39
B	25	53.05	47.04	38.40	33.24
C	37	69.40	63.50	54.80	49.86

UNLESS OTHERWISE SPECIFIED TOLERANCES		APPROVAL		DATE
U.S.	METRIC	DRAWN	Simon.Chen	04/11/19
.X +/-	0.50	CHECKED	Tony.Tang	04/11/19
.XX +/-	0.30	CHECKED		
.XXX +/-	0.20	DRAWING FILE :		
FRACTIONS +/-	5'	ANGLE OF PROJECTION		
ANGLES +/-				
REMOVE SHARP EDGES		DIMENSIONS		

Amphenol

TITLE
D-sub connector,R/A Series

SIZE	DRAWING NO.	REV.
A4	L177SDXXXSA4CH3R	1
SCALE	NONE	SHEET 1 OF 1