

This document is the property of Amphenol Corporation and is delivered on the express condition that it is not to be disclosed, reproduced or used, in whole or in part, for manufacture or sale by anyone other than Amphenol Corporation without its prior consent, & that no right is granted to disclose or to use any information in this document.

# Customer Drawing

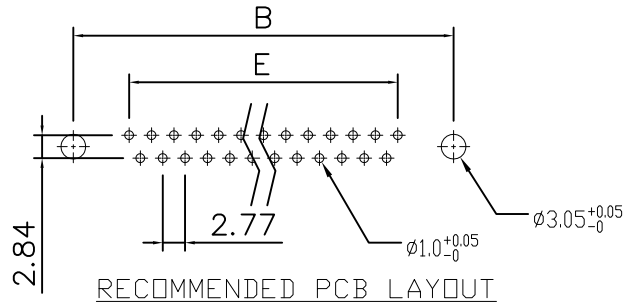
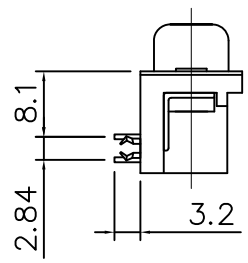
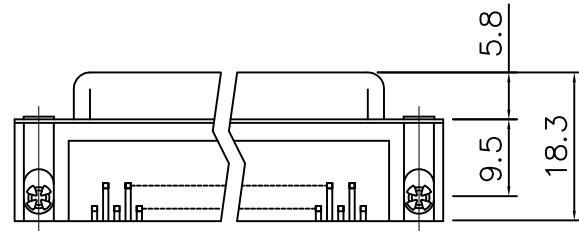
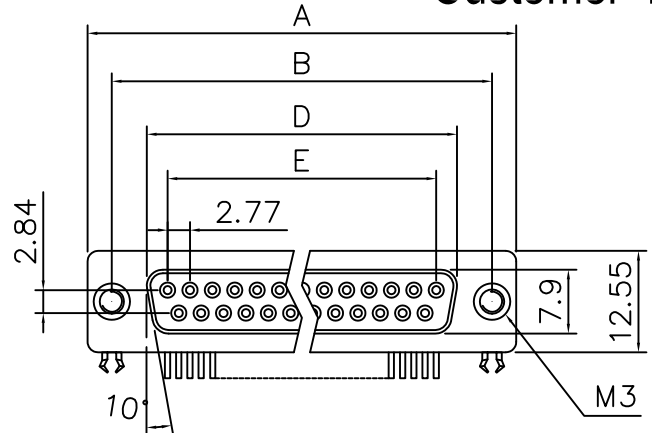

## Dimensions

Shell size	Positions	A	B	D	E
E	9	30.81	24.99	16.33	11.08
A	15	39.20	33.30	24.70	19.39
B	25	53.05	47.04	38.40	33.24
C	37	69.40	63.50	54.80	49.86

REVISIONS				
SYM	ECN	DESCRIPTION	DATE	APPROVED
1	HK--	First Release Drawing	04/11/19	IP

## D-SUB TECHNICAL DATA

SHELL : SPCC, 100u" min Tin over 30u" min Nickel over 50u" min Copper

BODY : PBT UL 94V-0 Color: Black

CONTACTS : Copper Alloy  
Gold flash over 50u" min Nickel on mating area.  
100u" min Tin over 50u" min Nickel on solder area.

BOARDLOCK: Copper alloy, Tin plated.

REAR NUT: Copper alloy, Nickel plated.

ELECTRICAL : Voltage rating 250 V Rms Max.  
Current rating 3A.  
Withstanding Voltage >1000 V Rms  
Insulation resistance >1000 M Ohms  
Contact resistance 20 mOhms max.

MARKING : Amphenol...(Series No.)  
Commercial reference  
Manufacturing date

## PRODUCT CODE

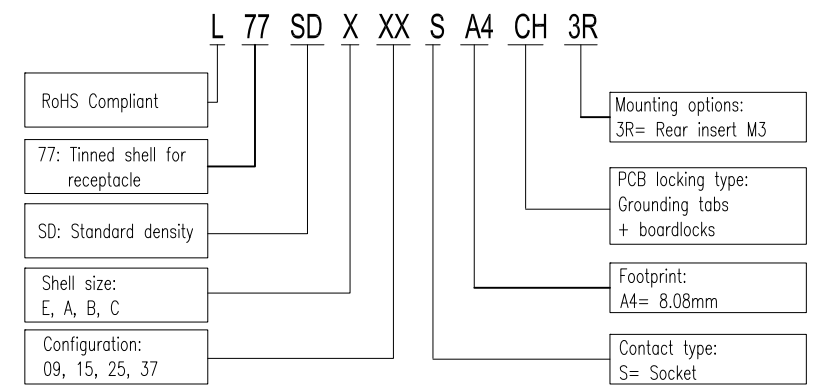

UNLESS OTHERWISE SPECIFIED TOLERANCES	APPROVAL	DATE
U.S. METRIC	DRAWN <i>Simon.Chen</i>	04/11/19
.X +/- 0.50	CHECKED <i>Tony.Tang</i>	04/11/19
.XX +/- 0.30	CHECKED	
.XXX +/- 0.20		
FRACTIONS +/-		
ANGLES +/- 5°		
FOR MATERIALS AND FINISHES SEE NOTES	DRAWING FILE :	
REMOVE SHARP EDGES	ANGLE OF PROJECTION	
DIMENSIONS		
U.S. INCHES		
METRIC MM		

Amphenol		
D-SUB connector, R/A Series		
TITLE		
SIZE	DRAWING NO.	REV.
A4	L77SDXXXSA4CH3R	1
SCALE	NONE	SHEET 1 OF 1