

THIS DRAWING IS UNPUBLISHED. RELEASED FOR PUBLICATION .19
BY AMP INCORPORATED. ALL INTERNATIONAL RIGHTS RESERVED.

NOO 2 LOC BD DIST 48

		REVISIONS				
P	F	ZONE	LTR	DESCRIPTION	DATE	APPD
			B	REVISED & REDRAWN PER ECN-2262	-	-
			C	REVISED PER ECN BD5212	08/28/78	-
✓			D	OBS -2 PER ECN BD6177	08/17/82	TS

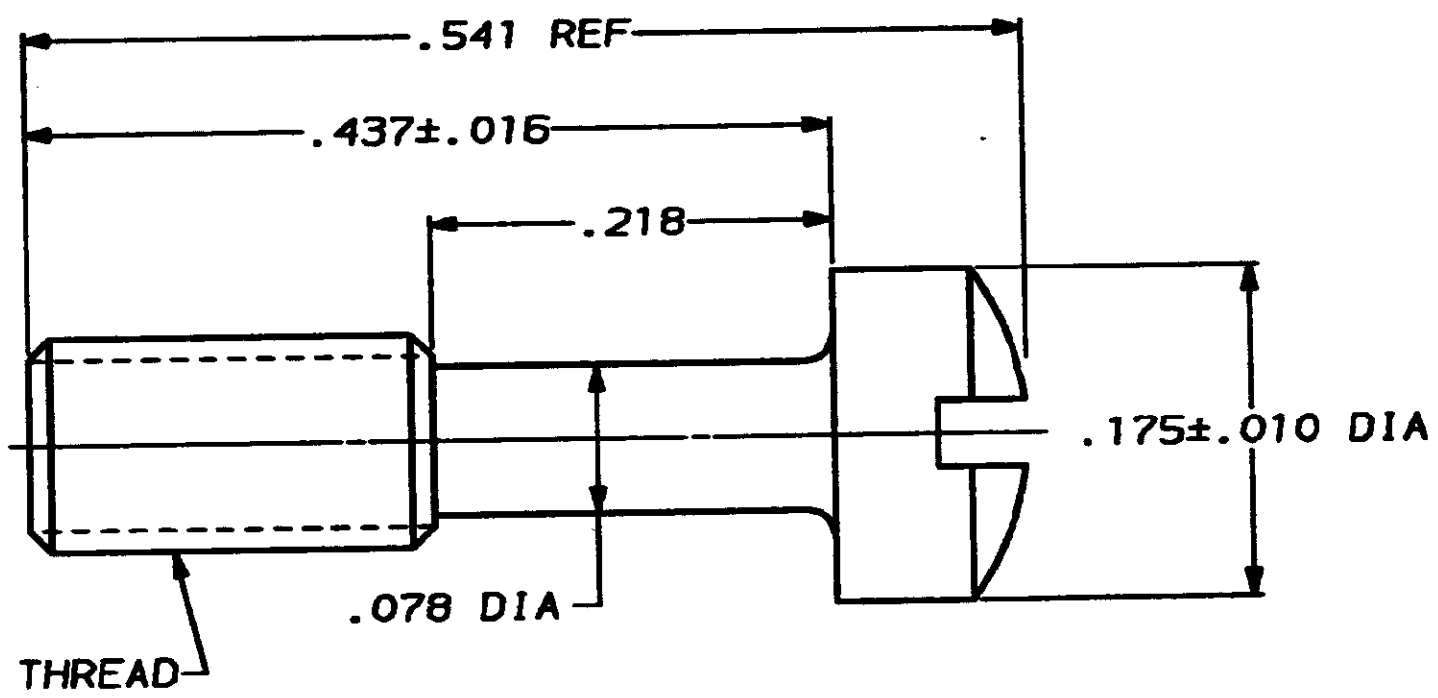

- 1. MUST BE USED WITH PART NUMBER 206473.
- 2. ZINC PLATED PER ASTM B633, TYPE II, CLASS SC1, YELLOW CHROMATE.
- 3. ZINC PLATED PER ASTM B633, TYPE III, CLASS SC1, CLEAR CHROMATE.

	3	206052-3
OBSOLETE	2	206052-2
FINISH		PART NO

DO NOT SCALE PRINT. UNLESS SPECIFIED DIMENSIONS IN INCHES TOLERANCES ON: 12 PLC DEC * - 13 PLC DEC * .005 ANGLES * -		OR C.80000 S-10-00 N.S. LEECH APPD 8-15-88 R.A. MOORE APPD 8-10-88 V. JENNA	AMP INCORPORATED MKTG/ENGRG. PG. 17100	
MATERIAL COLD ROLLED STEEL PER ASTM A108	PRODUCT SPEC	SADDLE SCREW, AMPLIMITE®		
FINISH SEE TABLE	APPLICATION SPEC	SIZE B	PART NO 00779	DRAWING NO 206052
		SCALE 10.1	SHEET 1 OF 1	

CUSTOMER DRAWING