

**NOTES:**

1. FOR WAVESOLDERING (SOLDER BATH TEMPERATURE 260 °C FOR 5 SEC. AND SOLDER PREHEAT 100 °C FOR 30 SEC.)
2. METALSHELLS: STEEL; min. 315µm TIN over 40-80µm NICKEL
3. INSULATOR: HIGH TEMPERATURE PLASTIC UL 94 V-0; BLACK
4. CONTACTS: COPPER ALLOY; PLATING (SEE PART NO.):
  - PLEASE ADD A for GOLD FLASH over NICKEL (PREFERRED TYPE)
  - PLEASE ADD B for 20µm HARD GOLD over min. 50µm NICKEL
  - PLEASE ADD C for 30µm HARD GOLD over min. 50µm NICKEL
5. THREADED SPACER CLIPS: COPPER ALLOY; min. 200µm TIN over 80µm NICKEL  
PCB-HOLE:  $\varnothing 3,1 \pm 0,1$ ; PCB THICKNESS 1,6mm
6. COLLARS: COPPER ALLOY; min. 200µm TIN over 80µm NICKEL
7. CAPACITANCE: 2 x 1300pF  $\pm 20\%$
8. DIELECTRIC WITHSTANDING VOLTAGE: 300 VDC
9. P.C.B. HOLE DRILLING ON PCB ON SHEET 2
10. MAXIMUM TORQUE VALUE FOR THREAD: 6 in.LB
11. CONNECTOR IS PART MARKED: **242□26400X CONEC ABC** (see note 4)

Directive 2002/95/EC RoHS compliant

THIS DRAWING MAY NOT BE COPIED OR REPRODUCED IN ANY WAY, AND MAY NOT BE PASSED ON TO A THIRD PARTY WITHOUT WRITTEN PERMISSION. OWNERSHIP AND COPYRIGHT OF CONEC GmbH DO NOT ALTER CAD DRAWING BY HAND				tolerance		scale: 2:1 (5:1)
				dim. in mm		material: SEE NOTES
				date	name	title: D-SUB PI FILTER FEMALE 25pos. SOLDER PIN STRAIGHT with threaded spacer clip
				drawn 25.03.14	Henneboel	
			appd. 06.05.14	Schmidt		
			norm			
			d-old	24K1A984	dwg no:	
4 x b	Ä5135	18.03.2014	K.H.		24K1A1507 (b)	DIN-A3
a	Original					sh: 1/2
rev.	description	date	name	part no: (b) 242□26400X (see note 4)		

# P.C.B. HOLE DRILLINGS

(P.C.B. TOP SIDE)

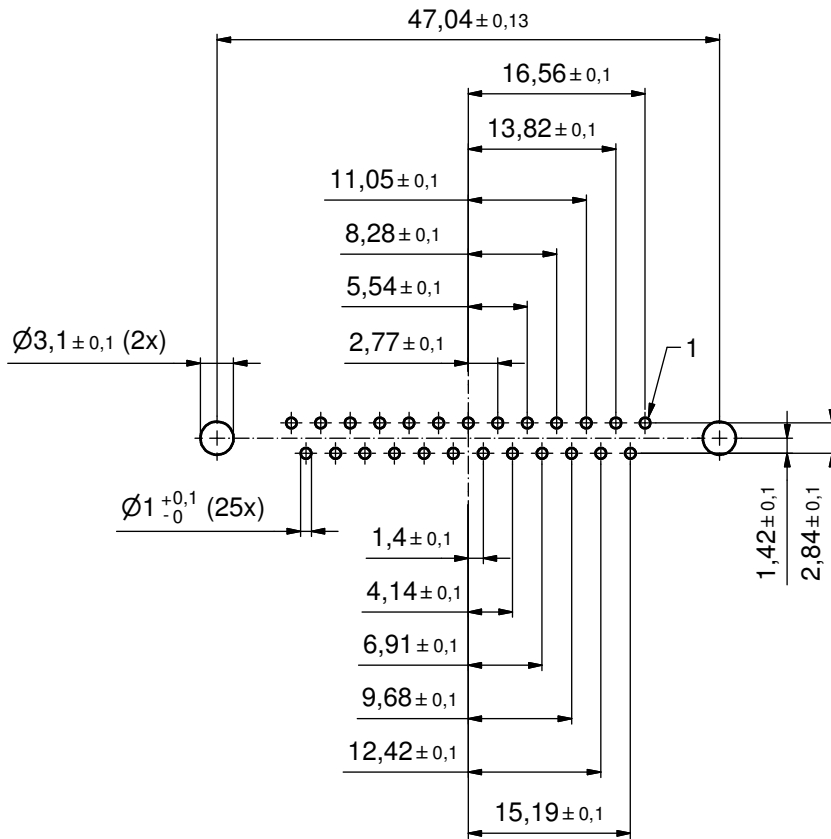

THIS DRAWING MAY NOT BE COPIED OR REPRODUCED IN ANY WAY, AND MAY NOT BE PASSED ON TO A THIRD PARTY WITHOUT WRITTEN PERMISSION. OWNERSHIP AND COPYRIGHT OF CONEC GmbH DO NOT ALTER CAD DRAWING BY HAND				tolerance		scale: 2:1	
					dim. in mm	material: SEE SHEET 1	
				date	name	title: <b>P.C.B. HOLE DRILLINGS</b> D-SUB PI FILTER FEMALE 25pos. SOLDER PIN with threaded spacer clip	
				drawn 25.03.14	Henneboel		
				appd. 06.05.14	Schmidt		
				norm			
				d-old		dwg no:	
	a	Original		<b>CONEC</b> <sup>®</sup>		24K1A1507	DIN-A3
	rev.	description	date			name	part no: SEE SHEET 1