

- NOTES:
- MATERIALS: HOUSING - LCP, GLASS FILLED, UL 94V-0, COLOUR: BLACK
POWER PINS - COPPER ALLOY
SIGNAL PINS - COPPER ALLOY
BOARDLOCK - COPPER ALLOY
 - FINISHES : POWER AND SIGNAL PINS :
SELECTIVE GOLD IN THE CONTACT AREA.
THICKNESS = 0.76 MICROMETER / 30 MICROINCH MINIMUM
SELECTIVE TIN IN THE PC TAIL AREA
THICKNESS = 2.54 MICROMETER / 100 MICROINCH MINIMUM
1.27µm NICKEL OVERALL
 - PRODUCT SPECIFICATION : PS-87631-006
 - SEE SHEET 2 FOR RECOMMENDED PCB LAYOUT AND THICKNESS.
 - COMPONENT STAY AWAY ZONE FROM CONNECTOR.
 - MANUFACTURER LOGO, PART NUMBER AND YEAR-WEEK CODE.
 - 8 POWER ALPHA - 24 SIGNAL IS SHOWN FOR ILLUSTRATION .
CONNECTOR CONFIGURATION IS AVAILABLE UP TO 203MM/INCH.
PLEASE CONTACT MOLEX SALES PERSONNEL FOR OTHER CONFIGURATION AND OPTION NEEDED.

THIS DRAWING CONTAINS INFORMATION THAT IS PROPRIETARY TO MOLEX ELECTRONIC TECHNOLOGIES, LLC AND SHOULD NOT BE USED WITHOUT WRITTEN PERMISSION											
DIMENSION UNITS		SCALE		CURRENT REV DESC: OBSOLETE PART NO							
MM/IN		NTS		<p>HEADER POWER CONNECTOR P-S CONFIG, R/A, T/H WITH BOARD-LOCK</p> <p>PRODUCT CUSTOMER DRAWING</p>							
GENERAL TOLERANCES (UNLESS SPECIFIED)											
		MM	INCH								
4 PLACES	±										
3 PLACES	±	0.25	± 0.01								
2 PLACES	±	0.25	±								
1 PLACE	±										
0 PLACES	±			INITIAL REVISION:		DOCUMENT NUMBER					
ANGULAR TOL		± 3.0°		DRWN: BHLOW		2002/11/21		SD-87696-014			
				APPR: SKTOH		2002/11/27		DOC TYPE	DOC PART	REVISION	
DRAFT WHERE APPLICABLE MUST REMAIN WITHIN DIMENSIONS		THIRD ANGLE PROJECTION		DRAWING		SERIES		MATERIAL NUMBER		CUSTOMER	SHEET NUMBER
				A3-SIZE		87696		SEE TABLE		GENERAL MARKET	1 OF 3

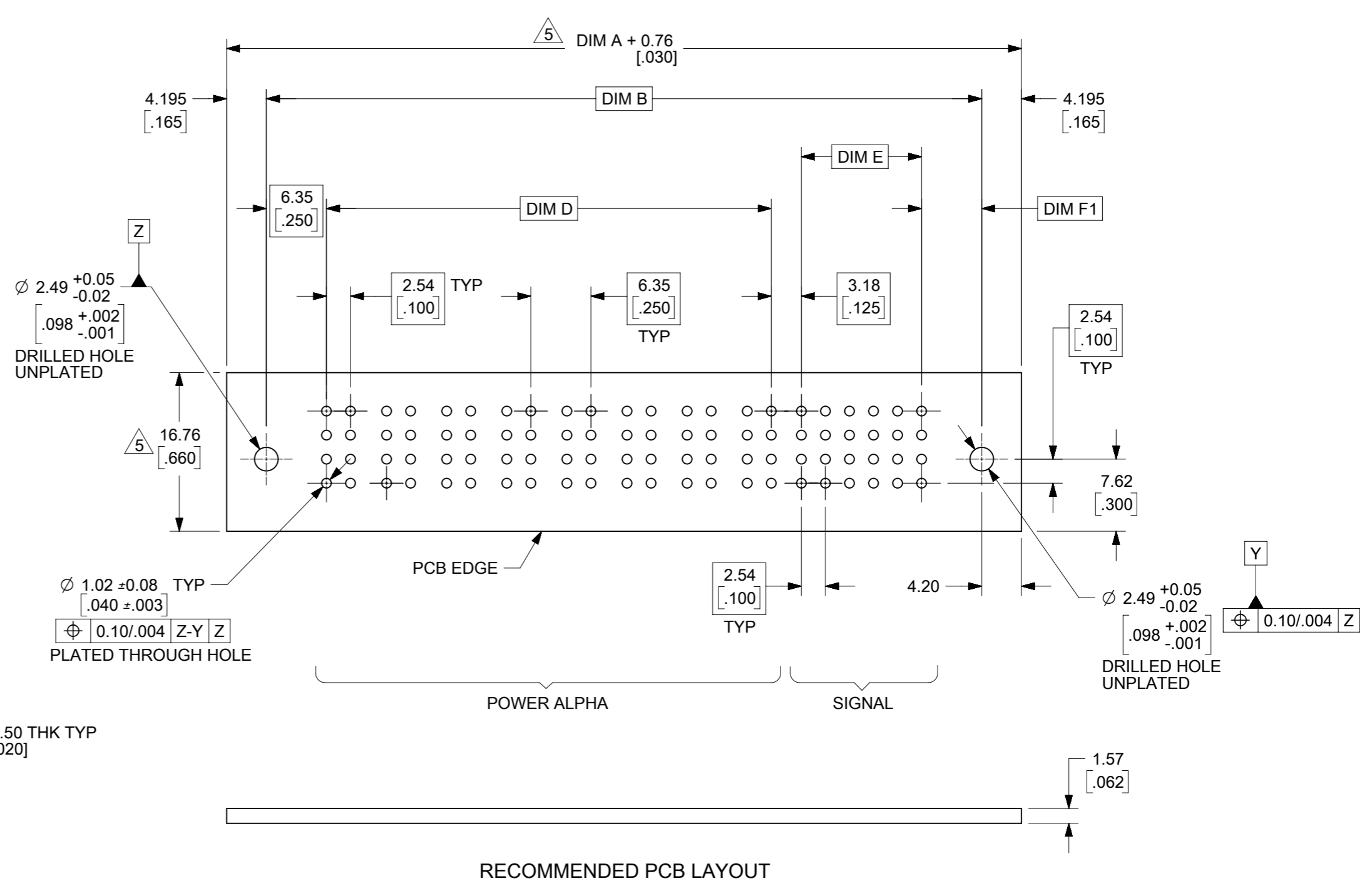
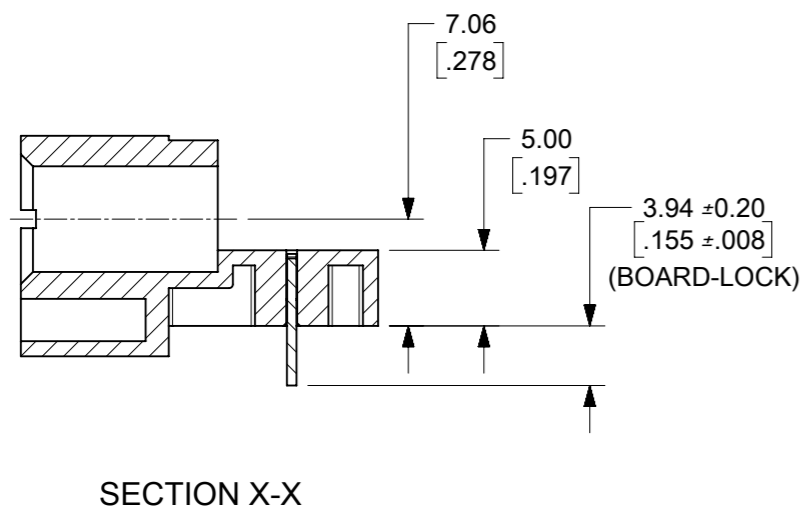
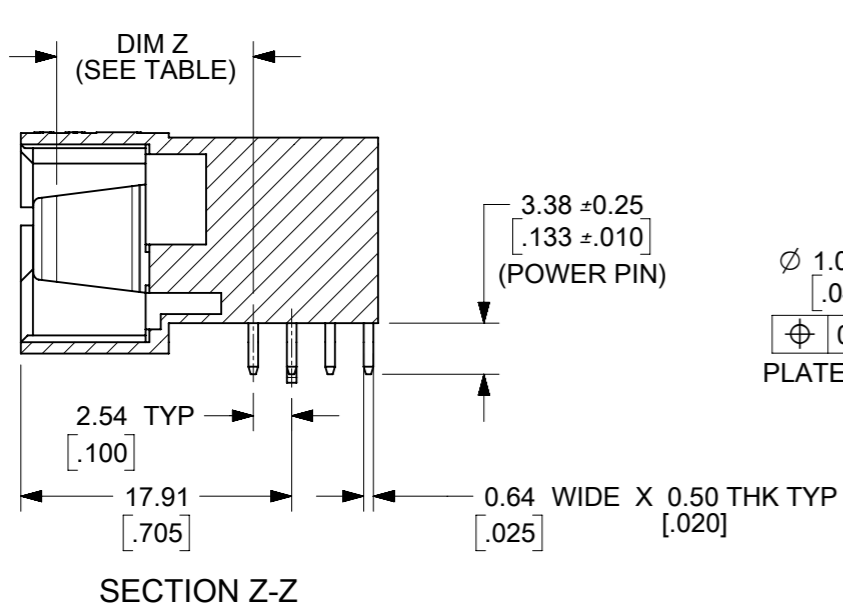
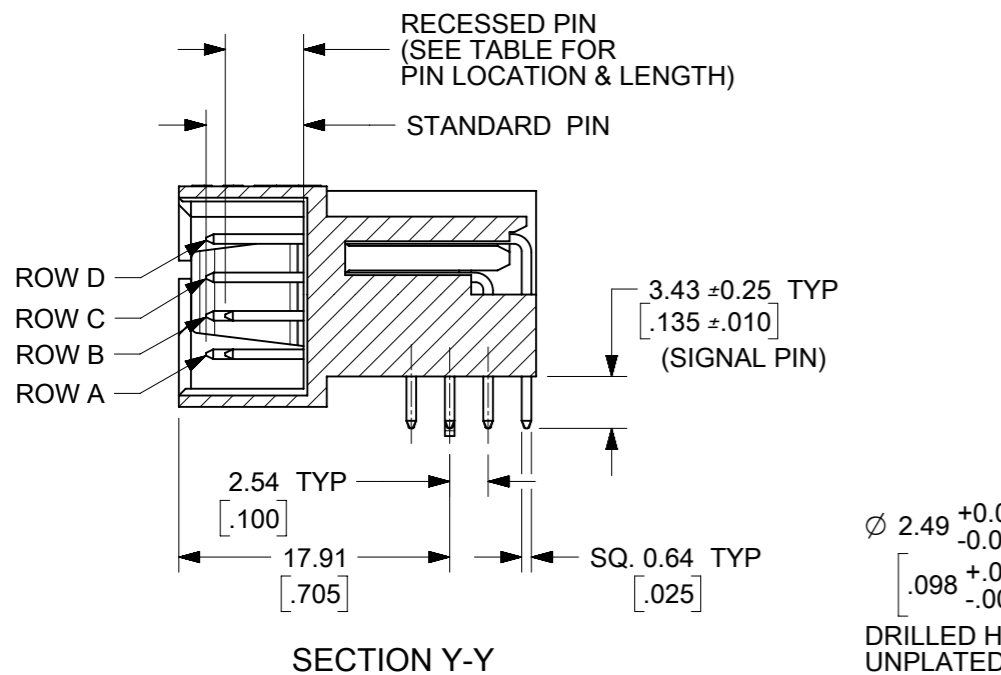

THIS DRAWING CONTAINS INFORMATION THAT IS PROPRIETARY TO MOLEX ELECTRONIC TECHNOLOGIES, LLC AND SHOULD NOT BE USED WITHOUT WRITTEN PERMISSION

DIMENSION UNITS		SCALE		CURRENT REV DESC: OBSOLETE PART NO				molex			
MM/IN		NTS									
GENERAL TOLERANCES (UNLESS SPECIFIED)							HEADER POWER CONNECTOR P-S CONFIG, R/A, T/H WITH BOARD-LOCK				
4 PLACES	±		±	EC NO: 618848		2018/07/17		PRODUCT CUSTOMER DRAWING			
3 PLACES	±		± 0.01	DRWN: AKUMAR19		2019/09/05		DOCUMENT NUMBER			
2 PLACES	±	0.25	±	CHK'D: GGA		2019/09/05		DOC TYPE DOC PART REVISION			
1 PLACE	±		±	APPR: GGA		2019/09/05		SD-87696-014 PSD 001 E			
0 PLACES	±		±	INITIAL REVISION:		2002/11/21		MATERIAL NUMBER			
ANGULAR TOL			± 3.0°	DRWN: BHLOW		2002/11/27		CUSTOMER			
DRAFT WHERE APPLICABLE MUST REMAIN WITHIN DIMENSIONS				THIRD ANGLE PROJECTION		DRAWING		SERIES		SHEET NUMBER	
				A3-SIZE		87696		SEE TABLE		GENERAL MARKET 2 OF 3	

PART NUMBER	P-S CONFIGURATION		DIM A	DIM B	DIM C	DIM D	DIM E	DIM F	DIM F1	POWER BLADE OPTIONS		STANDARD PIN LOCATION			RECESSED PIN LOCATION			VOID PIN LOCATION	PACKAGING
	POWER ALPHA	SIGNAL								TYPE	DIM Z ±0.13/.005	ROW	COLUMN	LENGTH	ROW	COLUMN	LENGTH		
87696-2004	4	16	$\frac{52.71}{2.075}$	$\frac{45.09}{1.775}$	$\frac{43.81}{1.725}$	$\frac{21.59}{.850}$	$\frac{7.62}{.300}$	$\frac{5.72}{.225}$	$\frac{6.35}{.250}$	LONG CONTACT	14.12/.556	D C B A	ALL	6.86/.270	A	1	5.59/.220	NIL	TRAY
87696-2010	8	28	$\frac{85.09}{3.350}$	$\frac{77.47}{3.050}$	$\frac{76.20}{3.000}$	$\frac{46.99}{1.850}$	$\frac{15.24}{.600}$	$\frac{5.08}{.200}$	$\frac{5.72}{.225}$	LONG CONTACT	14.12/.556	D C B A	1,2,3,4	6.86/.270	D C B A	1,2,3,4,5,6,7 1,2,3,4,5,6,7 1,2,3,4,5,6,7 5,6,7	5.59/.220	NIL	TRAY

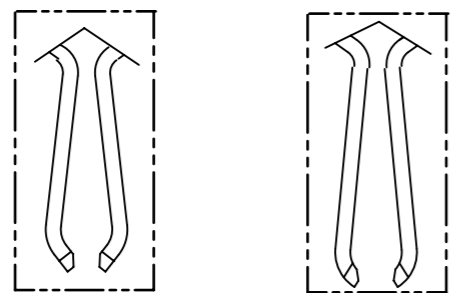

SHORT BLADE OPTION LONG BLADE OPTION

DETAIL R
(SEE TABLE FOR BLADE OPTION)

THIS DRAWING CONTAINS INFORMATION THAT IS PROPRIETARY TO MOLEX ELECTRONIC TECHNOLOGIES, LLC AND SHOULD NOT BE USED WITHOUT WRITTEN PERMISSION															
DIMENSION UNITS		SCALE		CURRENT REV DESC: OBSOLETE PART NO											
MM/IN		NTS													
GENERAL TOLERANCES (UNLESS SPECIFIED)															
		MM	INCH	EC NO: 618848											
4 PLACES	±			DRWN: AKUMAR19				2018/07/17							
3 PLACES	±		0.01	CHK'D: GGA				2019/09/05							
2 PLACES	±	0.25		APPR: GGA				2019/09/05							
1 PLACE	±			INITIAL REVISION:											
0 PLACES	±			DRWN: BHLOW				2002/11/21							
ANGULAR TOL		± 3.0°		APPR: SKTOH				2002/11/27							
DRAFT WHERE APPLICABLE MUST REMAIN WITHIN DIMENSIONS				THIRD ANGLE PROJECTION		DRAWING		SERIES		MATERIAL NUMBER		CUSTOMER		SHEET NUMBER	
						A3-SIZE		87696		SEE TABLE		GENERAL MARKET		3 OF 3	

DOCUMENT STATUS	P1	RELEASE DATE	2019/09/05	07:40:48
-----------------	----	--------------	------------	----------