

PLATING SPECIFICATIONS

	CONTACT	TERMINAL
A	.000015" GOLD	.0001" TIN/LEAD
D	.00003" GOLD	.00003" GOLD OVERALL
G	.00001" GOLD	.000005" GOLD
M	.00003" GOLD	.00001" GOLD OVERALL
N	.00005" GOLD	.0001" TIN/LEAD
O	.00003" GOLD	.0001" TIN/LEAD
P	GOLD FLASH	GOLD FLASH
R	.00002" GOLD	.0001" TIN/LEAD
S	.00001" GOLD	.00001" GOLD OVERALL
T	.0001" TIN/LEAD	.0001" TIN/LEAD OVERALL
V	.00003" GOLD	.000005" GOLD
W	GOLD FLASH	.0001" TIN/LEAD
X	.00003" GOLD	.0001" TIN/LEAD
Y	.00003" GOLD	.000005" GOLD
Z	.00001" GOLD	.0001" TIN/LEAD

PART NUMBER	CONTACT PIN	HEAD LENGTH	TAIL LENGTH
GTC_SABN-M30	ETC-SAB	0.230 [5.84]	0.320 [8.13]
GZC_SABN-M30	EZC-SAB	0.230 [5.84]	0.320 [8.13]
GTC_SFBN-M30	ETC-SFB	0.318 [8.08]	0.300 [7.62]
GZC_SFBN-M30	EZC-SFB	0.318 [8.08]	0.300 [7.62]

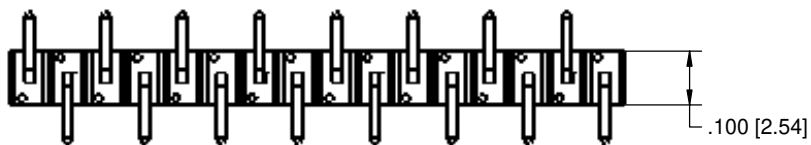
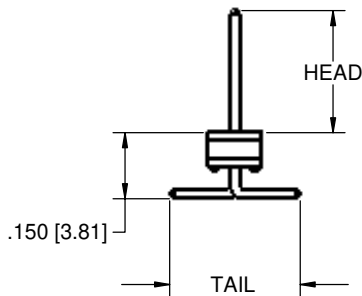
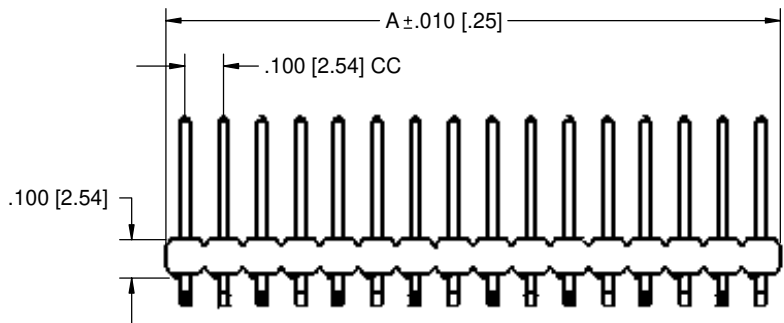

PART NUMBER	BODY NUMBER	A
G_C01S_N-M30	H01S-A360	0.100 [2.54]
G_C02S_N-M30	H02S-A360	0.200 [5.08]
G_C03S_N-M30	H03S-A360	0.300 [7.62]
G_C04S_N-M30	H04S-A360	0.400 [10.16]
G_C05S_N-M30	H05S-A360	0.500 [12.70]
G_C06S_N-M30	H06S-A360	0.600 [15.24]
G_C07S_N-M30	H07S-A360	0.700 [17.78]
G_C08S_N-M30	H08S-A360	0.800 [20.32]
G_C09S_N-M30	H09S-A360	0.900 [22.86]
G_C10S_N-M30	H10S-A360	1.000 [25.40]
G_C11S_N-M30	H11S-A360	1.100 [27.94]
G_C12S_N-M30	H12S-A360	1.200 [30.48]
G_C13S_N-M30	H13S-A360	1.300 [33.02]
G_C14S_N-M30	H14S-A360	1.400 [35.56]
G_C15S_N-M30	H15S-A360	1.500 [38.10]
G_C16S_N-M30	H16S-A360	1.600 [40.64]
G_C17S_N-M30	H17S-A360	1.700 [43.18]
G_C18S_N-M30	H18S-A360	1.800 [45.72]
G_C19S_N-M30	H19S-A360	1.900 [48.26]
G_C20S_N-M30	H20S-A360	2.000 [50.80]
G_C21S_N-M30	H21S-A360	2.100 [53.34]
G_C22S_N-M30	H22S-A360	2.200 [55.88]
G_C23S_N-M30	H23S-A360	2.300 [58.42]
G_C24S_N-M30	H24S-A360	2.400 [60.96]
G_C25S_N-M30	H25S-A360	2.500 [63.50]
G_C26S_N-M30	H26S-A360	2.600 [66.04]
G_C27S_N-M30	H27S-A360	2.700 [68.58]
G_C28S_N-M30	H28S-A360	2.800 [71.12]
G_C29S_N-M30	H29S-A360	2.900 [73.66]
G_C30S_N-M30	H30S-A360	3.000 [76.20]
G_C31S_N-M30	H31S-A360	3.100 [78.74]
G_C32S_N-M30	H32S-A360	3.200 [81.28]
G_C33S_N-M30	H33S-A360	3.300 [83.82]
G_C34S_N-M30	H34S-A360	3.400 [86.36]
G_C35S_N-M30	H35S-A360	3.500 [88.90]
G_C36S_N-M30	H36S-A360	3.600 [91.44]

COMPUTER  
GENERATED  
DOCUMENT DO  
NOT CHANGE  
MANUALLY

**PROPRIETARY AND CONFIDENTIAL**  
THIS DRAWING AND DESIGN IS THE  
PROPERTY OF SULLINS ELECTRONICS.  
IT MAY NOT BE USED FOR ANY  
PURPOSE OTHER THAN BY THE OWNER.  
SULLINS ELECTRONICS DOES NOT  
AUTHORIZE THE REPRODUCTION OR  
CONVEYANCE OF ANY INFORMATION  
CONTAINED HEREIN.

A	62	ORIGINAL RELEASE			9/19/03	JFW	AJT	
REV.	ECO NO.	DESCRIPTION			DATE	BY	APP'VD	
		<small>UNLESS OTHERWISE SPECIFIED: DIMENSIONS ARE IN INCHES TOLERANCES FRACTIONAL ± 1/32 ANGULAR ± 1° TWO PLACE DECIMAL ± .02 THREE PLACE DECIMAL ± .005 FOUR PLACE DECIMAL ± .0005 INTERPRET GEOMETRIC TOLERANCING PER</small>			DATE	NAME	<p style="text-align: center;"><b>SULLINS ELECTRONICS</b></p> <p style="text-align: center;">HEADERS G_C_S_N-M30</p>	
					DRAWN	9/19/03		JWHITE
					CHECKED	9/19/03		AJT
					COMMENTS			
		MATERIAL	NOTED				<small>PART NO. / DESCRIPTION:</small> SIZE DWG. NO. REV <b>C</b> 10058 A	
		FINISH	N/A				<small>SCALE: 1:1</small> SHEET 1 OF 1	
		APPLICATION	DO NOT SCALE DRAWING					