

THIS DRAWING IS A CONTROLLED DOCUMENT FOR THE CONTROL OF CHANGE AND THE CONTROL OF MATERIALS. ANY CHANGES TO THIS DRAWING MUST BE CONTACTED FOR THE LABEL REVISION.

THIS INFORMATION IS CONFIDENTIAL AND IS DISCLOSED TO YOU ON THE CONDITION THAT YOU WILL NOT DISCLOSE IT TO ANY OTHER PERSON OR ENTITY WITHOUT THE WRITTEN AUTHORIZATION FROM AMP INCORPORATED, HARRISBURG, PA.

DIST 66

\* Trademark of AMP Incorporated

AMP 3076-2 REV 8-74

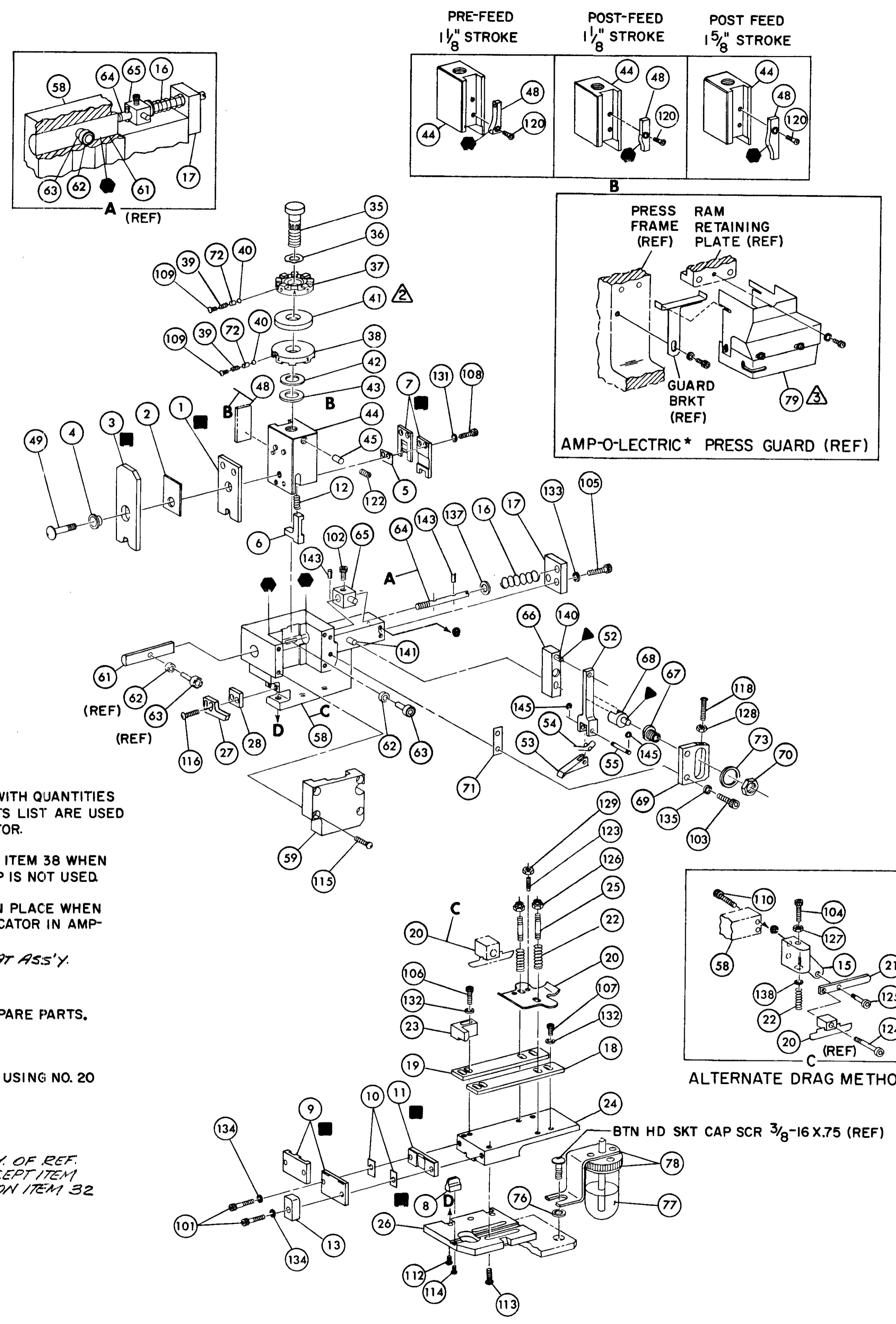

- NOTES:**
- 1 ONLY THE ITEMS WITH QUANTITIES SPECIFIED ON PARTS LIST ARE USED ON THIS APPLICATOR.
  - 2 USED IN PLACE OF ITEM 38 WHEN INSULATION CRIMP IS NOT USED.
  - 3 GUARD MUST BE IN PLACE WHEN OPERATING APPLICATOR IN AMP-O-LECTRIC PRESS.
  - 4 CUT TO LENGTH AT ASS'Y.
- KEY:**
- 5 RECOMMENDED SPARE PARTS.
  - 6 LUBRICATE DAILY USING NO. 20 MACHINE OIL.
  - 7 GREASE LIGHTLY.
5. ITEMS WITH QTY. OF REF. SPECIFIED EXCEPT ITEM 79 ARE USED ON ITEM 32

REF.	QTY	PART NO	DESCRIPTION	ITEM NO
21045-3	145	REF. 454220-1	RING, RETAINING 'C' (.187 DIA) FEED PIN	59
5-21028-1	143	REF. 453736-1	PIN, SLOT SPG (.12 DIA X .50) FD ADJ ROD	58
1-21030-7	141	REF. 240624-1	PIN, DOWEL (.187 DIA X 1.50) HOUSING	57
1-21030-1	140	REF. 691499-1	PIN, DOWEL (.187 DIA X .50) LEVER	56
22260-5	139	REF. 240624-1	WASHER, FLAT (NO 6) DRAG SPRING	55
21899-4	138	REF. 240635-1	WASHER, FLAT (5/16 DIA) SCR ADJ	54
21024-5	136	REF. 240634-1	WASHER, LOCK (NO 10) FEED ADJ PLATE	53
21024-5	135	REF. 7-21002-9	WASHER, LOCK (NO 10) SHEAR PLATES	52
21024-5	134	REF. 690501-4	WASHER, LOCK (NO 10) FEED ROD GUIDE	51
21024-4	133		WASHER, LOCK (NO 8) STRIP GUIDE	50
21024-4	132		WASHER, LOCK (NO 8) SHEAR BLADE	49
21018-4	131	1 690191-1	NUT, HEX MACH (4-40) DRAG	48
21068-5	130	1 455674-2	NUT, HEX MACH (6-32) FD ADJ PLATE	47
21018-7	129	1 690125-1	NUT, HEX MACH (10-32) DRAG SPRING	46
21022-2	128	1 690124-1	NUT, HEX SELF-LKG (8-32) DRAG STUD	45
5-21004-7	127	2 23241-6	SCR, SKT HD SHLD (250 DIA X .25) DRAG ARM	44
21004-5	126	2 690170-1	SCR, SKT HD SHLD (250 DIA X 1.00) DRAG	43
4-21078-8	125	1 690142-1	SCR, SKT SET OVAL POINT (4-40 X .75) DRAG	42
21009-2	124	1 690672-7	SCR, SKT SET (1/4-20 X 25) (LOC-WEL) RAM	41
1-21002-7	123	1 22480-5	SCR, BTN HD SKT CAP (6-32 X .38) CAM	40
3-21064-2	122	1 690212-1	SCR, RD HD MACH (6-32 X 1.50) FEED ADJ	39
2-21002-2	121	1 458980-1	SCR, BTN HD SKT CAP (8-32 X .50) STRIPPER	38
2-21002-9	120	1 455676-1	SCR, BTN HD SKT CAP (10-32 X .75) HSG CAP	37
22733-8	119	1 240639-1	SCR, BTN HD SKT CAP (8-32 X .38) (LOC-WEL) ANVIL	36
3-21002-3	118	REF. 455676-1	SCR, BTN HD SKT CAP (1/4-20 X .50) STR GDE PL	35
2-22733-9	117	2 22354-8	SCR, BTN HD SKT CAP (1/4-20 X .75) BASE PL	34
2-21000-4	116	2 22354-8	SCR, SKT HD CAP (6-32 X 1.00) DRAG ADAPTOR	33
23030-1	115	1 455678-1	SCR, SKT HD CAP (6-32 X .25) (LOC-WEL) CP DISC	32
2-21000-6	114	2 4-22281-1	SCR, SKT HD CAP (8-32 X .29) SHEAR BLADE	31
2-21000-5	113	1 240636-1	SCR, SKT HD CAP (8-32 X .25) STRIP GUIDE	30
2-21000-5	112	1 454177-1	SCR, SKT HD CAP (8-32 X .25) STRIP GUIDE	29
3-21000-7	111	1 458030-2	SCR, SKT HD CAP (10-32 X .75) FD ROD GUIDE	28
3-21000-9	110	1 458031-2	SCR, SKT HD CAP (10-32 X 1.00) DRAG SPRING	27
3-21000-6	109	REF. 454178-1	SCR, SKT HD CAP (10-32 X .62) FD ADJ PLATE	26
3-21000-4	108	REF. 454178-1	SCR, SKT HD CAP (10-32 X .38) PIVOT BLK	25
3-21000-8	107	REF. 4-22284-9	SCR, SKT HD CAP (10-32 X .88) SHEAR PLATE	24
455745-1	106	79	GUARD, WINDOW	23
465184-9	105	78	LUBRICATOR ASSY	22
455985-1	104	77	OIL, LUBRICATING	21
454406-1	103	76	SPACER, LUB BRACKET	20
458109-1	102	75	WASHER, FLAT (SPECIAL)	19
690603-1	101	74	SPRING, ASSIST	18
690517-1	100	73	SPACER	17
22594-8	99	72	NUT, HEX	16
240628-1	98	71	PLATE, ADJ	15
240626-1	97	70	SHAFT, PIVOT	14
240633-1	96	69	BUSHING	13
455680-1	95	68	LEVER, INTERMEDIATE	12
240629-1	94	67	BLOCK, PIVOT	11
240632-2	93	66	SCREW, ADJ	10
240659-3	92	65	PIN, CAM ROLLER	9
240658-1	91	64	CAM, ROLLER	8
454398-1	90	63	ROD, FEED	7
458109-1	89	62	WASHER, FLAT (SPECIAL)	6
690603-1	88	61	SPRING, ASSIST	5
690517-1	87	60	SPACER	4
22594-8	86	59	NUT, HEX	3
240628-1	85	58	PLATE, ADJ	2
240626-1	84	57	SHAFT, PIVOT	1
240633-1	83	56	BUSHING	
455680-1	82	55	LEVER, INTERMEDIATE	
240629-1	81	54	BLOCK, PIVOT	
240632-2	80	53	SCREW, ADJ	
240659-3	79	52	PIN, CAM ROLLER	
240658-1	78	51	CAM, ROLLER	
454398-1	77	50	ROD, FEED	

QTY	PART NO	DESCRIPTION	ITEM NO
1	240644-1	PLATE, REAR SHEAR	11
1	690482-6	SPACER, SHEAR PLATE	10
1	8-238005-2	PLATE, FRONT SHEAR	9
1	690474-6	ANVIL	8
1	1-240641-9	BLADE, SLUG	7
1	238009-1	HOLD DOWN, TERMINAL	6
1	4-456135-9	SPACER, SHEAR BLADE	5
1	455888-6	SPACER, TUBULAR	4
1	4-456406-3	CRIMPER, INSULATION	3
1		SPACER, INSULATION	2
1		CRIMPER, WIRE	1

CRIMPING DATA				APPLICATOR WILL APPLY	
PAD LTR	CRIMP HEIGHT	WIRE SIZE	WIRE LENGTH		
A	.053	20			62638
B	.050	22			62639
C	NOT USED				
D	NOT USED				

CRIMP	SIZE	TYPE	FEED	APPL INST
WIRE	.090	F	.504	A1 8039
INSUL	.180	O		

WIRE RANGE 22-20 INSULATION RANGE .070-.120 PRESS NO

REMARKS POST-FEED AMPONATOR

(REF.) I.D. PLATE 461264-1

APPL USED ON MACHINE PART NO	MACH SERIAL NO	DISTRIBUTION
CUSTOMER NAME	APPL SERIAL NO	ORIGINAL
ADDRESS	PURCHASE ORDER	CUSTOMER COPY
CITY	ENG APP	FIELD ENG COPY