

Pb THIS PRODUCT MANUFACTURED WITH LEAD-FREE PROCESSING

DESIGNED & DIMENSIONED IN MILLIMETERS [INCHES]

DO NOT SCALE FROM THIS PRINT

RFX6T-XXXXX-XXXXXX-XXXX

CABLE CALLOUT
A6T: RG-6 CABLE (CCA-6)
B6T: BELDEN 1694A CABLE (CCA-1694A)

OVERALL ASSEMBLY LENGTH (OAL) XXXX (MILLIMETERS) (0300 MIN) (SEE NOTE 8)

END 1 CONNECTOR (SEE TABLE 3, SHT 2)

END 2 CONNECTOR OR PREPARATION (SEE TABLE 3, SHT 2)

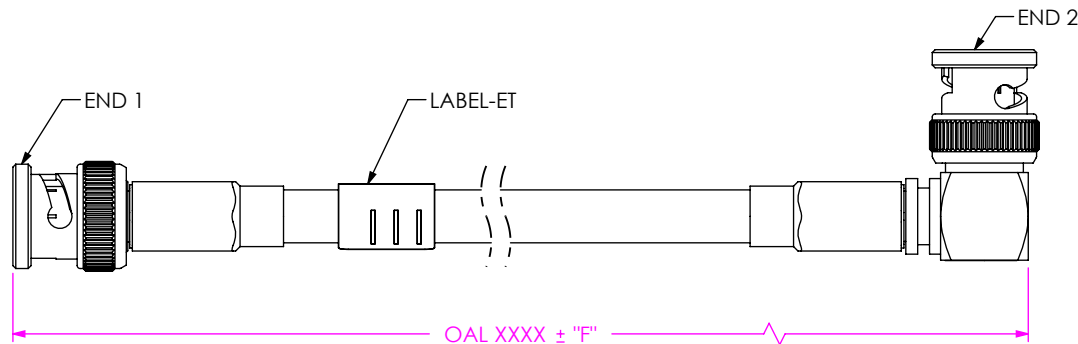

FIG 1
RFX6T-74SPX-74RPX-XXXX SHOWN

TABLE 2	
LENGTH	"F"
0300-0500 [11.81-19.69]	+5.0 [.20]/-0.0 [.00]
0501-1100 [19.72-43.31]	+10.0 [.40]/-0.0 [.00]
>1100 [43.31]	± 1%

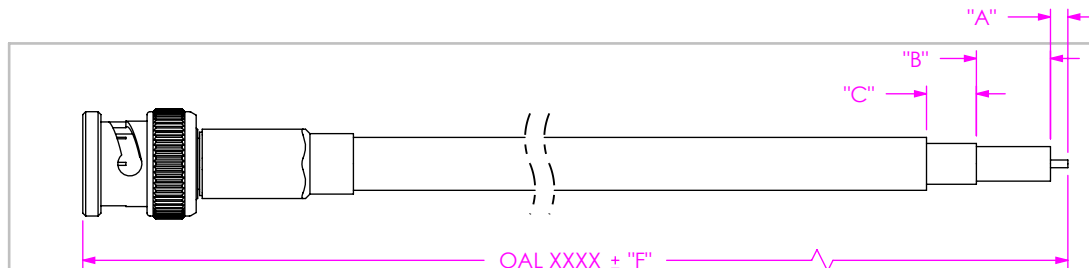

FIG 2
RFX6T-74SPX-172849-XXXX SHOWN (SEE NOTES 5 & 7)

"C" FORMAT: X.X mm
"B" FORMAT: X.X mm
"A" FORMAT: X.X mm

DO NOT LEAVE ANY SPACE BLANK, EACH MUST CONTAIN A NUMERIC CHARACTER 0 THRU 9.

NOTES:

1. REPRESENTS A CRITICAL DIMENSION
2. ASSEMBLY TO BE 100% TESTED FOR OPENS, SHORTS & HI-POT TESTED (PER TABLE 1, AC OR DC), THE HI-POT VOLTAGE FOR THE ASSEMBLY SHOULD BE SET TO THE END OPTION WITH THE LOWEST TEST VOLTAGE RATING.
3. AFTER FINAL ELECTRICAL TEST, LABEL EACH CABLE ASSEMBLY WITH 1 LABEL-ET.
4. FINISHED ASSEMBLIES TO BE PACKAGED PER PACKAGING STANDARD CO-RF-WI-3040-M. ASSEMBLIES WITH LOCKWASHERS, NUTS, AND GASKETS TO BE SHIPPED KITTED AS ONE ASSEMBLY PER BAG, UNASSEMBLED.
5. DIM "A", "B", AND "C" HAVE A MINIMUM VALUE OF 0.0mm & A MAXIMUM VALUE OF 9.9mm.
6. CONNECTORS TO BE ORIENTED ACCORDING TO CO-RF-WI-3048-M.
7. FOR STRIPPED AND TINNED OPTION, ONLY THE CENTER CONDUCTOR IS TINNED.
8. CABLE LENGTHS LONGER THAN 1000 MILLIMETERS ARE NOT SUPPORTED BY S.I. TEST DATA.

F:\DWG\MISC\MKTG\RFX6T-XXXXX-XXXXXX-MKT.SLDDRW

UNLESS OTHERWISE SPECIFIED, DIMENSIONS ARE IN MILLIMETERS [INCHES]. TOLERANCES ARE: DECIMALS ANGLES .X: ±0.3 [.01] 2° .XX: ±0.13 [.005] .XXX: ±0.051 [.0020]	PROPRIETARY NOTE THIS DOCUMENT CONTAINS CONFIDENTIAL AND PROPRIETARY INFORMATION AND ALL DESIGN, MANUFACTURING, REPRODUCTION, USE, PATENT RIGHTS AND SALES RIGHTS ARE EXPRESSLY RESERVED BY SAMTEC, INC. THIS DOCUMENT SHALL NOT BE DISCLOSED, IN WHOLE OR PART, TO ANY UNAUTHORIZED PERSON OR ENTITY NOR REPRODUCED, TRANSFERRED OR INCORPORATED IN ANY OTHER PROJECT IN ANY MANNER WITHOUT THE EXPRESS WRITTEN CONSENT OF SAMTEC, INC.
MATERIAL: DO NOT SCALE DRAWING SHEET SCALE: 2:1	
DIELECTRIC: PTFE GASKET: SILICONE SPRING: STAINLESS STEEL ALL OTHER: BRASS	



520 PARK EAST BLVD. NEW ALBANY, IN 47150
PHONE: 812-944-6733 FAX: 812-948-5047
e-Mail info@SAMTEC.com code 55322

DESCRIPTION: TRUE 75 OHM, RF6T CABLE ASSEMBLY
DWG. NO. RFX6T-XXXXX-XXXXXX-XXXX
BY: R MUSSER 03/27/2009 SHEET 1 OF 8

TABLE 3							
END OPTION	SERIES	GENDER	CONFIGURATION	PLATING			FIGURE
				CENTER CONTACT	OUTER CONTACT	OTHER COMPONENTS	
-74RP3	75 OHM BNC	PLUG	RIGHT ANGLE	10µ" GOLD	100µ" NICKEL	100µ" NICKEL	SHT 3, FIG 3
-74SP3	75 OHM BNC	PLUG	STRAIGHT	10µ" GOLD	100µ" NICKEL	100µ" NICKEL	SHT 3, FIG 4
-H4SP2	75 OHM HIGH DENSITY BNC	PLUG	STRAIGHT	30µ" GOLD	100µ" NICKEL	100µ" NICKEL	SHT 4, FIG 5
-H4SP3	75 OHM HIGH DENSITY BNC	PLUG	STRAIGHT	10µ" GOLD	100µ" NICKEL	100µ" NICKEL	
-H4SP4	75 OHM HIGH DENSITY BNC	PLUG	STRAIGHT	10µ" GOLD	3µ" GOLD	100µ" NICKEL	
-H4SP8	75 OHM HIGH DENSITY BNC	PLUG	STRAIGHT	30µ" GOLD	3µ" GOLD	100µ" NICKEL	
-D4SP3	75 OHM BNC (DIE CAST)	PLUG	STRAIGHT	10µ" GOLD	100µ" NICKEL	100µ" NICKEL	SHT 4, FIG 6
-78SP4	75 OHM DIN 1.0/2.3	PLUG	STRAIGHT	10µ" GOLD	3µ" GOLD	100µ" NICKEL	SHT 5, FIG 7
-78SP5	75 OHM DIN 1.0/2.3	PLUG	STRAIGHT	10µ" GOLD	10µ" GOLD	100µ" NICKEL	
-78SP6	75 OHM DIN 1.0/2.3	PLUG	STRAIGHT	30µ" GOLD	30µ" GOLD	100µ" NICKEL	
**-.79SP2	75 OHM MINI BNC	PLUG	STRAIGHT	30µ" GOLD	100µ" NICKEL	100µ" NICKEL	
**-.79SP3	75 OHM MINI BNC	PLUG	STRAIGHT	10µ" GOLD	100µ" NICKEL	100µ" NICKEL	SHT 5, FIG 8
**-.79RP2	75 OHM MINI BNC	PLUG	RIGHT ANGLE	30µ" GOLD	100µ" NICKEL	100µ" NICKEL	SHT 6, FIG 9
**-.79RP3	75 OHM MINI BNC	PLUG	RIGHT ANGLE	10µ" GOLD	100µ" NICKEL	100µ" NICKEL	
*-SING	SINGLE ENDED	-	-	-	-	-	-
*-XXXXXX	STRIPPED & TINNED	-	-	-	-	-	SHT 1, FIG 2

* = END 2 OPTION ONLY

** = FOR EXISTING CUSTOMERS ONLY

TABLE 1						
END OPTION	SUBTRACTOR	STRIP DIMENSIONS			HI POT	
		"Y"	"A"	"D"	"E"	"DC"
-74RP3	4.7 [0.19]	2.3 [0.09]	12.1 [0.48]	18.7 [0.74]	1000	300
-74SP3	10.3 [0.41]	3.2 [0.13]	5.4 [0.21]	11.9 [0.47]	1000	300
-H4SP2	13.4 [0.53]	2.7 [0.11]	4.2 [0.17]	11.0 [0.43]	1000	300
-H4SP3						
-H4SP4						
-H4SP8						
-D4SP3	10.3 [0.41]	3.2 [0.13]	5.4 [0.21]	11.9 [0.47]	1000	300
-78SP4	15.7 [0.62]	2.9 [0.11]	5.0 [0.20]	12.3 [0.48]	1000	300
-78SP5						
-78SP6						
**-.79SP2	8.7 [0.34]	2.0 [0.08]	2.6 [0.10]	8.6 [0.34]	1000	300
**-.79SP3						
**-.79RP2	3.0 [0.12]	1.7 [0.07]	7.1 [0.28]	13.7 [0.54]	1000	300
**-.79RP3						
*-SING	0.0 [0.00]	-	-	-	1000	N/A
*-XXXXXX	0.0 [0.00]	"A"	"A" + "B"	"A" + "B" + "C"	1000	N/A

* = END 2 OPTION ONLY

** = FOR EXISTING CUSTOMERS ONLY

F:\DWG\MISC\MKTG\RFx6T-XXXXX-XXXXXX-XXXX-MKT.SLDDRW

PROPRIETARY NOTE
 THIS DOCUMENT CONTAINS CONFIDENTIAL AND PROPRIETARY INFORMATION AND ALL DESIGN, MANUFACTURING, REPRODUCTION, USE, PATENT RIGHTS AND SALES RIGHTS ARE EXPRESSLY RESERVED BY SAMTEC, INC. THIS DOCUMENT SHALL NOT BE DISCLOSED, IN WHOLE OR PART, TO ANY UNAUTHORIZED PERSON OR ENTITY NOR REPRODUCED, TRANSFERRED OR INCORPORATED IN ANY OTHER PROJECT IN ANY MANNER WITHOUT THE EXPRESS WRITTEN CONSENT OF SAMTEC, INC.



520 PARK EAST BLVD, NEW ALBANY, IN 47150
 PHONE: 812-944-6733 FAX: 812-948-5047
 e-Mail: info@SAMTEC.com code 55322

DO NOT SCALE DRAWING

SHEET SCALE: 1:1

DESCRIPTION:
 TRUE 75 OHM, RF6T CABLE ASSEMBLY

DWG. NO.
RFx6T-XXXXX-XXXXXX-XXXX

BY: R MUSSER 03/27/2009 SHEET 2 OF 8

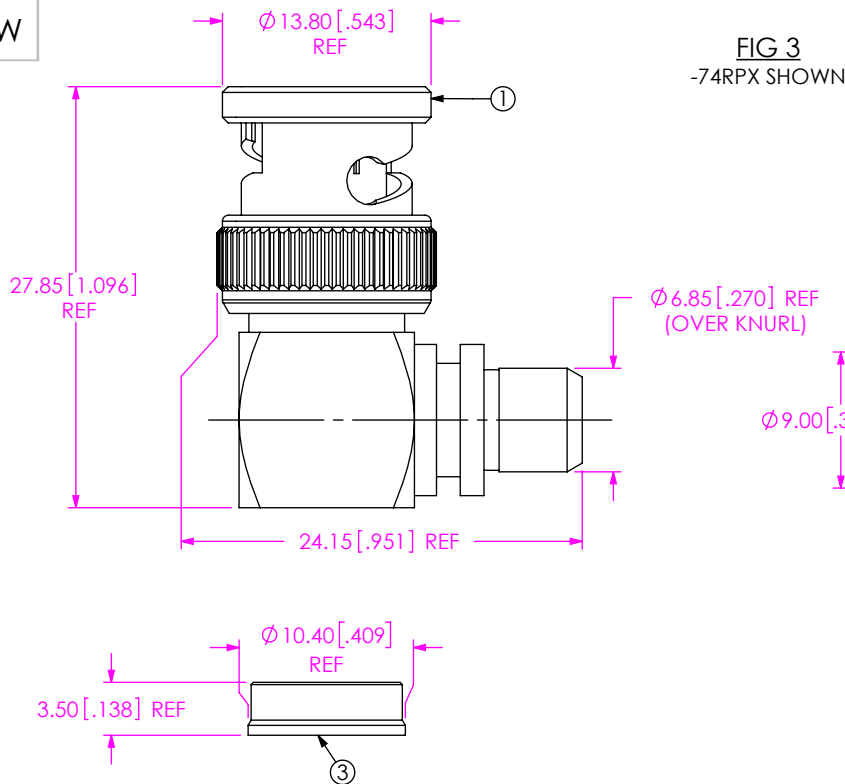

FIG 3
-74RPX SHOWN

BOM		
ITEM	COMPONENT	-74RP3
1	SUB ASSEMBLY	SUB-BNC7T-P-C-GN-RA-CA6
2	FERRULE	BNC-FER-001-N
3	CAP	BNC7T-P-C-N-RA-CA6-CAP
4	HEAT SHRINK	HST-0.500-02-BLK

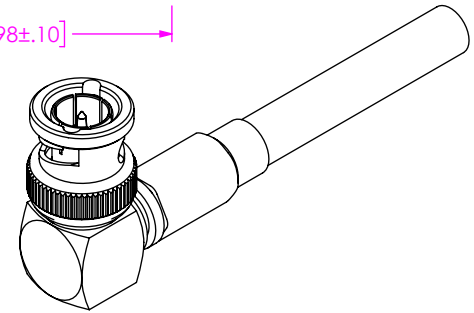
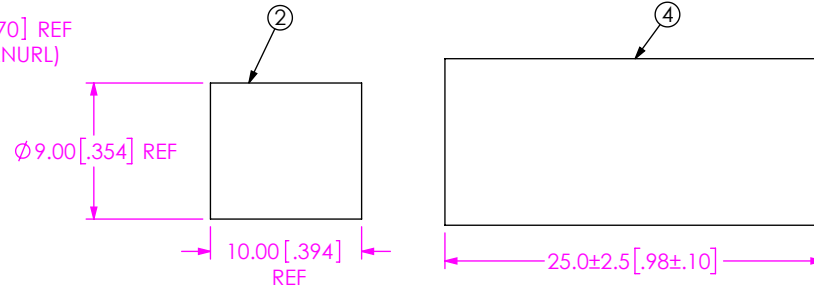
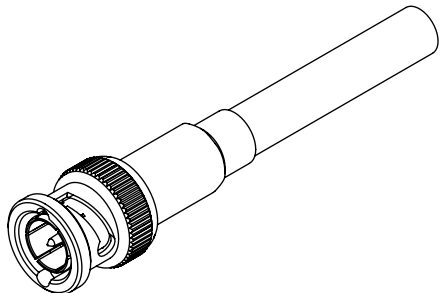
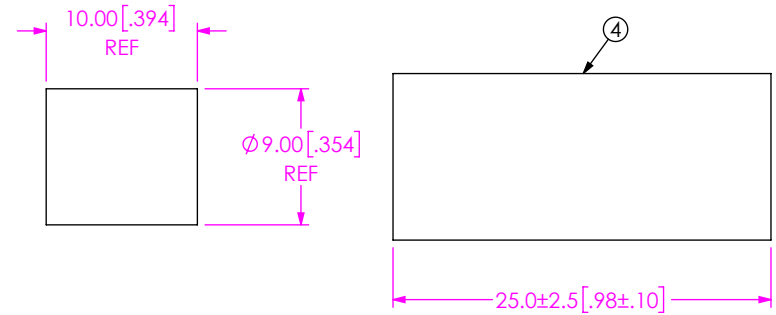
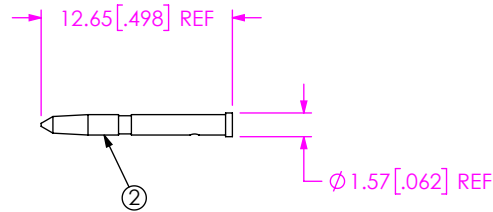
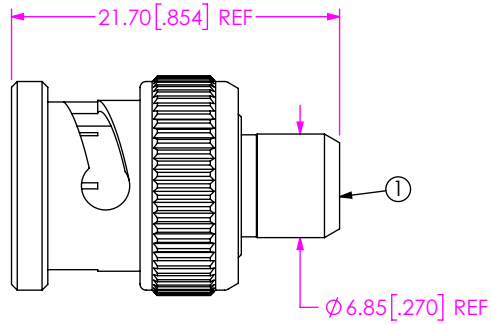

FIG 4
-74SPX SHOWN



BOM		
ITEM	COMPONENT	-74SP3
1	SUB-ASSEMBLY	SUB-BNC7T-P-C-N-ST-CA6
2	PIN	BNC7T-P-C-G-ST-CA6-PIN
3	FERRULE	BNC-FER-001-N
4	HEAT SHRINK	HST-0.500-02-BLK

F:\DWG\MISC\MKTG\RF6T-XXXX-XXXX-XXXX-MKT.SLDDRW

PROPRIETARY NOTE
THIS DOCUMENT CONTAINS CONFIDENTIAL AND PROPRIETARY INFORMATION AND ALL DESIGN, MANUFACTURING, REPRODUCTION, USE, PATENT RIGHTS AND SALES RIGHTS ARE EXPRESSLY RESERVED BY SAMTEC, INC. THIS DOCUMENT SHALL NOT BE DISCLOSED, IN WHOLE OR PART, TO ANY UNAUTHORIZED PERSON OR ENTITY NOR REPRODUCED, TRANSFERRED OR INCORPORATED IN ANY OTHER PROJECT IN ANY MANNER WITHOUT THE EXPRESS WRITTEN CONSENT OF SAMTEC, INC.

DO NOT SCALE DRAWING

SHEET SCALE: 2:1



520 PARK EAST BLVD, NEW ALBANY, IN 47150
PHONE: 812-944-6733 FAX: 812-948-5047
e-Mail info@SAMTEC.com code 55322

DESCRIPTION:
TRUE 75 OHM, RF6T CABLE ASSEMBLY

DWG. NO.
RFX6T-XXXXX-XXXXXX-XXXX

BY: R MUSSER 03/27/2009 SHEET 3 OF 8

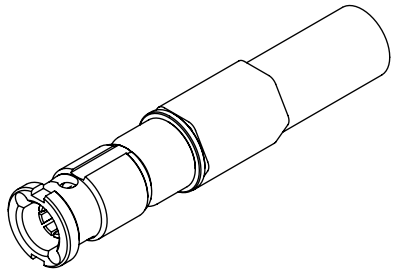
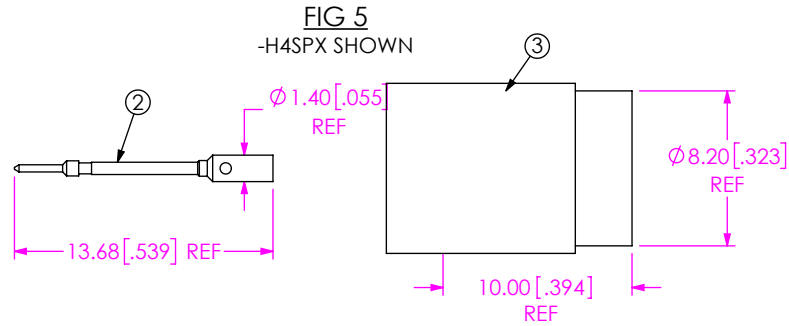
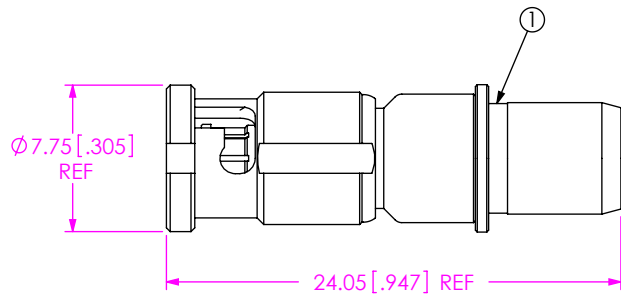

BOM					
ITEM	COMPONENT	-H4SP2	-H4SP3	-H4SP4	-H4SP8
1	SUB ASSEMBLY	SUB-HDBNC-P-C-NN-ST-CA6	SUB-HDBNC-P-C-NN-ST-CA6	SUB-HDBNC-P-C-FN-ST-CA6	SUB-HDBNC-P-C-FN-ST-CA6
2	PIN	HDBNC-P-C-H-ST-CA6-PIN	HDBNC-P-C-G-ST-CA6-PIN	HDBNC-P-C-G-ST-CA6-PIN	HDBNC-P-C-H-ST-CA6-PIN
3	FERRULE	HDBNC-FER-001-N			

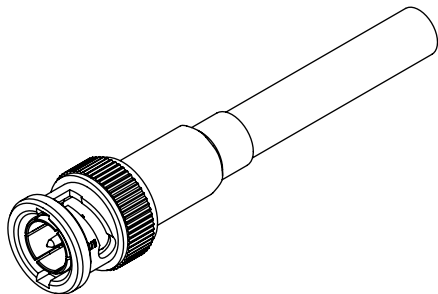
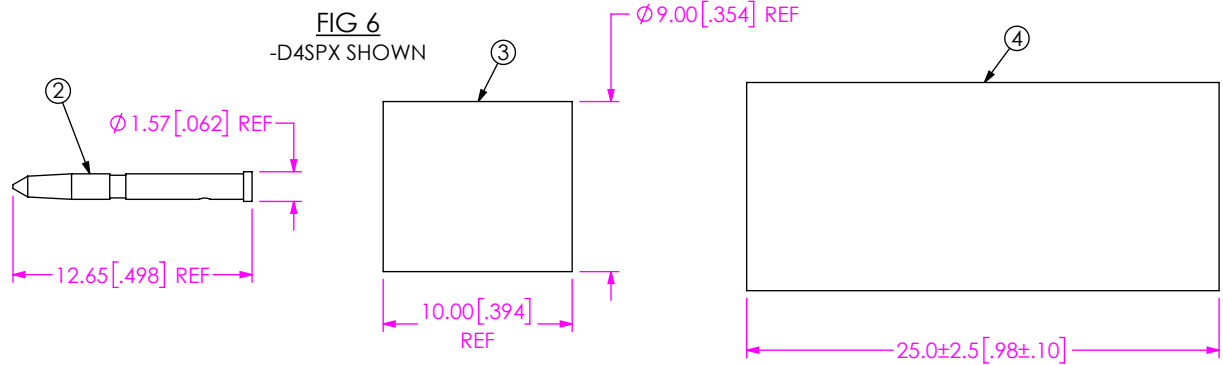
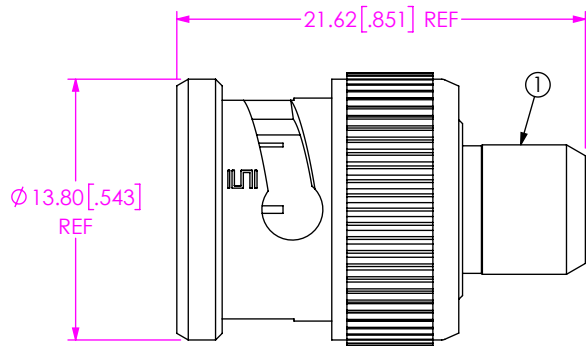

BOM		
ITEM	COMPONENT	-D4SP3
1	SUB-ASSEMBLY	SUB-BNC7T-P-C-N-ST-CA6D
2	PIN	BNC7T-P-C-G-ST-CA6-PIN
3	FERRULE	BNC-FER-001-N
4	HEAT SHRINK	HST-0.500-02-BLK

PROPRIETARY NOTE
 THIS DOCUMENT CONTAINS CONFIDENTIAL AND PROPRIETARY INFORMATION AND ALL DESIGN, MANUFACTURING, REPRODUCTION, USE, PATENT RIGHTS AND SALES RIGHTS ARE EXPRESSLY RESERVED BY SAMTEC, INC. THIS DOCUMENT SHALL NOT BE DISCLOSED, IN WHOLE OR PART, TO ANY UNAUTHORIZED PERSON OR ENTITY NOR REPRODUCED, TRANSFERRED OR INCORPORATED IN ANY OTHER PROJECT IN ANY MANNER WITHOUT THE EXPRESS WRITTEN CONSENT OF SAMTEC, INC.

DO NOT SCALE DRAWING

SHEET SCALE: 2.5:1



520 PARK EAST BLVD, NEW ALBANY, IN 47150
 PHONE: 812-944-6733 FAX: 812-948-5047
 e-Mail info@SAMTEC.com code 55322

DESCRIPTION:
 TRUE 75 OHM, RF6T CABLE ASSEMBLY

DWG. NO.
 RFX6T-XXXXX-XXXXXX-XXXX

BY:R MUSSER 03/27/2009 SHEET 4 OF 8

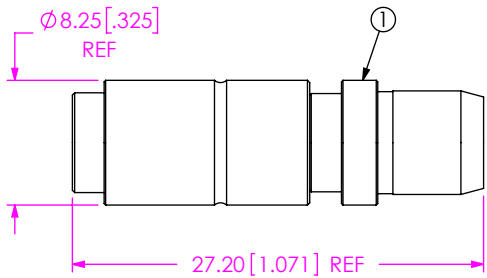
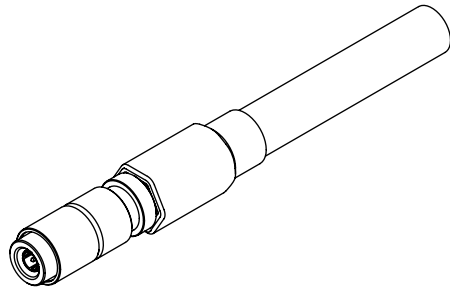
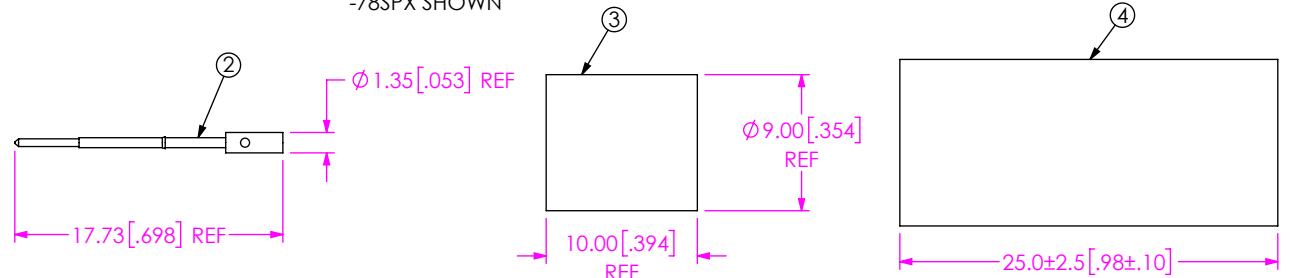

FIG 7
-78SPX SHOWN



BOM				
ITEM	COMPONENT	-78SP4	-78SP5	-78SP6
1	SUB ASSEMBLY	SUB-DIN7A-PP-C-FN-ST-CA6	SUB-DIN7A-PP-C-GN-ST-CA6	SUB-DIN7A-PP-C-HN-ST-CA6
2	PIN	DIN7A-P-C-G-ST-CA6-PIN	DIN7A-P-C-G-ST-CA6-PIN	DIN7A-P-C-H-ST-CA6-PIN
3	FERRULE	BNC-FER-001-N		
4	HEAT SHRINK	HST-0.500-02-BLK		

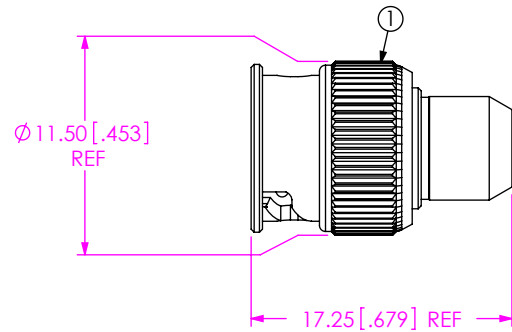
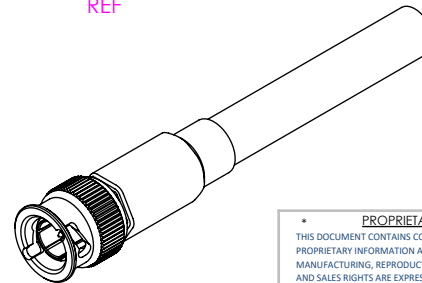
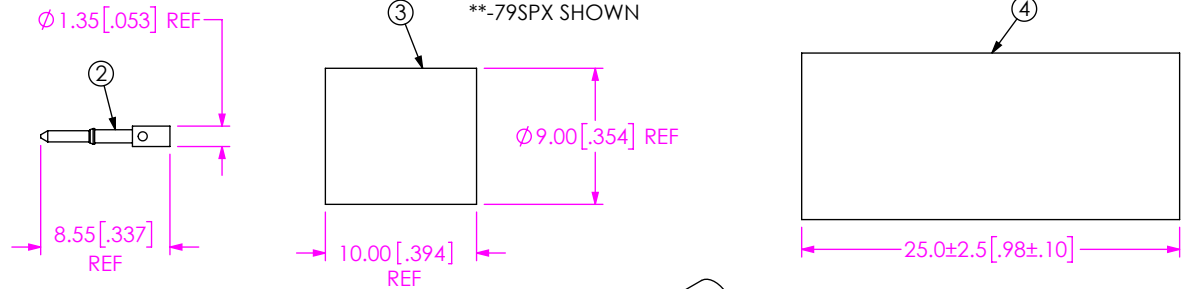

FIG 8
**-79SPX SHOWN



BOM			
ITEM	COMPONENT	** -79SP2	** -79SP3
1	SUB ASSEMBLY	SUB-MBNC7-P-C-N-ST-CA6	
2	PIN	MBNC7-P-C-H-ST-CA6-PIN	MBNC7-P-C-G-ST-CA6-PIN
3	FERRULE	BNC-FER-001-N	
4	HEAT SHRINK	HST-0.500-02-BLK	

** = FOR EXISTING CUSTOMERS ONLY

PROPRIETARY NOTE
 THIS DOCUMENT CONTAINS CONFIDENTIAL AND PROPRIETARY INFORMATION AND ALL DESIGN, MANUFACTURING, REPRODUCTION, USE, PATENT RIGHTS AND SALES RIGHTS ARE EXPRESSLY RESERVED BY SAMTEC, INC. THIS DOCUMENT SHALL NOT BE DISCLOSED, IN WHOLE OR PART, TO ANY UNAUTHORIZED PERSON OR ENTITY NOR REPRODUCED, TRANSFERRED OR INCORPORATED IN ANY OTHER PROJECT IN ANY MANNER WITHOUT THE EXPRESS WRITTEN CONSENT OF SAMTEC, INC.



520 PARK EAST BLVD, NEW ALBANY, IN 47150
 PHONE: 812-944-6733 FAX: 812-948-5047
 e-Mail: info@SAMTEC.com code 55322

DO NOT SCALE DRAWING

SHEET SCALE: 2:1

DESCRIPTION:
TRUE 75 OHM, RF6T CABLE ASSEMBLY

DWG. NO.
RFX6T-XXXXXX-XXXXXX-XXXX

BY: R MUSSER 03/27/2009 SHEET 5 OF 8

FIG 9
**-79RPX SHOWN

BOM			
ITEM	COMPONENT	** -79RP2	** -79RP3
1	SUB ASSEMBLY	SUB-MBNC7-P-C-HN-RA-CA6	SUB-MBNC7-P-C-GN-RA-CA6
2	FERRULE	BNC-FER-001-N	
3	CAP	MBNC7-P-C-N-RA-CAP	
4	HEAT SHRINK	HST-0.500-02-BLK	

** = FOR EXISTING CUSTOMERS ONLY

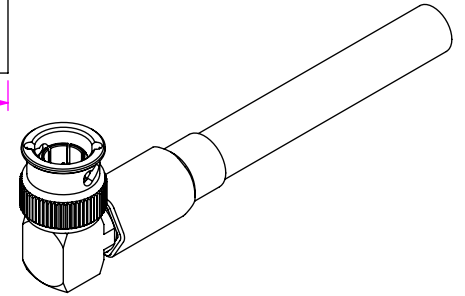
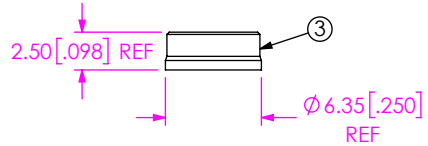
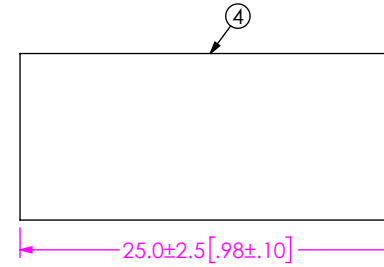
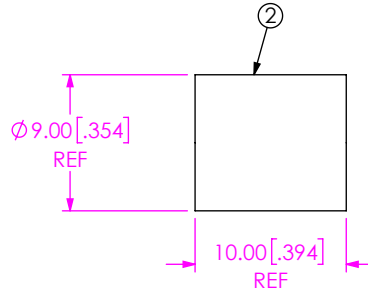
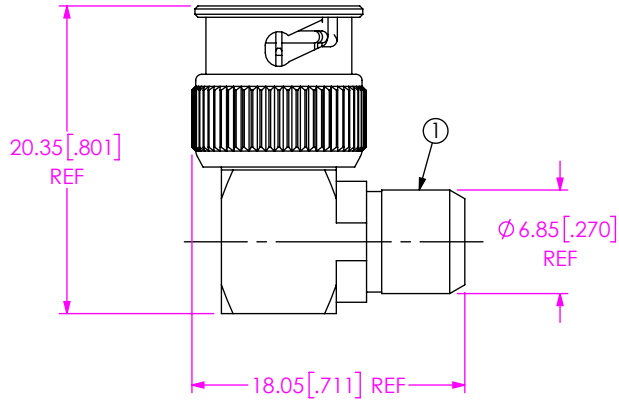

PROPRIETARY NOTE
THIS DOCUMENT CONTAINS CONFIDENTIAL AND PROPRIETARY INFORMATION AND ALL DESIGN, MANUFACTURING, REPRODUCTION, USE, PATENT RIGHTS AND SALES RIGHTS ARE EXPRESSLY RESERVED BY SAMTEC, INC. THIS DOCUMENT SHALL NOT BE DISCLOSED, IN WHOLE OR PART, TO ANY UNAUTHORIZED PERSON OR ENTITY NOR REPRODUCED, TRANSFERRED OR INCORPORATED IN ANY OTHER PROJECT IN ANY MANNER WITHOUT THE EXPRESS WRITTEN CONSENT OF SAMTEC, INC.

samtec
520 PARK EAST BLVD, NEW ALBANY, IN 47150
PHONE: 812-944-6733 FAX: 812-948-5047
e-Mail info@SAMTEC.com code 55322

DO NOT SCALE DRAWING

SHEET SCALE: 2:1

DESCRIPTION:
TRUE 75 OHM, RF6T CABLE ASSEMBLY

DWG. NO.
RFX6T-XXXXXX-XXXXXX-XXXX

BY: R MUSSER 03/27/2009 SHEET 6 OF 8

IN PROCESS 1
CUT CABLE TO LENGTH

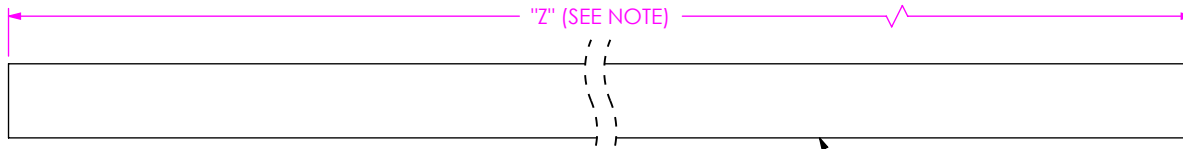

NOTE: "Z" = 2*OAL - 2*"Y"(END 1) (FOR SINGLE OR XXXXX OPTIONS)
"Z" = OAL - "Y"(END 1) - "Y"(END 2) (FOR DOUBLE ENDED OPTIONS)

SEE TABLE

TABLE	
CABLE CALLOUT	PART NUMBER
RFA6T	CCA-6
RFB6T	CCA-1694A

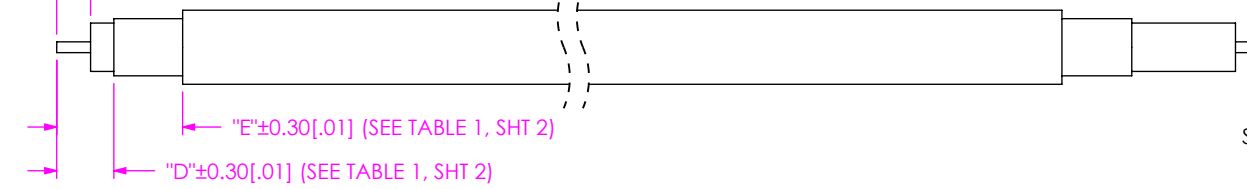

IN PROCESS 2
STRIP AND TIN INNER CONDUCTOR

STRAIGHT
IN PROCESS 3
ADD FERRULE & HEAT SHRINK TUBE (IF APPLICABLE),
SOLDER SIGNAL PIN
USING INDUCTION SOLDERING
OR CRIMP (IF APPLICABLE)

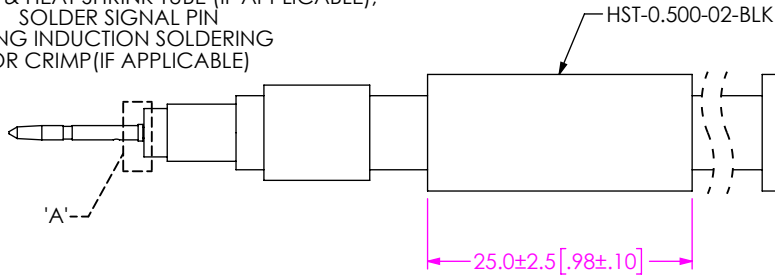

RIGHT ANGLE
IN PROCESS 3
ADD FERRULE & HEAT SHRINK TUBE,
FLARE SHIELD, ADD SUB ASSEMBLY
(CABLE FOIL WRAP TO BE INSERTED
INSIDE CABLE BODY)
(SEE NOTE 6)

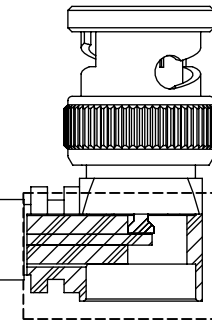

STRAIGHT
IN PROCESS 4
FLARE SHIELD,
ADD SUB ASSEMBLY
(CABLE FOIL WRAP TO BE INSERTED
INSIDE CABLE BODY)
(SEE NOTE 6)

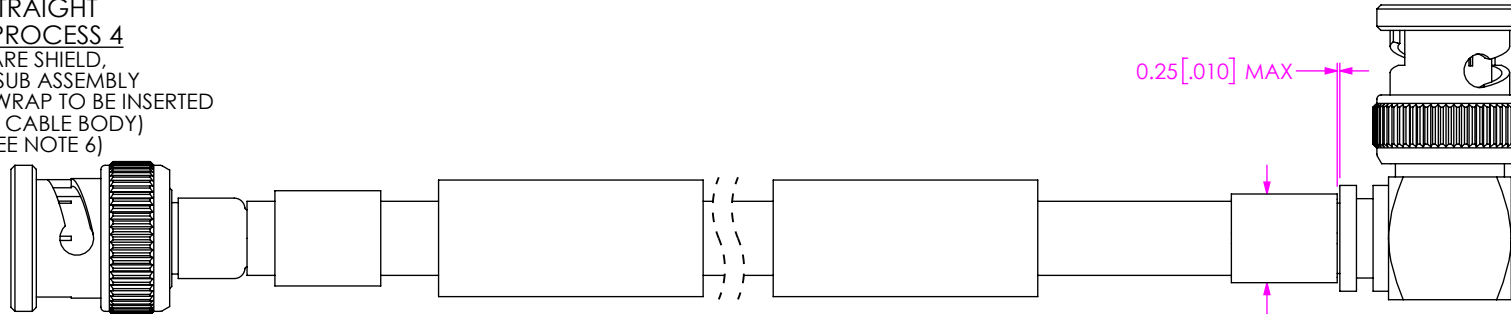

RIGHT ANGLE
IN-PROCESS 4
CRIMP FERRULE &
SOLDER SIGNAL PIN

0.10[.004] MAX

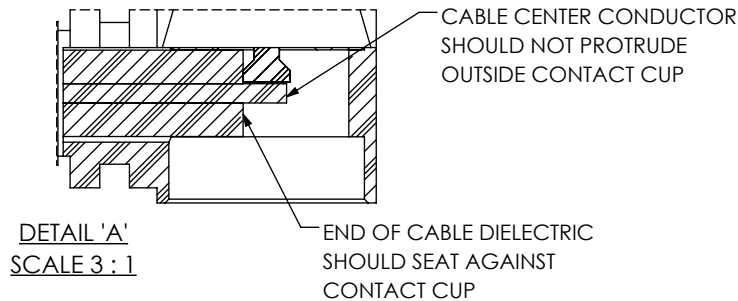
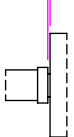

DETAIL 'A'
SCALE 3 : 1

PROPRIETARY NOTE
THIS DOCUMENT CONTAINS CONFIDENTIAL AND PROPRIETARY INFORMATION AND ALL DESIGN, MANUFACTURING, REPRODUCTION, USE, PATENT RIGHTS AND SALES RIGHTS ARE EXPRESSLY RESERVED BY SAMTEC, INC. THIS DOCUMENT SHALL NOT BE DISCLOSED, IN WHOLE OR PART, TO ANY UNAUTHORIZED PERSON OR ENTITY NOR REPRODUCED, TRANSFERRED OR INCORPORATED IN ANY OTHER PROJECT IN ANY MANNER WITHOUT THE EXPRESS WRITTEN CONSENT OF SAMTEC, INC.

DO NOT SCALE DRAWING
DETAIL 'B'
SCALE 2.5 : 1



520 PARK EAST BLVD, NEW ALBANY, IN 47150
PHONE: 812-944-6733 FAX: 812-948-5047
e-Mail info@SAMTEC.com code 55322

DESCRIPTION:
TRUE 75 OHM, RF6T CABLE ASSEMBLY
DWG. NO.
RFX6T-XXXXX-XXXXXX-XXXX
BY: R MUSSER 03/27/2009 SHEET 7 OF 8

STRAIGHT
IN-PROCESS 5
CRIMP FERRULE

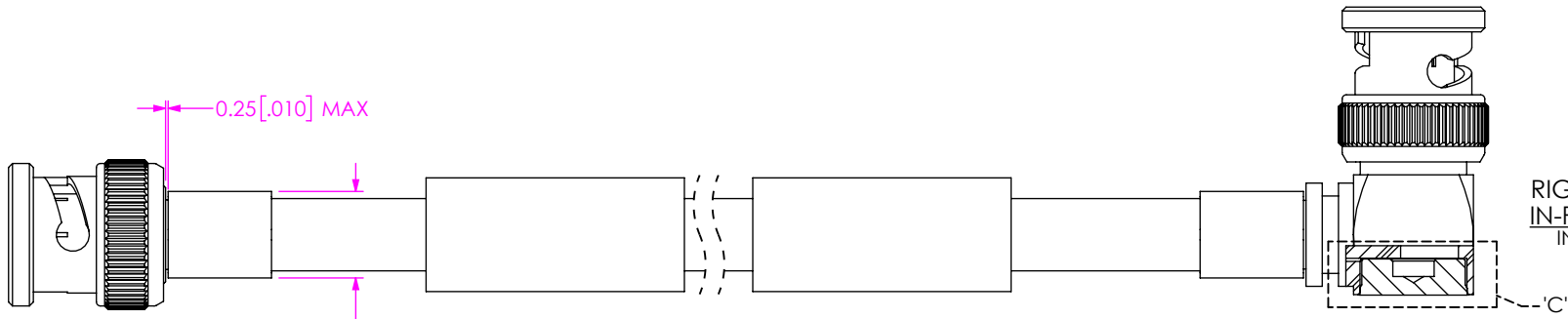

RIGHT ANGLE
IN-PROCESS 5
INSERT CAP

STRAIGHT
IN PROCESS 6
ACTIVATE HEAT SHRINK
(IF APPLICABLE)

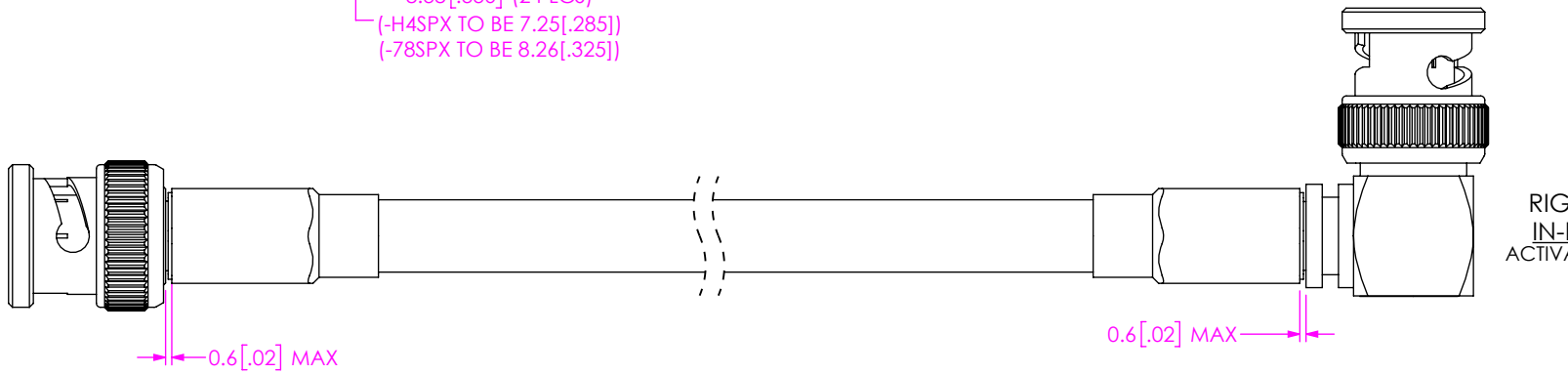

RIGHT ANGLE
IN-PROCESS 6
ACTIVATE HEAT SHRINK

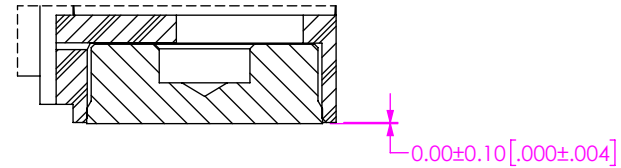

F:\DWG\MISC\MKTG\RF6T-XXXXX-XXXXX-XXXX-MKT.SLDDRW

PROPRIETARY NOTE
THIS DOCUMENT CONTAINS CONFIDENTIAL AND PROPRIETARY INFORMATION AND ALL DESIGN, MANUFACTURING, REPRODUCTION, USE, PATENT RIGHTS AND SALES RIGHTS ARE EXPRESSLY RESERVED BY SAMTEC, INC. THIS DOCUMENT SHALL NOT BE DISCLOSED, IN WHOLE OR PART, TO ANY UNAUTHORIZED PERSON OR ENTITY NOR REPRODUCED, TRANSFERRED OR INCORPORATED IN ANY OTHER PROJECT IN ANY MANNER WITHOUT THE EXPRESS WRITTEN CONSENT OF SAMTEC, INC.

samtec
520 PARK EAST BLVD, NEW ALBANY, IN 47150
PHONE: 812-944-6733 FAX: 812-948-5047
e-Mail info@SAMTEC.com code 55322

DO NOT SCALE DRAWING

SHEET SCALE: 1.4:1

DESCRIPTION:
TRUE 75 OHM, RF6T CABLE ASSEMBLY

DWG. NO.
RFX6T-XXXXX-XXXXXX-XXXX

BY: R MUSSER 03/27/2009 SHEET 8 OF 8