

RECOMMENDED PCB LAY-OUT AND KEEP-OUT ZONE

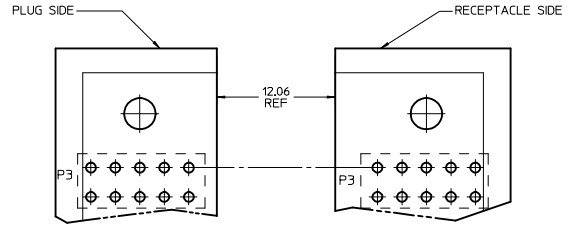
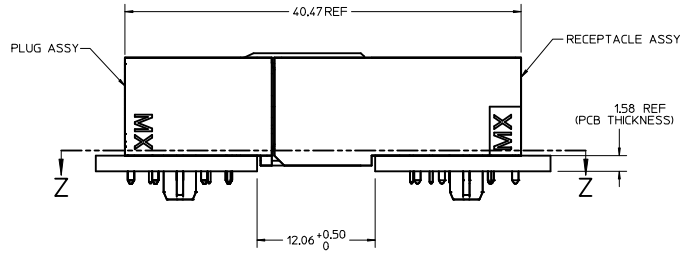
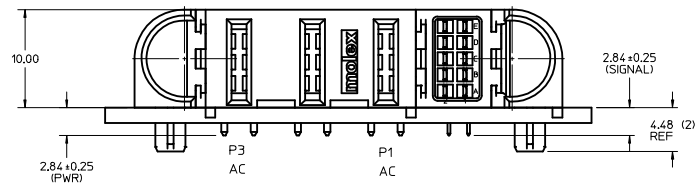

VIEW Z-Z
(POWER CKTS ARE ALIGNED)

NOTES:

- MATERIAL:
 - HOUSINGS: LCP UL94 V-0, COLOR: BLACK
 - TERMINALS: COPPER ALLOY
 - PLATING: 0.00127 NICKEL OVERALL WITH 0.00254 SELECTIVE TIN ON COMPLIANT PINS AND 0.000762 SELECTIVE GOLD ON CONTACT AREA
- PACKAGING ASSEMBLIES TO BE TRAY PACKED PER PACKAGING SPEC PK-46562-XXX
- PRODUCT SPEC PS-46436-100
- APPLICATION SPEC: AS-46436-100
- PCB REQUIRES SOLDER THRU HOLES, REFER TO PS-46436-100 FOR DETAILS
- PRODUCT TO MEET RoHS REQUIREMENTS
- ASSEMBLY MATES WITH PLUG ASSEMBLY, P/N 46437-1281

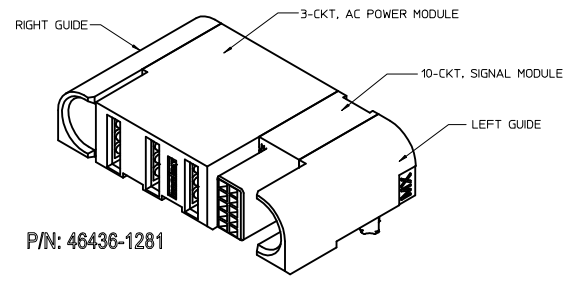

P/N: 46436-1281

RELEASED IEC NO: UCP2012-0275 DRAWN BY: TMPATIL CHECKED BY: CHYKOBPISZCZOR APPR: APATEL DATE: 2011/08/03 2012/08/22 2012/08/30	QUALITY SYMBOLS	GENERAL TOLERANCES (UNLESS SPECIFIED)	DIMENSION STYLE	SCALE	DESIGN UNITS	THIRD ANGLE PROJECTION
	▽=0	mm INCH	MM ONLY	4:1	METRIC	☉
	▽=0	4 PLACES ±--- ±---	DRAWN BY: TMPATIL	DATE: 2011/08/03	TITLE: RA RECEPTACLE ASSY	
	▽=0	3 PLACES ±--- ±---	CHECKED BY: BPI SZCZOR	DATE: 2012/08/22	10S-3AC	
	2 PLACES ±0.25 ±---	1 PLACE ±0.25 ±---	APPROVED BY: APATEL	DATE: 2012/08/30	TEN60 POWER FAMILY	
	ANGULAR ±1/2°		MATERIAL NO: 46436-1281	DOCUMENT NO: SD-46436-1281	MOLEX INCORPORATED	
		DRAFT WHERE APPLICABLE MUST REMAIN WITHIN DIMENSIONS	SIZE: D	SHEET NO: 1 OF 1		

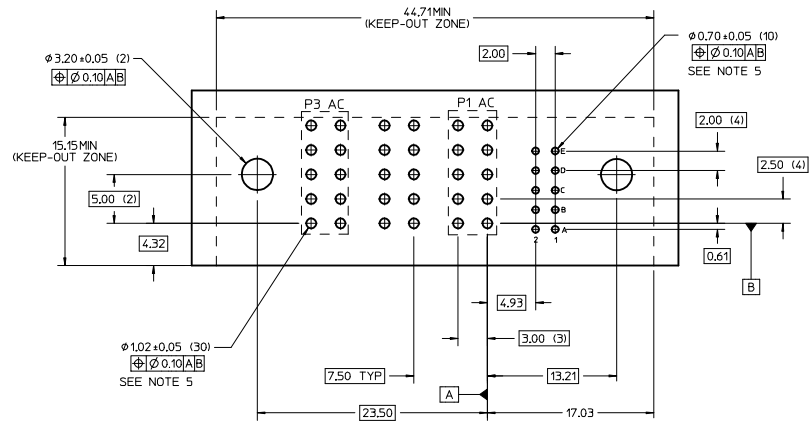
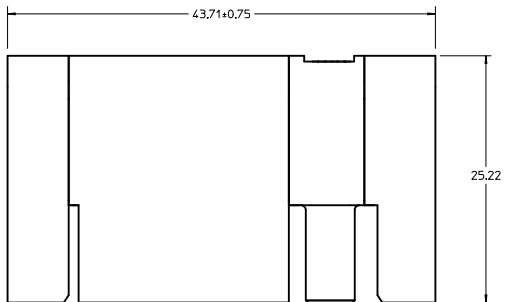

RECOMMENDED PCB LAY-OUT AND KEEP-OUT ZONE

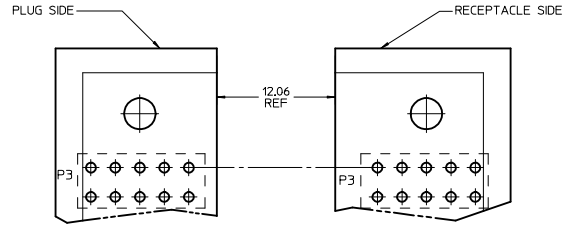
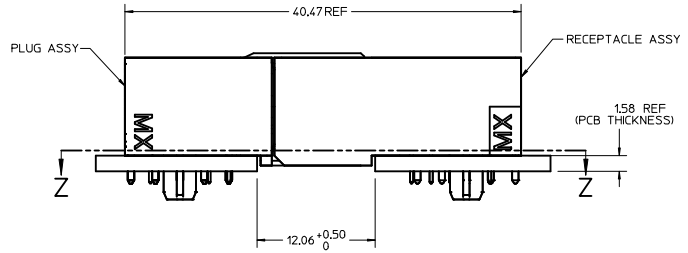
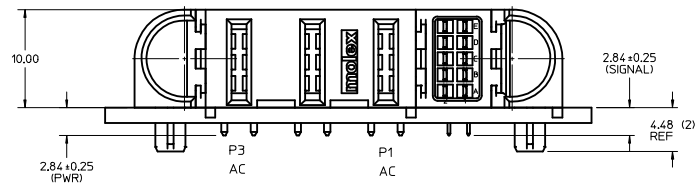

VIEW Z-Z
(POWER CKTS ARE ALIGNED)

NOTES:

- MATERIAL:
 - HOUSINGS: LCP UL94 V-0, COLOR: BLACK
 - TERMINALS: COPPER ALLOY
 - PLATING: 0.00127 NICKEL OVERALL WITH 0.00254 SELECTIVE TIN ON COMPLIANT PINS AND 0.000762 SELECTIVE GOLD ON CONTACT AREA
- PACKAGING ASSEMBLIES TO BE TRAY PACKED PER PACKAGING SPEC PK-46562-XXX
- PRODUCT SPEC PS-46436-100
- APPLICATION SPEC: AS-46436-100
- PCB REQUIRES SOLDER THRU HOLES, REFER TO PS-46436-100 FOR DETAILS
- PRODUCT TO MEET RoHS REQUIREMENTS
- ASSEMBLY MATES WITH PLUG ASSEMBLY, P/N 46437-1281

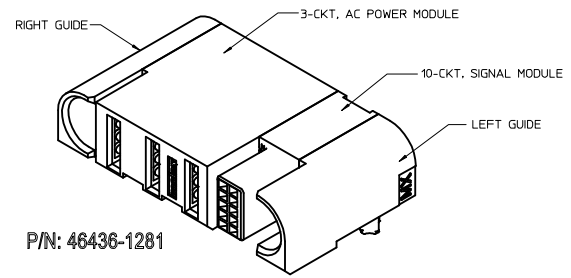

P/N: 46436-1281

RELEASED IEC NO: UCP2012-0275 DRAWN BY: TMPATIL CHECKED BY: CHYKOBPISZCZOR APPR: APATEL DATE: 2011/08/03 DATE: 2012/08/12 DATE: 2012/08/30	QUALITY SYMBOLS ∇=0 ∇=0 ∇=0	GENERAL TOLERANCES (UNLESS SPECIFIED)		DIMENSION STYLE MM ONLY	SCALE 4:1	DESIGN UNITS METRIC	THIRD ANGLE PROJECTION	
		4 PLACES ±--- ±--- 3 PLACES ±--- ±--- 2 PLACES ±0.25 ±--- 1 PLACE ±0.25 ±---	mm INCH	DRAWN BY: TMPATIL DATE: 2011/08/03	TITLE RA RECEPTACLE ASSY 10S-3AC TEN60 POWER FAMILY			
		ANGULAR ±1/2°		CHECKED BY: BPI SZCZOR DATE: 2012/08/22	MOLEX INCORPORATED			
		DRAFT WHERE APPLICABLE MUST REMAIN WITHIN DIMENSIONS		APPROVED BY: APATEL DATE: 2012/08/30	MATERIAL NO: 46436-1281	DOCUMENT NO: SD-46436-1281	SHEET NO. 1 OF 1	

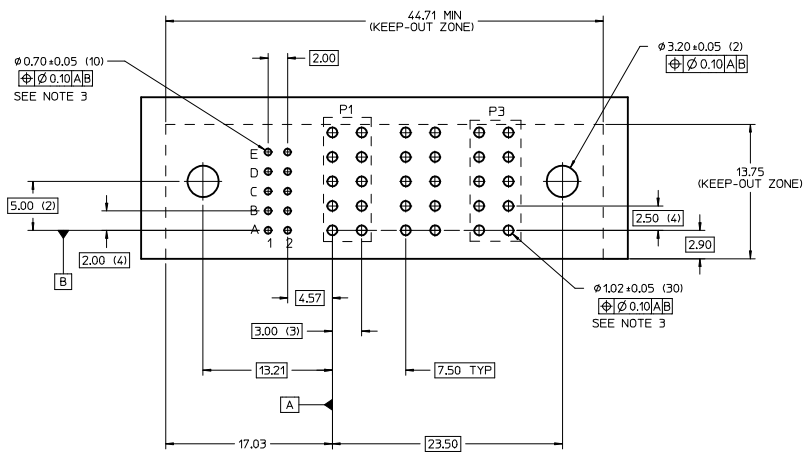
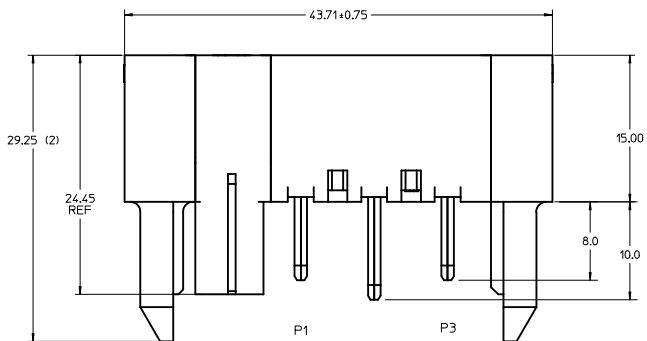

RECOMMENDED PCB LAYOUT AND KEEP-OUT ZONE

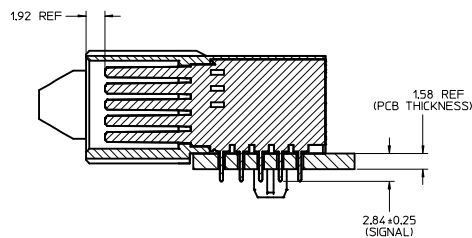
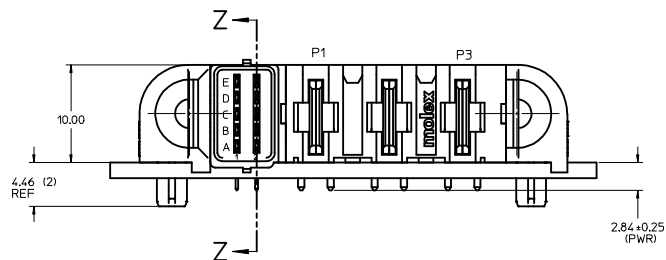

SECTION Z-Z

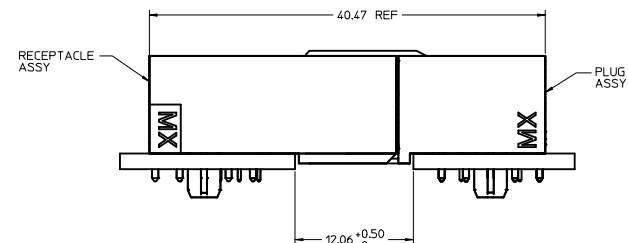

MATING PROFILE

NOTES:

- MATERIAL:
-HOUSINGS: LCP UL-94, V-0, COLOR: BLACK
-TERMINALS: COPPER ALLOY
-PLATING: 0.00127 NICKEL OVERALL WITH 0.00254 SELECTIVE TIN ON SOLDER TAILS AND 0.000762 SELECTIVE GOLD ON CONTACT AREA.
- PACKAGING: ASSEMBLIES TO BE TRAY PACKED, QTY TBD.
- PC BOARD REQUIRES SOLDER THRU HOLES. REFER TO PS-46436-100 FOR DETAILS
- PRODUCT SPEC: PS-46436-100
- APPLICATION SPEC: AS-46436-100
- SEE PRODUCT SPEC FOR MEET ROHS REQUIREMENTS
- ASSEMBLY MATES WITH MOLEX RECEPTACLE ASSEMBLY P/N: 46562-1281 AND 46436-1281

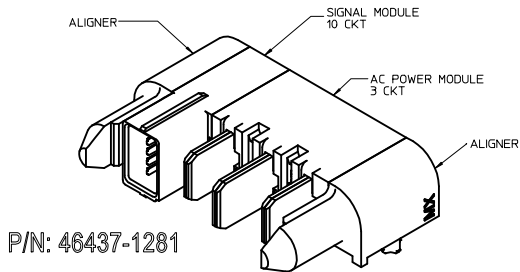

P/N: 46437-1281

RELEASED EIC NO: UICP2012-0275 DRAWN BY: SZCZOR 2012/04/11 CHECKED BY: SZCZOR 2012/08/22 APPR: APATEL 2012/08/30	QUALITY SYMBOLS	GENERAL TOLERANCES (UNLESS SPECIFIED)	DIMENSION STYLE	SCALE	DESIGN UNITS	THIRD ANGLE PROJECTION
	▽=0	mm INCH	MM ONLY	4:1	METRIC	☉
	▽=0	4 PLACES ± --- ± ---	DRAWN BY: TMPATIL DATE: 2011/08/03	TITLE	R/A PLUG ASSY	
	▽=0	3 PLACES ± 0.25 ± ---	CHECKED BY: BPI SZCZOR DATE: 2012/08/22	G-10S-3AC-G		TEN60 POWER FAMILY
	ANGULAR ±1/2°	DRAFT WHERE APPLICABLE MUST REMAIN WITHIN DIMENSIONS	MATERIAL NO.	DOCUMENT NO.	SHEET NO.	
			46437-1281	SD-46437-1281	1 OF 1	
			THIS DRAWING CONTAINS INFORMATION THAT IS PROPRIETARY TO MOLEX INCORPORATED AND SHOULD NOT BE USED WITHOUT WRITTEN PERMISSION			

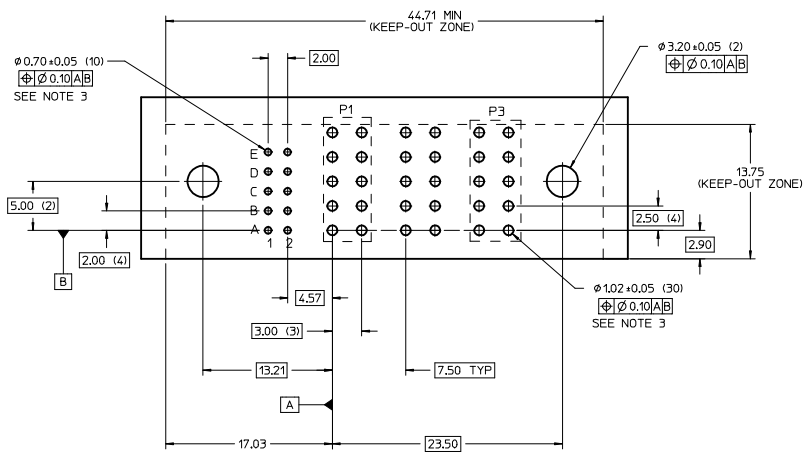
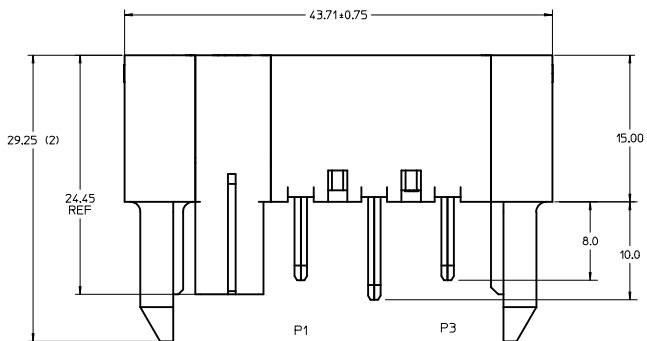

RECOMMENDED PCB LAYOUT AND KEEP-OUT ZONE

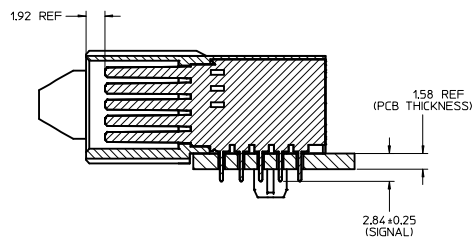
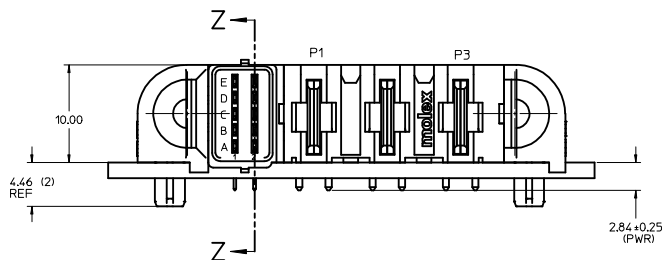

SECTION Z-Z

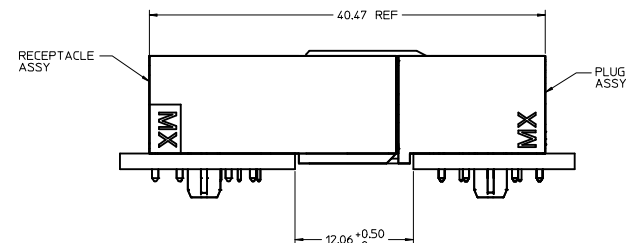

MATING PROFILE

NOTES:

- MATERIAL:
-HOUSINGS: LCP UL-94, V-0, COLOR: BLACK
-TERMINALS: COPPER ALLOY
-PLATING: 0.00127 NICKEL OVERALL WITH 0.00254 SELECTIVE TIN ON SOLDER TAILS AND 0.000762 SELECTIVE GOLD ON CONTACT AREA.
- PACKAGING: ASSEMBLIES TO BE TRAY PACKED, QTY TBD.
- PC BOARD REQUIRES SOLDER THRU HOLES. REFER TO PS-46436-100 FOR DETAILS
- PRODUCT SPEC: PS-46436-100
- APPLICATION SPEC: AS-46436-100
- SEE PRODUCT SPEC FOR MEET ROHS REQUIREMENTS
- ASSEMBLY MATES WITH MOLEX RECEPTACLE ASSEMBLY P/N: 46562-1281 AND 46436-1281

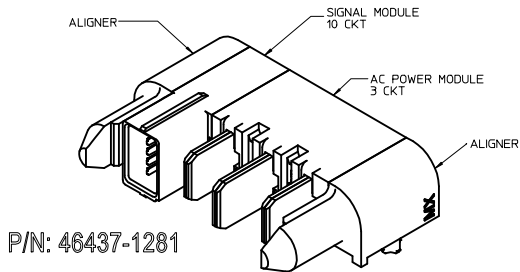

RELEASED IEC NO: UICP2012-0275 DRAWN BY: SZCZOR 2012/04/11 CHECKED BY: SZCZOR 2012/08/22 APPR: APATEL 2012/08/30	QUALITY SYMBOLS	GENERAL TOLERANCES (UNLESS SPECIFIED)	DIMENSION STYLE	SCALE	DESIGN UNITS	THIRD ANGLE PROJECTION
	▽=0	mm INCH	MM ONLY	4:1	METRIC	☉
	▽=0	4 PLACES ±--- ±---	DRAWN BY: TMPATIL DATE: 2011/08/03	TITLE	R/A PLUG ASSY	
	▽=0	3 PLACES ±0.25 ±---	CHECKED BY: BPI SZCZOR DATE: 2012/08/22	G-10S-3AC-G		TEN60 POWER FAMILY
		1 PLACE ±0.25 ±---	APPROVED BY: APATEL DATE: 2012/08/30	DOCUMENT NO. SD-46437-1281		SHEET NO. 1 OF 1
		0 PLACE ± ±	MATERIAL NO. 46437-1281		THIS DRAWING CONTAINS INFORMATION THAT IS PROPRIETARY TO MOLEX INCORPORATED AND SHOULD NOT BE USED WITHOUT WRITTEN PERMISSION	