

MATERIALS AND FINISHES

BODY: BERYLLIUM COPPER
PLATED GOLD

CENTER CONTACT: BERYLLIUM COPPER
PLATED GOLD

INSULATOR: TEFLON

CRIMP TUBE: BRASS
PLATED NICKEL

EMI RING: BRASS
PLATED GOLD

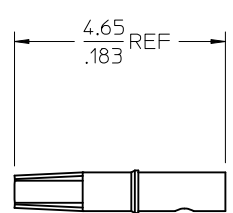
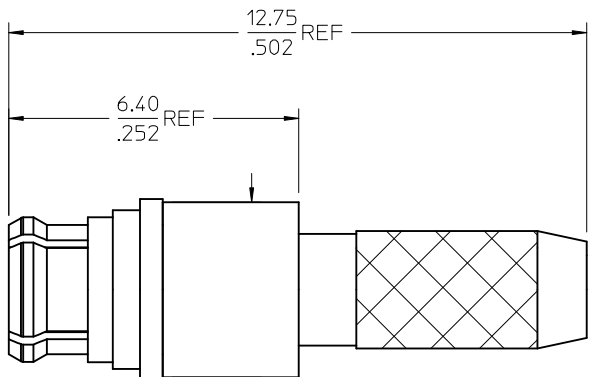
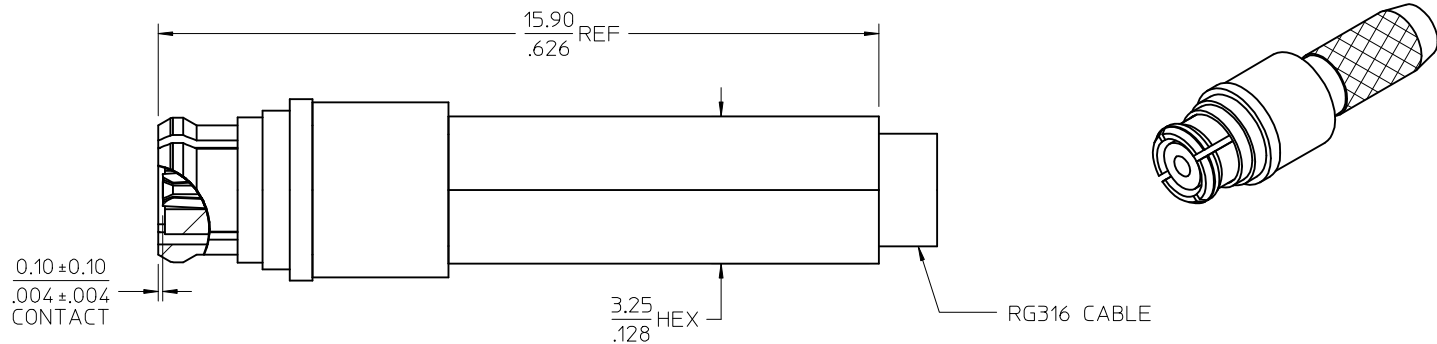

CENTER CONTACT

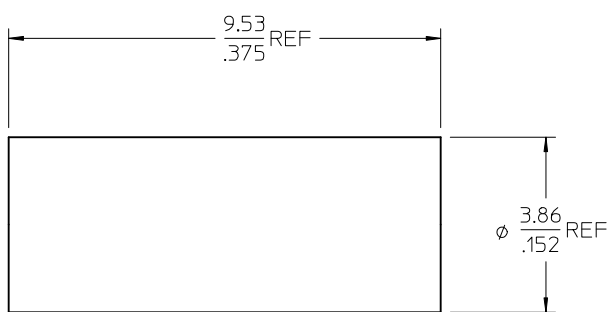

CRIMP TUBE

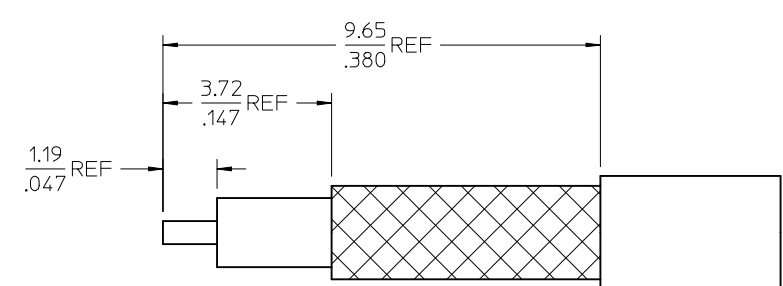

RECOMMENDED CABLE
STRIP DIMENSIONS

PART # 73415-4810

MIL-STD-348A, FIG. 326.1a	INTERFACE
SPECIFICATION	DESCRIPTION

CHG: UPDATE CONTACT DEPICTION EC NO: URF2010-0157 DRWN: WIENER 2009/09/21 CHKD: SHAH 2009/09/21 APPR: WIENER 2009/09/21	QUALITY SYMBOLS ▽=0 ▽=0	GENERAL TOLERANCES (UNLESS SPECIFIED)		DIMENSION STYLE MM/IN	SCALE METRIC	DESIGN UNITS METRIC	THIRD ANGLE PROJECTION		
		4 PLACES ± --- ± --- 3 PLACES ± --- ± --- 2 PLACES ± --- ± --- 1 PLACE ± --- ± ---	mm INCH	DRAWN BY TEF 2006/11/27	DATE 2006/11/27	TITLE SMP JACK, STR, 50 OHMS FOR RG316 CABLE SMP-JC			
		ANGULAR ± 2 °	DRAFT WHERE APPLICABLE MUST REMAIN WITHIN DIMENSIONS	CHECKED BY SSS 2006/11/27	DATE 2006/11/27	APPROVED BY JDW 2006/11/27			
		A1	REV	MATERIAL NO. 734154810	DATE 2006/11/27	MOLEX INCORPORATED	DOCUMENT NO. SD-73415-481	SHEET NO. 1 OF 1	